

HOTATA

User Manual

Model No: 3109

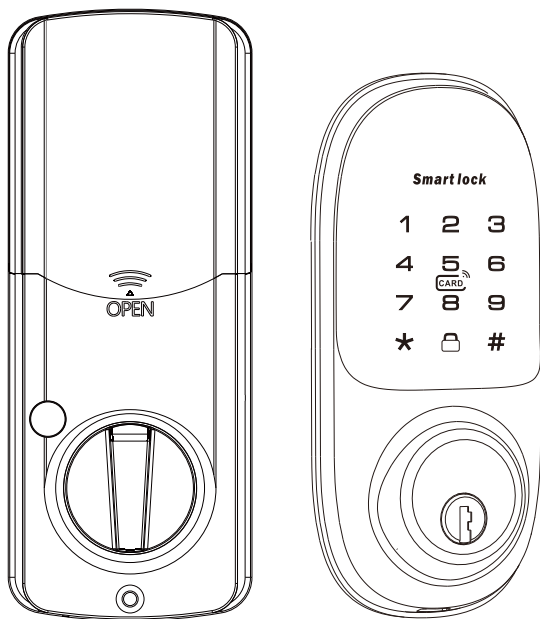

IMPORTANT: Read the instructions carefully before operating the appliance and keep them for future reference.

Customer Service



1 Year Warranty



Lifetime Customer Support



Quality Assurance



Support Return and Exchange

Email US: **aftersale@hotata.com**



Scan QR code for
video tutorials

Check out our video tutorials available at
**[https://www.youtube.com/
@hotataaftersale/playlists](https://www.youtube.com/@hotataaftersale/playlists)**

✉ **aftersale@hotata.com**

Contents

Components List	2
Installation Guide	3
Programming Guide	8
Change Programming Code	9
Advanced Stting Options	10
Basic Functions Of The App	13
FCC Warning	14
ISED Warning	15
Template	16

Components List

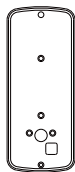
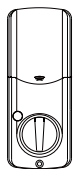
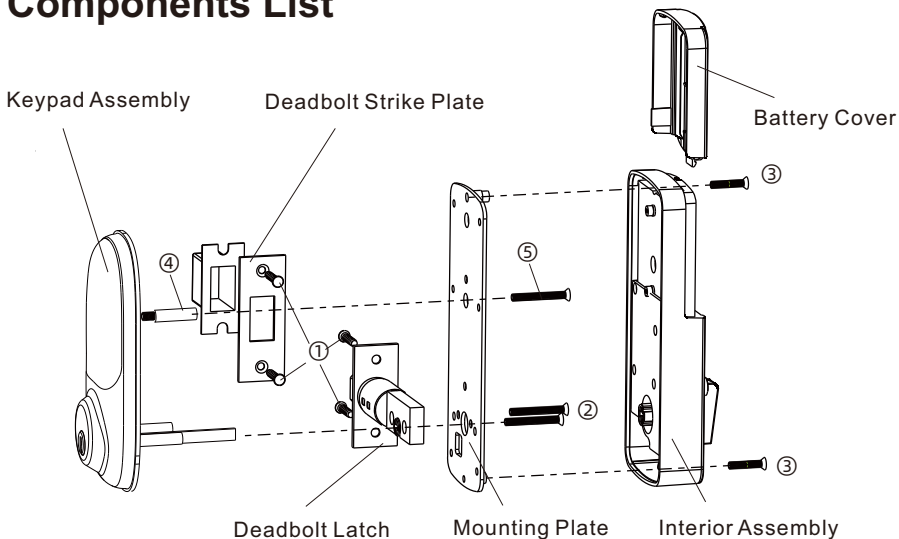

①

3/4"(19mm)Screws-4 pcs



②

1-5/32"(33mm)Screws-2 pcs



③

3/4"(19mm)Screws-2 pcs



Entry Key
(2 ea.)

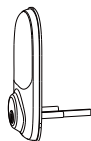

Keypad Assembly



Deadbolt Latch



④



⑤

Optional Reinforcement
screws (1 set)

Tools Required

Tools Required for Installation on Pre-drilled Doors:
•Phillips Screwdriver (DO NOT USE POWER DRILL!)



Installation Guide

Prepare the door and check dimensions

If drilling a new door, use the supplied template and the complete door drilling instructions.

Optional: For the best fix, you may need to drill an additional hole for the reinforcement screw.

1. Measure to confirm that the hole in the door is $2\frac{1}{8}"$ (54mm)

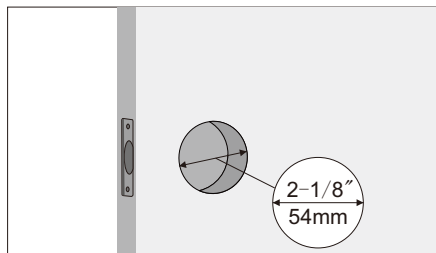

2. Measure to confirm that the backset is either $2\frac{3}{8}"$ or $2\frac{3}{4}"$ (60 or 70mm)

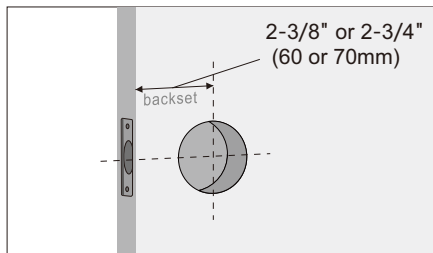

3. Measure to confirm that the hole in the door edge is 1" (25mm)

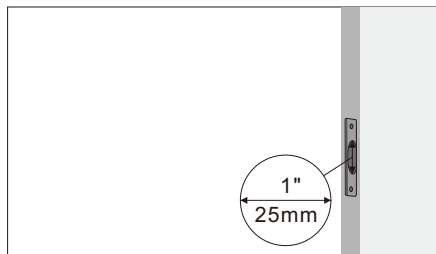

4. Measure to confirm the thickness of the door is between $1\frac{3}{8}"$ and 2" (35 and 50mm)

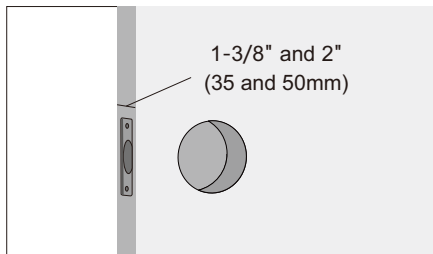

Installation Guide

Install the latch and strike

1. Insert the latch bolt into the door.

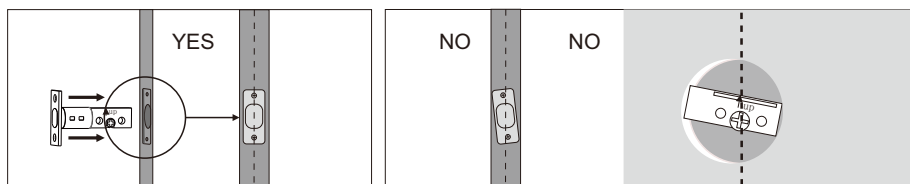
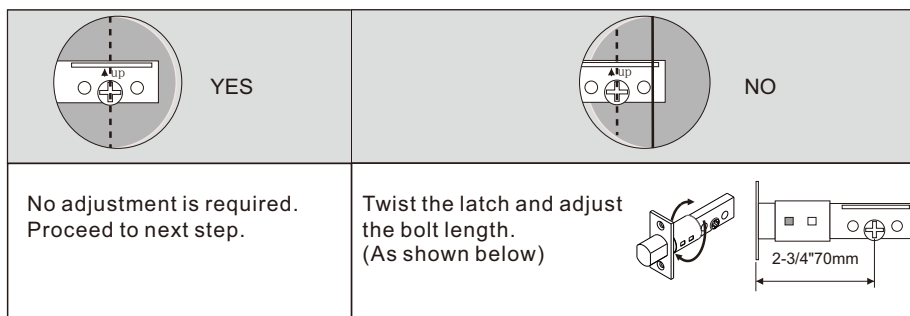
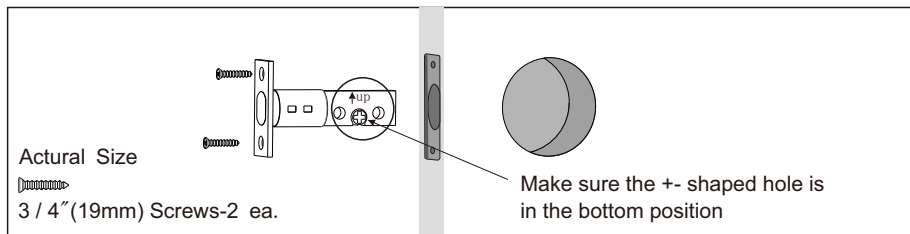

2. Install strike on the door frame.

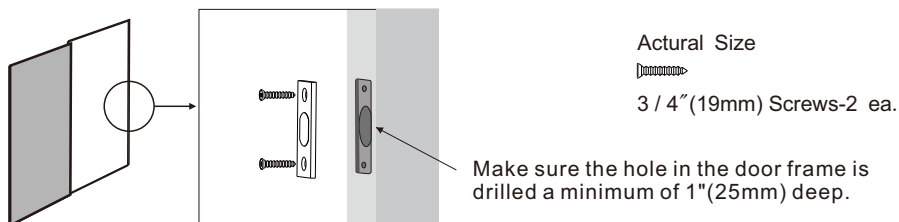

Installation Guide

Install the exterior assembly

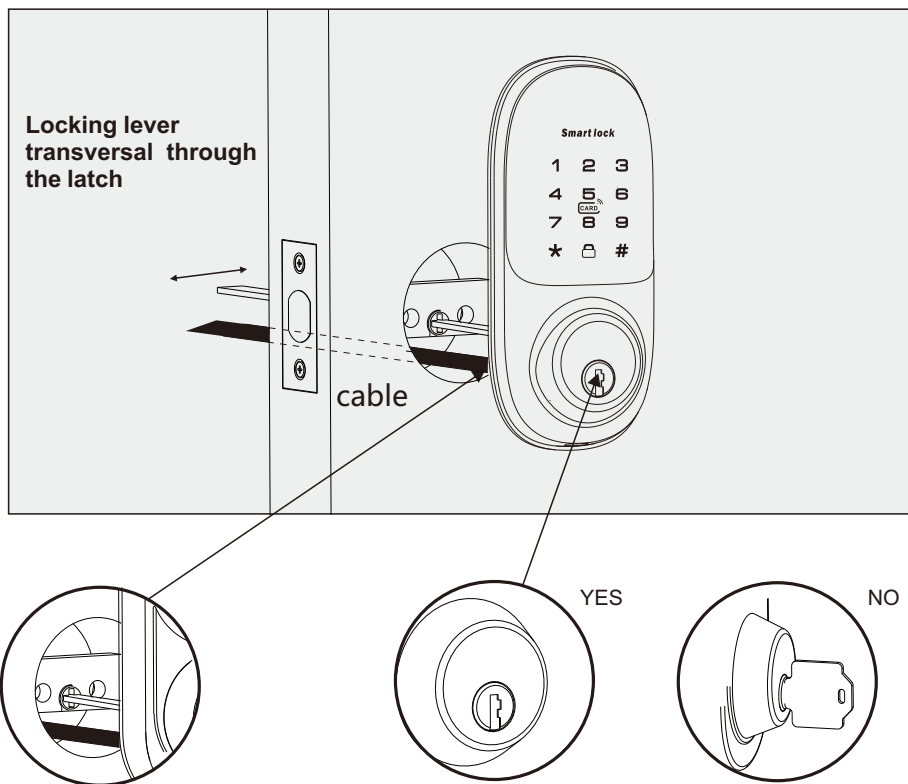

Route the cable through the door below the bolt and push the keypad onto the door.

The key must be pulled out when installing.

Installation Guide

Install the interior assembly

1. Please confirm the door opening direction before installing.
Find the direction switch under the Interior Assembly, and change the direction as per the instructions below:

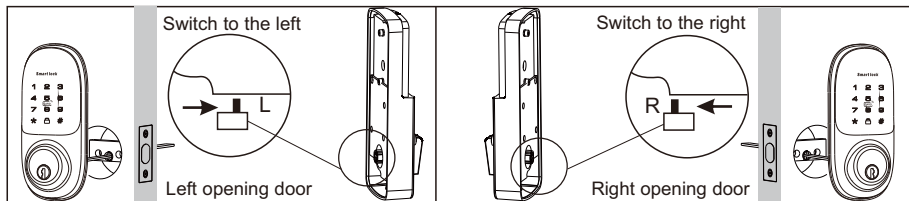

2. Route cable through the bottom of mounting plate.

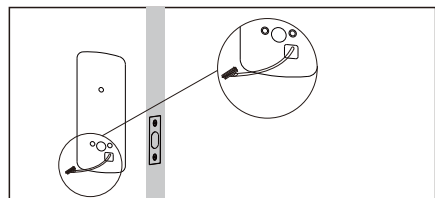

3. Tighten screws evenly.

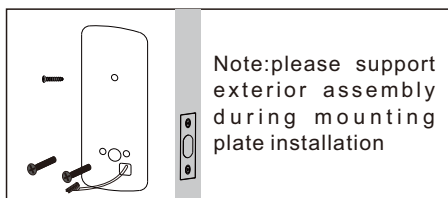

4. Ensure tight cable connection.

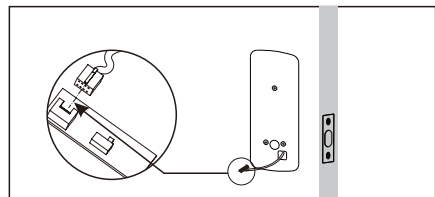

5. Tighten screws evenly.

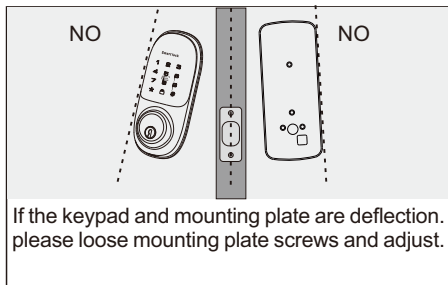
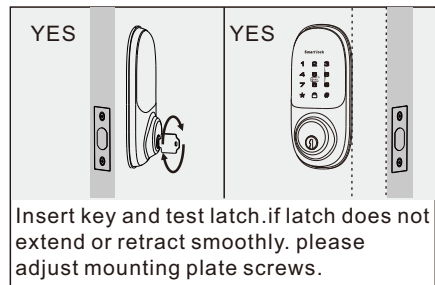
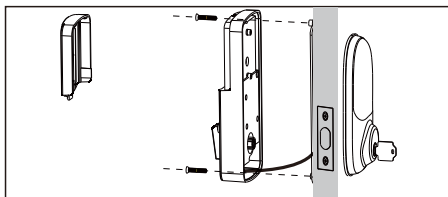

Installation Guide

Install the batteries and test the lock

Note: Do not use rechargeable batteries or Non-alkaline batteries.

1. Install 4 AA batteries in battery pack.

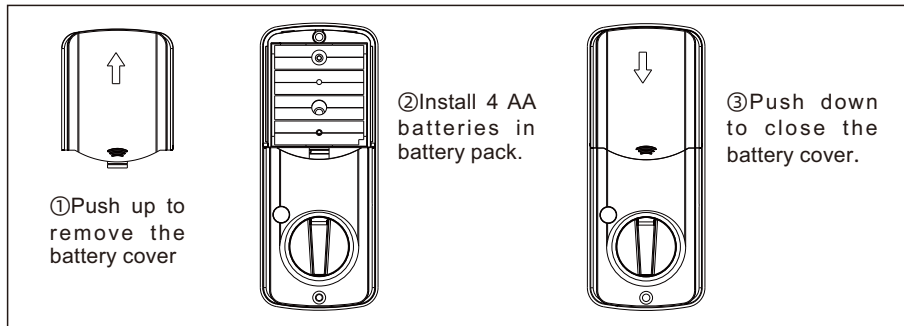

2. Test the lock.

- ① Press and hold , the latch bolt extends by itself.
- ② Enter preset code: 123456, press , the latch bolt retracts by itself.

 If the latch bolt extends or retracts not smoothly. please check the door opening direction and re-install the lock.

Programming Guide

Programming Symbols

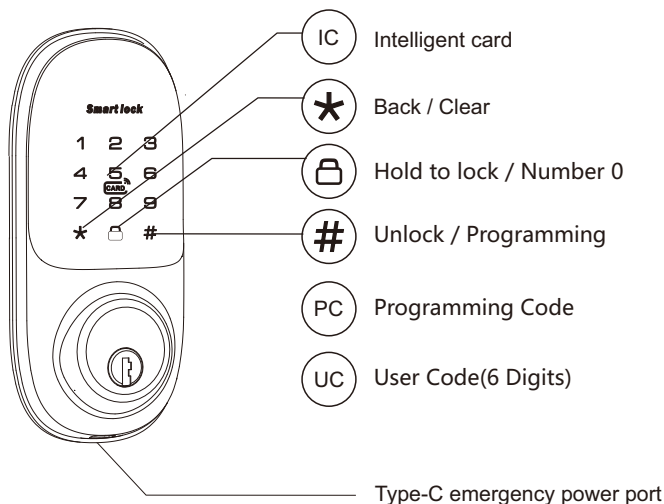

Factory default settings

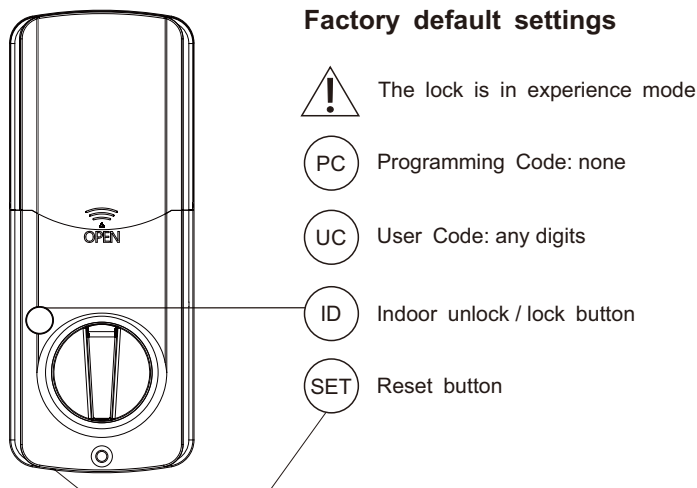

Change Programming Code



Important tips for programming :

- 1. For your safety, it is strongly recommended that you set and remember your programming code in time.
- 2. When you enter the wrong button, you can press * clear it.
- 3. If you do not enter any buttons within 15 seconds, the system will exit the programming mode, and you can attempt programming procedure again.

First time registration

If you have set a password in the "Tuya Smart" app as an administrator, you can ignore this step because the password set in the app is the programming code.

If your lock is new, the factory preset code is none, Please set it up asap, The new programming code must be 6 digits, Touch to light up keyboard then:

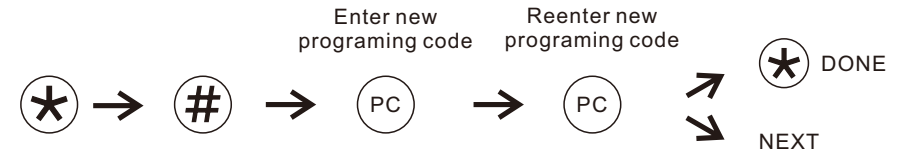

The lock can be set with 1 (PC) programming codes and 997 (UC) user codes or (IC) Intelligent cards. The first three registrations are (PC) programming codes, and the latter are users, both (UC) user codes and (IC) Intelligent cards are acceptable.

Not first time registration

Touch to light up keyboard then:

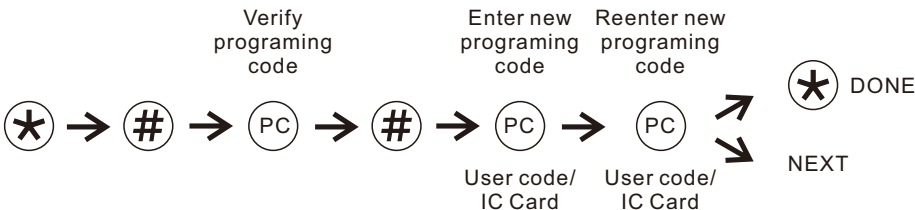

Advanced Setting Options

Auto-lock

Press keys 2 and 8 immediately after unlocking to enable the automatic locking function. The latch will automatically lock back within tens of seconds after each unlocking.

When the product is powered off and restarted, the automatic locking function will be turned off.

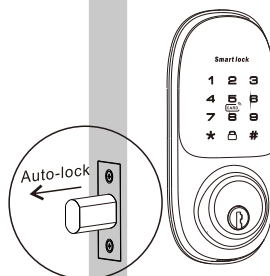

Factory default reset

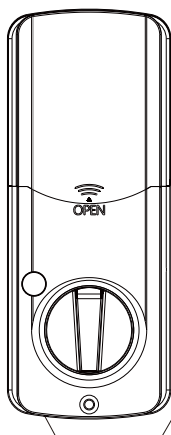

A factory reset will delete all codes associated with the lock.

Find a paper clip, put it into the hole at the bottom, long press for 5 seconds until the lock voice prompts "initialized successfully"

 The lock has been reset successfully. All entered information has been deleted.

Advanced Stting Options

Smart Home Platform

The lock supports TUYA Bluetooth protocol,you can manage your lock by connecting TUYA APP Search "TUYA" in the app market or scan the code to get the APP.



How to connect the app

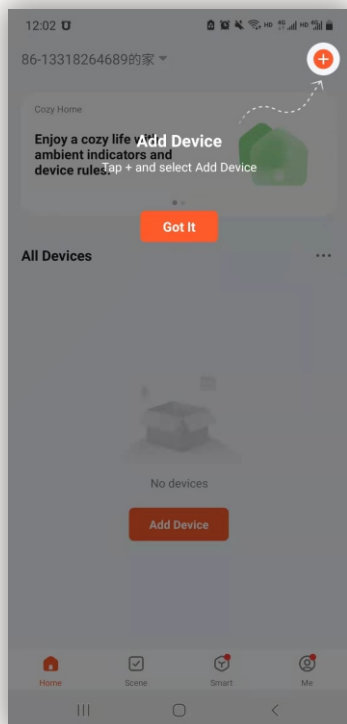

Step 1
Open TUYA APP, click to add device

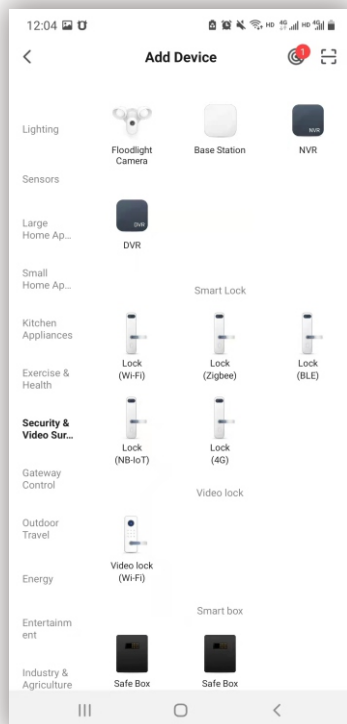

Step 2
Choose Security & Surveillance-
Lock(BLE)

Advanced Stting Options



Step 3
Click on the scanned device and Next

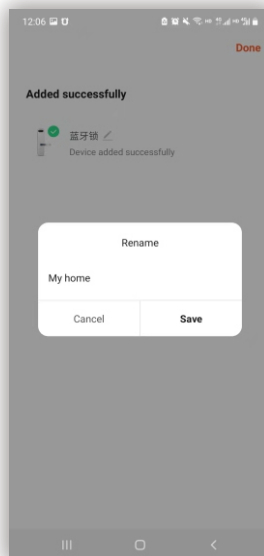

Step 4
Edit your device name

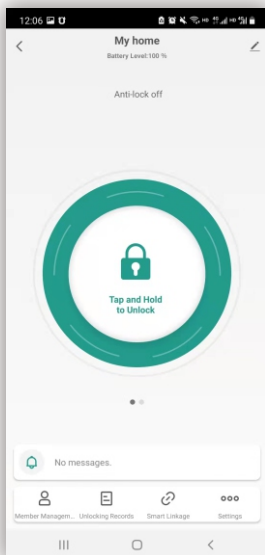

Step 5
You can press the icon to unlock via Bluetooth, and manage your device on your phone.

Basic Functions Of The App

Introduction to some functions

You can manage almost the full functionality of your lock on your phone.

Note:

It is recommended to use the APP to set your lock from the beginning. The programming code set by the APP will replace the programming code that has been set on the lock in turn.

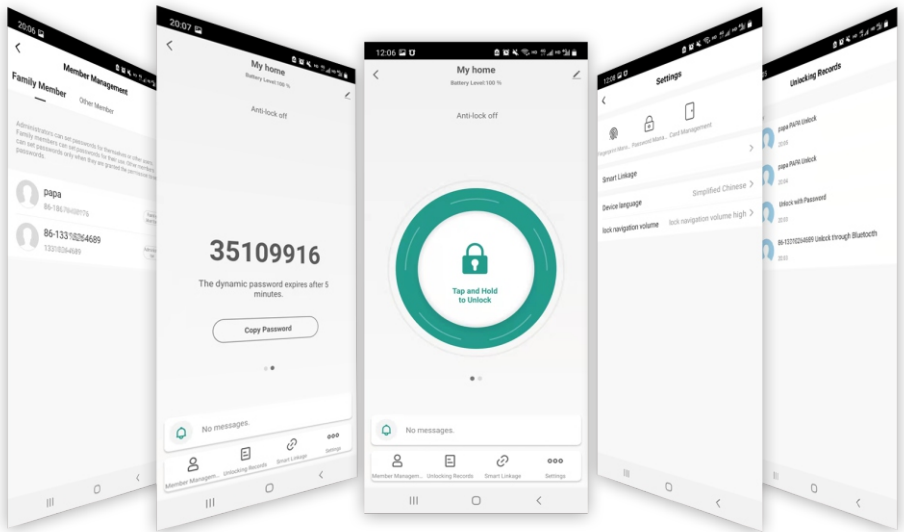

- Programming code
- User code
- Intelligent cards
- Unlock records
- Member management
- Dynamic password

System language & volume For more functions, please refer to the APP.

If you have any questions, please contact us at any time.

Email: Aftersale @hotata.com

FCC Warning

Any Changes or modifications not expressly approved by the party responsible for compliance could void the user's authority to operate the equipment.

Note: This equipment has been tested and found to comply with the limits for a Class B digital device, pursuant to part 15 of the FCC Rules. These limits are designed to provide reasonable protection against harmful interference in a residential installation. This equipment generates uses and can radiate radio frequency energy and, if not installed and used in accordance with the instructions, may cause harmful interference to radio communications. However, there is no guarantee that interference will not occur in a particular installation. If this equipment does cause harmful interference to radio or television reception, which can be determined by turning the equipment off and on, the user is encouraged to try to correct the interference by one or more of the following measures

- Reorient or relocate the receiving antenna.
- Increase the separation between the equipment and receiver.
- Connect the equipment into an outlet on a circuit different from that to which the receiver is connected.
- Consult the dealer or an experienced radio/TV technician for help.

This device complies with part 15 of the FCC Rules. Operation is subject to the following two conditions:

(1) This device may not cause harmful interference, and (2) this device must accept any interference received, including interference that may cause undesired operation.

This equipment complies with FCC radiation exposure limits set forth for an uncontrolled environment. This equipment should be installed and operated with minimum distance 20cm between the radiator & your body.

ISED Warning

This device contains licence-exempt transmitter(s)/receiver(s) that comply with Innovation, Science and Economic Development Canada's licence-exempt RSS(s). Operation is subject to the following two conditions:

- (1) This device may not cause interference.
- (2) This device must accept any interference, including interference that may cause undesired operation of the device.

L'émetteur/récepteur exempt de licence contenu dans le présent appareil est conforme aux CNR d'Innovation, Sciences et Développement économique Canada applicables aux appareils radio exempts de licence. L'exploitation est autorisée aux deux conditions suivantes :

- 1) L'appareil ne doit pas produire de brouillage;
- 2) L'appareil doit accepter tout brouillage radioélectrique subi, même si le brouillage est susceptible d'en compromettre le fonctionnement.

This transmitter must not be co-located or operating in conjunction with any other antenna or transmitter. Cet émetteur ne doit pas être colocalisé ou fonctionner en conjonction avec une autre antenne ou un autre émetteur. The device meets the exemption from the routine evaluation limits in section 2.5 of RSS-102 and compliance with RSS-102 RF exposure, users can obtain Canadian information on RF exposure and compliance. This equipment should be installed and operated with a minimum distance of 20 centimeters between the radiator and your body.

Le dispositif rencontre l'exemption des limites courantes d'évaluation dans la section 2.5 de RSS 102 et la conformité à l'exposition de RSS-102 rf, utilisateurs peut obtenir l'information canadienne sur l'exposition et la conformité de rf.

Cet émetteur ne doit pas être Co-placé ou ne fonctionnant en même temps qu'aucune autre antenne ou émetteur. Cet équipement devrait être installé et actionné avec une distance minimum de 20 centimètres entre le radiateur et votre corps.

TEMPLATE

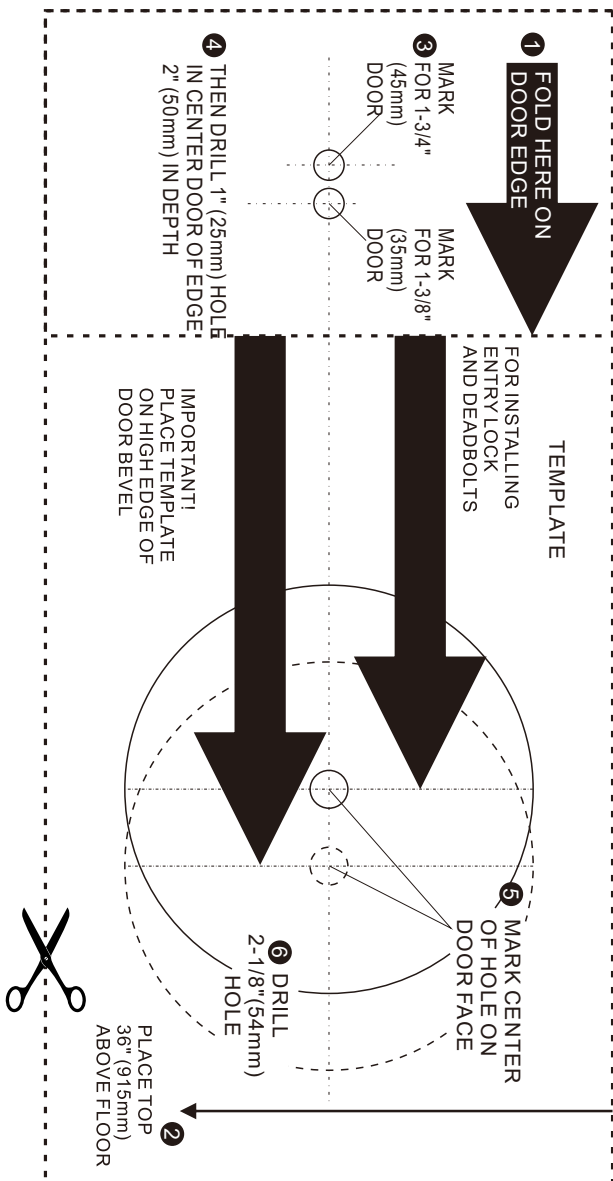

Scan the QR code or visit the link:

<https://www.youtube.com/@hotataaftersale/playlists>

to watch video tutorials, which can help you better understand the installation and usage of the product.



Scan QR code for
video tutorials