

HOME
HERO

FOOD SCALE WITH TIMER AND PULL OUT DISPLAY



33lb/15kg FOOD SCALE

Batteries

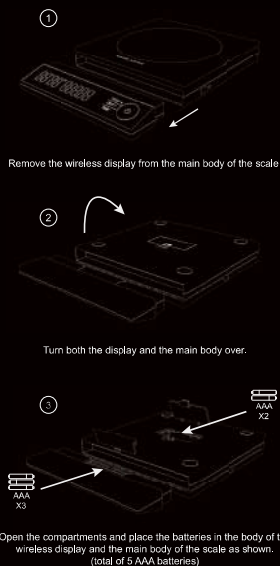

Turning On / Off



Pulling Out the Display



Display features

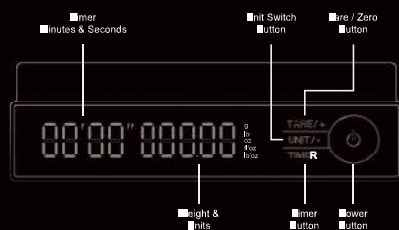

Power Button

In addition to the main body of the scale, press the power button to turn ON and OFF. The display will connect.

Tare / Zero Button

Press Tare to reset the scale measure to 0 before adding ingredients.

Timer Button

Press Timer to open the feature, minutes and seconds are adjustable by pressing the + on Tare and the - on Unit. *explanation on next pages

Unit Switch Button

Press to switch between the different units at any time during weighing.

Weight & Units

Display the weight. This scale provides measures for 5 types of unit: grams, pounds, ounces, US fluid ounces and pound ounces. Measures up to 33lb/15kg.

Timer

Display the timer. An alarm will sound when reaching 0.

Automatic Shut-Off

After 5 minutes without activity, the scale will shut off and the measure/time will be lost.

Zeroing

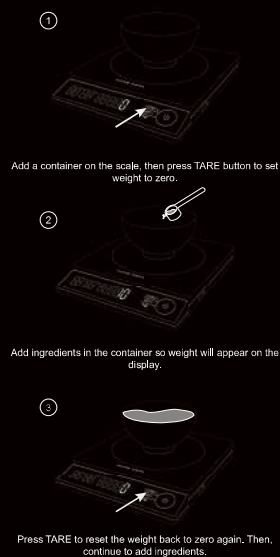

Using Timer

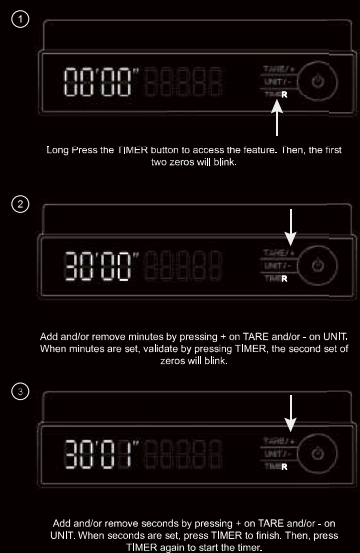

Using the scale while the timer is ON



FCC Warning:

This equipment has been tested and found to comply with the limits for a Class B digital device, pursuant to part 15 of the FCC Rules. These limits are designed to provide reasonable protection against harmful interference in a residential installation. This equipment generates, uses and can radiate radio frequency energy and, if not installed and used in accordance with the instructions, may cause harmful interference to radio communications. However, there is no guarantee that interference will not occur in a particular installation. If this equipment does cause harmful interference to radio or television reception, which can be determined by turning the equipment off and on, the user is encouraged to try to correct the interference by one or more of the following measures:

- Reorient or relocate the receiving antenna.
- Increase the separation between the equipment and receiver.
- Connect the equipment into an outlet on a circuit different from that to which the receiver is connected.
- Consult the dealer or an experienced radio/TV technician for help.

Caution: Any changes or modifications to this device not explicitly approved by manufacturer could void your authority to operate this equipment.

This device complies with part 15 of the FCC Rules. Operation is subject to the following two conditions:

(1) This device may not cause harmful interference, and (2) this device must accept any interference received, including interference that may cause undesired operation.

This equipment complies with FCC radiation exposure limits set forth for an uncontrolled environment. This equipment should be installed and operated with minimum distance 0cm between the radiator and your body.