

## How it works

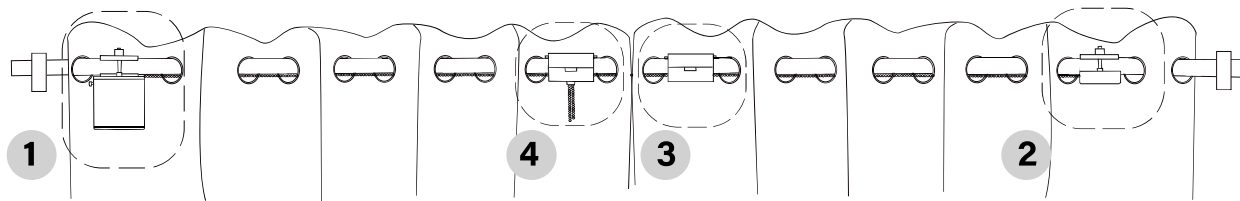

The host rotates to drive the bead chain, The chain pulls/push the two fasteners to control the opening and closing of the curtain. The threading process

## The threading process

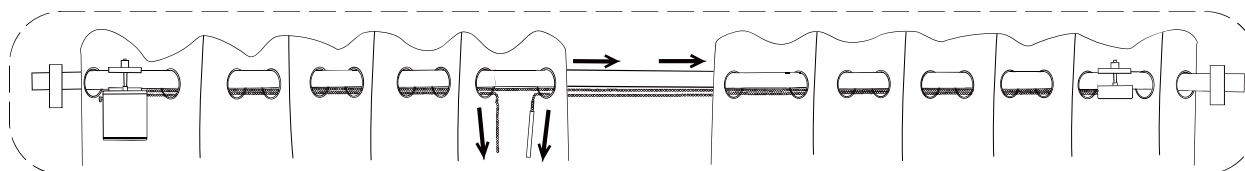

- 1: Use traction rod let chain through all curtain rings from left to right .
- 2: Use rod let the chain of right side through rings of right side to the middle .
- 3: Use rod let the chain of left side through rings of left side to the middle .

## Tips:

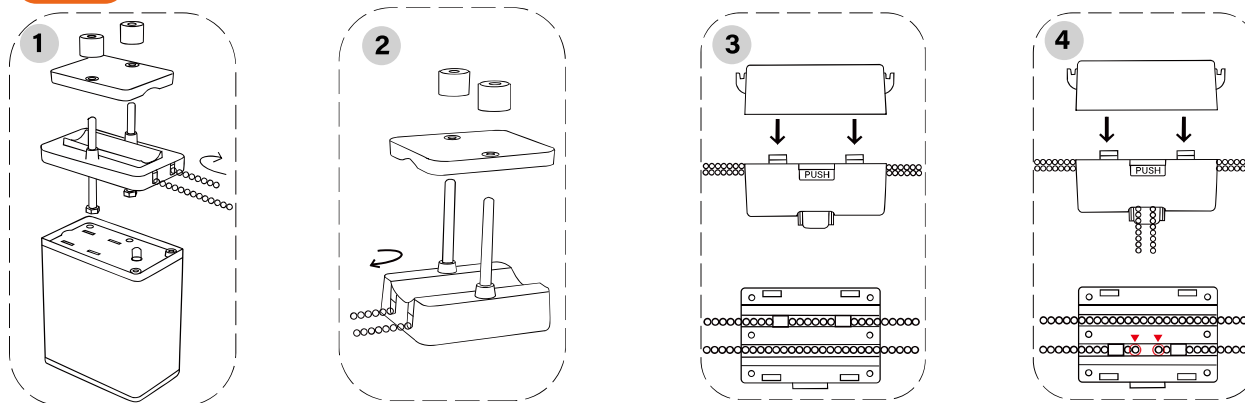

1: Follow the arrow , let the chain through the hole of host .

2: Follow the arrow , let the chain through the hole of host .

3: Use the fastener clip the chain , notice the chain is inside one .

4: This is the last step , let the chain of 2 sides through the hole of the fastener. Clip the chain, let it don't move .

## Precautions:

- 1 . This product is not a toy . Keep children away from this product.
- 2 . This product is **only** for indoor use . Please do not use this product in humid environment or outdoor.
- 3 . Do not expose this product to liquids or operate with wet hands.
- 4 . Do not place this product near heat sources in a closed environment.
- 5 . Do not attempt to disassemble, modify or repair this product, unless by an authorized technician .
- 6 . This product is designed to improve the convenience of home life . We do not account for any risks or property loss as possible results of not following this user manual.

## Warranty:

We warrant to the original owner of the product that the product will be free from defects in materials and workmanship . Please note that this limited warranty does not cover:

- 1 . Products submitted beyond the original limited warranty period.
- 2 . Products on which repairs or modifying have been attempted.
- 3 . Products subjected to falls , extreme temperatures , water , or other operating conditions outside the product specifications.
- 4 . Damage due to natural disaster ( including but not limited to lightning , flood , tornado , earthquake , or hurricane , etc . ) .
- 5 . Damage due to misuse , abuse , negligence or casualty ( e . g . fire ) .
- 6 . Other damage that is not attributable to defects in the manufacture of product materials .
- 7 . Products purchased from unauthorized resellers.
- 8 . Consumable parts ( including but not limited to batteries ) .
- 9 . Natural wear of the product.

## Contact & Support:

Set up and Troubleshooting : ([search adasisan in Youtube](https://www.youtube.com/channel/UCC21oHzDjKlI8eRfbrCHJg))  
<https://www.youtube.com/channel/UCC21oHzDjKlI8eRfbrCHJg>

Support Email : [service@adasisan.com](mailto:service@adasisan.com)

Feedback : If you have any concerns or problems when using our products , please send feedback via our E-mail.

# Adasisan

Control your dream home at ease

## Packing list

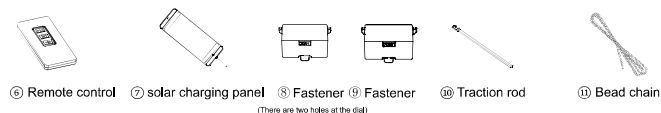
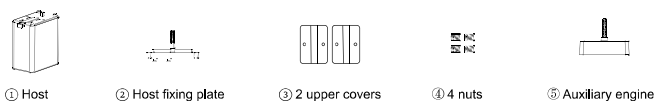

## Function Description

### Function Description:

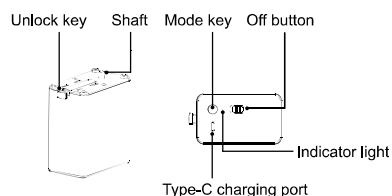

### Mainframe button function description:

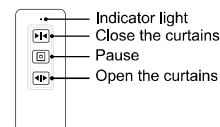

### On/Off button:

When it is moved to the position close to the indicator light, the curtain companion is turned on, and when it is moved to the opposite position, the curtain companion is turned off.

- Pairing between the host and the mobile phone: long press the function key for 5 seconds and the indicator light flashes slowly in the pairing state (for specific operations, please scan the QR code of the installation video, smart connection and usage method to watch the connection method of the Linklemo APP).
- The remote control is paired with the host; long press any key of the remote control and touch the function key of the host once, the remote control can be paired with the host.
- Press and hold the function key for 10 seconds when the indicator light flashes rapidly, the Curtain Companion has been restored to factory settings.

**Warning:** After a factory reset, you may lose all settings and you may need to re-add the device to reset it.

### Type-C charging port:

When it is moved to the position close to the indicator light, the curtain companion is turned on, and when it is moved to the opposite position, the curtain companion is turned off.

### Charging port:

- Plug the charging port into the solar charging board or 5V=1A charger (not included) for charging

### Remote control opening and closing ratio position setting method:

- Click "□□" to open the curtain to a suitable position, click "□□" to pause the curtain, and press "□□" at the same time to set the curtain opening position successfully.
- Click "□□" to close the curtain to a suitable position, click "□□" to pause the curtain, and press "□□" at the same time to set the curtain closing position successfully.
- Press "□□" at the same time to reset the opening and closing ratio position successfully.

## Product parameters

Model:	AD-1R	Product power:	0.9w-1.5w
Material:	ABS plastic	Wireless version:	5.0
Product net weight:	1.3kg	Wireless working range:	10m
Host battery:	8000mAH lithium ion battery	Timer:	It needs to be connected to the 2.4G WIFI network with the Linklemo APP
Host power supply:	solar panel or DC 5v=1A adapter (not included)	Voice control:	It needs to be equipped with the Linklemo APP and smart speakers
Maximum load:	20kg	Host size:	107*98*53mm
Applicable curtain length:	1~4m	Auxiliary machine size:	65*70*55mm

## Preparation before installation

- Smartphone (not included)
- Download the Linklemo APP on your mobile phone, register and log in to your account.
- If the indicator light is not on after turning on the power button of the host, use a 5V=1A charging device (not included) to charge the host of the curtain companion for 4 hours and then turn it on.
- Voice control and timer switch functions need to be used with a smartphone (not included) to download the Linklemo APP and connect to a 2.4G WIFI network.

### Notice:

Before installing the host, make sure that the host is turned off. After the installation is complete, confirm that the bead chain has been adjusted to the appropriate position. After booting, set the opening and closing position through the Linklemo APP/remote control before testing and running, so as to avoid misoperation of the host .

Model: AD-1R

## Smart WIFI Curtain Set

Roman Rod Manual >>>



Scan the QR code to watch the installation video, intelligent connection and usage



Scan the QR code to download Linklemo APP

FCC Warning:

This equipment has been tested and found to comply with the limits for a Class B digital device, pursuant to part 15 of the FCC Rules. These limits are designed to provide reasonable protection against harmful interference in a residential installation. This equipment generates, uses and can radiate radio frequency energy and, if not installed and used in accordance with the instructions, may cause harmful interference to radio communications. However, there is no guarantee that interference will not occur in a particular installation. If this equipment does cause harmful interference to radio or television reception, which can be determined by turning the equipment off and on, the user is encouraged to try to correct the interference by one or more of the following measures:

- Reorient or relocate the receiving antenna.
- Increase the separation between the equipment and receiver.
- Connect the equipment into an outlet on a circuit different from that to which the receiver is connected.
- Consult the dealer or an experienced radio/TV technician for help.

Caution: Any changes or modifications to this device not explicitly approved by manufacturer could void your authority to operate this equipment.

This device complies with part 15 of the FCC Rules. Operation is subject to the following two conditions:

(1) This device may not cause harmful interference, and (2) this device must accept any interference received, including interference that may cause undesired operation.

This equipment complies with FCC radiation exposure limits set forth for an uncontrolled environment. This equipment should be installed and operated with minimum distance 20cm between the radiator and your body.