

STEP 6

Next time if you need to wash, just place the model face up into the empty box, then stack the two boxes as in Step 4. Turn on the cleaning agent valve and air-in switch, then wait for the alcohol to flow into the box with models, then follow the guidelines in Step3 to finish washing.

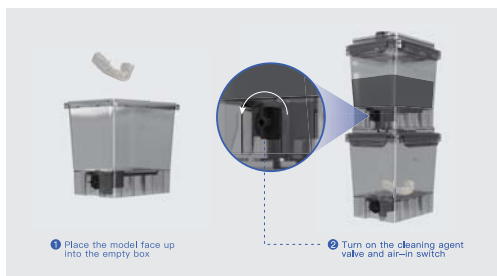

5 Cautions

01

Please clean the washing box with the supplied brush when a large amount of resin residue in it.

02

Please store the box containing alcohol properly when washing is finished. Cover the lid tightly and turn off the air-in switch.

03

The washing unit may cause the table to shake during working, so please avoid placing objects that can be easily poured or open containers with other liquids nearby.



heygears.com

info@heygears.com

Tel: +1 (318) 353-4295 (Global)/ +1 (949) 418-9418 (USA) / +44 148-396-8549 (EU)

USA-17931 Sky Park Circle, Suite E, Irvine, CA, 92614

CHN-Block B2, 501, 601, Enterprise Accelerator, Kaifu District, Guangzhou City

Follow us @HeyGears



Quickstart V1.0



Wash

UltraCraft Washing

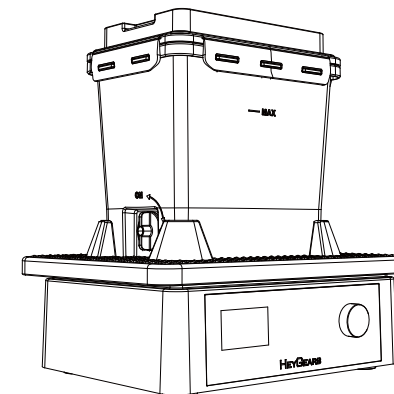

This quick start must be read and understood before operating the machine.

Thank you for choosing HeyGears. **For safety, please contact HeyGears support staff for assistance regarding unpacking and installing the machine.** If you fail to comply with the instructions in this manual, HeyGears will not be liable for the consequential damages unless required by federal and local ordinances.

Please keep this operation manual properly for future reference. The pictures are for reference only and the products are subject to the actual product.

1 Items & Parameters



UltraCraft Wash
X1



Power Cord
X1



Washing Box
X2



Brush
X1

Name	UltraCraft Washing Unit	Input	100–240 V~ 50/60 Hz
Model	UltraCraft Wash	Weight	8 kg
Size	351*272*168 mm	Power	80 W

2 Components



3 Installation Requirements



Position the printer onto a stable table



100–240 V power socket nearby



Protected from exposure to direct sunlight

Temperature & Humidity Control:



18~25°C



<50%

4 Operation Steps

STEP 1

Take out the washing unit from the package and place it on an even, horizontal surface. Use the power cord supplied in the package for connecting to the mains, then turn on the start button. The screen lights up means it connect to the power supply successfully.



STEP 2

Take out two washing boxes and their lids in package and separate them. Put the model in it.



STEP 3

Put the washing box on the washing unit and rotate the knob to select "Wash", then select the washing time and speed as recommended in parameters page. Press the knob to start washing after selection.



STEP 4

Remove the washing box when washing finished, and put it on the other empty box, then rotate the cleaning agent valve to ON, turn on the air-in switch. The alcohol will flow out naturally.

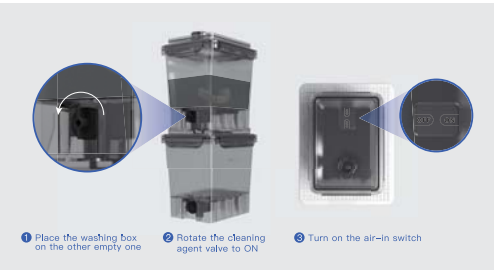

STEP 5

After the alcohol is drained, turn off the cleaning agent valve and air-in switch. Remove the models from the washing box, and store the two boxes properly.



FCC Compliance Information Statement

Caution

Caution: The user is cautioned that changes or modifications not expressly approved by the party responsible for compliance could void the user's authority to operate the equipment.

This device complies with part 15 of the FCC Rules. Operation is subject to the following two conditions:

- ① This device may not cause harmful interference, and
- ② this device must accept any interference received, including interference that may cause undesired operation.

NOTE

This equipment has been tested and found to comply with the limits for a Class B digital device, pursuant to Part 15 of the FCC Rules. These limits are designed to provide reasonable protection against harmful interference in a residential installation. This equipment generates, uses and can radiate radio frequency energy and, if not installed and used in accordance with the instructions, may cause harmful interference to radio communications. However, there is no guarantee that interference will not occur in a particular installation. If this equipment does cause harmful interference to radio or television reception, which can be determined by turning the equipment off and on, the user is encouraged to try to correct the interference by one or more of the following measures:

- Reorient or relocate the receiving antenna.
- Increase the separation between the equipment and receiver.
- Connect the equipment into an outlet on a circuit different from that to which the receiver is connected.
- Consult the dealer or an experienced radio/TV technician for help.

FCC Radiation Exposure Statement

This equipment complies with FCC radiation exposure limits set forth for an uncontrolled environment. This equipment should be installed and operated with a minimum distance of 20cm between the radiator and your body.

This transmitter must not be co-located or operating in conjunction with any other antenna or transmitter.



HEYGEARS

