

Wireless Microphone

User Manual



Made in China

Introduction

Thanks for choosing our product.
This product is a smart wireless microphone that provides, professional-grade recording output.Plug and play,no app required.
Multiple uses, It can be used in online live broadcast video Vlog, shooting, program interview, recording, video teaching and other occasions.

The wireless Microphone consists of two parts, one is Microphone. Transmitter, the other one is receiver, (See as below picture)

*Some mobile APPs support external microphones, but the OTG part of the settings page of the mobile phone is turned off, which will cause the connection to fail. In this case, please search for OTG in the settings bar on the mobile phone page, turn it on, and enable the product to connect and use normally.

*Some mobile phone apps do not support external microphones, which will cause silent recording. In this case, please replace the app and continue to use the product.

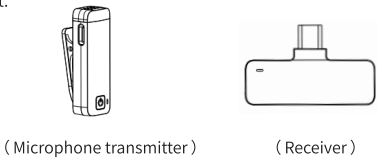

(Microphone transmitter) (Receiver)

ID Diagram

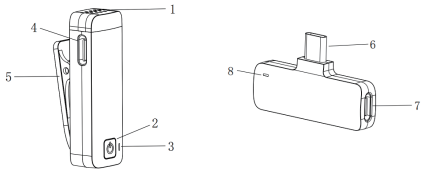

- ①Windproof net
②Switch key
③Microphone indicator
④Microphone charging port
- ⑤Microphone clip
⑥Mobile interface
⑦The port of receiver
⑧Receiver indicator

*The microphone is equipped with a built-in battery, which can be used only after being charged
The power of the receiver is supplied by phone(⑦The port is for phone charging)

How to use

Step1: Connect the receiver to the phone interface.
Step2: Press switch key of microphone, the indicator light turns bule, and then power is turned on.
Step3: After successful automatic pairing, the bule light at the receiving end is always on and the bule light at the transmitting end is always on, Then open the phone camera, live App or other Apps, and then to use the microphone to receive sound

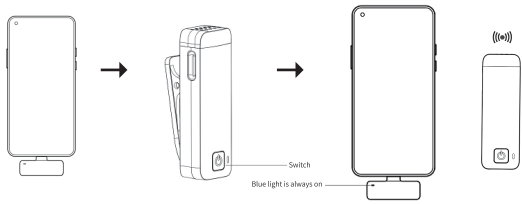

*Connect receiver to phone
*Press microphone switch key
*Use microphone

About UI

Microphone Transmitter

Function	How to use	Lighting effect
Power on	Press switch key about 3 seconds	Blue light on
Power off	Press switch key about 3 seconds	Lights out
Charging	Charging with data line	Charging red light flashes, full light off
Search for a match		Blue light flashing
Paired successfully		Blue light is always on
Noise reduction mode	Automatic noise reduction	
Low battery alarm	Battery is below 20%	red light flashing
Reset	Press and hold the power key	

Receiver

Function	How to use	Lighting effect
Power on	Plug in the device	Red Light On
Power off	Plug off the device	Light Off
Search for a match		Red light and blue light flashing
Paired successfully		Blue light is always on

Packing List

Content of packing

- (1)Microphone transmitter
(2)Receiver
(3)Charging line
(4)User manual

This device complies with Part 15 of the FCC Rules. Operation is subject to the following two conditions: (1) this device may not cause harmful interference, and (2) this device must accept any interference received, including interference that may cause undesired operation

NOTE: This equipment has been tested and found to comply with the limits for a Class B digital device, pursuant to Part 15 of the FCC Rules. These limits are designed to provide reasonable protection against harmful interference in a residential installation. This equipment generates, uses and can radiate radio frequency energy and, if not installed and used in accordance with the instructions, may cause harmful interference to radio communications. However, there is no guarantee that

interference will not occur in a particular installation.

If this equipment does cause harmful interference to radio or television reception, which can be determined by turning the equipment off and on, the user is encouraged to try to correct the interference by one or more of the following measures:

- Reorient or relocate the receiving antenna.
- Increase the separation between the equipment and receiver.
- Connect the equipment into an outlet on a circuit different from that to which the receiver is connected.
- Consult the dealer or an experienced radio/TV technician for help.

Warning: changes or modifications not expressly approved by the party responsible for compliance could void the user's authority to operate the equipment

The device has been evaluated to meet general RF exposure requirement, the device can be used in portable exposure condition without restriction