

CONTROLLER

TX-100



Hisingy

HISINGY.com

**DESIGNED BY PROS
FOR EVERYONE**

FPV MADE EASY
 **MINI DRONE**

INSTRUCTION MANUAL



reddot winner 2022
Red Dot Award: Product Design



Please read this instruction manual carefully before using this product. This instruction manual contains important information, please safekeeping.

CATALOGUE

1 About Controller

- ▲ 1.1 Key / Function of Controller
- ▲ 1.2 Controller and Aircraft Binding
- ▲ 1.3 About Device Battery
 - 1.3.1 Device Battery Installation
 - 1.3.2 Charge the Device Battery
- ▲ 1.4 Basic Flight Control

02



2 Description of Limited Warranty

12



1

ABOUT GONTROLLER

1.1 Key / Function of Controller

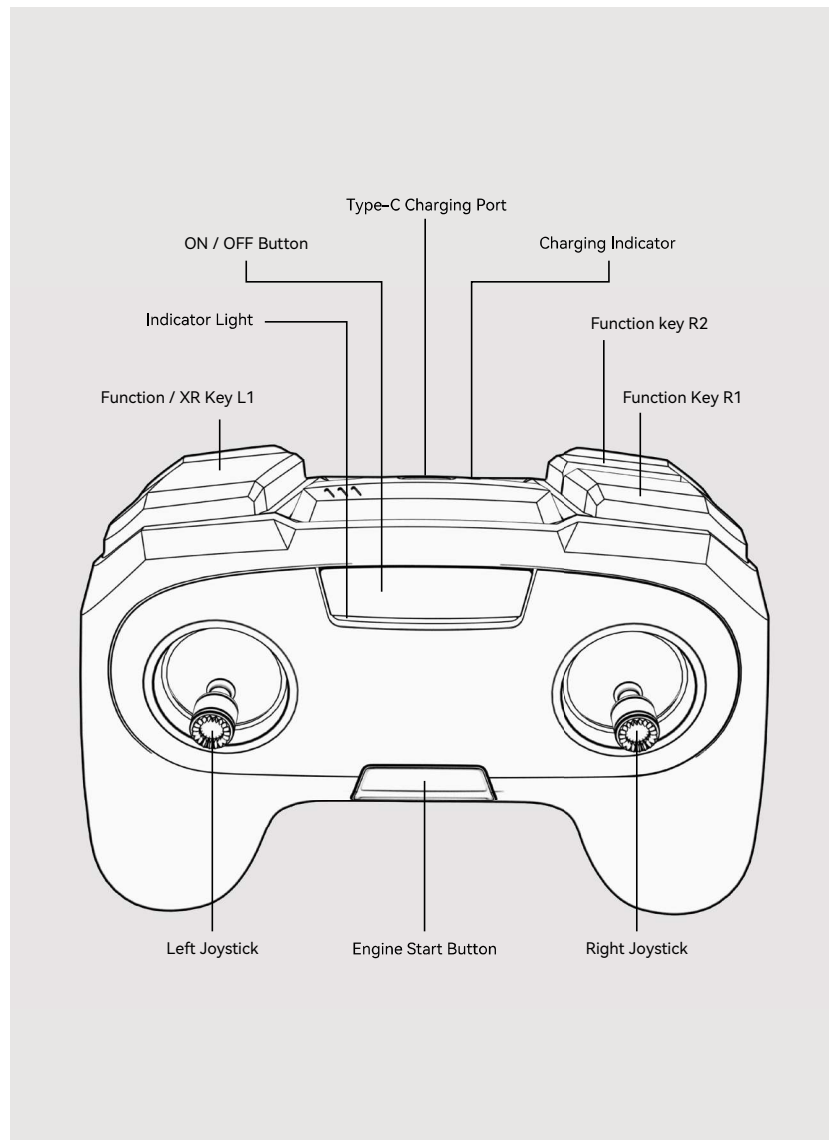

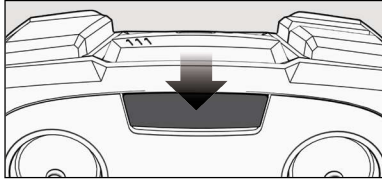

On / Off Button

Usage: Long Press

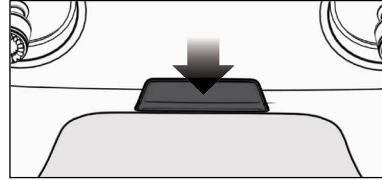

Engine Start Button

Usage: Long Press

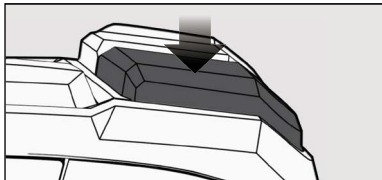

Function Key R1

Function: Flight Mode Switch

Usage: Press R1 to switch between altitude assist / sport mode

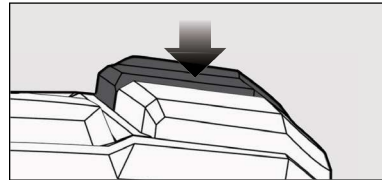

Function key R2

Function: Beacon Mode

Usage: When motors are not running, long press R2 to activate beacon mode

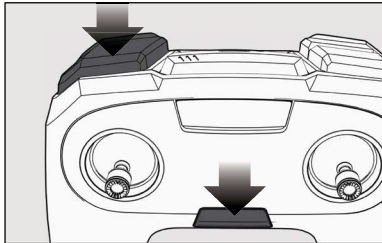

Function / XR Key L1

Features: Roll Over

Usage: Press and hold L1, then long press the engine start button to activate rescue mode. Push right joystick left and right / back and forth to roll the aircraft back on its feet.

Low battery alarm

When the battery level of the controller is lower than 20%, low battery alarm will be activated.

Charging Tips

The charging indicator LED lights up when charging, and turns off when charging is complete.

1.2 Controller and Aircraft Binding



Aircraft Operation

1. Insert the flight battery, wait for the booting process to complete, the indicator LED (at the rear of the aircraft) begins to breath alternatively in multiple colors.

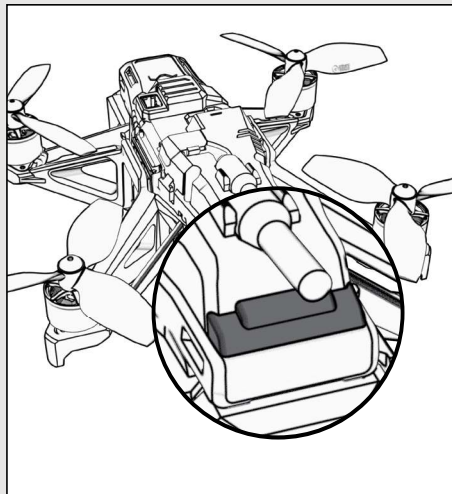
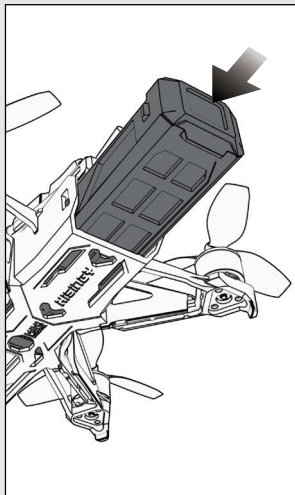

2. Long press the bind button, the indicator LED begins to flash rapidly and alternate in multiple colors.

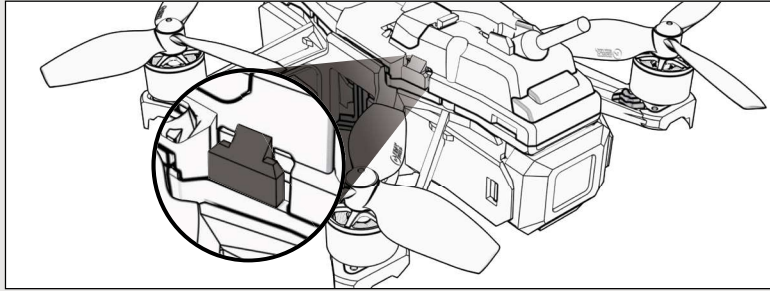

3. Once activated, the aircraft stays in bind mode for 20 seconds, then will returns to standby state after 20 seconds or a successful bind. Repeat the steps above if needed.



Controller Operation

1. Press and hold L1 while the controller is turned off, then press the on / off button to switch on the controller. Once the controller is on, binding tune will sound and the indicator light will flash continuously, indicating the controller is in bind mode.

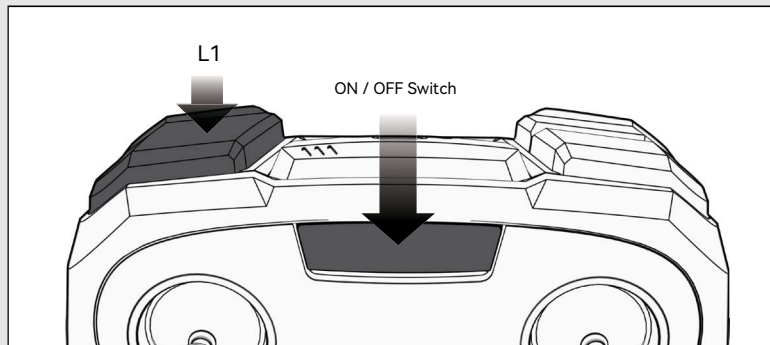

2. The indicator light becomes steady on with one short pulse of vibration when bind is complete.