



KEYSME

LUNAR 01

Connect Wired

Connect wired device with the cable, then turn the switch to the **Cable/OFF** mode.



Connect 2.4G Wireless

Connect the dongle to the device. Turn the switch to the **2.4G** mode. The indicator light will start flashing once a second when pairing. The indicator light will start flashing quickly and the light will stay on when pairing is successful.

If the pairing cannot be performed or the pairing times out, please repeat the above steps. Press **FN + *** (for 3 seconds) until pairing is successful.

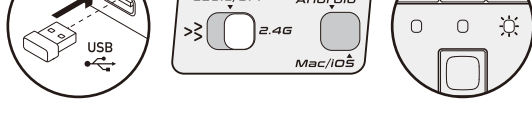

Connect Bluetooth

Turn the switch to the " >> " mode.

Bluetooth mode can connect up to three devices.

Press **FN+1**, **FN+2** and **FN+3** to switch devices.

Press **FN+1**, **FN+2** or **FN+3** (for 3 seconds) and pair with device named **KEYSME Lunar 01**.

The indicator light will light up red, green, and blue to correspond to the three channels. The indicator light flashing once a second when pairing. The indicator light flashing quickly and the light will stay on when pairing is successful.

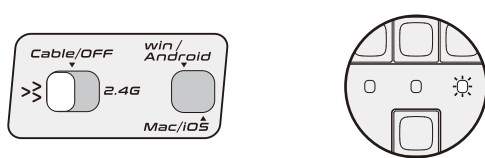

Knob Set

Press the knob once to switch the pickup lamp mode. Turn the pickup lamp on or off when press for 1 second.

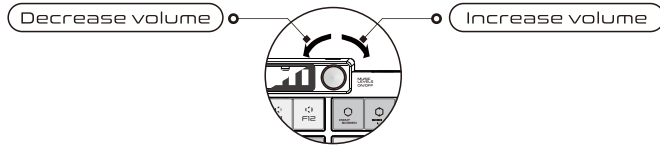

Compatibility Windows/Android

Note: some shortcuts may require system support

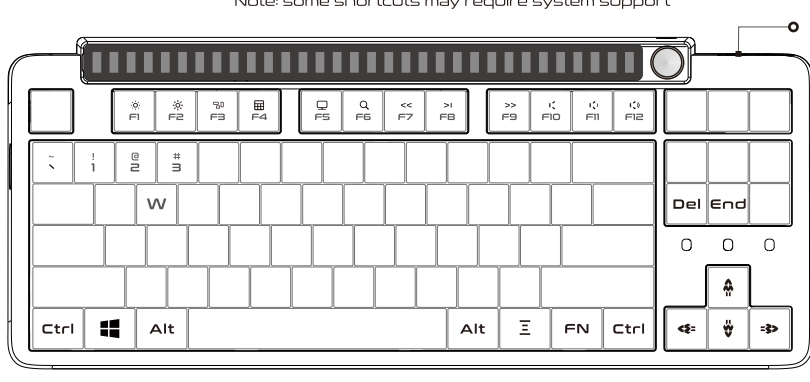

Turn the Switch to the **WIN/Android**



win/Android mode shortcuts

FN+F1 Decrease screen brightness

FN+F2 Increase screen brightness

FN+F3 Open the mission control

FN+F4 Open the explorer

FN+F5 Open the calculator

FN+F6 Open the computer window

FN+F7 Previous track

FN+F8 Play/Pause

FN+F9 Next track

FN+F10 Mute

FN+F11 Decrease volume

FN+F12 Increase volume

FN+↑ Increase back-light brightness

FN+↓ Decrease back-light brightness

FN+← Increase back-light speed

FN+→ Decrease back-light speed

FN+DEL Switch back-light mode

FN+END Switch back-light color

FN+W Interchange positions of WASD and ↑↓←→

FN+WIN The WIN key is disabled, the WIN key's light will turn off

FN+~ 2.4G Model

Press for 3 seconds and pair with 2.4G

FN+1 BT Channel 1

Press for 3 seconds and pair with BT Channel 1

FN+2 BT Channel 2

Press for 3 seconds and pair with BT Channel 2

FN+3 BT Channel 3

Press for 3 seconds and pair with BT Channel 3

Compatibility Mac/iOS

When you go to system settings > Keyboard > Use F1, F2, etc. keys as standard function keys, these functions can only be used by pressing and holding FN

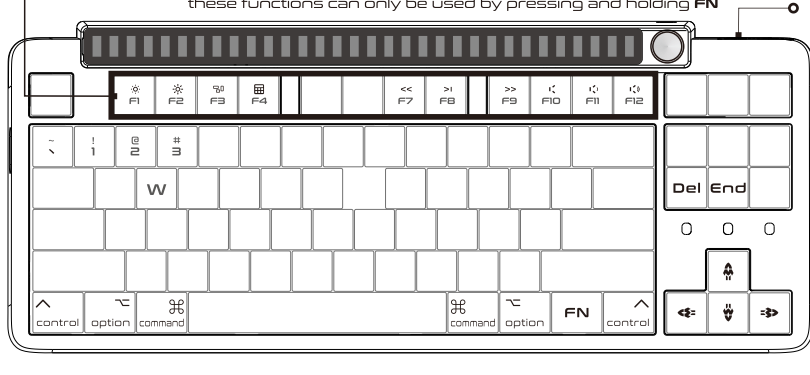

Turn the Switch to the **Mac/iOS**

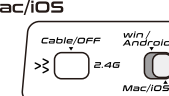

Mac/iOS mode shortcuts

FN+F1 Decrease screen brightness

FN+F2 Increase screen brightness

FN+F3 Open the mission control

FN+F4 Open the Launchpad

FN+F7 Previous track

FN+F8 Play/Pause

FN+F9 Next track

FN+F10 Mute

FN+F11 Decrease volume

FN+F12 Increase volume

FN+↑ Increase back-light brightness

FN+↓ Decrease back-light brightness

FN+← Increase back-light speed

FN+→ Decrease back-light speed

FN+DEL Switch back-light mode

FN+END Switch back-light color

FN+W Interchange positions of WASD and ↑↓←→

FN+~ 2.4G Model

Press for 3 seconds and pair with 2.4G

FN+1 BT Channel 1

Press for 3 seconds and pair with BT Channel 1

FN+2 BT Channel 2

Press for 3 seconds and pair with BT Channel 2

FN+3 BT Channel 3

Press for 3 seconds and pair with BT Channel 3

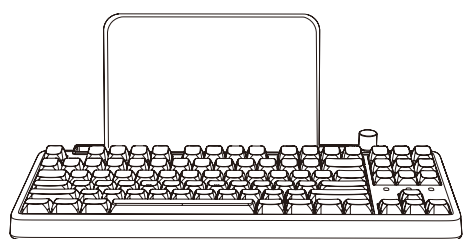
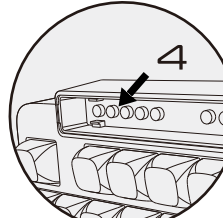
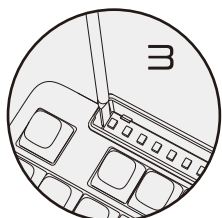
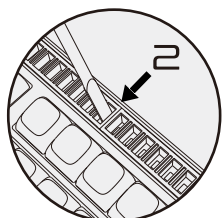
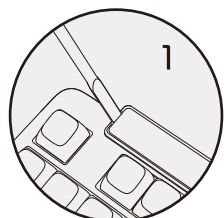

PHONE / PAD STAND MODE

Use the attached crowbar to tilt up the cover plate, body and PCBA on the pickup lamp to remove it.

Once the pickup lamp has been removed you will then be able to use a tablet or phone instead. You can also match your favorite building block toys to make your keyboard unique.

Warning: Please store the removed parts carefully, keep parts out of reach of children to prevent any accidents and choking hazards.

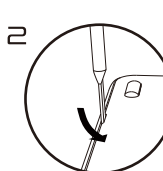
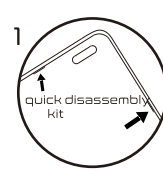
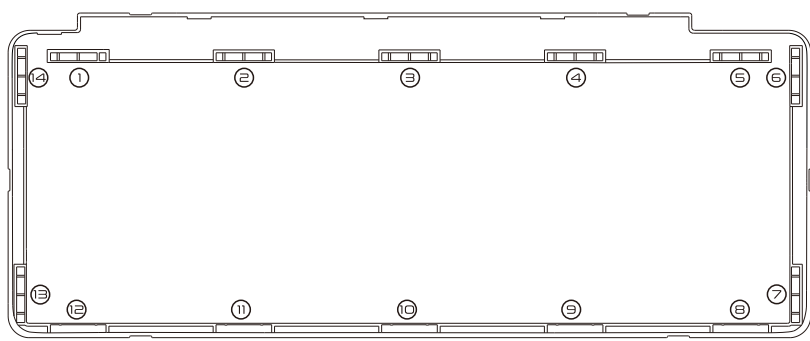

Adjust Typing feel

Place a towel on the table, place the keyboard back up on the towel, and insert the attached crowbar into the reserved quick disassembly kit, pry the shell in the direction as shown in the figure and remove the bottom case.

As shown in the figure, the bottom case of the keyboard has 14 gasket slots, you can use the silicone gasket supplied in the package for replacement, or adjust the quantity and position of the gasket to obtain the desired elastic feel.

Warning: Please store the removed parts carefully, keep parts out of reach of children to prevent any accidents and choking hazards.

Battery & Charging

This keyboard contains two lithium batteries, total capacity 4000mAh/3.7V/14.8Wh.

It can be charged when the keyboard is connected to the powered on device with a cable. Use USB3.0 or 5V/2A DC adapter for charging speed up.

When using 5V/2A DC adapter, the keyboard is expected to take 7 hours to be fully charged.

Note: this product supports up to 5V charging voltage and 2A charging current, and it must be charged with a DC power. We are not responsible for any problems caused by improper charging.

Indicator light is blinking during charging, the indicator light lights on when the battery is not charged.

The indicator light lights **Green** when high battery.

The indicator light lights **Orange** when middle battery.

The indicator light lights **Red** when low battery.

The indicator light lights on **Blue** after being fully charged.



Travel NOTE: In some special security inspection occasions (such as airports), please turn the keyboard to the **Cable/OFF** mode and do not connect the cable. It is recommended to carry this manual together to inform relevant security personnel. Please ask the local staff if you can check in or take the keyboard with you when you fly.

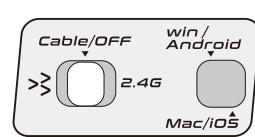

Battery saver

When keyboard connects device with the cable, it won't enter into battery saver mode.

When keyboard connects device with 2.4G wireless or bluetooth, it will enter into battery saver mode:

1. When keyboard is inactive for 10 minutes.

2. After sleep / shutdown of the device connected to the keyboard.

3. Keyboard disconnected from device.

You can tap any button to wake the keyboard.

Remap keys and macro

Please download software running on windows from www.keysme.com.

Factory reset

Press and hold **Fn + M + K** for 3 seconds.

Wireless transmission

It is not recommended that use the keyboard more than 10 meters from the device. There are metal frame objects between the keyboard and the device, blocked by walls, or the keyboard is resting on the metal surface, which may affect the signal effect.

It is recommended to use **Cable/OFF** mode or **2.4G** mode for games. The polling rate of Cable and 2.4G wireless mode connection is 1000Hz, this may add your gaming experience.

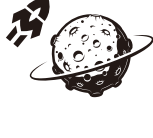

FCC Warning:

This equipment has been tested and found to comply with the limits for a Class B digital device, pursuant to part 15 of the FCC Rules. These limits are designed to provide reasonable protection against harmful interference in a residential installation. This equipment generates, uses and can radiate radio frequency energy and, if not installed and used in accordance with the instructions, may cause harmful interference to radio communications. However, there is no guarantee that interference will not occur in a particular installation. If this equipment does cause harmful interference to radio or television reception, which can be determined by turning the equipment off and on, the user is encouraged to try to correct the interference by one or more of the following measures:

- Reorient or relocate the receiving antenna.
- Increase the separation between the equipment and receiver.
- Connect the equipment into an outlet on a circuit different from that to which the receiver is connected.
- Consult the dealer or an experienced radio/TV technician for help.

Caution: Any changes or modifications to this device not explicitly approved by manufacturer could void your authority to operate this equipment.

This device complies with part 15 of the FCC Rules. Operation is subject to the following two conditions:

(1) This device may not cause harmful interference, and (2) this device must accept any interference received, including interference that may cause undesired operation.

This equipment complies with FCC radiation exposure limits set forth for an uncontrolled environment. This equipment should be installed and operated with minimum distance 0cm between the radiator and your body.