

**Solution SCA SA**

**ul. Gen. W. Sikorskiego 119**

**05-080 Klaudyn**

**POLAND**

**USER MANUAL  
MULTIMEDIA DISPLAY CALLED  
ONE TO ONE**



Instruction Original	User manual Multimedia display called ONE TO ONE	Edition 1 Page: 2/15
Device description	Multimedia display	
Device name	ONE TO ONE	
Document number	UM-OTO-02-1-PL	
Date of issue if the document	20-05-2020	
Producer	Solution SCA SA ul. Gen. W. Sikorskiego 119 05-080 Kludyn POLAND	

## 1 Spis treści



2	Device identification.....	4
2.1	Subject of the operating instructions.....	4
2.2	Declarations.....	5
3	Device Information.....	5
3.1	Intended Use .....	5
3.2	Dedicated chargers.....	6
3.2.1	Wireless connection .....	8
3.2.2	Navigation .....	9
3.3	Precautions.....	9
3.4	Basic parts of the device.....	10
3.5	Speificationa .....	11
3.6	Working conditions .....	11
3.7	Basic information about the device .....	11
3.8	Installation.....	12
4	Information on using the device .....	12
4.1	Using the device .....	12
5	Health and Safety Information .....	13
5.1	Safety instructions.....	13
5.2	Behavior in case of failure, disturbances .....	14
6	Information on storage and transport .....	14
6.1	Transport .....	14
7	Maintenance information .....	14
7.1	Display maintenance .....	14
7.2	Storage and disposal .....	14
8	FCC Instruction .....	15

### Caution



Persons operating the device are obliged to read this manual and follow the rules contained therein.

Symbols used in this manual:

Pictogram	Signal word	Definition
	DANGER	Failure to comply with the applicable rules of conduct indirectly leads to injuries along with death and serious material damage.
	CAUTION	Non-observance of the applicable rules may result in serious injuries and material damage.
	TIP	Application advice and other practical information.

## 2 Device identification

device name	ONE TO ONE
Model	OTO
Type	02
	Solution SCA SA
Producer	ul. Gen. W. Sikorskiego 119
	05-080 Klaudyn
	POLAND

### 2.1 Subject of the operating instructions

The subject of these Operating Instructions are guidelines for the operation, commissioning and operation of the multimedia display named ONE TO ONE.

(1) This device may not cause harmful interference

(2) This device must accept any interference received, including interference that may cause undesired operation.

### 1.2 Nameplate

The data plate of the device informs the service about the device model and the year of production. This makes it easier to consult the manufacturer when technical problems arise.

The plate is located on the bottom of the device housing.



## 2.2 Declarations

Solution SCA SA hereby declares that the OTO-01 radio equipment type is in compliance with the 2014/53 / EU and RoHS 2011/65 / EU Directive.

The full text of the EU declaration of conformity is available at the following internet address:  
[www.solutionsca.pl](http://www.solutionsca.pl).

## 3 Device Information

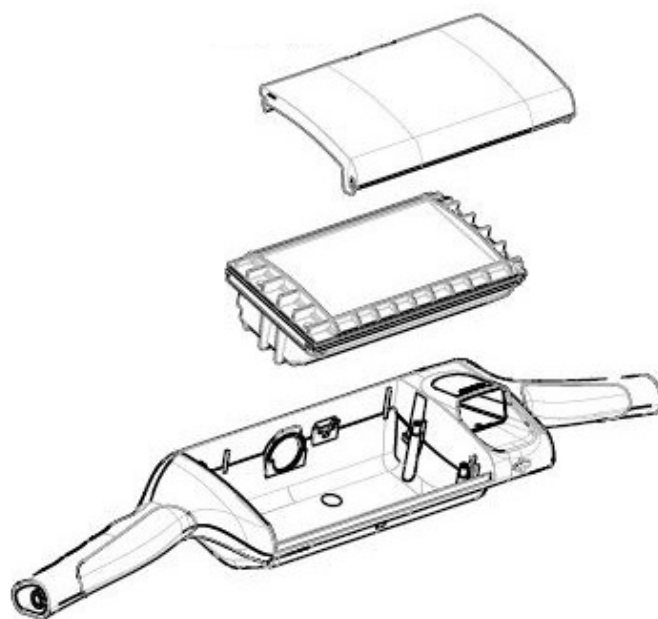

Figure 1 Display components

### 3.1 Intended Use

The multimedia display named ONE TO ONE is a portable device powered by a dedicated charging strip. It is strictly forbidden to charge displays using devices other than dedicated chargers.

Basic functions of the multimedia display named ONE TO ONE:

- Displaying multimedia messages: promotions, advertisements, multimedia shop leaflets,
- Displaying a dedicated message for holders of contactless loyalty cards \*
- Displaying multimedia messages depending on the location of the trolley in the store \*
- Collection of statistical data and automatic transfer to the Immensus system
- Automatic system for checking the status and operation of each monitor
- Advanced data security systems
- Automatic monitor location system outside the store \*

\* option

### CAUTION



Operation of the display with devices that are not dedicated to it is not allowed.

### CAUTION



The charger may only be connected to earthed sockets

## 3.2 Dedicated chargers

Only dedicated chargers provided by Solution SCA SA can be connected to the device.

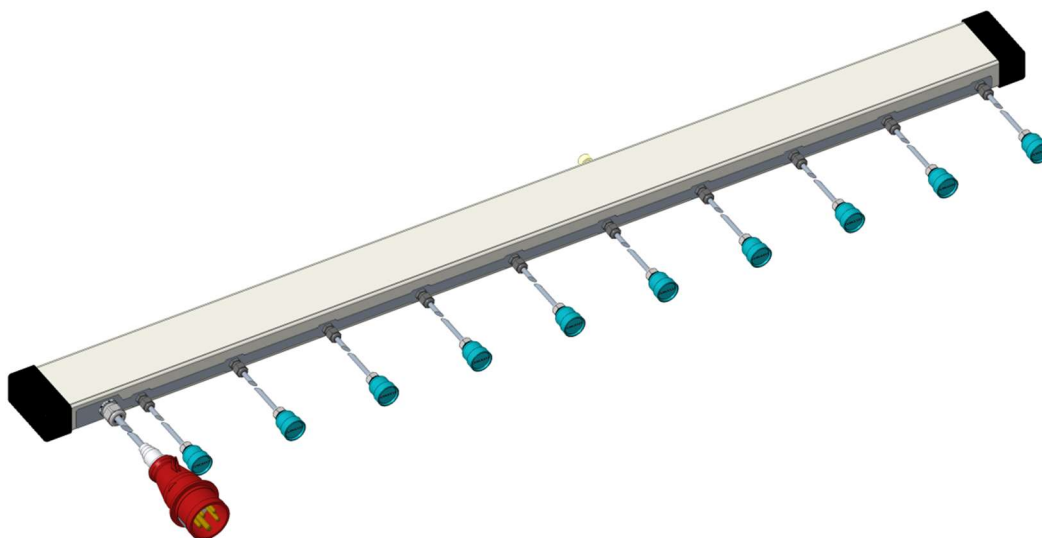

Figure 2 Dedicated charging strip



Figure 3 Single slot charger



Figure 4 Dedicated charger PS-02

### 3.2.1 Wireless connection

The Device connects wirelessly (WiFi 2.4 GHz- 802.11b/g/n) to dedicated DATAHUB without user intervention



Figure 5 DATAHUB DH-02



### 3.2.2 Navigation

Device offers coarse positioning, based on Bluetooth LE beacon transmitters. The device works on receive-only mode and position is estimated on received signals strength.



Figure 6 Beacons.

### 3.3 Precautions

- Make sure that no moisture can get inside,
- Avoid exposing the device to extremely low (below  $-20^{\circ}\text{C}$ ) and high (above  $55^{\circ}\text{C}$ ) temperatures, vibrations and large shocks, as this may damage it,
- Do not use the device after any mechanical, chemical or thermal damage, when external damage is visible, eg on the restoration, charging socket, or if there are signs of malfunction. Please contact the manufacturer first.
- In case of doubt as to the operation, safety or connection of the device, please contact the manufacturer.

In case of doubts as to the operation, safety or connection of the device, please contact the manufacturer.

### 3.4 Basic parts of the device

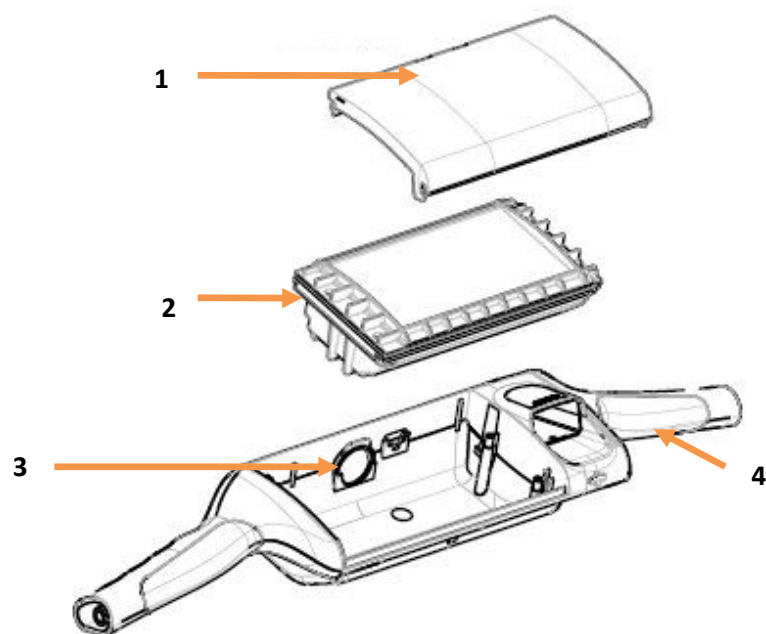

Figure 7 Basic parts of the device

1.	Housing
2.	Multimedia display
3.	Charging socket
4.	Shpping cart handle

### 3.5 Specification

Name	ONE TO ONE
Model	OTO
Type	01
Input power	Constant Current 3A (nom. 8V)
Supply voltage	Vmax=15VDC
Working temperature	-20°C/+55°C

### 3.6 Working conditions

The device is designed to work in conditions both inside and outside the building.

- The device should be attached to a stable trolley or frame,
- Ambient temperature -20 ° C / +55 ° C,
- Relative humidity 5% - 80%, non-condensing.

The device cannot be used in the following situations:

- in conditions of explosion hazard,
- in mobile, portable marine or air systems,
- in residential premises,
- in situations where the elements of the station's equipment will be exposed to extremely high temperatures.

### 3.7 Basic information about the device

The device has been designed in accordance with the requirements of the Radio Directive 2014/53 / EU (RED), the Regulation of the Minister of Labor and Social Policy of September 26, 1997 on general health and safety regulations.

Personal injuries and damage to property are possible if the device is used incorrectly.

### 3.8 Installation

Installation of the multimedia display named ONE TO ONE may only be carried out by trained and qualified personnel with particular care and diligence in the work carried out.



#### CAUTION

It is forbidden to operate the display without its proper assembly.

## 4 Information on using the device

### 4.1 Using the device

ONE TO ONE series multimedia displays are completely maintenance-free and require no user intervention. However, if the device works in a polluted environment and requires periodic cleaning of the illuminating surface, use a damp cloth to remove dirt, then wipe with a dry cloth so as not to leave moisture.

The display system is installed only by replacing the handle on the shopping cart and does not interfere with the store's infrastructure.

Correct use of the device:

- Make sure that the device is charged,
- Move the shopping cart to trigger the display operation.

Correct shutdown of the device:

- The device goes into sleep mode if it remains motionless for 30 seconds,
- The device is completely turned off when the battery is discharged.

## 5 Health and Safety Information

### 5.1 Safety instructions

- Read the operating instructions carefully before putting the display into operation.
- Keep this manual for future reference.
- If in doubt about the installation and use of the display, please contact with the manufacturer.
- The display must be installed into a shopping cart by trained personnel.
- Using the device in a way other than that described in the manual may lead to injury and void the warranty.
- It is forbidden to modify or manipulate the interior of the display.
- Do not change the characteristics of the display as it may result in electric shock or fire.
- Do not place any objects on the device.



#### CAUTION

Failure to follow the above instructions will result in the loss of warranty.



#### CAUTION

Any activities related to the multimedia display not provided for by the manufacturer and not described in the User's Manual should be considered incorrect and improper.

## 5.2 Behavior in case of failure, disturbances

If the image is not displayed on the display, make sure that:

- The device is charged

If the above condition is met and the device does not work properly, you should:

- Connect the device to the charger, wait 10 minutes.
- Switch the device on again by moving it.

If the device still does not work properly, please contact the device manufacturer.

### TIP



In the event of any interferences, stop working with the device and contact the manufacturer

## 6 Information on storage and transport

### 6.1 Transport

The multimedia display named ONE TO ONE for transport must be tightly wrapped with a "stretch" foil and placed in a packaging that protects it against mechanical damage.

## 7 Maintenance information

### 7.1 Display maintenance

The device should only be cleaned when it is disconnected from the charging strip. It is recommended to clean it with a clean, dry cotton cloth. A damp cloth can be used with stubborn dirt. It is possible to clean the device with a pressure washer - the device is tight and has a high resistance to splashing.

### 7.2 Storage and disposal

- Turn off the device,
- Disassemble the device from the shopping cart,
- Store in a dry place. Avoid the formation of condensate. Use an air dehumidifier if necessary.

When disposing of (scrapping) the device, observe the regional regulations on this matter.

## 8 FCC Instruction

### FCC Compliance Statement

This device complies with part 15 of the FCC rules. Operation is subject to the following two conditions: (1) This device may not cause harmful interference, and (2) this device must accept any interference received, including interference that may cause undesired operation.

### FCC Interference Statement

This equipment has been tested and found to comply with the limits for a Class B digital device, pursuant to part 15 of the FCC Rules. These limits are designed to provide reasonable protection against harmful interference in a residential installation. This equipment generates, uses and can

radiate radio frequency energy and, if not installed and used in accordance with the instructions, may

cause harmful interference to radio communications. However, there is no guarantee that interference

will not occur in a particular installation. If this equipment does cause harmful interference to radio or

television reception, which can be determined by turning the equipment off and on, the user is encouraged to correct the interference by one of the following measures:

- Reorient or relocate the receiving antenna.
- Increase the separation between the equipment and receiver.
- Connect the equipment into an outlet on a circuit different from which the receiver is connected. •

Consult the dealer or an experienced radio/TV technician for help.

### FCC Caution

Any changes or modifications not expressly approved by the party responsible for compliance could

void the user's authority to operate this equipment. This transmitter must not be co-located or

operating in conjunction with any other antenna or transmitter.