



# INSTRUCTION MANUAL

## Sterra Moon™ AIR PURIFIER

Thank you for supporting Sterra!

Please read the user manual carefully before use and keep it for future reference.



## CONTENTS

IMPORTANT NOTES .....	01
PRODUCT OVERVIEW .....	03
SPECIFICATIONS .....	04
INSTRUCTIONS .....	04
WIFI OPERATION .....	05
FILTER INSTALLATION .....	06
MAINTENANCE .....	08
FAQ .....	09

# IMPORTANT NOTES

Please read this manual carefully before use and keep it for future reference.

## SAFETY WARNING

1. To avoid electric shock and fire, keep the air purifier away from water or any flammable liquids.
2. Do not spray insecticide, perfume or any flammable sprays around the air purifier.
3. Before connecting the power supply, please check whether the voltage of the air purifier is consistent with the local power supply voltage.
4. The air purifier cannot replace normal ventilation, daily dust collection or range hood.
5. Ensure that the air purifier is used on a stable and horizontal surface.
6. Leave at least 30cm of space at the back and sides of the air purifier, and at least 50cm of space above the air purifier when it is in use.
7. Ensure both the filter and its cover are properly installed before using the air purifier.
8. Do not insert anything into the air inlet/outlet to prevent physical damage or trouble.

### Read and save these instructions.

This appliance has a polarized plug (one blade is wider than the other). To reduce the risk of electric shock, this plug is intended to fit in a polarized outlet only one way. If the plug does not fit fully in the outlet, reverse the plug. If it still does not fit, contact a qualified electrician. Do not attempt to ignore, bypass, or disregard this safety feature.

**WARNING:** Please unplug or disconnect the power supply before repair or open the machine

## FCC WARNING

This equipment may generate or use radio frequency energy. Changes or modifications to this equipment may cause harmful interference unless the modifications are expressly approved in the instruction manual. The user could lose the authority to operate this equipment if an unauthorized change or modification is made. This device complies with part 15 of the FCC Rules. Operation is subject to the following two conditions:

1. This device may not cause harmful interference.
2. This device must accept any interference received, including interference that may cause undesired operation.

This equipment complies with RF radiation exposure limits set forth for an uncontrolled environment. This equipment should be installed and operated with a minimum distance of 20 centimeters between the radiator and your body.

**NOTE:** This equipment has been tested and found to comply with the limits for a Class B digital device, pursuant to part 15 of the FCC Rules. These limits are designed to provide reasonable protection against harmful interference in a residential installation. This equipment generates, uses and can radiate radio frequency energy and, if not installed and used in accordance with the instructions, may cause harmful interference to radio communications. However, there is no guarantee that interference will not occur in a particular installation. If this equipment does cause harmful interference to radio or television reception, which can be determined by turning the equipment off and on, the user is encouraged to try to correct the interference by one or more of the following measures:

- Reorient or relocate the receiving antenna.
- Increase the separation between the equipment and receiver.
- Connect the equipment into an outlet on a circuit different from that to which the receiver is connected.
- Consult the dealer or an experienced radio/TV technician for help.
- The rating information is located at the bottom of the unit.

# PRODUCT OVERVIEW

## COMPONENTS

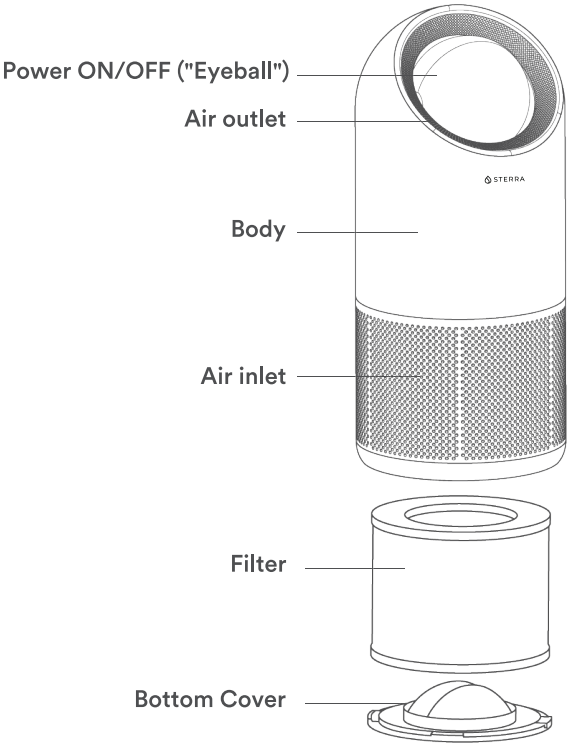

# SPECIFICATIONS

Model	Sterra Moon™
Dimensions	244x244x544mm
Weight	3.7kg
Adapter	Input DC24V 2A
Power	45W
CADR	250m³/h
Coverage area	<30m²

# INSTRUCTIONS

1. When the air purifier is connected to the power outlet and powered on, the buzzer will beep for 1 second and enters into the automatic mode. The air purifier's eyeball will move automatically according to the air quality. If the air quality is bad, the eyeball will not move automatically and the light ring in the eyeball will be red in color. However, if you use your hands to manually adjust the eyeball, the air purifier will be in manual mode and you can adjust the wind speed manually. The greater the angle of adjustment, the smaller the wind speed. Conversely, the smaller the angle of adjustment, the higher the wind speed.

The light ring displays the color according to the air quality.

- Blue - Good air quality
- Yellow - Normal air quality
- Red - Poor air quality

2. When the air purifier is in standby mode, press the Power ON/OFF button and the air purifier will enter into automatic mode as per described in point 1.
3. Once the air purifier is powered on, the UV function will automatically start.  
Turning off the UV function can only be done via the APP (applies to UV Edition only).

## WIFI OPERATION

### Download and Sign Up

1. Scan the QR code to download "Smart Life" APP. You can also search "Smart Life" in either APP store or Google Play to install the APP.
2. Open the "Smart Life" APP. Tap "Sign Up" to register a "Smart Life" account with your email address if you haven't signed up.



### Add the air purifier automatically

Make sure the air purifier is powered on and your mobile phone is connected to your WiFi network. If the WiFi indicator of the air purifier does not flash, please press and hold the center of the light ring for more than 5 seconds. The light ring will flash blue color repeatedly. You might be required to turn on your Bluetooth function too.

Click on "+" on the top right corner of the APP or "add device". Once the air purifier is detected, click "Add". Please ensure that the air purifier to be added is correct before clicking "+" beside the air purifier's name. You will be prompted to choose the WiFi network and to key in your WiFi password. Once done, please hold on while the configuration is taking place. You should receive a notification to inform you if the connection is successful or not.

If the connection is successful, you are ready to control your air purifier via the APP.

### Add the air purifier manually

If you are unable to add the air purifier automatically, you can add the air purifier manually.

Click on "+" on the top right corner of the APP or "add device". Under the section "Add Manually", scroll to "Others" found on the left hand side. Click on "Connector (Wi-Fi)". You will be prompted to confirm your WiFi network and password. Click "Next" to confirm.

Press and hold the center of the light ring on the air purifier for more than 5 seconds. The light ring will flash blue color repeatedly. You might be required to turn on your Bluetooth function too. On the APP, click "Confirm the indicator is blinking rapidly" if the indicator is blinking rapidly and follow the instructions on the APP.

Give it some time for the air purifier to be configured. Please ensure that the air purifier to be added is correct before clicking "+" beside the air purifier's name. Once done, please hold on while the configuration is taking place. You should receive a notification to inform you if the connection is successful or not.

If the connection is successful, you are ready to control your air purifier via the APP.

## FILTER INSTALLATION

### NOTICE

- Please remove the filter packaging when using for the first time.
- Ensure the air purifier is unplugged before removing or installing the filter.
- Please wipe the dust off the filter regularly. Do not wash or use it repeatedly.
- Please use the filter specially designed for this air purifier.

The steps for replacing the filter are as follows:

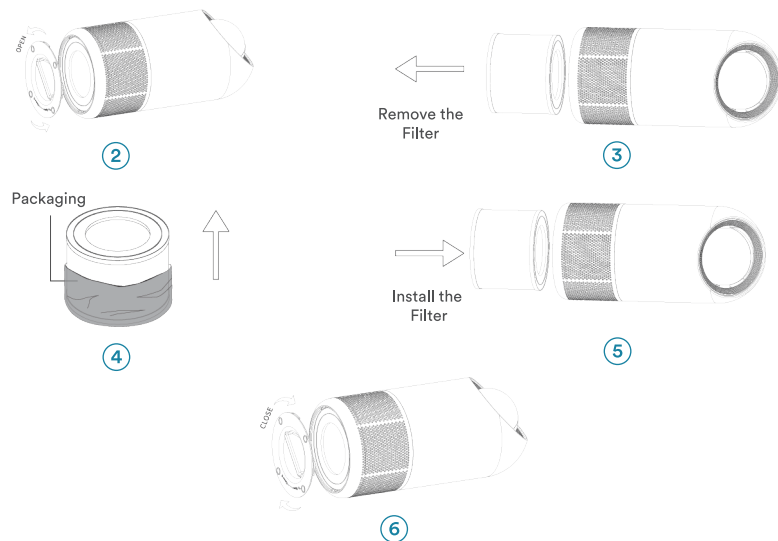

1. Power off and unplug the air purifier from the power outlet before replacing or installing the filter.
2. Invert the air purifier and turn the base cover in the direction marked as "OPEN".
3. Take the filter out of the air purifier.
4. Remove the filter packaging of a new filter.
5. Install the new filter into the air purifier.
6. Put the base cover back and turn in the direction marked "CLOSE" to tighten the cover.
7. After replacing the filter, plug the air purifier into the power outlet. Press and hold the center of the light ring for about 7 seconds to remove the red light from the power indicator.

**NOTE:** There is no need to reset the air purifier if it is the first time installing the filter.

## MAINTENANCE

### NOTE

- Ensure the air purifier is unplugged from the power source before maintenance.
- Do not immerse the air purifier into water or any liquid.
- Do not use abrasive, corrosive or flammable cleansers (e.g. bleach or alcohol) to clean the air purifier.
- Don't use a vacuum cleaner to clean the filter or wash it directly.
- Please place the filter under sunlight regularly, but do not place the filter on wet/damp surfaces.

### CLEANING

- Ensure the air purifier is switched off and unplugged from power sources.
- Remove the filter and clean the dust on the filter surface.
- Use a soft cloth with neutral cleanser to clean away any dust from the air purifier's surface and air inlet/outlet.

**NOTE:** Wipe with clean and dry cloth.

### STORAGE

- Power off and unplug the air purifier from power sources. Bundle the power cord neatly.
- Remove the filter and clean away the dust on the filter's surface.
- Use a soft cloth with neutral cleanser to clean away any dust from the air purifier's surface and air inlet/outlet.
- Once the air purifier is dry, you may put the air purifier into a bag and place it in a cool and well-ventilated place.

# FAQ

Situation	Reason
Not working	<ul style="list-style-type: none"><li>• Is it plugged into a power outlet? Is there a power outage?</li><li>• Is the home leakage switch or fuse cut off?</li><li>• Is the light ring flashing red? If yes, you might need to replace the filter.</li></ul>
Poor performance	<ul style="list-style-type: none"><li>• Is there any dust on the surface of the pre-filter?</li><li>• Is the air inlet/outlet blocked?</li></ul>
Significant noise	<ul style="list-style-type: none"><li>• Please set a lower wind speed if it is too loud or when preparing to sleep at night.</li><li>• Is there anything stuck on the fan or in the air outlet?</li><li>• Is the machine tilted?</li></ul>
Nasty smell	<ul style="list-style-type: none"><li>• It is normal for the air purifier to emit a plastic smell when used for the first few times.</li><li>• The air purifier will also emit smell if the filter is dusty. In this case, please clean or replace the filter.</li><li>• If the air purifier emits a burning smell, please switch the power off, unplug the air purifier from the power source and contact Sterra immediately.</li></ul>
Filter replacement reminder continues flashing after filter has been replaced.	<ul style="list-style-type: none"><li>• Press and hold the center of the light ring for more than 7 seconds to remove the flashing red light. The counter will resume from "0" hours.</li></ul>

**NOTICE:** If you are still unable to solve the problem and require maintenance, please contact Sterra. Please do not disassemble the air purifier and maintain it by yourself.

