

Quick Start Guide

Remote Two

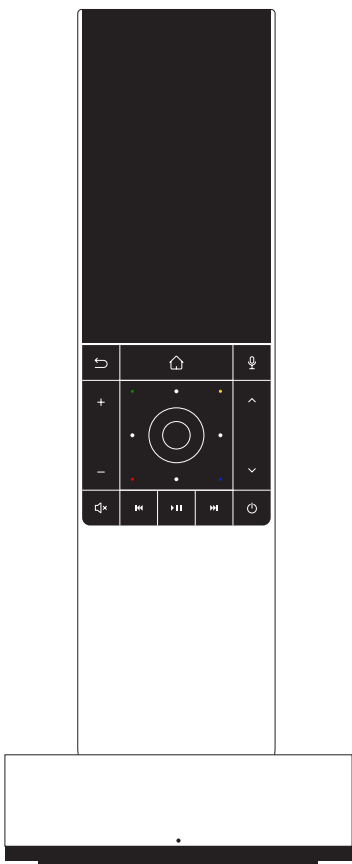

unfolded circle

What's in the box?



Remote

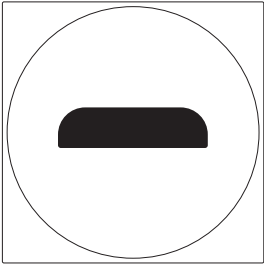

Smart Charging Dock

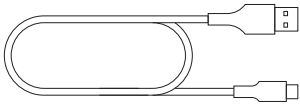

USB-C to USB-A Cable



IR Extender Cable with 2 Emitters

Initial setup

Press and hold the Power button for 2 seconds to turn on the remote and follow the instructions on the screen for initial setup.

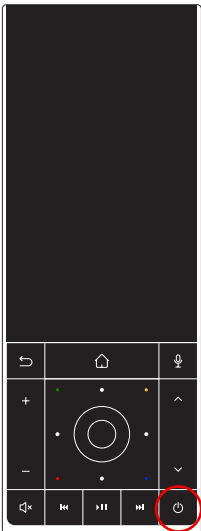

Press and hold for 2 seconds to power on

Positioning the dock

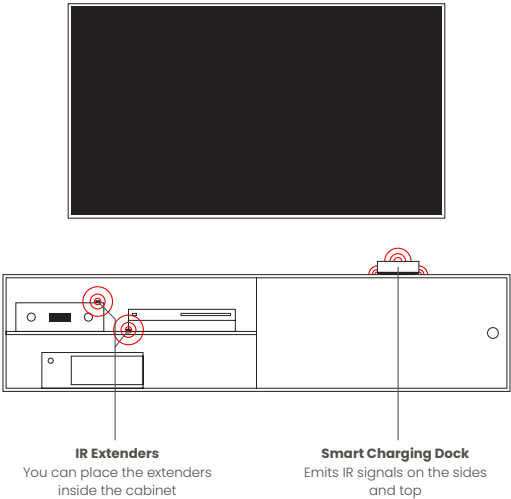

Position your Smart Charging Dock so it has an unobstructed line of sight to the IR (infrared) devices you want to control. You can use the supplied IR extender to place the emitters inside your cabinet to reach devices behind closed doors.

Charging the remote

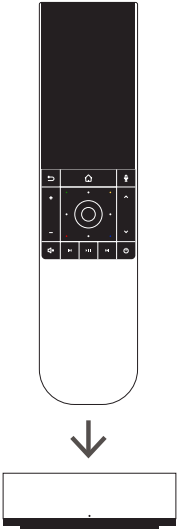

Place the remote in the dock to charge it. Internal magnets will help you guide the remote to the correct position. The status LED on the dock will light up in a breathing pattern to indicate the remote is charging.

Only use power supplies that meet the minimum requirements of the Smart Charging Dock.

Support

For more information and support, please visit
unfoldedcircle.com/support



Important



unfolded circle

ATTENTION: ALL INFORMATION IN THIS DOCUMENT CAN CHANGE WITHOUT NOTICE.

IMPORTANT: BY USING YOUR UNFOLDED CIRCLE PRODUCT YOU AGREE TO BE BOUND BY THE TERMS AND CONDITIONS.

To read these terms, please go to:
unfoldedcircle.com/legal

or scan the QR code:



English

Important safety instructions

- Read these instructions.
- Keep these instructions.
- Heed all warnings.
- Follow all instructions.
- Clean only with dry cloth. Household cleaners or solvents can damage the finish on your components.
- Install in accordance with the manufacturer's instructions.
- Do not use this product near water or expose the products to dripping or splashing of any water liquid and do not place objects filled with liquids, such as vases near or on the Unfolded Circle products.
- Do not install near any heat sources such as radiators, heat registers, stoves, or other apparatus (including amplifiers) that produce heat.
- Only use attachments/accessories and power supplies that meet the requirements specified by the manufacturer.
- Refer all servicing to qualified service personnel. Servicing is required when the apparatus has been damaged in any way, such as power-supply cord or plug is damaged, liquid has been spilled or objects have fallen into the apparatus, the apparatus has been exposed to rain or moisture, does not operate normally, or has been dropped.
- WARNING: No naked flame sources, such as lighted candles should be placed on the product.
- Using USB-C chargers of poor quality may trigger false operations during charging.
- The USB-C charger should adhere to EN 62368-1.
- The maximum length of an ethernet cable should not exceed 3 m (10 ft).
- The product is intended for indoor use in dry, domestic environments only.
- The product should only be used in enviroments with ambient temperatures between 5°C to 40°C (41°F to 104°F).
- Turn off your device in restricted areas where the use of mobile devices is prohibited.
- Always obey rules and regulations when in restricted areas, such as, in aircraft, movie theater, in hospitals or near medical equipment, near gas or fuel, construction sites, blasting sites and other areas.
- The device screen is made of glass. If the glass gets broken, stop using the device and do not touch the broken glass parts.
- Risk of explosion if a battery is replaced with an incorrect type that can defeat a safeguard (for example, in the case of some lithium battery types)
- Do not dispose of a battery into fire or a hot oven, or mechanically crush or cut a battery, because it can result in an explosion.
- Do not leave a battery in an extremely high temperature surrounding environment, because it can result in an explosion or the leakage of flammable liquid or gas.
- Do not subject a battery to extremely low air pressure because it may result in an explosion or the leakage of flammable liquid or gas.
- Do not short-circuit the battery terminals with metal items.



Unfolded Circle ApS declares that this product herewith complies with the requirements of the EMC Directive 2014/30/EU, RED Directive 2014/53/EU, RoHS Directive 2011/65/EU when installed and used in accordance with the manufacturer's instructions. A copy of the full Declaration of Conformity may be found at unfoldedcircle.com/legal/compliance

The following standards were used to assess the product:
EN 55032: 2015+A1: 2020, EN 55035: 2017+A1: 2020,
EN IEC 61000-3-2: 2019+A1: 2021, EN 61000-3-3: 2013+A2: 2021,
ETSI EN 301 489-1 V2.2.3: 2019, ETSI EN 301 489-17 V3.2.4: 2020,
ETSI EN 300328 V2.2.2: 2019, EN IEC 62311: 2020, EN 50665: 2017,
EN IEC 62368-1:2020+A1:2020

Compliance with 2014/53/EU Radio Equipment Directive (RED)
In accordance with Article 10.8(a) and 10.8(b) of the RED, the following table provides information on the frequency bands used and the maximum RF transmit power of the product for sale in the EU:

| Frequency range | Max. Transmit Power |
|-----------------|---------------------|
| 2412-2472 MHz | 7.92 dBm |
| 2402-2480 MHz | 0.05 dBm |

As a result of electrostatic discharge, the remote(UCR2) may restart and cannot return to the previous user interface state. The user needs to navigate to the previous state.



Prolonged listening at high volume levels may cause hearing damage.



The symbol means that according to local laws and regulations your product and/or its battery shall be disposed of separately from household waste. When this product reaches its end of life, take it to a collection point designated by local authorities.



Hereby, Unfolded Circle ApS declares that the radio equipment Remote Two is in compliance with Radio Equipment Regulations 2017. Full text of UKCA declaration of conformity is available at unfoldedcircle.com/legal/compliance

Fcc statement

This device complies with Part 15 of FCC Rules. Operation is subject to the following two conditions: (1) this device may not cause harmful interference, and (2) this device must accept any interference received, including interference that may cause undesired operation.

WARNING: Changes or modifications to this unit not expressly approved by the part responsible for compliance could void the user's authority to operate the equipment.

NOTE: This equipment has been tested and found to comply with the limits for a Class B digital device, pursuant to Part 15 of the FCC Rules. These limits are designed to provide reasonable protection against harmful interference in a residential installation. This equipment generates, uses and can radiate radio frequency energy and, if not installed and used in accordance with the instructions, may cause harmful interference to radio communications. However, there is no guarantee that interference will not occur in a particular installation. If this equipment does cause harmful interference to radio or television reception, which can be determined by turning the equipment off and on, the user is encouraged to try to correct the interference by one or more of the following measures:

- Reorient or relocate the receiving antenna.
- Increase the separation between the equipment and receiver.
- Connect the equipment into an outlet on a circuit different from that to which the receiver is connected.
- Consult the dealer or an experienced radio/TV technician for help.

E-label for the remote:

To access the e-label information for the Unfolded Circle Remote Two, follow the following instructions on your device:

Step 1 – Go to settings

Step 2 – About

Step 3 – Regulatory

For further FCC statements visit unfoldedcircle.com/legal/compliance

IC statement

This device complies with Industry Canada licence-exempt RSS standard(s). Operation is subject to the following two conditions: (1) this device may not cause interference, and (2) this device must accept any interference, including interference that may cause undesired operation of the device.

WARNING: Modifications not expressly approved by the manufacturer may void the user's authority to operate the equipment.

Unfolded Circle Remote Two:

This equipment has been SAR tested and conforms to the ISED portable RF exposure requirements of RSS-102 for general population/ uncontrolled exposure usage. The maximum measured body extremity SAR value is 0.88 W/Kg when placed next to the body or on hand with a minimum of 0 mm separation from the body.

E-label for the remote:

To access the e-label information for the Unfolded Circle Remote Two, follow the following instructions on your device:

Step 1 – Go to settings

Step 2 – About

Step 3 – Regulatory

For further IC statements visit unfoldedcircle.com/legal/compliance

Avis d'Industrie Canada

Le présent appareil est conforme aux CNR d'industrie Canada applicables aux appareils radio exempts de licence. L'exploitation est autorisée aux deux conditions suivantes: (1) l'appareil ne doit pas produire de brouillage; et

(2) l'utilisateur de l'appareil doit accepter brouillage radioélectrique subi même si le brouillage est susceptible d'en compromettre le fonctionnement. mauvais fonctionnement de l'appareil.

Unfolded Circle Remote Two:

Cet équipement a été testé SAR et est conforme aux exigences d'exposition aux RF portables ISED de RSS-102 pour une utilisation générale/exposition non contrôlée. La valeur DAS maximale mesurée à l'extrémité du corps est de 0,88 W/kg lorsqu'elle est placée à côté du corps ou dans la main avec une séparation minimale de 0 mm par rapport au corps.

E-label pour la télécommande :

Pour accéder aux informations de l'étiquette électronique pour le Unfolded Circle Remote Two, suivez les instructions suivantes sur votre appareil :

Étape 1 – Accédez aux paramètres

Étape 2 – À propos

Étape 3 – Réglementation

Pour d'autres déclarations d'IC, visitez
unfoldedcircle.com/legal/compliance

RF exposure information (SAR) – FCC

Unfolded Circle Remote Two:

This device meets the government's requirements for exposure to radio waves. This device is designed and manufactured not to exceed the emission limits for exposure to radio frequency (RF) energy set by the Federal Communications Commission of the U.S. Government.

The exposure standard employs a unit of measurement known as the Specific Absorption Rate, or SAR. The SAR limit set by the FCC is 1.6 W/kg. Tests for SAR are conducted using standard operating positions accepted by the FCC with the EUT transmitting at the specified power level in different channels. The highest SAR value for the device as reported to the FCC is 0.88 W/kg when placed next to the body or on hand with a minimum of 0 mm separation from the body.

The FCC has granted an Equipment Authorization for this device with all reported SAR levels evaluated as in compliance with the FCC RF exposure guidelines. SAR information on this device is on file with the FCC and can be found under the Display Grant section of www.fcc.gov/oet/ea/fccid after searching on FCC ID: 2BAA9-UCR2

Limited warranty

Unfolded Circle products marketed by Unfolded Circle ApS purchased from Unfolded Circle ApS are covered by limited warranty. For detailed information on the coverage of this limited warranty and its limited duration go to unfoldedcircle.com/legal/warranty



unfolded circle