



75mm

Wireless Charging Dock



Compatible with Kindle Paperwhite Signature Edition

Packing List

| List | Quantity |
|---------------------------|----------|
| 1. Wireless charging dock | 1PCS |
| 2. Type-C charging cable | 1PCS |
| 3. Type-C charging cable | 1PCS |
| 4. Adapter | 1PCS |

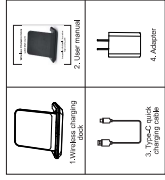

Specification

Model: W75 (W75) / W75 (ZW)
Item: Item name, Type-C

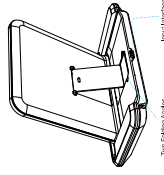

Two 4.0mm Angles

LED Indicator Light

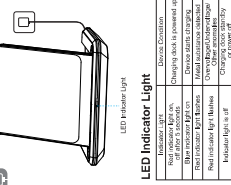

| LED STATUS | LED STATUS |
|------------------------------|-----------------------------|
| Red indicator light on | Charging dock is powered up |
| Red indicator light on | Device is fully charged |
| Red indicator light flashing | Device is not fully charged |
| Red indicator light off | Device is not fully charged |
| Red indicator light off | Device is not fully charged |

FAQ

1. When charging is not fully, please check the connection of the charging dock and the device.
2. Please make sure your device has enough power to charge.
3. Please make sure your device has enough power to charge.
4. Please make sure your device has enough power to charge.
5. Please make sure your device has enough power to charge.
6. Please make sure your device has enough power to charge.

FAQ

1. Bitte vermeiden Sie die in diese Anleitung angegebenen Fehler.
2. Bitte vermeiden Sie die in diese Anleitung angegebenen Fehler.
3. Bitte vermeiden Sie die in diese Anleitung angegebenen Fehler.
4. Bitte vermeiden Sie die in diese Anleitung angegebenen Fehler.
5. Bitte vermeiden Sie die in diese Anleitung angegebenen Fehler.
6. Bitte vermeiden Sie die in diese Anleitung angegebenen Fehler.



110mm

Kabellose Ladestation



Kompatibel mit Kindle Paperwhite Signature Edition

Packliste

| Liste | Menge |
|--------------------------|-------|
| 1. Kabellose Ladestation | 1PCS |
| 2. Type-C Ladekabel | 1PCS |
| 3. Type-C Ladekabel | 1PCS |
| 4. Adapter | 1PCS |

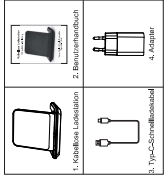

Spezifikation

Model: W75 (W75) / W75 (ZW)
Item: Item name, Type-C

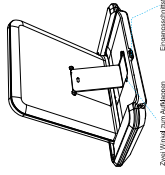

Zwei Winkel von 4,0mm

LED-Anzeigeleuchte

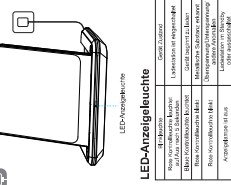

| LED STATUS | LED STATUS |
|---------------------|-------------------------------------|
| Rot leuchtend | Ladestation ist eingeschaltet |
| Rot leuchtend | Gerät ist vollständig geladen |
| Rot blinkend | Gerät ist nicht vollständig geladen |
| Rot nicht leuchtend | Gerät ist nicht vollständig geladen |
| Rot nicht leuchtend | Gerät ist nicht vollständig geladen |

FAQ

1. Wenn das Laden nicht vollständig ist, überprüfen Sie die Verbindung zwischen der Ladestation und dem Gerät.
2. Stellen Sie sicher, dass Ihr Gerät genügend Energie zum Laden hat.
3. Stellen Sie sicher, dass Ihr Gerät genügend Energie zum Laden hat.
4. Stellen Sie sicher, dass Ihr Gerät genügend Energie zum Laden hat.
5. Stellen Sie sicher, dass Ihr Gerät genügend Energie zum Laden hat.
6. Stellen Sie sicher, dass Ihr Gerät genügend Energie zum Laden hat.

FAQ

1. Bitte vermeiden Sie die in diese Anleitung angegebenen Fehler.
2. Bitte vermeiden Sie die in diese Anleitung angegebenen Fehler.
3. Bitte vermeiden Sie die in diese Anleitung angegebenen Fehler.
4. Bitte vermeiden Sie die in diese Anleitung angegebenen Fehler.
5. Bitte vermeiden Sie die in diese Anleitung angegebenen Fehler.
6. Bitte vermeiden Sie die in diese Anleitung angegebenen Fehler.



FCC Warning

This device complies with part 15 of the FCC Rules. Operation is subject to the following two conditions: (1) This device may not cause harmful interference, and (2) this device must accept any interference received, including interference that may cause undesired operation.

Any Changes or modifications not expressly approved by the party responsible for compliance could void the user's authority to operate the equipment.

Note: This equipment has been tested and found to comply with the limits for a Class B digital device, pursuant to part 15 of the FCC Rules. These limits are designed to provide reasonable protection against harmful interference in a residential installation. This equipment generates uses and can radiate radio frequency energy and, if not installed and used in accordance with the instructions, may cause harmful interference to radio communications. However, there is no guarantee that interference will not occur in a particular installation. If this equipment does cause harmful interference to radio or television reception, which can be determined by turning the equipment off and on, the user is encouraged to try to correct the interference by one or more of the following measures:

- Reorient or relocate the receiving antenna.
- Increase the separation between the equipment and receiver.
- Connect the equipment into an outlet on a circuit different from that to which the receiver is connected.
- Consult the dealer or an experienced radio/TV technician for help.

This equipment complies with FCC radiation exposure limits set forth for an uncontrolled environment. This equipment should be installed and operated with minimum distance 20cm between the radiator & your body.