

INFRARED SENSOR SWITCH INSTRUCTION MANUAL



This infrared sensor switch is applied to replace traditional or old switch panels. It can be directly installed at the place where the original switch lay. You can control the light without touch the switch. When your hand close to the switch in the range of 15cm, the light can turn on immediately.



Notes:

1. when wiring lines, please make sure the connections of L and N are completely right.
2. After installation, the protective film can be taken off.

Installation:

1. Disassemble the original switch from the wall.
2. For the infrared sensor switch, you need to take off the control part from the switch panel by a small tool.

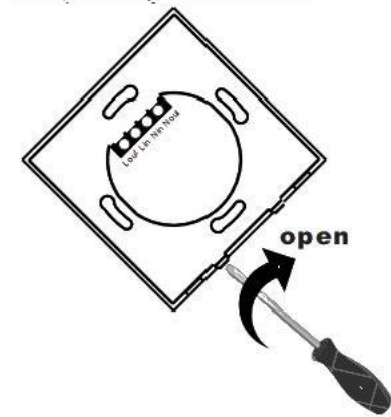

3. Loose the four screws and wire the switch with the live line and naught line.
4. Tighten the screws and fix the switch on the wall with screws in the package.
5. Cover the panel on the switch.

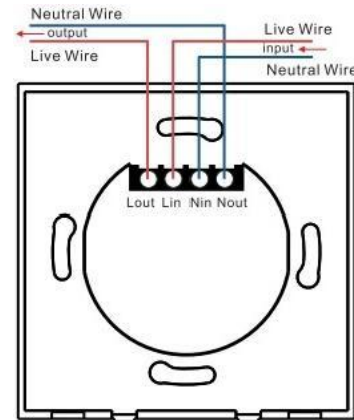

Specification:

Type	86 type(square)
Voltage	AC100-240V50/60Hz
Power Consumption	<0.05w
Rated Power	800w
Relay Output	10A
Connection	L and N lines
Infrared sensing distance	≤15cm
Material	PC+Tempered Glass
Mount Hole Distance	60mm
Indicator Light	Red for ON, Blue for OFF
Screw diameter	4mm
Installation Depth	26mm
Service Life	>20,000 times
Dimension	86x86x35mm
Weight	116g
Wireless Type	WiFi 2.4GHz

How to connect the switch to Wi-Fi network

1 Download SmartLife App

Scan the QR code to download "SmartLife" App, or search SmartLife in IOS app store or Google play. sign up for an account.



IOS&Android System

Download on the
APP Store

Get it on
Google Play

2 Connect with mobile phone

when the switch is powered on for the first time, it will automatically enter the distribution network state. After the power is turned on, the blue indicator flashes quickly, "Smart Life" App tap "+" icon on the top right corner. Follow the prompts to add devices. Once connected, the App will prompt the connection, then click "Done".

If the blue indicator light does not flash quickly after power on, you can wave your hand at the position of the switch sensor 10 times continuously, that is, the switch switches state 10 times continuously, the switch will enter the network configuration state.
(If you have added the switch to the App, this action will remove the device from the App.)

Warm Tips

"Please check whether the device is connected with power and your phone is connected with Wi-Fi."
*Check routers: If the router is dual-band router, please select a 2.4GHz network to add device.
*Check whether connected devices have reached the Maximum number router connection. If so, please try to turn off the Wi-Fi connection of some devices.
***Make sure router wireless MAC filtering function is enabled.**

FCC Caution:

This device complies with part 15 of the FCC Rules. Operation is subject to the following two conditions: (1) This device may not cause harmful interference, and (2) this device must accept any interference received, including interference that may cause undesired operation.

Any Changes or modifications not expressly approved by the party responsible for compliance could void the user's authority to operate the equipment.

Note: This equipment has been tested and found to comply with the limits for a Class B digital device, pursuant to part 15 of the FCC Rules. These limits are designed to provide reasonable protection against harmful interference in a residential installation. This equipment generates uses and can radiate radio frequency energy and, if not installed and used in accordance with the instructions, may cause harmful interference to radio communications. However, there is no guarantee that interference will not occur in a particular installation. If this equipment does cause harmful interference to radio or television reception, which can be determined by turning the equipment off and on, the user is encouraged to try to correct the interference by one or more of the following measures:

- Reorient or relocate the receiving antenna.
- Increase the separation between the equipment and receiver.
- Connect the equipment into an outlet on a circuit different from that to which the receiver is connected.
- Consult the dealer or an experienced radio/TV technician for help.

The device has been evaluated to meet general RF exposure requirement.