

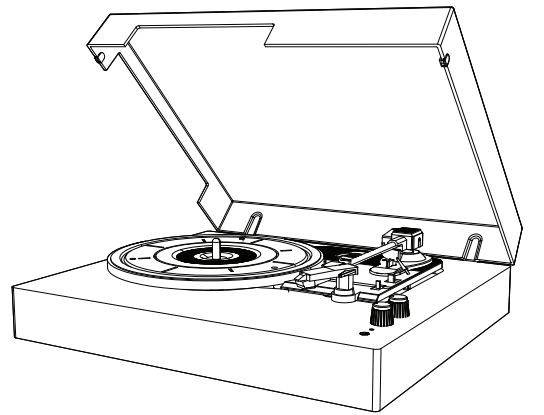

with Bluetooth and USB Encoding



Model: E300

USER MANUAL

## TURNTABLE PARTS

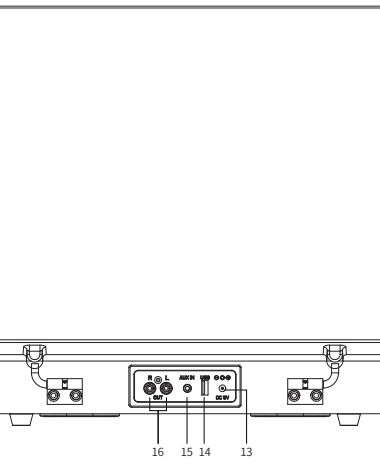
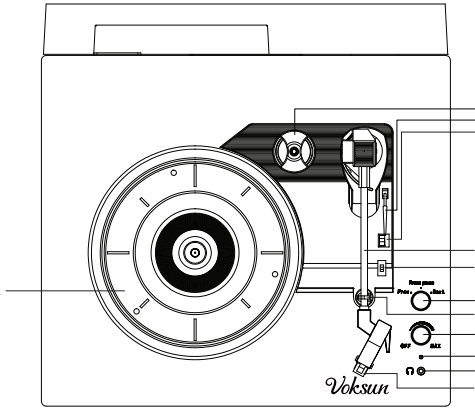

- 1 45RPM adaptor
- 2 Lift lever
- 3 PREV/NEXT button/Mode switching (Switch to BT/PH/AUX/USB when the rotation phase is greater than a second)
- 4 Volume + / switch / volume -
- 5 Status indicator
- 6 Headphone port—to connect headphone or earphone to enjoy music
- 7 AUTO-STOP ON/OFF switch
- 8 Speed switch
- 9 Tonearm
- 10 Tonearm lock
- 11 Cartridge with needle
- 12 Platter
- 13 DC IN jack—to connect the power adaptor
- 14 USB port
- 15 Line in(AUX IN) port
- 16 RCA out port—to connect external speaker system with built-in amplifier

## BEFORE USE

1. Choose a safe location and avoid placing the unit in direct sunlight or near any heat source.
2. Avoid locations subject to vibrations, excessive dust, cold or moisture.
3. Do not open the cabinet as this may result in electrical shock. If a foreign object is inserted accidentally contact your dealer.
4. Do not attempt to clean the unit with chemical solvents as this might damage the finishing. A clean, dry cloth is recommended for cleaning.
5. Keep this manual for future reference.

## PARAMETER SPECIFICATION

Product model	E300	Bluetooth	V 5.0
input voltage	AC100V~240V 50/60HZ	Play mode	PH/USB/ Bluetooth/AUX
Power Adapter	DC5V/1.0A	Rotational speed	33/45/78 RPM
Product size	35*30*10.5 cm	Record size	7/10/12
Product weight	2.3 kg	Power cord length	1 m

## GETTING STARTED

1. Firmly and securely insert the DC plug of the adaptor to the DC IN Jack on the unit.

2. Insert the adaptor' s AC plugs into a power outlet.

## BLUETOOTH MODE

1. Turn on the power switch knob. Device enter into Bluetooth mode automatically ( USB,AUX IN ports are not occupied ) The status indicator will become blue with flashing.
  2. Turn on the Bluetooth function on your mobile phone or tablet PC and search device name VOKSUN. After pairing and connecting, the indicator will become blue without flashing, then you can play your music from your mobile phone or tablet PC through this turntable player.
- Turn the VOLUME CONTROL KNOB to adjust the volume. The mobile phone or tablet PC's volume control also impact the overall volume level. Please adjust that as well if necessary.

## PHONO MODE

1. Turn on the power switch knob.
2. Place a record on the turntable platter and select the desired speed (33/45/78) according to the record. NOTE: when playing a 45RPM record, use the included 45RPM adaptor located in the holder near the tonearm.
3. Remove the white needle protector and open the tonearm clip to release the tonearm. Push the lift lever backward to raise the tonearm and gently move the tonearm towards the desired position over the record. Push the lift lever forward to lower the tonearm slowly onto the desired position on the record, device enter into PHONO mode automatically .
4. If the AUTO STOP ON/OFF Switch is turned ON, the record will stop playing automatically when finished (For a few vinyl records, it will stop when it does not come to the end OR it will not stop when it comes to the end). If Auto Stop Control is turned OFF, record will NOT stop playing automatically when finished.
5. Vinyl-to-Digital Recording: First please make sure your USB flash drive's format is FAT32. In phono mode, and insert a USB drive into the USB port. Place a record and start to play. Press the PREV/PAUSE/NEXT button till the status indicator becomes red flashing. The vinyl recording starts. Press the PREV/PAUSE/NEXT button till the status indicator stops flashing when you want to stop the recording. An audio file is created. Then power off the record player and remove the USB drive.

**Notice : PHONO mode is the highest precedence , must stop PHONO mode to switch into BT,AUX, USB mode.**

## USB PLAYBACK MODE

1. Turn on the power switch knob. Insert your USB drive into the USB port. Device enter into

USB mode automatically ,The status indicator will become blue .

2.The USB playback mode is on and it will automatically start to play the audio files in your USB drive. Press the PREV/PAUSE/NEXT button to pause or restart the playing. Switch the PREV/PAUSE/NEXT button towards NEXT position for next song, and towards the PREV position for previous song.

## LINE-IN MODE

1. Turn on the power switch knob. AUX IN mode is precedence after plug in, plug 3.5mm Audio cable, Device enter into AUX IN mode automatically.
2. You can enjoy the music from iPod, MP3 player, mobile phones etc. through the record player.
3. Turn the VOLUME CONTROL KNOB to adjust the volume. The iPod, MP3 player, mobile phones' volume control also impact the overall volume level. Please adjust that as well if necessary.

## AMPLIFIER CONNECTION (IF REQUIRED)

Whilst you can listen to your new turntable using the built-in speakers, you may wish to connect it to your existing Hi-Fi system. Connect the audio plugs to the Line input on your mixer or amplifier using an RCA cable (not supplied).

- Red plug into R/H channel input.
- White plug into L/H channel input.

## HOW TO REPLACE THE NEEDLE

To replace the needle, please refer to the instructions below.

### Removing the needle from the cartridge:

1. Place a screwdriver at the tip of the stylus and push downward as shown in direction "A".
2. Remove the stylus by pulling the stylus forward and pushing downward.

### Installing the Stylus:

1. Hold the tip of the stylus and insert the stylus by pressing as shown in direction "B".
2. Push the stylus upward as in direction "C" until the stylus locks into the tip position.

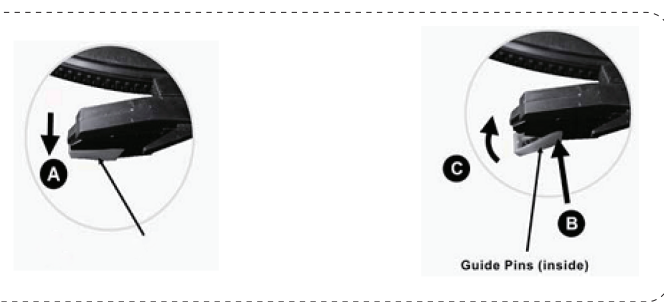

## NOTES

1. We advise you to clean your records with an anti-static cloth to gain maximum enjoyment from them.
2. We would also point out that for the same reason your stylus should be replaced periodically (approximately every 250 hours).

## TIPS FOR BETTER TURNTABLE PERF-OR MANCE

1. When opening or closing the turntable cover, handle it gently, gripping it either at the centre or at each side.
2. Do not touch the needle tip with your fingers, avoid bumping the needle against the turntable platter or record edge.
3. Frequently clean the needle tip-use a soft brush in a "back-to-front" motion only.
4. If you must use a needle cleaning fluid, use very sparingly.
5. Gently wipe the turntable player housing with a soft cloth. Use only a small amount of mild detergent to clean the turntable player.
6. Never apply harsh chemicals or solvents to any part of the turntable system.

## FCC WARNING

This device complies with part 15 of the FCC Rules. Operation is subject to the following two conditions: (1) this device may not cause harmful interference, and (2) this device must accept any interference received, including interference that may cause undesired operation. Any changes or modifications not expressly approved by the party responsible for compliance could void the user's authority to operate the equipment.

NOTE: This equipment has been tested and found to comply with the limits for a Class B digital device, pursuant to Part 15 of the FCC Rules. These limits are designed to provide reasonable protection against harmful interference in a residential installation. This equipment generates, uses and can radiate radio frequency energy and, if not installed and used in accordance with the instructions, may cause harmful interference to radio communications.

However, there is no guarantee that interference will not occur in a particular installation. If this equipment does cause harmful interference to radio or television reception, which can be determined by turning the equipment off and on, the user is encouraged to try to correct the interference by one or more of the following measures:

- Reorient or relocate the receiving antenna.
  - Increase the separation between the equipment and receiver.
  - Connect the equipment into an outlet on a circuit different from that to which the receiver is connected.
  - Consult the dealer or an experienced radio/TV technician for help.
- To maintain compliance with FCC's RF Exposure guidelines, This equipment should be installed and operated with minimum distance between 20cm the radiator your body: Use only the supplied antenna.