

## Chac

### Magnetic Wireless Charger

ADVQ-T8



## User Safety Manual

1. Avoid using excessive force when screwing. It might break the blades of the air vent.
2. Do not disassemble.
3. Keep this product away from fire or water.
4. Do not place the product too close to the objects' magnetic chips/strips (like credit cards, IC, etc) to avoid failure or malfunction of the product.
5. Installation instruction

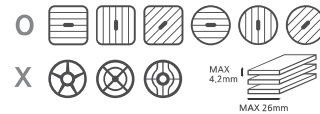
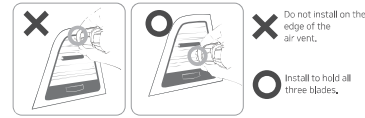

- ※ Do not place the product too close to the objects' magnetic chips/strips (like credit cards, IC, etc) to avoid failure or malfunction of the product.

## Product Warranty

### Product Service

We offer a warranty for this product as stated below. This service is offered at the customer service center or where you purchased the product. Notice of compensation and details will be offered within 7 days from the date of notification, and damage compensation will be offered within 14 days from the date of notification.

Product	Fast Wireless Charger	Date of purchase	. .
Model NO.	ADVQ-T8	Functionality	

### Complimentary Service

Within warranty period (6months)	Functional defects with normal uses within 10 days of purchase
	Functional defects with normal uses within 1 month of purchase
	Product defects
	Missing parts
After warranty period	Unable to exchange the product
	Once your warranty expires, it'll be up to you to pay for repairs.

### Paid Service

#### >In case of failure due to consumer's negligence

- In the event of damage due to negligence of the consumer's handling, incorrect repair or modification
- In the event of using incorrect electric voltage
- In case of repairing from 3rd party repair center
- In case of damage due to external impact or dropping
- In case of damage due to using consumables not specified from Mdfit.
- Failure to comply with the product manuals and instructions

Chac

## Magnetic Wireless Charger

### Chac Magnetic Fast Wireless Charger

#### Product Manual



- Read the product manual before using the product.
- We are not responsible for any damage from failure to comply with the product manual and instructions.

## Product Component Information

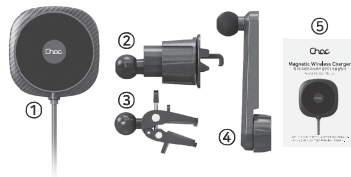

- ① Chac fast wireless charger
- ② Dual locking air vent mount
- ③ Clamp type air vent mount
- ④ Swing bar
- ⑤ Product manual

## 제품 사양

- Input : 5V 2A / 9V 2A / 12V 1.5A
- Output : 5W / 7.5W / 10W / 15W(MAX)
- Cable length : 1.2M

#### ※ Adapter recommendation

- We recommend using a car charger with QC 3.0 or above, which is compatible with fast charging.
- USB port from the vehicle or lower power charger might cause malfunction of the product.

## Product

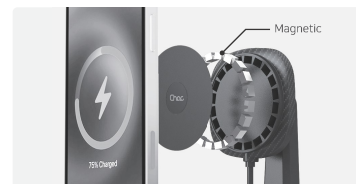

## Product Assembly Instruction

### # Assemble Order

1. Joint the Swing bar and the air vent mount (either the dual-locking type or clamp type)
2. Joint Chac fast wireless charger with the assembled Swing bar

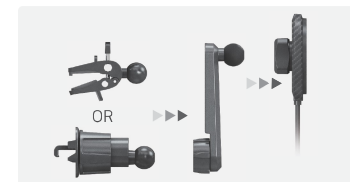

### # Other Assemble

> Assemble per your needs



## Mounting Instruction

### # Dual Locking Air Vent Mount

1. Unscrew the air vent mount.



2. Slide the hook into the gap of the air vent wings. The mount is installed by the springs, (primary fixation)



3. Tighten the screw for a sturdy installation, (Secondary fixation)



### # Clamp type Air Vent Mount

1. Adjust the clamps and slide the hook into the gap of the air vent wings.



2. Tighten the screw for a sturdy installation.



#### FCC Statement:

This device complies with Part 15 of the FCC rules. Operation is subject to the following two conditions: 1) this device may not cause harmful interference, and 2) this device must accept any interference received, including interference that may cause undesired operation.

Note: This equipment has been tested and found to comply with the limits for a Class B digital device, pursuant to part 15 of the FCC Rules. These limits are designed to provide reasonable protection against harmful interference in a residential installation. This equipment generates uses and can radiate radio frequency energy and, if not installed and used in accordance with the instructions, may cause harmful interference to radio communications. However, there is no guarantee that interference will not occur in particular installation. If this equipment does cause harmful interference to radio or television reception, which can be determined by turning the equipment off and on, the user is encouraged to try to correct the interference by one or more of the following measures:

- Reorient or relocate the receiving antenna.
  - Increase the separation between the equipment and receiver.
  - Connect the equipment into an outlet on a circuit different from that to which the receiver is connected.
  - Consult the dealer or an experienced radio/TV technician for help.
- Changes or modifications not expressly approved by the party responsible for compliance could void the user's authority to operate the equipment.

#### Radiation Exposure Statement

This device complies with FCC RF radiation exposure limits set forth for an uncontrolled environment. This transmitter must not be co-located or operating in conjunction with any other antenna or transmitter. During the operation of device a distance of 15 cm surrounding the device and 20 cm above the top surface of the device must be respected.