

**mpw**

## Outdoor Bullet Cam Quick Guide

MI-3021

# Warning

## FCC

This device complies with part 15 of the FCC Rules. Operation is subject to the condition that this device does not cause harmful interference (1) this device may not cause harmful interference, and (2) this device must accept any interference received, including interference that may cause undesired operation.

Any changes or modifications not expressly approved by the party responsible for compliance could void the user's authority to operate the equipment.

NOTE: This equipment has been tested and found to comply with the limits for a Class B digital device, pursuant to Part 15 of the FCC Rules. These limits are designed to provide reasonable protection against harmful interference in a residential installation. This equipment generates, uses and can radiate radio frequency energy and, if not installed and used in accordance with the instructions, may cause harmful interference to radio communications. However, there is no guarantee that interference will not occur in a particular installation.

If this equipment does cause harmful interference to radio or television reception, which can be determined by turning the equipment off and on, the user is encouraged to try to correct the interference by one or more of the following measures:

- Reorient or relocate the receiving antenna.
- Increase the separation between the equipment and receiver.
- Connect the equipment into an outlet on a circuit different from that to which the receiver is connected.
- Consult the dealer or an experienced radio/TV technician for help.

The antennas used for this transmitter must be installed to provide a separation distance of at least 20 cm from all persons and must not be co-located for operating in conjunction with any other antenna or transmitter.

**FCC ID: 2AZO6MI-3021**

## CE RED

This product can be used across EU member states.

## RF Specification:

Function	Operation Frequency	Max RF Output Power	Limit
Wi-Fi	802.11b/g/n(20MHz): 2412~2472MHz; 802.11n(40MHz):2422~2462MHz	13.75 dBm	20 dBm

### EU Declaration of Conformity

We,  
Shenzhen Baishihao Electronic Technology Co., Ltd. (Room 202, No. 6, 5th Alley, Xiangjiaotang New Village, Xiangjiaotang Community, Bantian Street, Longgang District, Shenzhen District, Shenzhen, China, 518057) hereby declares that this Outdoor Bullet Cam is in compliance with the essential requirements and other relevant provisions of Directive 2014/53/EU. According to Article 10(2) of Directive 2014/53/EU, the Outdoor Bullet Cam can be used in Europe without restriction.

#### Warning:

1. Adapter shall be installed near the equipment and shall be easily accessible.
2. Operation temperature:-10~50 °C .
3. The plug considered as disconnect device of adapter.
4. Accessories information:

Adapter JF012WR-1200100VH

Input: 100-240V~50/60Hz 0.35A

Output: 12V1.0A

We,  
According to Article 10(2) of Directive 2014/53/EU, the MI-3021 can be used in Europe without restriction.

The full text of the EU declaration DOC is available at the following:

Visit the Web site <https://www.mpwsafe.com>

# Catalogue

1. What's In The Box	P. 1
2. Camera Structure	P. 2
3. Insert Micro SD Card	P. 3
4. Read Before Installing	P. 4
5. Set Up With SafeMiraie App	P. 5
6. Installation	P. 6-10
7. Status Light	P. 11
8. Protect Plan	P. 12

# What's In The Box

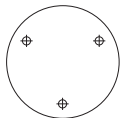

Drilling Template

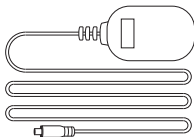

Power Adapter



Weatherproof Tube



Quick Guide



X 3

Mounting Screws



X 3

Anchors

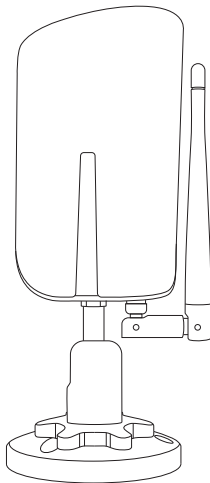

Outdoor Bullet Cam

# Camera Structure

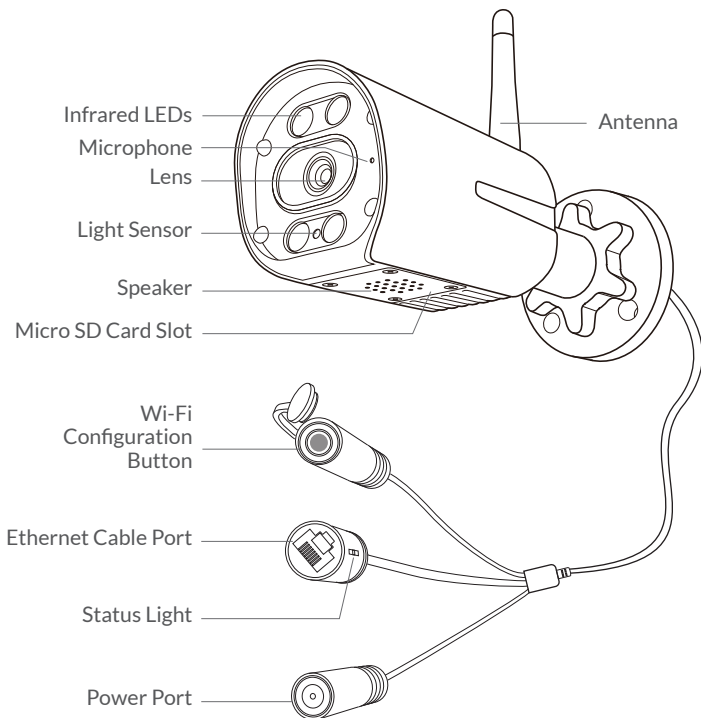

# Insert Micro SD Card

This camera comes with a built-in card slot which supports up to 128GB Micro SD card. Once you insert the storage card, the camera will automatically start to record and store videos on the storage card. You can view those videos in the 'Replay' page by clicking the 'Replay' button in the 'Homepage'.

**Step 1:** Loosen the screws. Take off the cover gently since wires are attaching to it.

**Step 2:** Insert Micro SD card. Make sure you insert it in the correct direction.

**Step 3:** Put the cover back and tighten the screws.

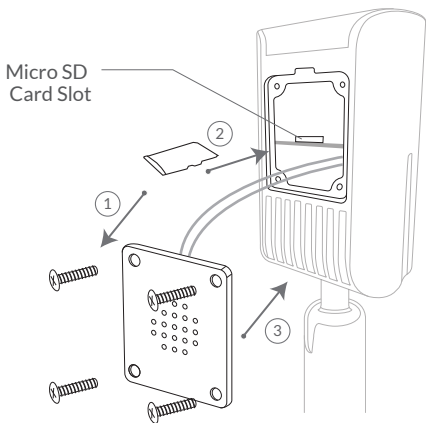

# Read Before Installing

1. Keep the Outdoor Bullet Cam and all accessories out of reach of children and pets.
2. Power supply voltage that is required to operate Outdoor Bullet Cam should be DC12V ( $\geq 1000\text{mA}$ ).
3. The product can only be used in proper temperature and humidity:  
Operating temperature:  $-10^{\circ}\text{C}$  -  $50^{\circ}\text{C}$  ( $14^{\circ}\text{F}$ - $122^{\circ}\text{F}$ )  
Operating humidity: 0-95%.
4. Please do not expose the camera lens to direct sunlight.
5. Please do not install the camera to the place that is likely struck by lightning.

## Note:

1. This camera only works with 2.4GHz Wi-Fi.
2. Strong lights may interfere with the ability to scan the QR code.
3. Avoid placing the device behind furniture or near microwaves.  
Try to keep it within range of your Wi-Fi signal.



# Set Up with SafeMiraie App



Download the SafeMiraie App from App Store or Google Play. Follow the in-app instruction to complete the entire set up process.

# Installation

Check following things before you starting to drill holes on your wall:

1. This camera has been successfully added to your Safemiraie App and is able to stream video.
2. Have planned the cable route. Measured the length of the power cable and ethernet cable (if you plan to use ethernet connection) you will need.

## Step 1:

Find a good installation spot.

- We recommend installing the Outdoor Bullet Cam just 7-10 feet (2-3 meter) above the ground for a better two-way audio experience.
- There is a power outlet nearby.
- Test whether Outdoor Bullet Cam can stream video smoothly at the spot.
- Make sure nothing blocks the camera's sight.

## Step 2:

Before you start to drill, make sure you know the locations of wall-in pipes and electrical wires. (If you are not comfortable with drilling holes, please consult with a licensed electrician)

① Use the provided drilling template to mark the position of holes on your wall. Use drill bit (15/64", 6mm) to drill three holes.

② Install anchors to hold screws.

Skip ① ② if you are installing camera on wood.

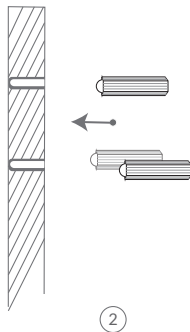
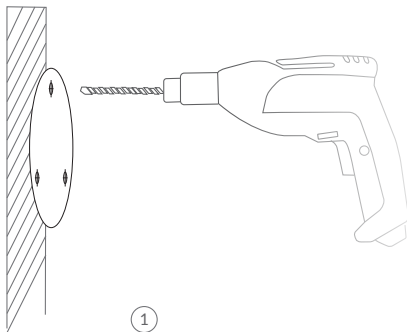

③ Tighten the provided screws to secure the camera.

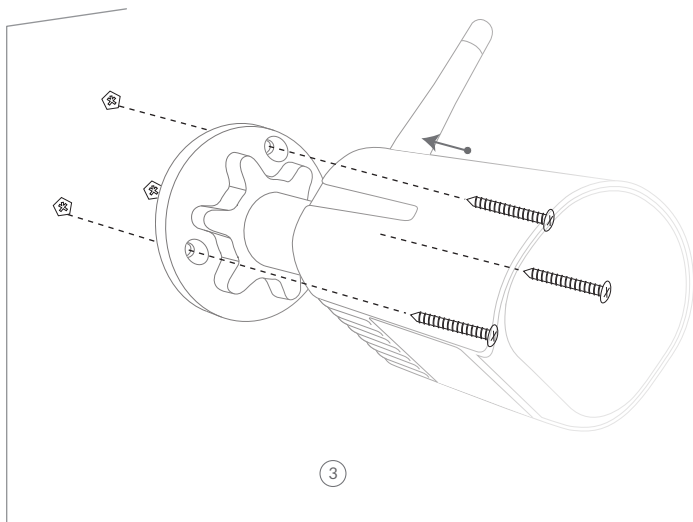

### Step 3 (Wired Connection):

Read this step if you are using wired connection, otherwise skip this step.

A weatherproof tube is needed for Ethernet Cable to avoid leaking water into Ethernet Cable Port.

Make sure the cable works. Insert the cable into the weatherproof tube, and then connect it to the Ethernet cable port of your Camera.

#### Things you need:

Ethernet Cable

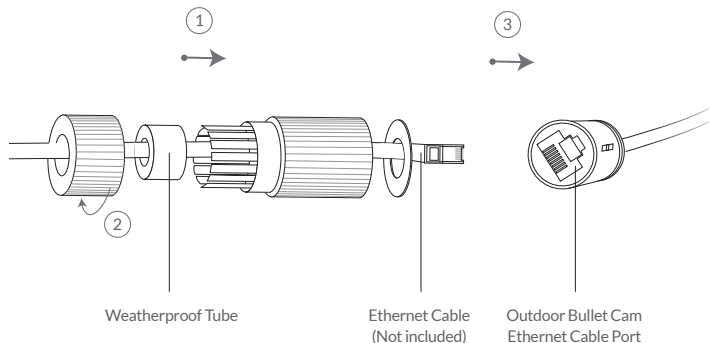

#### Step 4:

Screw the plastic flange-nut counterclockwise over the base of the camera, point the camera to your designate direction, then screw the plastic the plastic flange-nut.

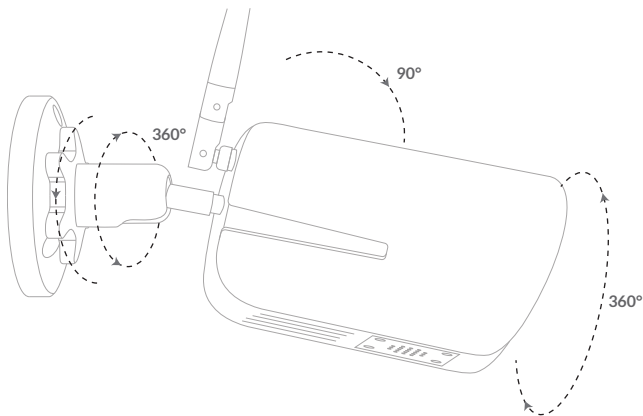

# Status Light

This camera uses status light to communicate.

Status Light	Description
Solid Green	Online
Rapidly Flashing green	Wi-Fi Configuration Mode
None	Offline

# Protect Plan

Protect Plan provides optional advanced features for home security, and supports multiple devices.

**Continuous Video Recording:** Records what's happening for 24/7 and saves everything in the background, you can replay to catch anything you missed.

**Event Video Recording:** Automatically records a video clip when a motion is detected, and push it to your phone instantly.

**Human Detection:** Get alerted when human are detected. No more bothered by normal alerts, and won't miss important things.



Visit [my.safemiraie.com](https://my.safemiraie.com) to learn more.





Feel free to contact us for additional help



support@mpwsafe.com

---

Room 202, No. 6, 5th Alley, Xiangjiaotang New Village,  
Xiangjiaotang Community, Bantian Street,  
Longgang District, Shenzhen, China, 518057

Shenzhen Baishihao Electronic Technology Co., Ltd.

support@mpwsafe.com

www.mpwsafe.com