



Instruction Manual

TW388

UHF Wireless Microphone



ABOUT THIS MANUAL

Thank you for purchasing TONOR wireless microphone. This manual is intended to help you understand all about this microphone and how to use it. TONOR always strives for the ultimate user experience. All our knowledge and passion for audio technology are incorporated into building microphones with high performance for you. The TONOR microphone is high quality and easy to use to achieve the best user experience.

Enjoy your microphone!

TONOR Team

PACKAGE INCLUDING

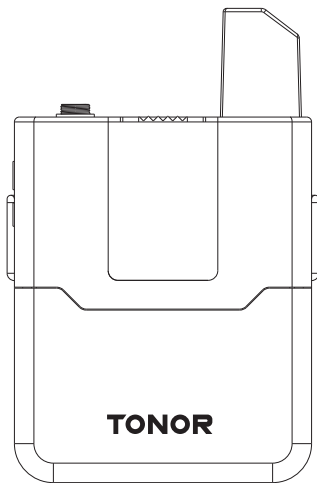

OPERATING ENVIRONMENTS & NOTES



When using this device, keep it away from water.



Use the device in ventilated environment, keep it away from fire.



Since it's a wireless device, please keep it away from other interfering sources.



Don't take apart the device.



Please use the standard power supply, high voltage may damage the device.



Please place the used batteries into the recycle bin, don't litter them.

SPECIFICATIONS

Frequency Response: 40hz-18khz

Maximum Radio-frequency Power Transmitted: 12.0 dBm

Operating Frequency: A MIC: 538.2-544.8MHz, B MIC: 545.4-552MHz,

C MIC: 553.8-560.4MHz, D MIC: 561-567.6MHz, E MIC: 569.4-576MHz,

F MIC: 576.6-583.2MHz, G MIC: 585-591.6MHz, H MIC: 592.2-598.8MHz

Operating Range: Up to 90m

Frequency Stability: ± 10 ppm

SNR: 96dB

Sound Distortion: 0.03%

Handheld Mic Input Sensitivity: -52dB \pm 3dB

Bodypack Input Sensitivity: -40dB \pm 3dB

RF Sensitivity: -95dBm

Operating Temperature: 0°C to +55°C

BODYPACK OPERATION INSTRUCTION

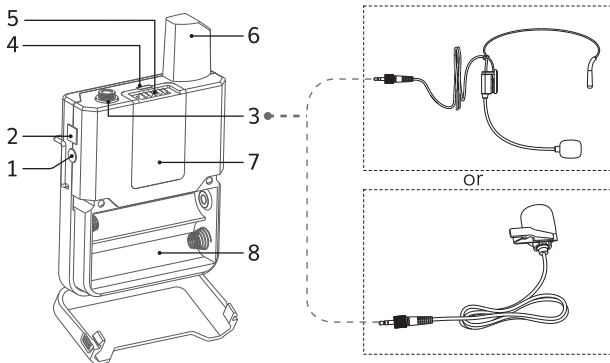

1. SET Button

- Click to change the frequency.
- When the bodypack is on, long press for 5 seconds into the pairing mode.

2. MUTE/VOL

- Click to turn on or mute the sound. Long press for 3 seconds into the volume adjustment mode, and the LCD screen will flash. Click the MUTE/VOL button to increase the volume, the highest level up to 40, and Click the SET button to decrease the volume, the lowest level down to 0.

3. 3.5mm Jack

4. LED Light

- Green for power on. Red for Mute.

5. On/Off Switch

6. Antenna

7. LCD Display

8. Battery Compartment

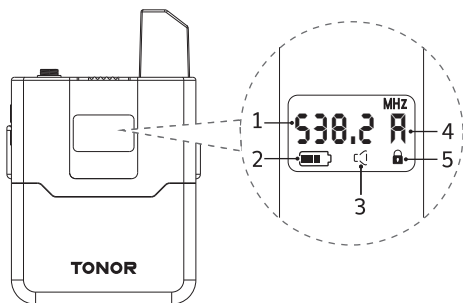

Switch to turn on the mic. Display Screen Instruction:

1. Frequency

2. Battery Aware

3. Mute Indicator

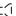
- When the bodypack is turned on, click the MUTE/VOL button to turn on the mute, and "  " lights up. Click the MUTE/VOL button again to turn off the mute, and "  " lights up.

4. Bodypack Number A to H

5. Locked Indicator

- When the bodypack is turned on, "  " appears, indicating that the hand microphone and receiver are locked. When multiple sets are used, they will not interfere with each other.

TROUBLESHOOTING

-Turn on all the microphones or bodypacks, but one of them has on sound.

Reconnect the microphone or bodypack and receiver.

- Received signal with noise or interference

Change to other channels;

Check if receiving distance exceeds the maximum range.

- Microphone cannot be turned on

Check if batteries are installed reversely;

Change to new batteries.

- The microphone number is repeated and cannot be used normally.

For handheld mic: Turn off the microphone with the problem. Then press and hold the power button for about 10 seconds, waiting for the screen to display "CH x" and then release the button. Click "+-" button to select A/B/C/D/E/F/G/H. Then short press the SET button to confirm the number and exit.

For bodypack: Turn off the bodypack with the problem. Long press the SET button and wait for the screen to display "CH-x" and then release the button. Short press the MUTE/VOL button to select A/B/C/D/E/F/G/H. Then short press the SET button to confirm the number and exit.

- Multiple sets used together.

Each set of products need to be repaired according to "STEPS TO PAIR".

All are turned on, and press the SET button on the microphone to set all microphone frequencies to unique frequencies.

Conditions and restrictions for using frequencies

There may be special conditions and restrictions for using frequencies in your country.

Before putting the product into operation, find the information for your country at the following address:

<https://www.tonormic.com/pages/permited-frequency-bands>

WARRANTY

TONOR provides 2 years of after-sales service, free replacement to products that are NOT damaged resulting from accident, alteration, misuse, negligence, or abuse. If exceeding 30 days of Amazon return policy, you can still contact us through our Shopify TONORMIC. We will serve you with full sincerity!

FCC Statement



This device complies with part 15 of the FCC Rules. Operation is subject to the following two conditions:

- (1) This device may not cause harmful interference.
- (2) This device must accept any interference received, including interference that may cause undesired operation.

TW380 / TW388 FREQUENCY LIST

CHA	CHB	CHC	CHD	CHE	CHF	CHG	CHH
538.2	545.4	553.8	561	569.4	576.6	585	592.2
538.8	546	554.4	561.6	570	577.2	585.6	592.8
539.4	546.6	555	562.2	570.6	577.8	586.2	593.4
540	547.2	555.6	562.8	571.2	578.4	586.8	594
540.6	547.8	556.2	563.4	571.8	579	587.4	594.6
541.2	548.4	556.8	564	572.4	579.6	588	595.2
541.8	549	557.4	564.6	573	580.2	588.6	595.8
542.4	549.6	558	565.2	573.6	580.8	589.2	596.4
543	550.2	558.6	565.8	574.2	581.4	589.8	597
543.6	550.8	559.2	566.4	574.8	582	590.4	597.6
544.2	551.4	559.8	567	575.4	582.6	591	598.2
544.8	552	560.4	567.6	576	583.2	591.6	598.8

	AT	BE	BG	CY	CZ	DE
	DK	EE	EL	ES	FI	FR
	HR	HU	IE	IT	LT	LU
	LV	MT	NL	PL	PT	RO
	SE	SI	SK	UK(NI)		

FCC Warning

This device complies with part 15 of the FCC rules. Operation is subject to the following two conditions: (1) this device may not cause harmful interference, and (2) this device must accept any interference received, including interference that may cause undesired operation.

Changes or modifications not expressly approved by the party responsible for compliance could void the user's authority to operate the equipment.

NOTE: This equipment has been tested and found to comply with the limits for a Class B digital device, pursuant to part 15 of the FCC Rules. These limits are designed to provide reasonable protection against harmful interference in a residential installation. This equipment generates uses and can radiate radio frequency energy and, if not installed and used in accordance with the instructions, may cause harmful interference to radio communications. However, there is no guarantee that interference will not occur in a particular installation. If this equipment does cause harmful interference to radio or television reception, which can be determined by turning the equipment off and on, the user is encouraged to try to correct the interference by one or more of the following measures:

- Reorient or relocate the receiving antenna.
- Increase the separation between the equipment and receiver.
- Connect the equipment into an outlet on a circuit different from that to which the receiver is connected.
- Consult the dealer or an experienced radio/TV technician for help.

Radiation Exposure Statement

The device has been evaluated to meet general RF exposure requirement. The device can be used in portable exposure condition without restriction.

 www.tonormic.com

 support@tonormic.com

MANUFACTURER: EASTWEST ELECTRONIC COMMERCE CO., LIMITED
ADDRESS: 6/F MANULIFE PLACE 348 KWUN TONG ROAD KL

US-REP: EASTWEST ELECTRONIC COMMERCE CO US LIMITED
ADDRESS: 3500 SOUTH DUPONT HIGHWAY, SUITE G106 DOVER, DE
19901 UNITE STATES

MADE IN CHINA