

PMN:Voice Amplifier

HVIN:K10

# TONOR

Voice Amplifier Instruction Manual

**K10**

UK  
CA

CE

FC

RoHS



## **ABOUT THIS MANUAL**

---

Thank you for purchasing TONOR Voice Amplifier. This manual is intended to help you understand all about this Voice Amplifier and how to use it. TONOR always strives for the ultimate user experience. All our knowledge and passion for audio technology are incorporated into building Voice Amplifier with high performance for you. The TONOR Voice Amplifier is high quality and easy to use to achieve the best user experience.

Enjoy your Voice Amplifier!

TONOR Team

Package Including

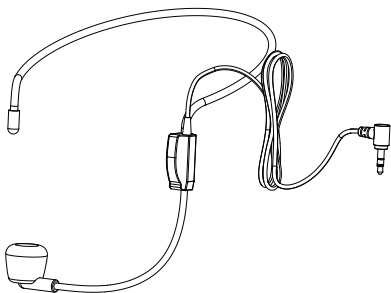
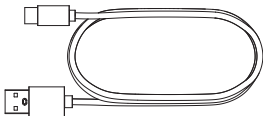
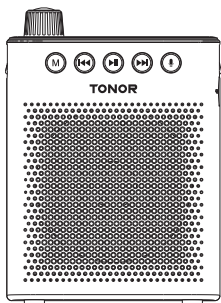

## OPERATING ENVIRONMENTS & NOTES

- When using this device, keep it away from water.
- Use the device in ventilated environment, keep it away from fire.
- Since it's a wireless device, please keep it away from other interfering sources.
- Don't take apart the device.
- Please use the standard power supply, high voltage may damage the device.
- When the battery is low, the mic or voice amplifier will automatically shut down. Please charge it.
- Recommended to use the original charging cable for all charging equipment. Or use a Type-A to Type-C charging cable.
- Not recommended to use equipment while charging.

## SPECIFICATIONS

1. Bluetooth version: V5.2
2. Frequency range: 2402-2480MHz
3. RF power: 1.6mW
4. Bluetooth working distance: 10m
5. Frequency response: 180Hz-18kHz
6. Voice amplifier peak power: 10W
7. Speaker: 3"/4 $\Omega$
8. Voice amplifier Battery: Lithium battery 3.7V/1800mAh
9. Voice amplifier Charging Time: 3~4 hours
10. Voice amplifier Battery Life: 11 hours
11. Voice amplifier and wireless headset microphone powered: DC 5V, 500mA
12. Working temperature: -10°C ~ 45°C

Note: The above parameters are based on experimental data and may vary depending on actual usage conditions.

## VOICE AMPLIFIER OPERATION INSTRUCTION

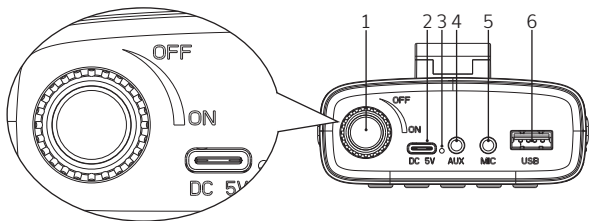

1. Power switch/volume adjustment

- Power on: Rotate to ON. Keep rotate to increase the volume. Rotate back to decrease the volume.

- Shut down: Rotate to OFF

2. DC5V charging socket

3. Indicator light

- The blue light flashes when the Bluetooth is not connected, and the blue light stays on when the connection is successful.

- When playing music in any mode, the blue light flashes.

- The red light is on when charging, and light off when fully charged.

4. AUX input jack

5. 3.5mm MIC jack

6. USB card socket

7. Mode switching button

8. Previous song

- Double click to turn on/off the beep sound.

9. Play/pause

10. Next song

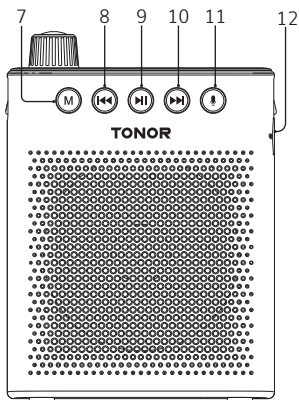

11. Record button

12. TF card slot

## AMPLIFICATION MODE

Turn on the amplifier, connect the headset through the 3.5mm "MIC" jack, and enter wired amplification mode.

1. Wear the headset microphone correctly and adjust the angle of the microphone.
2. To achieve good results, please adjust the microphone to 1-2cm away from your mouth.
3. Rotate to adjust to the appropriate volume.
4. Long press the "Record" button to turn on or off the reverb.

## BLUETOOTH MODE

1. When the amplifier is in Bluetooth mode, turn on the Bluetooth of your phone, find TONOR K10 and pair it. After successful pairing, you can use your phone to play your favorite music. If your mobile phone is trying to connect to TONOR K10 for the first time, you need to click on the search device, find TONOR K10 and then pair it.

2. Long press the "Play/Pause" button for 2 seconds to disconnect the currently connected Bluetooth device.

3. TWS interconnection: Turn on two TONOR K10 loudspeakers, in Bluetooth mode, double-click the "M" key of one of them to perform TWS interconnection. There will be a voice prompt after the connection. At this time, the two hosts can play music at the same time. In the TWS interconnection state, double-click the "M" key on the host to disconnect.

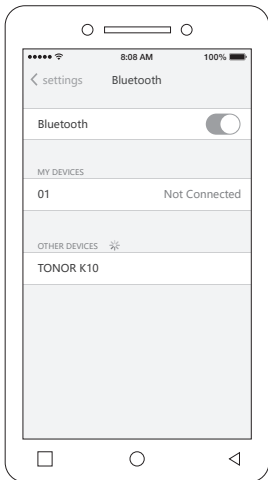

## AUX MODE

1. Use a 3.5mm audio cable to connect the amplifier to external audio source devices such as mobile phones, tablets or computers. Turn on the amplifier and play your favorite music from your phone, tablet or computer.
2. In AUX mode, press the "M" key to switch to other modes.

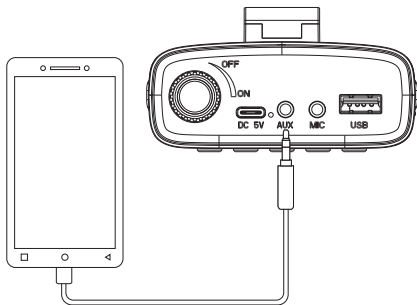

## FM RADIO MODE

1. Automatic station search: Short press the "M" button to enter FM mode. When entering FM mode for the first time, long press the "Play/Pause" button for 2 seconds to automatically search for stations. After the station search is completed, the station will be automatically saved. Short press "Previous song" or "Next song" to switch stations.
2. Manual station search: Long press "Previous Song" or "Next Song" to search for stations. After searching for a station, release the button to listen. Continue long pressing "Previous" or "Next" to retrieve new channels. Manually searched stations are not saved automatically.

## TF CARD AND U DISK MODE

1. Insert the TF card or U disk, automatically switch to TF card or U disk mode. And automatically play the audio files in the TF card or U disk.
2. During playback, long press the "Play/Pause" button for 2 seconds to switch between single loop or all loops. Long press the "Rewind" button to rewind. Long press the "Forward" button to fast forward.
3. This unit has a power-off memory function. When it is turned off, it will remember the track played at that time. When you turn it on next time and use the TF card or U disk mode, it will continue playing from the breakpoint of the last track played.
4. Maximum supported capacity of TF card or U disk: 32GB
5. TF card or USB disk format: FAT32/exFAT
6. Music playback format: supports MP3

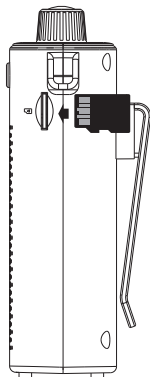
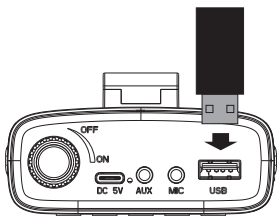



## RECORDING MODE

1. Start recording: Insert the wired microphone into the 3.5mm MIC port. Short press the "Record" button to switch to recording mode and start to record.
2. Stop recording: In recording mode, press the "Record" key to stop recording.
3. Play the recording:
  - When recording with a TF card or U disk, long press the "M" key to enter the recording file playback mode. Press "Previous Song" or "Next Song" to select the recording file to play. Long press the "M" key again to exit the recording file playback mode.
  - When recording without a TF card or U disk, double-click the "Play/Pause" button to enter the recording file playback mode. Press "Previous Song" or "Next Song" to select the recording file to play.
4. Delete the recording: While the recording is playing, long press the "Playback Pause" button to delete the recording.

Note: TONOR K10 supports cardless recording for 240 seconds. If you need to record for a long time, please insert a TF card or U disk.

## **TROUBLESHOOTING**

1. There is no sound from the amplifier when playing a track or listening to a radio channel.

- Check whether the volume is adjusted too low.
- Check whether the battery is discharged. If the battery is out of power, please charge the battery in time.

2. When automatically searching for stations, there are few or no stations found.

- The automatic station search function saves clearer stations by default. Some stations with weak signals will be ignored and not saved by the system. At this time, you can use the manual station search function to search again.

- Please confirm whether the usage environment has FM signal coverage. Adjust the placement of the amplifier to achieve better search.

3. When using the amplification function, the amplifier has no sound.

- Check whether the plug connection is correct and the microphone should be plugged into the microphone interface. The audio cable should be plugged into the audio cable interface.

- Check whether the amplifier or microphone is out of power. If the battery is discharged, please charge the battery in time.

- Check that the power is on.

- Check whether the volume is too low.

- Check whether the wireless microphone is not connected to the amplifier. If not, please follow the "pairing steps" to connect it.

4. There is noise or discontinuity in the speaker.

- The battery may be low, please recharge the battery.

- There may be a poor contact between the microphone and the amplifier.

## **EU DECLARATION OF CONFORMITY**

### **• RoHS Directive (2011/65/EU)**

Hereby, Fujian EastWest Lifewit Technology Co.,LTD declares that the radio equipment type K10 is in compliance with Directive 2014/53/EU.

The full text of the EU declaration of conformity is available at the following internet address:

<https://www.tonormic.com/pages/eu-declaration-of-conformity>

## **Conditions and restrictions for using frequencies**

There may be special conditions and restrictions for using frequencies in your country.

Before putting the product into operation, find the information for your country at the following address:

<https://www.tonormic.com/pages/permitted-frequency-bands>

## **WARRANTY**

TONOR provides 2 years of after-sales service, free replacement to products that are NOT damaged resulting from accident, alteration, misuse, negligence, or abuse. If exceeding 30 days of Amazon return policy, you can still contact us through our Shopify TONOR-MIC. We will serve you with full sincerity!

 <https://www.tonormic.com>

 [support@tonormic.com](mailto:support@tonormic.com)



Vous êtes responsable de remettre tous les appareils électriques et électroniques usagés à des points de collecte correspondants.

Pour en savoir plus:  
[www.quefairedemesdechets.fr](http://www.quefairedemesdechets.fr)



Points de collecte sur [www.quefairedemesdechets.fr](http://www.quefairedemesdechets.fr)

FUJIAN EASTWEST LIFEWIT TECHNOLOGY CO.,LTD | RM  
1201-1205, BLD 18, 2ND PHASE OF INNOVATION PARK, FUZHOU  
350108, CHINA

EASTWEST ELECTRONIC COMMERCE CO US LIMITED | 3500  
SOUTH DUPONT HIGHWAY, SUITE G106 DOVER, DE 19901 UNITED  
STATES

LIFEWIT LIMITED | UNIT 2, VINCENT HOUSE, FIRCREFT WAY,  
EDENBRIDGE UNITED KINGDOM

Lifewit GmbH | Friedenstraße 5 97072 Wuerzburg Germany

MADE IN CHINA

#### FCC Caution:

This device complies with part 15 of the FCC Rules. Operation is subject to the following two conditions: (1) This device may not cause harmful interference, and (2) this device must accept any interference received, including interference that may cause undesired operation.

Any changes or modifications not expressly approved by the party responsible for compliance could void the user's authority to operate the equipment.

NOTE: This equipment has been tested and found to comply with the limits for a Class B digital device, pursuant to Part 15 of the FCC Rules. These limits are designed to provide reasonable protection against harmful interference in a residential installation. This equipment generates, uses and can radiate radio frequency energy and, if not installed and used in accordance with the instructions, may cause harmful interference to radio communications. However, there is no guarantee that interference will not occur in a particular installation.

If this equipment does cause harmful interference to radio or television reception, which can be determined by turning the equipment off and on, the user is encouraged to try to correct the interference by one or more of the following measures:

- Reorient or relocate the receiving antenna.
- Increase the separation between the equipment and receiver.
- Connect the equipment into an outlet on a circuit different from that to which the receiver is connected.
- Consult the dealer or an experienced radio/TV technician for help.

The device has been evaluated to meet general RF exposure requirement. The device can be used in portable exposure condition without restriction.

#### ISED Statement

English: This device contains licence-exempt transmitter(s)/receiver(s) that comply with Innovation, Science and Economic Development Canada's licence-exempt RSS(s). Operation is subject to the following two conditions:

(1) This device may not cause interference.

(2) This device must accept any interference, including interference that may cause undesired operation of the device.

The digital apparatus complies with Canadian CAN ICES-3 (B)/NMB-3(B).

French: Cet appareil contient des émetteurs/récepteurs exempts de licence qui sont conformes aux RSS exemptés de licence d'Innovation, Sciences et Développement économique Canada.

L'exploitation est soumise aux deux conditions suivantes :

(1) Cet appareil ne doit pas provoquer d'interférences.

(2) Cet appareil doit accepter toute interférence, y compris les interférences susceptibles de provoquer un fonctionnement indésirable de l'appareil.

L'appareil numérique du ciem conforme canadien peut - 3 (b) / nmb - 3 (b).

This device meets the exemption from the routine evaluation limits in section 2.5 of RSS 102 and compliance with RSS 102 RF exposure, users can obtain Canadian information on RF exposure and compliance.

Cet appareil est conforme à l'exemption des limites d'évaluation courante dans la section 2.5 du cnr - 102 et conforme à RSS 102 de l'exposition aux rf, les utilisateurs peuvent obtenir des données canadiennes sur l'exposition aux champs rf et la conformité.

This equipment complies with Canada radiation exposure limits set forth for an uncontrolled environment.

Cet équipement est conforme aux limites d'exposition aux rayonnements du Canada établies pour un environnement non contrôlé.

The device has been evaluated to meet general RF exposure requirement. This equipment should be installed and operated with minimum distance 0mm between the radiator & your body.

L'appareil a été évalué pour répondre aux exigences générales d'exposition aux RF.

Cet équipement doit être installé et utilisé avec une distance minimale de 0 mm entre le radiateur et votre corps.