

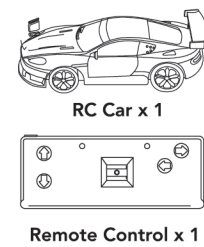

Instruction Manual

Please read instructions before using.
Please keep these instructions as they contain important information.

CONTENTS:



FUNCTION DIAGRAM:

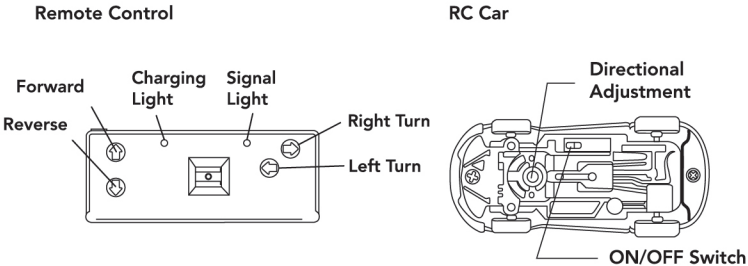

SETUP:

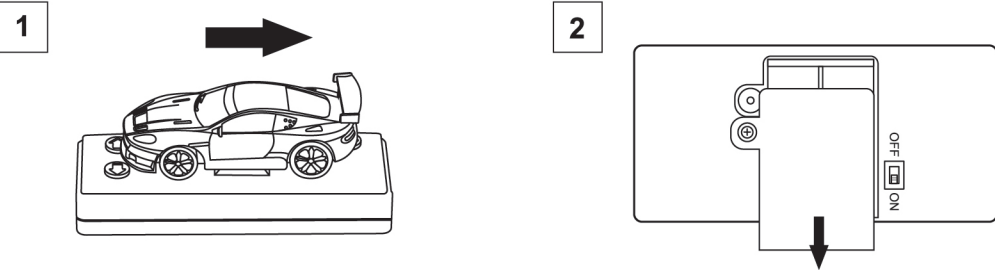

Take out the Remote Control and RC Car from box. Slide the RC Car in the direction shown.

Use a Phillips screwdriver to remove the battery cover on the back of the remote control.

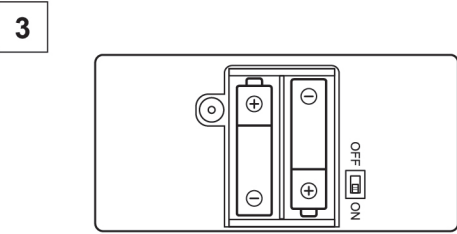

Have an adult install 2 "AA" batteries in the correct (+) (-) position and replace the battery compartment cover.

CHARGING INSTRUCTIONS:

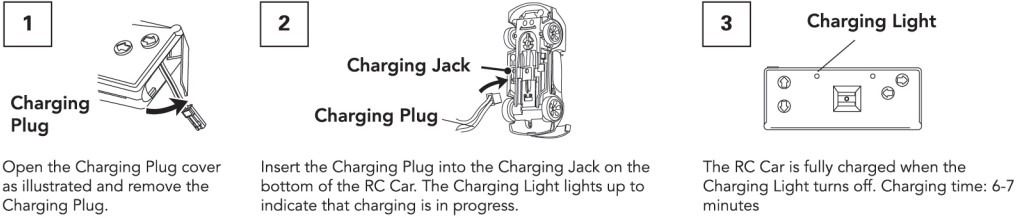

OPERATING INSTRUCTIONS:

1. Move the Power Switch on the back of the Remote Control to the ON position. Move the ON/OFF switch on the RC Car to the ON position and place it on the ground.

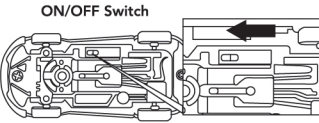

2. The Signal Light lights up when any button on the Remote Control is pressed.

The RC Car moves forward and the headlights light up when the Forward button is pressed. The RC Car moves backward and the tail lights light up when the Reverse button is pressed.

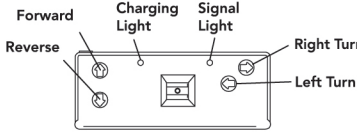

Pressing the Left/Right button on the remote control while the RC Car is moving forward or backward will cause the RC Car to turn.

The Release Button on the Remote Control is used to release the RC Car which is locked onto the Remote Control in the box.

3. The Directional Adjustment is used to adjust the RC Car's straight-line movement performance. Use the adjustment if the RC Car is not moving in a straight line.

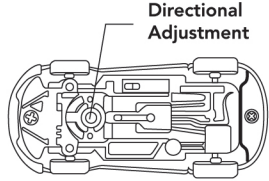

Important Battery Information:

- Batteries should be replaced by an adult.
- Do not charge non-rechargeable batteries.
- Supply terminals should not be short-circuited.
- Ensure batteries are inserted with the correct polarity.
- Spent batteries should be removed from the product.
- Rechargeable batteries should be removed from the product and charged under adult supervision.
- Do not mix alkaline, standard (carbon-zinc), or rechargeable (nickel-cadmium) batteries, or new and used batteries.
- Do not dispose of batteries in household waste or fire, as batteries may explode. Dispose spent batteries safely at local authorities or approved waste sites.

Keep this packaging as it contains important information.

This device complies with Part 15 of the FCC Rules. Operation is subject to the following two conditions: (1) This device may not cause harmful interference, and (2) this device must accept any interference received, including interference that may cause undesired operation.

Caution: changes or modifications not expressly approved by the party responsible for compliance could void the user's authority to operate the equipment.

NOTE: This equipment has been tested and found to comply with the limits for a Class B digital device, pursuant to part 15 of the FCC Rules. These limits are designed to provide reasonable protection against harmful interference in a residential installation. This equipment generates, uses and can radiate radio frequency energy and, if not installed and used in accordance with the instructions, may cause harmful interference to radio communications. However, there is no guarantee that interference will not occur in a particular installation. If this equipment does cause harmful interference to radio or television reception, which can be determined by turning the equipment off and on, the user is encouraged to try to correct the interference by one or more of the following measures:

- Reorient or relocate the receiving antenna.
- Increase the separation between the equipment and receiver.
- Connect the equipment into an outlet on a circuit different from that to which the receiver is connected.
- Consult the dealer or an experienced radio/TV technician for help.

This equipment complies with FCC radiation exposure limits set forth for an uncontrolled environment. This transmitter must not be co-located or operating in conjunction with any other antenna or transmitter.