

Music Starry Sky Projector

Model: SKD-P1

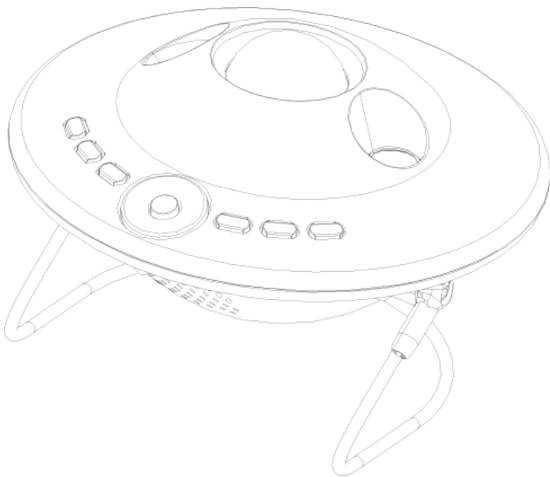

User Manual

Package List

- 1 Music Starry Sky Projector ×1
- 2 2m Type-C USB Cable ×1
- 3 Remote Control ×1
- 4 User Manual ×1

Product Introduction

It is a very interesting electronic entertainment device that can project stars, colorful clouds and various planets on the ceiling. It can provide a visual feast for you. You can connect it with other devices via BT to play your favorite music, or play the built-in music to help you sleep better. It also has unique night light function.

The BT mode will open automaticlly with prompt tone when you turn on the device(BT name:SKD-P1). It will close automaticlly if the BT isn't connected within 2 minutes. The built-in mode has 8 natural sounds, you can use the remote control or press corresponding button of the device to open it.

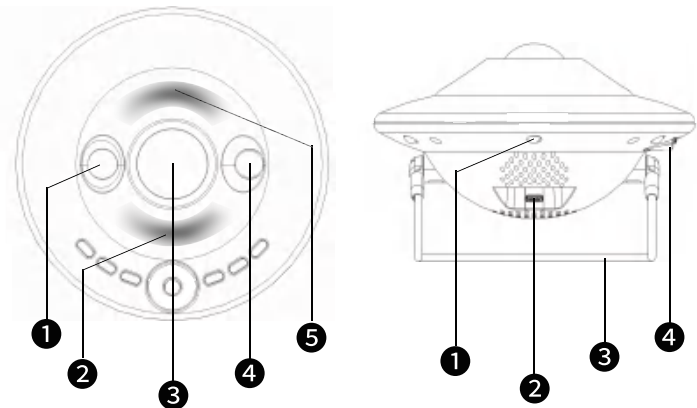

- 1 Star light
- 2 Touch area
- 3 Cloud light
- 4 Planet light
- 5 Touch area

- 1 Night light
- 2 Type-C
- 3 Bracket
- 4 Switch key

Host Button Function Description

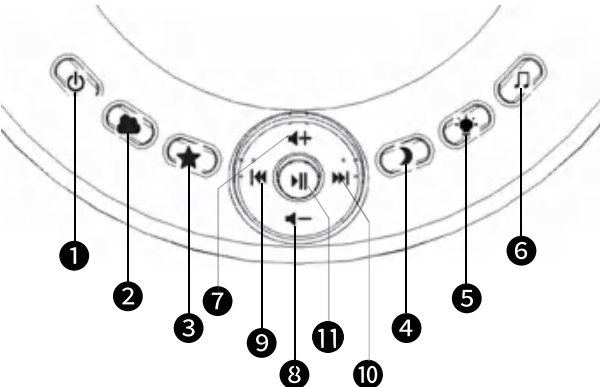

- | | |
|-----------------------------------|---|
| 1 Power ON/OFF;Scene switch | 2 Cloud light ON/OFF;Color switch |
| 3 Star light ON/OFF;Mode switch | 4 Planet light ON/OFF;Brightness switch |
| 5 Night light ON/OFF;Color switch | 6 Built-in / BT Music switch |
| 7 Volume up | 8 Volume down |
| 9 Previous | 10 Next |
| 11 Play/Pause | |

Remote Control Function Description

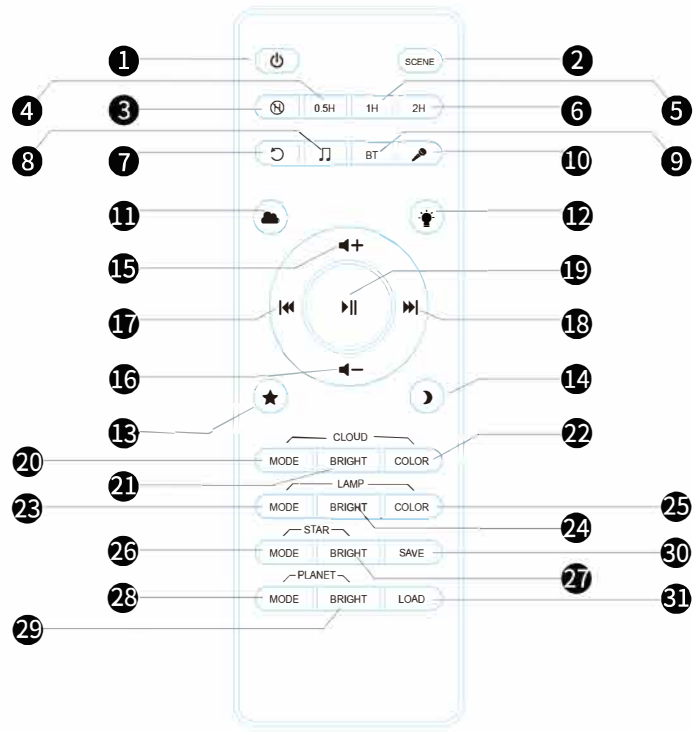

- 1 Power ON/OFF
- 2 Scene (Sleep / Relax / Party)
- 3 Cancel the timing
- 4 Timed 0.5 hour
- 5 Timed 1 hour
- 6 Timed 2 hours
- 7 Reset
- 8 Built-in music (8 Natural Sounds)
- 9 BT music
- 10 Voice control (When playing BT music, the lighting effect will change with the rhythm of the music)
- 11 Cloud light ON/OFF
- 12 Night Light ON/OFF
- 13 Star light ON/OFF
- 14 Planet light ON/OFF
- 15 Volume up
- 16 Volume down
- 17 Previous
- 18 Next
- 19 Play/Pause
- 20 Cloud light Mode (Fast / Slow)
- 21 Cloud light Brightness (100% / 70% / 40%)
- 22 Cloud light Color (R / G / B / RG / RB / GB / RGB)
- 23 Night light Mode (Light / Breathe / Strobe)
- 24 Night light Brightness (100% / 70% / 40%)
- 25 Night light Color (Warm White / White / R / G / B / Colorful)
- 26 Star light Mode (Light / Breathe / Strobe)
- 27 Star light Brightness (100% / 70% / 40%)
- 28 Planet light Mode (Light / Breathe)
- 29 Planet light Brightness (100% / 70% / 40%)
- 30 Save (Save various lighting effects in the current scene)
- 31 Load (Play the last saved scene)

Projection angle adjustment

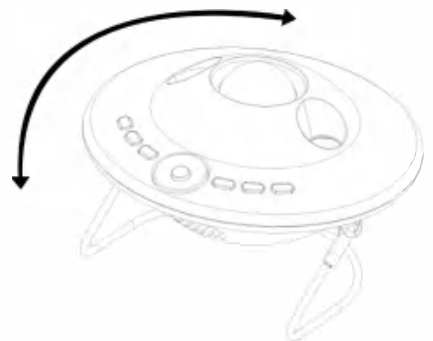

Specifications

Name	Music Starry Sky Projector
Model	SKD-P1
Power Input	5V / 1A
Speaker Power	3W Max
Operating Temperature	15~35℃
Operating Humidity	0~90% RH, no condensation
Dimensions	175*175*120mm
Material	ABS+Iron

Warnings

- 1 Do not stare at the light directly with your eyes to avoid injury.
- 2 Children should use it under the supervision of adults.
- 3 Please cut off the power immediately when danger occurs.
- 4 Do not damage or modify.
- 5 Do not forcibly bend the bracket.
- 6 Please use a safe and compliant power adapter.
- 7 Do not place this product near a heat source.
- 8 If you do not use it for a long time, please unplug the power adapter and charging cable.

Notice

- 1 The device will automatically power off after 8 hours working.
- 2 For indoor use only, works better in a dark environment.

FCC STATEMENT :

This device complies with Part 15 of the FCC Rules. Operation is subject to the following two conditions:

This device may not cause harmful interference, and

This device must accept any interference received, including interference that may cause undesired operation.

Warning: Changes or modifications not expressly approved by the party responsible for compliance could void the user's authority to operate the equipment.

NOTE: This equipment has been tested and found to comply with the limits for a Class B digital device, pursuant to Part 15 of the FCC Rules. These limits are designed to provide reasonable protection against harmful interference in a residential installation. This equipment generates uses and can radiate radio frequency energy and, if not installed and used in accordance with the instructions, may cause harmful interference to radio communications. However, there is no guarantee that interference will not occur in a particular installation. If this equipment does cause harmful interference to radio or television reception, which can be determined by turning the equipment off and on, the user is encouraged to try to correct the interference by one or more of the following measures:

Reorient or relocate the receiving antenna.

Increase the separation between the equipment and receiver.

Connect the equipment into an outlet on a circuit different from that to which the receiver is connected.

Consult the dealer or an experienced radio/TV technician for help.

FCC Radiation Exposure Statement:

This equipment complies with FCC radiation exposure limits set forth for an uncontrolled environment. This equipment should be installed and operated with minimum distance 20cm between the radiator & your body.