

平面印刷品基本技术要求

设计：王心竺	日期：2022.04.29	物料名称	说明书
尺寸：A5(145*210mm)	材质：封面 157g 哑粉纸 + 内页 105g 哑粉纸	产品型号	ZJ2122
页数：96p	印刷颜色：黑白印刷	物料编码	451-2122-1600
比例：1:1	装订方式：胶装	版次	S00

受控发行-机密
22. 05. 17



INSTRUCTION MANUAL

MANUEL D'INSTRUCTIONS
MANUAL DE INSTRUCCIONES

yeedi KK

Contents

1. Package Contents	8
2. Mapping and Cleaning.....	11
3. Maintenance	17
4. Indicator Light.....	26
5. Troubleshooting.....	27
6. Product Specifications	31

IMPORTANT SAFETY INSTRUCTIONS

READ ALL INSTRUCTIONS BEFORE USING THIS APPLIANCE.

SAVE THESE INSTRUCTIONS

For Household use only

When using an electrical appliance, basic precautions should always be followed, including the following:

WARNING: Read all safety warnings and instructions. Failure to follow the warnings and instructions may result in electric shock, fire or serious injury.



1. Do not allow to be used as a toy. Close attention is necessary when used by or near children.
2. Clear the area to be cleaned. Remove power cords and small objects from the floor that could entangle the Appliance. Tuck rug fringe under the rug base, and lift items such as curtains and tablecloths off the floor.
3. If there is a drop-off in the cleaning area due to a step or stairs, you should operate the Appliance to ensure that it can detect the step without falling over the edge. It may become necessary to place a physical barrier at the edge to keep the unit from falling. Make sure the physical barrier is not a trip hazard.
4. Only use as described in this manual. Only use attachments recommended or sold by the manufacturer.
5. Please make sure your power supply voltage matches the power voltage marked on the Charging Station.
6. Do not handle plug or appliance with wet hands.
7. Non-rechargeable batteries are prohibited.
8. Do not use without dust bin and/or filters in place.
9. Do not operate the vacuum in an area where there are lit candles or fragile objects on the floor to be cleaned.
10. Do not use and store in extremely hot or cold environments (below -5°C /23°F or above 40°C/104°F). Please charge the Robot in temperature above 0°C/32°F and below 40°C/104°F.
11. Keep hair, loose clothing, fingers, and all parts of body away from any openings and moving parts.
12. Do not operate the Appliance in a room where an infant or child is sleeping.
13. For INDOOR use ONLY. Do not use the Appliance in outdoor, commercial or industrial environments. Do not use Appliance on wet surfaces or surfaces with standing water.

14. Do not allow the Appliance to pick up large objects like stones, large pieces of paper or any item that may clog the Appliance.
15. Do not use Appliance to pick up flammable or combustible materials such as gasoline, printer or copier toner, or use in areas where they may be present.
16. Do not use Appliance to pick up anything that is burning or smoking, such as cigarettes, matches, hot ashes, or anything that could cause a fire.
17. Do not put any object into openings. Do not use with any opening blocked; keep free of dust, lint, hair, and anything that may reduce air flow.
18. Take care not to damage the power cord. Do not pull on or carry the Appliance or Charging Station by the power cord, use the power cord as a handle, close a door on the power cord, or pull power cord around sharp edges or corners. Do not run Appliance over the power cord. Keep power cord away from hot surfaces. Do not unplug by pulling on cord. To unplug, grasp the plug, not the cord.
19. If the power cord is damaged, it must be replaced by the manufacturer or its service agent in order to avoid a hazard.
20. Do not use the Charging Station if it is damaged.
21. Do not use with a damaged power cord or plug. Do not use the Appliance or Charging Station if it is not working properly, has been dropped, damaged, left outdoors, or come in contact with water. It must be repaired by the manufacturer or its service agent in order to avoid a hazard.
22. Turn OFF the power switch before cleaning or maintaining the Appliance. Turn off all controls before unplugging.
23. The plug must be removed from the receptacle before cleaning or maintaining the Charging Station.
24. Remove the Appliance from the Charging Station, and turn OFF the power switch to the Appliance before removing the battery for disposal of the Appliance.
25. The battery must be removed and discarded according to local laws and regulations before disposal of the Appliance.
26. Please dispose of used batteries according to local laws and regulations.
27. Do not incinerate the Appliance even if it is severely damaged. The batteries can explode in a fire.
28. When not using the Charging Station for a long period of time, please unplug it.

29. The Appliance must be used in accordance with the directions in this Instruction Manual. yeedi cannot be held liable or responsible for any damages or injuries caused by improper use.
30. Prevent unintentional starting. Ensure the switch is in the OFF position before connecting to battery pack, picking up or carrying the appliance. Carrying the appliance with your finger on the switch or energizing appliance that have the switch on invites accidents.
31. When battery pack is not in use, keep it away from other metal objects, like paper clips, coins, keys, nails, screws or other small metal objects, that can make a connection from one terminal to another. Shorting the battery terminals together may cause burns or a fire.
32. Under abusive conditions, liquid may be ejected from the battery; avoid contact. If contact accidentally occurs, flush with water. If liquid contacts eyes, additionally seek medical help. Liquid ejected from the battery may cause irritation or burns.
33. Do not use a battery pack or appliance that is damaged or modified. Damaged or modified batteries may exhibit unpredictable behavior resulting in fire, explosion or risk of injury.
34. Do not expose a battery pack or appliance to fire or excessive temperature. Exposure to fire or temperature above 130°C may cause explosion. The temperature of 130°C can be replaced by the temperature of 265°F.
35. Follow all charging instructions and do not charge the battery pack or appliance outside of the temperature range specified in the instructions. Charging improperly or at temperatures outside of the specified range may damage the battery and increase the risk of fire.
36. Have servicing performed by a qualified repair person using only identical replacement parts. This will ensure that the safety of the product is maintained.
37. Do not modify or attempt to repair the appliance or the battery pack (as applicable) except as indicated in the instructions for use and care.
38. Place the cords from other appliances out of the area to be cleaned.
39. Do not operate the vacuum in a room that has lit candles on furniture that the vacuum may accidentally hit or bump into.
40. Do not allow children to sit on the vacuum.
41. Use only as described in this manual. Use only

manufacturer's recommended attachments.

42. Recharge only with the charger specified by the manufacturer. A charger that is suitable for one type of battery pack may create a risk of fire when used with another battery pack.
43. Use appliances only with specifically designated battery packs. Use of any other battery packs may create a risk of injury and fire.
44. The Robot contains batteries that are only replaceable by skilled persons. To replace the Robot's battery, please contact Customer Service.
45. If the Robot will not be used for a long time, fully charge the Robot and power OFF for storage and unplug the Charging Station.
46. To Reduce The Risk Of Electric Shock – Do not use on wet surfaces. Do not expose to rain. Store indoors.
47. To Reduce The Risk Of Injury From Moving Parts – Unplug Before Servicing.
48. Risk Of Injury. Brush May Start Unexpectedly. Unplug Before Cleaning or Servicing.
49. To reduce the risk of injury, user must read instruction manual.
50. To Reduce The Risk Of Electric Shock – Do not use outdoors or on wet surfaces.

	Direct current
	Alternating current

This Device Complies with DHHS Radiation Rules, 21CFR Chapter 1, Subchapter J.

Federal Communications Commission (FCC) Interference Statement

This equipment has been tested and found to comply with the limits for a Class B digital device, pursuant to Part 15 of the FCC Rules.

These limits are designed to provide reasonable protection against harmful interference in a residential installation. This equipment generate, uses and can radiate radio frequency energy and, if not installed and used in accordance with the instructions, may cause harmful interference to radio communications.

However, there is no guarantee that interference will not occur in a particular installation. If this equipment does cause harmful interference to radio or television reception, which can be determined by turning the equipment off and on, the user is encouraged to try to correct the interference by one of the following measures:

- Reorient or relocate the receiving antenna.

- Increase the separation between the equipment and receiver.
- Connect the equipment into an outlet on a circuit different from that to which the receiver is connected.
- Consult the dealer or an experienced radio/TV technician for help.

This device complies with Part 15 of the FCC Rules. Operation is subject to the following two conditions:

(1) This device may not cause harmful interference, and (2) this device must accept any interference received, including interference that may cause undesired operation.

Caution: Changes or modifications to this unit not expressly approved by the party responsible for compliance could void the user's authority to operate the equipment.

This device contains licence-exempt transmitter(s)/receiver(s) that comply with Innovation, Science and Economic Development Canada's licence-exempt RSS(s). Operation is subject to the following two conditions:

- (1) This device may not cause interference.
- (2) This device must accept any interference, in-

cluding interference that may cause undesired operation of the device.

RF exposure warning

This equipment complies with FCC radiation exposure limits set forth for an uncontrolled environment.

MPE caution (for mobile device under Part 15.247 & 15.407 device)

To satisfy FCC&ICRF exposure requirements, a separation distance of 20cm or more should be maintained between the antenna of this device and persons during device operation.

To ensure compliance, operations at closer than this distance is not recommended.

To disable Wi-Fi module on Robot, power the Robot OFF. Place the Robot on the Charging Station making sure the Charging Contacts on Robot and the Charging Station Pins make a connection.

Press and hold the AUTO Mode Button on the Robot for 20 seconds until Robot emits 3 beeps.

To enable Wi-Fi module on Robot, power the Robot OFF and then power ON. The Wi-Fi module is turned on when Robot is restarted.

1. Package Contents/1.1 Package Contents

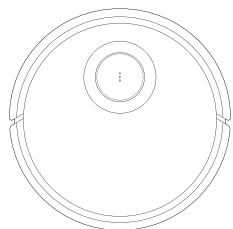

Robot

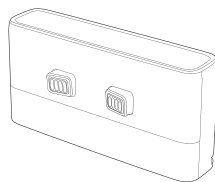

Charging Station

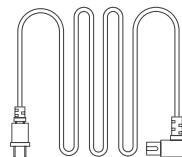

Power Cord

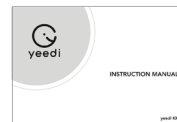

Instruction Manual

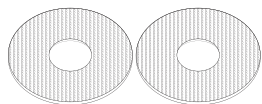

Washable Mopping Pads
(Pre-Installed)

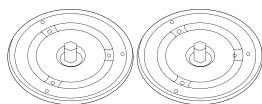

Mopping Pad Plates
(Pre-Installed)



Multi-Function Cleaning Tool

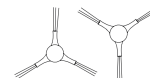

Dual Elastic Edge Brushes



Rubber Plugs

Note:

1. Figures and illustrations are for reference only and may differ from actual product appearance.
2. Product design and specifications are subject to changes without notice.

1. Package Contents/1.2 Product Diagram

Robot Top View

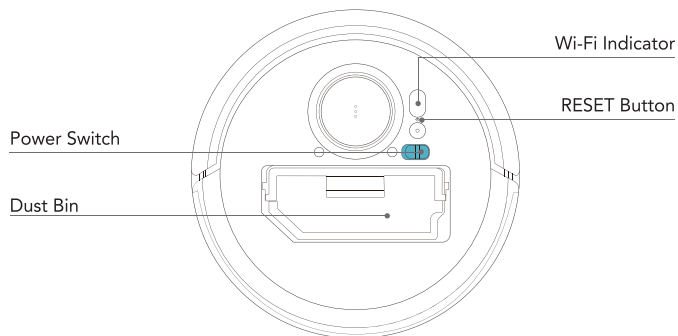
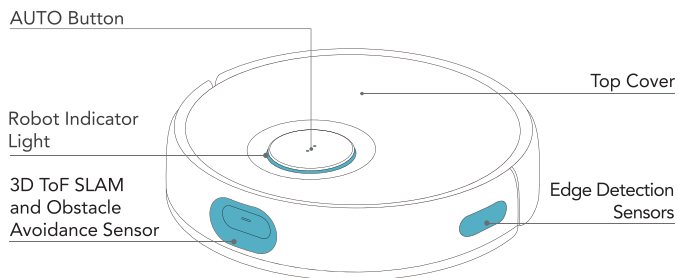

Dust Bin

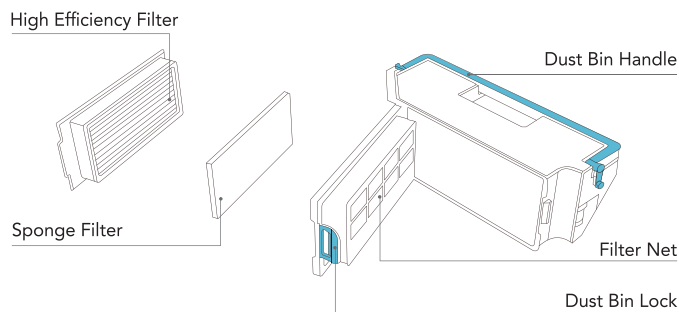

Reservoir

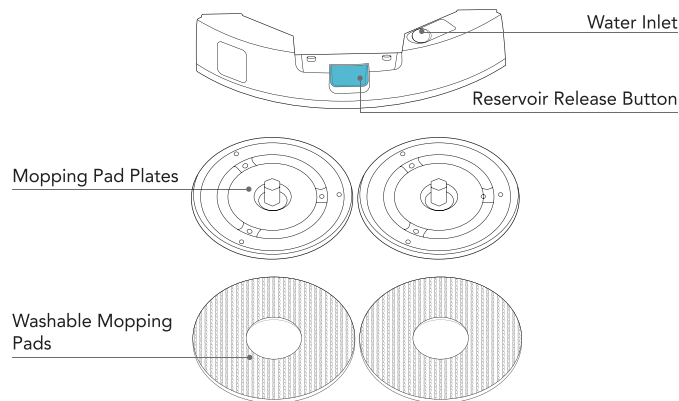

1. Package Contents/1.2 Product Diagram

Robot Bottom View

Universal Wheel

Elastic Edge Brushes

Adaptive
Multi-Surface Brush

Adaptive
Multi-Surface Brush
Release Buttons

Carpet Detection Sensor

Driving Wheels

Mopping Pad
Plate Slots

Water Outlets

Anti-Drop Sensors

Anti-Drop Sensors

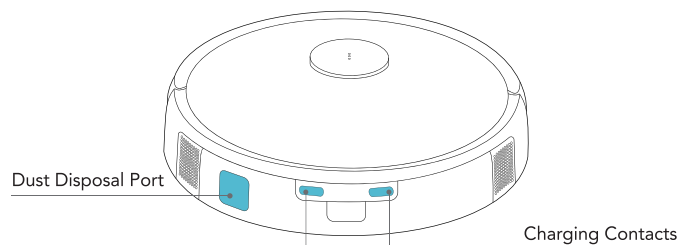

Charging Station

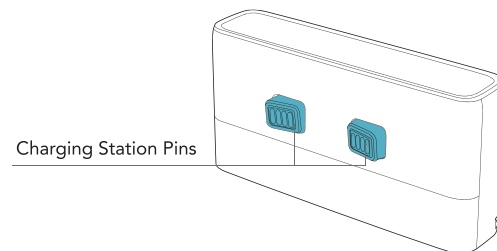

Holes for Rubber Plugs

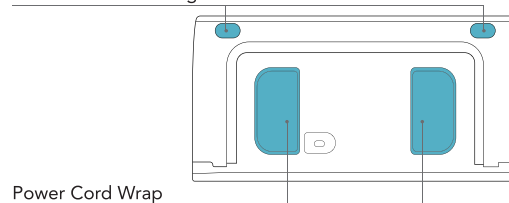

2. Mapping and Cleaning/2.1 Notes before Cleaning

Tidy up the area to be cleaned by putting furniture, such as chairs, in their proper place.

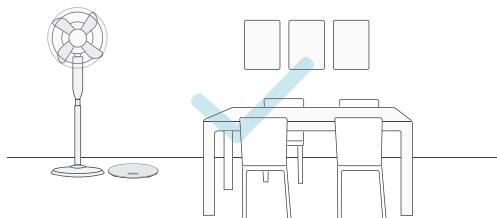

During the first use, make sure each room door is open to help Robot fully explore your house.

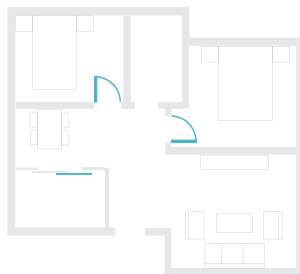

It may be necessary to place a physical barrier at the edge of a drop to stop the Robot from falling over the edge.

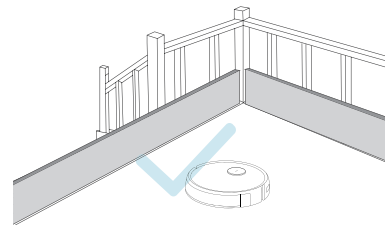

Put away objects including wires, cloths and slippers, etc. on the floor to improve the mapping and cleaning efficiency.



Before using the Robot on a rug with tasseled edges, please fold the rug edges under.



Please do not stand in narrow spaces, such as hallways, and make sure not to block the 3D ToF Sensor.



Please make sure that the Robot has created a home map in yeedi App before starting cleaning.

2. Mapping and Cleaning/2.2 Preparation

Please remove all protection materials on Robot and assemble Charging Station before use.

1 Assemble Charging Station

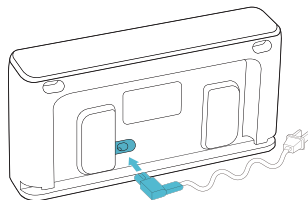

3 Insert Rubber Plugs(For Walls with Skirting Line)

Remove stickers on the end of the Rubber Plugs and insert Rubber Plugs(adhesive side) to the holes.

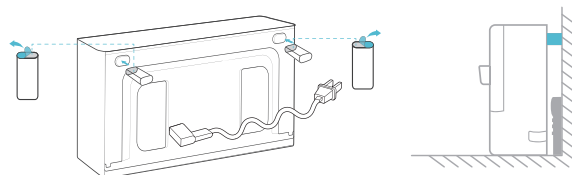

2 Charging Station Placement

Place the Charging Station against the wall in a large space, so your Robot will find its way to recharge more efficiently when in a larger or more complex home environment.

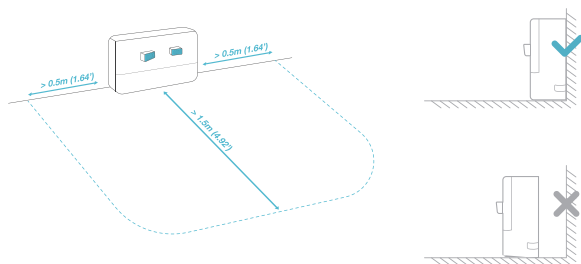

4 Install Dual Elastic Edge Brushes

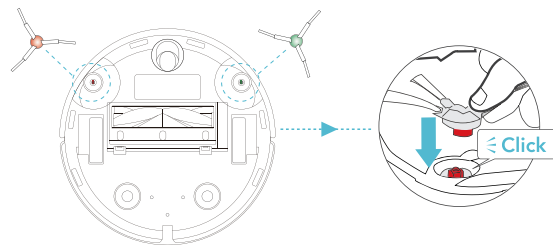

Note:

Please do not place the Charging Station on the carpet.

5 Power ON

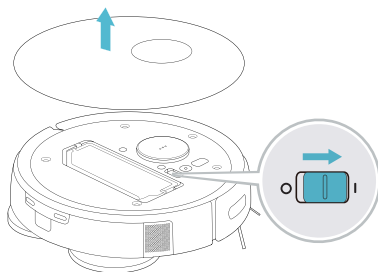

6 Charge Robot

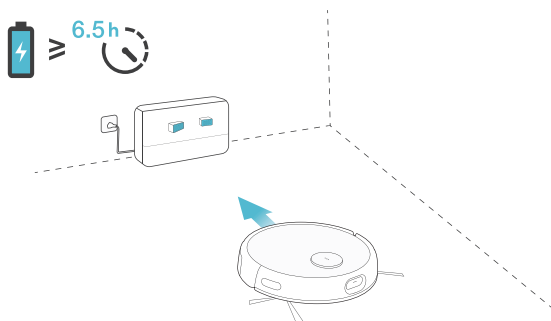

Note:

1. When Robot completes the cleaning or when the battery gets low, Robot automatically returns to the Charging Station to recharge itself. Robot can also be sent back to the Charging Station at any time by using the yeedi App or by pressing the AUTO Button on the Robot for more than 3 seconds.
2. Please make sure that Robot starts cleaning from the Station. Do not move the Station while cleaning.

2. Mapping and Cleaning/2.3 yeedi App

To enjoy all available features, it is recommended to control your Robot via the yeedi App.

Before you start, make sure that:

- Your mobile phone is connected to a Wi-Fi network.
- The 2.4GHz band wireless signal is enabled on your router.
- The Wi-Fi indicator light on Robot is slowly flashing.
- Follow the quick guidance to complete network setup.



Wi-Fi Indicator Light

	Slowly flashing	Disconnected to Wi-Fi or waiting for Wi-Fi connection
	Rapidly flashing	Connecting to Wi-Fi
	Solid	Connected to Wi-Fi

Note:

If you have any problems during the Wi-Fi setup process, refer to the Troubleshooting > Wi-Fi Connection section in this manual.

2. Mapping and Cleaning/2.4 Start, Pause, Wake Up, Power OFF

During the first cleaning:

Please supervise Robot and assist it should there be a problem.

Start

Please make sure that the Robot has created a home map in yeedi App before starting cleaning.

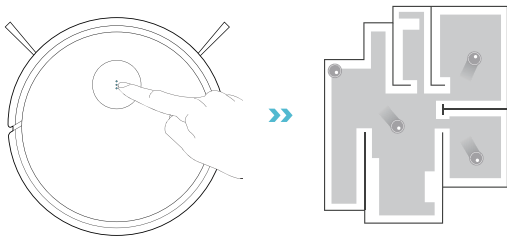

Note:

For the first cleaning, please ensure that the Robot is fully charged.

Pause

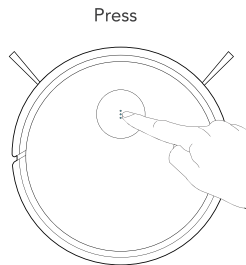

Note:

When Robot is not working, it is recommended to keep it switched ON and charging.

Wake Up

Press the AUTO button on Robot to wake it up.

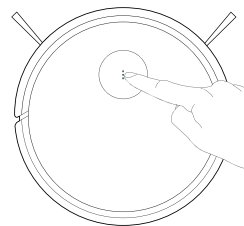

Power OFF

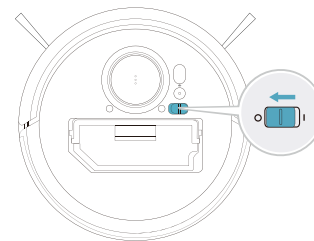

Note:

The Indicator on the Robot's Control Panel stops glowing after the Robot is paused for 10 minutes.