

# CPE-A311

# User Manual

Please read the user manual before using the product.

# Contents

1.Product introduction .....	1
2.Work,ng diagram .....	3
3.Settings of connection with internet by Ethernet	3
4.Settings of connection with internet by3G/4G network	4
5 WIFI connection and settings .....	5
6.WEB connection and settings .....	6
7.Fault judgement and Precautions .....	7

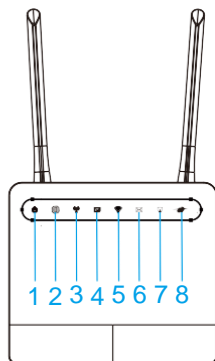

# 1. Product introduction:

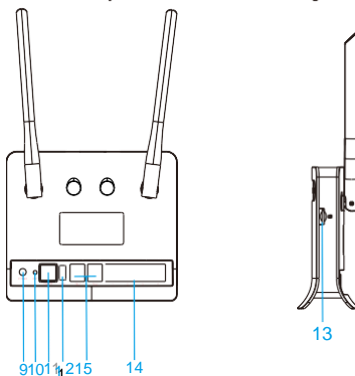

Pic1 keys and status indicator lights



Pic2 ports and keys

5/N	Icon	Functions
		On: CPE connected with power supply, the light is on under power-on status. Off: CPE disconnected with power supply, the indicator light is off
2	垂	On: After CPE starts up, the indicator light is on if SIM card is inserted. It will blink after registering on the network and dialing successfully Off: CPE disconnected with power supply or the SIM card is removed, the indicator light is off
3	焯	On: After CPE starts up, display the number of signal bars according to the actual network conditions Off: CPE disconnected with power supply, the indicator light is off
4		On: CPE starts up, after detected the SIM card, the indicator light is on. Off: CPE disconnected with power supply or no SIM card is inserted, the indicator light is off
	专	On: WIFI indicator light is normally on after the CPE powers on, It blinks when terminal connected with WIFI Off: CPE disconnected with power supply, the indicator light will be off
6	区	On: After CPE starts up, the indicator light is on when there is unread SMS. It blinks when receiving new SMS, if SMS is not read, it will turn to constant light. When SMS storage is full, it will blink continuously Off: CPE disconnected with power supply or no unread SMS, the indicator light is off
	口上	On: ETH1 port accesses with network cable, the indicator light blinks when working Off: Plug out network cable from ETH1 port, the indicator light is off
8	毋	On: Working under 4G network, the indicator light is on Off: CPE power disconnected or CPE is not working under 4G network
9	Power supply	Power supply requirements: 12V, 1A Please use
10	Reset key	Long press reset key for 5 seconds then release, CPE will factory reset and the device will restart automatically
11	Power key	Press the power key to power on or power off the CPE

12	USS	Upgrade software.
13	SIM card slot	Insert SIM card, it is used for connecting with network. Support standard SIM card
14	LAN interface	To provide wired data transmission for the LAN port terminal. It is used for connecting a computer or other local area network equipment
15	TEL	Dial up phone.

Table 1-interface and status indicator lights description

## 2. Working diagram:

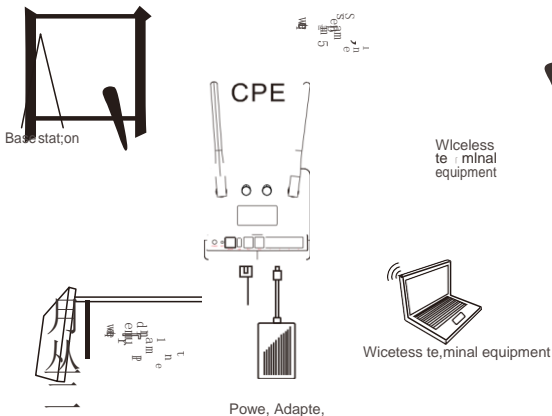

Pie 3 working diagram

## 3. Settings of connection with internet by Ethernet :

**CAUTION :** Place the CPE in a horizontal position to avoid the damage from shaking or dropping

- 1).Unpack and connect the power adapter that in the package with the CPE power connector

- 2). Power on CPE , all indicator lights on panel are on one time, later the power indicator light is on, WIFI indicator light is on, the device starts up completely
- 3). Connect the Ethernet cable to the ETH1 port and the indicator light of ETH1 is on. Make sure the Ethernet can connect with network successfully
- 4). Connect the terminal device with the CPE\_WIFI , the WIFI indicator light blinks. The device connection is successful that indicates that the network is connected

#### 4. Settings of connection with internet by 3G/4G network:

**CAUTION:** Place the CPE in a horizontal position to avoid damage from shaking or dropping

- 1). Insert a standard SIM card as below picture showing

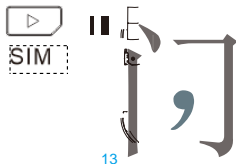

Figure 13: SIM card installation

- 2). Unpack and connect the power adapter that in the package with the CPE power connector
- 3). Power on CPE , all indicator lights on panel are on one time, later the power indicator light is on, WIFI indicator light is on, the device starts up completely
- 4). The device automatically dials up, the panel NET indicator light is on, then the indicator light flashes to indicate that the device dials successfully and the CPE device has successfully connected to the base station network

5).Connect the terminal device with the CPE\_WIFI, and the WIFI indicator on the panel will blink.

## 5. WIFI connection and settings

1) . Confirm the status of CPE is normal, and confirm the CPE\_WIFI is working normally.



Pic5: WIFI name and password

- 2).Turn on the device and enter into WIFI connection settings.
- 3).Click CPE\_WIFI name. The WIFI name and password is shown on the CPE back. The sticker position is shown as picture5.
- 4).Input WIFI password, click connect, WIFI indicator light on the CPE panel will blink, which means WIFI connection successful.  
(Different terminal devices with different WIFI setting interfaces, check below picture.)

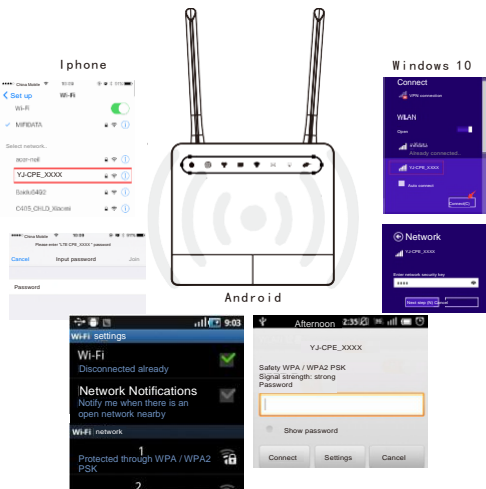

Pic 6 WIFI settings

## 6.WEB connection and settings:

- 1) . Confirm the CPE status is normal, and confirm CPE has been connected with notebook or smart phone correctly.



Web IP:192.168.100.1  
Username: admin  
Password: admin

Pic7 WEB connection and parameters setting



- 2). Open computer or mobile phone browser.
- 3). Input the IP address of CPE at browser address bar, the address is on the CPE back sticker shown as picture 7.
- 4). Follow the prompts dialog box to enter the password, the password is on the CPE back sticker shown as picture 7.:
- 5). Enter WEB UI main interface, WEB UI settings include CPE status display, router settings, WIFI settings, firewall, SMS settings, system management and other CPE parameter display and system functionality settings, the user can set up according to individual needs.

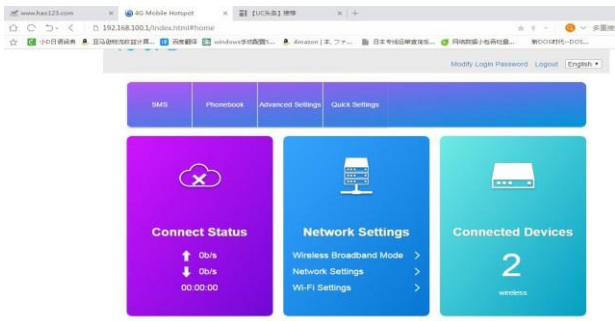

Pic8 main interface

## 7. Judgement and Precautions

### Judgement:

1. Power indicator does not light: Check if the power plug is plugged in properly.
2. NET indicator does not light: Check if the SIM card is properly inserted.
3. NET indicator does not blink:

- a. If the indicator light is on within 3 minutes , which means the CPE is searching the network
- b. If the indicator light is on more than 3 minutes without blinking , which means the base station network cannot be detected by the CPE , please change the CPE placing position and retry

#### Precautions :

1. Place the CPE in a horizontal position to avoid damage from shaking or falling
2. The ideal working temperature of equipment is 0 °C - 40 °C, the ideal storage temperature is -20 °C - +70 °C , Avoid too high or too low temperature to prevent the equipment or accessories from damages
3. Avoid the unnecessary damage of equipment or accessories from the fire , water and other high temperature or erosion position
4. Avoid using the equipment during a lighting storm to prevent the equipment from lightning strikes
5. Avoid violence press or bend the external antenna , otherwise it may affect the quality of communication

The user interface in this manual is for reference only

(May be different from the actual operation interface!)

## FCC STATEMENT

This device complies with Part 15 of the FCC Rules. Operation is subject to the following two conditions:

This device may not cause harmful interference.

This device must accept any interference received, including interference that may cause undesired operation.

any Changes or modifications not expressly approved by the party responsible for compliance could void the user's authority to operate the equipment.

NOTE: This equipment has been tested and found to comply with the limits for a Class B digital device, pursuant to Part 15 of the FCC Rules. These limits are designed to provide reasonable protection against harmful interference in a residential installation.

This equipment generates uses and can radiate radio frequency energy and, if not installed and used in accordance with the instructions, may cause harmful interference to radio communications. However, there is no guarantee that interference will not occur in a particular installation. If this equipment does cause harmful interference to radio or television reception, which can be determined by turning the equipment off and on, the user is encouraged to try to correct the

interference by one or more of the following measures:

Reorient or relocate the receiving antenna.

Increase the separation between the equipment and receiver.

Connect the equipment into an outlet on a circuit different from that to which the receiver is connected.

Consult the dealer or an experienced radio/TV technician for help.

## FCC Radiation Exposure Statement

This equipment complies with FCC radiation exposure limits set forth for an uncontrolled environment. This equipment should be installed and operated with minimum distance 20cm between the radiator & your body