

Robot Vacuum YT-89

User Manual

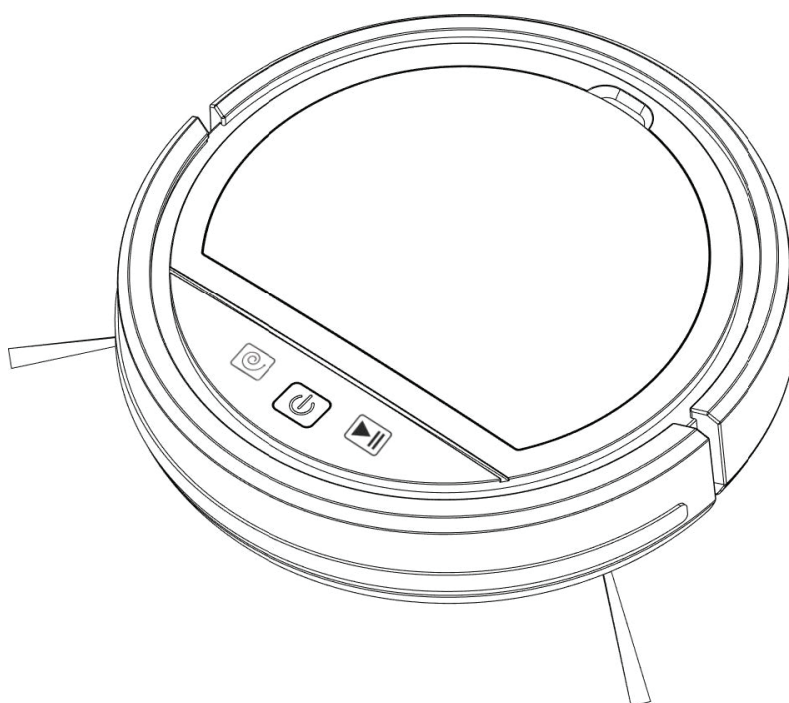

Please carefully read the manual before using.
If you have any problem,
welcome to contact us here : sup-service@outlook.com

FCC Statement

Changes or modifications not expressly approved by the party responsible for compliance could void the user's authority to operate the equipment.

This equipment has been tested and found to comply with the limits for a Class B digital device, pursuant to Part 15 of the FCC Rules. These limits are designed to provide reasonable protection against harmful interference in a residential installation. This equipment generates uses and can radiate radio frequency energy and, if not installed and used in accordance with the instructions, may cause harmful interference to radio communications. However, there is no guarantee that interference will not occur in a particular installation. If this equipment does cause harmful interference to radio or television reception, which can be determined by turning the equipment off and on, the user is encouraged to try to correct the interference by one or more of the following measures:

- Reorient or relocate the receiving antenna.
- Increase the separation between the equipment and receiver.
- Connect the equipment into an outlet on a circuit different from that to which the receiver is connected.
- Consult the dealer or an experienced radio/TV technician for help

This device complies with part 15 of the FCC rules. Operation is subject to the following two conditions (1) this device may not cause harmful interference, and (2) this device must accept any interference received, including interference that may cause undesired operation.

This equipment complies with FCC radiation exposure limits set forth for an uncontrolled environment. This equipment should be installed and operated with minimum distance 20cm between the radiator & your body

Important Safety Instructions

Pls read the below safety instructions carefully before using and keep the user manual for future use. Pls follow the below basic safety instructions to avoid catching fire, electronic shock and human injury:

Safety Operating Rules:

1. Pls read the user manual carefully before using.
2. Outdoor using is forbidden.
3. Pls ensure the filter is installed properly in the dust box before using the cleaner.
4. Cannot be used under rain, in water or in moisture environment such as bathroom or laundry room.
5. Pls tidy up things on the floor before using the cleaner. Make sure there are no clothes, papers, cables or other things which can stumble the cleaner on the floor; if there is curtain which contact the floor, need to roll it up to avoid danger. If the cable or other things rolled into the wheels, then the cleaner might drag the table, chair or cabinet down.
6. Standing or sitting on the cleaner is strictly forbidden. Pls pay attention to children and pets to avoid any potential danger.
7. Do not use the cleaner to clean the smoking cigarette, firing match or other on fire things.
8. Do not use the cleaner to clean flammable or volatile things such as gasoline and etc.
9. Pls contact our service support team if the cleaner fall from high place, hit or defective.
10. Pls turn off the power if do not use it for a long time.

Notes of Charging:

1. Pls follow the voltage and current on the product packing when charging the battery. Pls confirm with the salesman or local electric power company if you cannot sure.
2. Pls do use the original battery and power adapter.
3. The power adapter only can be used indoor.
4. Do not charging when there is damage on the charging cable or power adapter.
5. Do not touch the power adapter or charging cable with wet hands.
6. Pls disconnect with the electric power first if you need to clean the cleaner.
7. Pls take the battery out first if you want to throw the cleaner away.
8. Pls make sure the power is off before taking the battery out.
9. Give the abandoned battery to professional recycle station to process.

Product Specifications

Color :	Black / White
Dust Bin Capacity :	0.3L
Battery Type :	2500mAh, 7.4V
Average Charge Time :	5 Hours
Vacuum Operation Run-Time :	70 Minutes
Operating Voltage :	100-200V
Product Weight :	2.9lbs / 1.3kg
Dimensions (L x W x H) :	11.0" x 11.0" x 2.9" (27.5 x 27.5 x 7.5cm)

How to operate

Turn on power button  the cleaner will start “U” shape cleaning.

Click  button, cleaner will pause cleaning, click again will resume cleaning.

In pause mode, Click  button, will start Spot Cleaning mode.

Power on	Red and green lights flash 3 times	Spot Cleaning	Red and green lights flashing alternately
Standby	Red and green lights on	Charging	On charging: red light flashing, green light off. Fully charged: red light off, green light on.
Auto-cleaning	Green light flashing, red light off		

Cleaner and Accessories



Cleaner x1

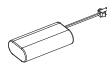

Rechargeable battery x1

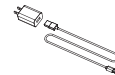

Power adapter and cable x1



Filter x1 (installed in the dust box)

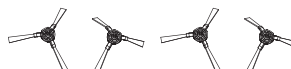

Round brushes x4



User manual x1

Mopping cloth

Mopping cloth x1

Cleaner and Accessories

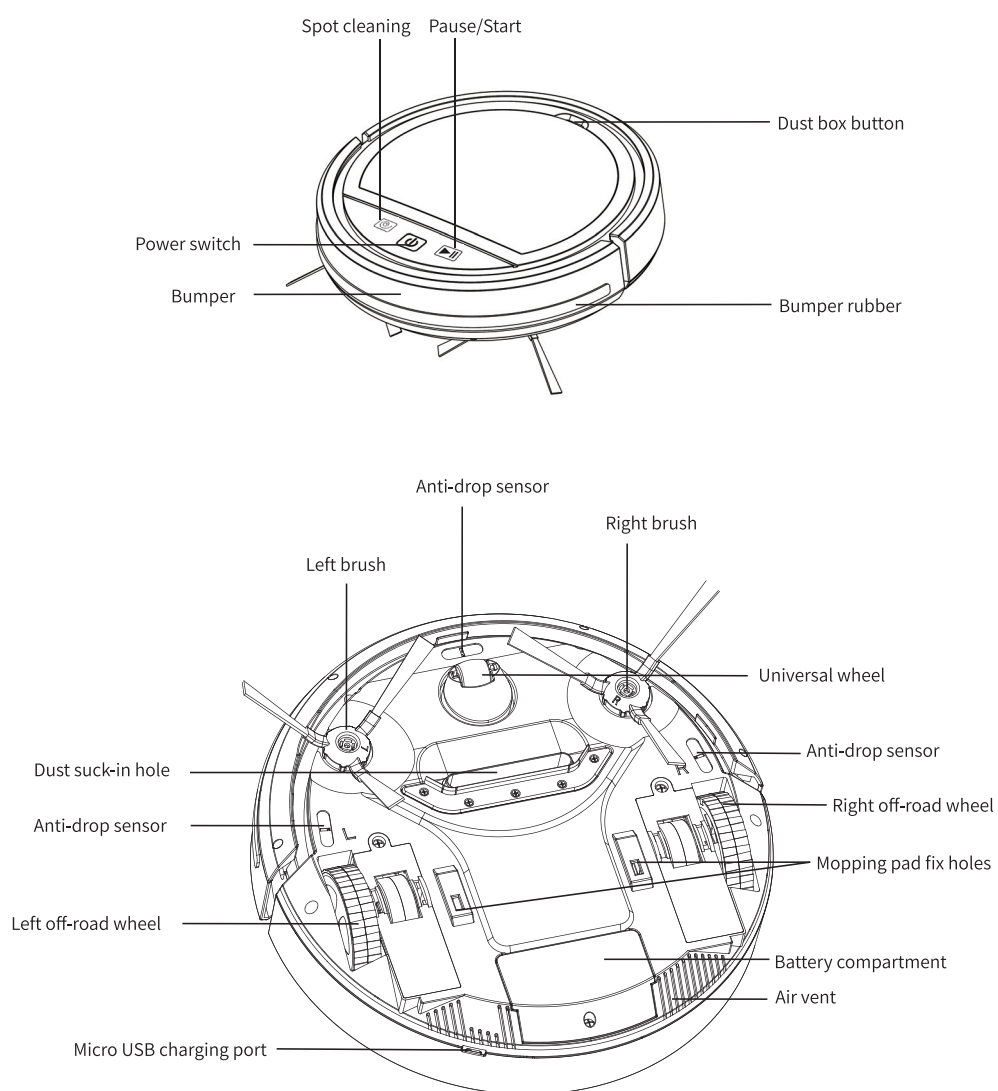

How to install and dismantle battery

1. Make sure the cleaner is power off before install/dismantle the battery.
2. When the battery fix screw is off, then open the battery cover (using Phillips screwdriver) (see Picture 2)
3. Put the battery inside (or get out) the battery compartment, put the battery cover back then screw tight (see Picture 3)

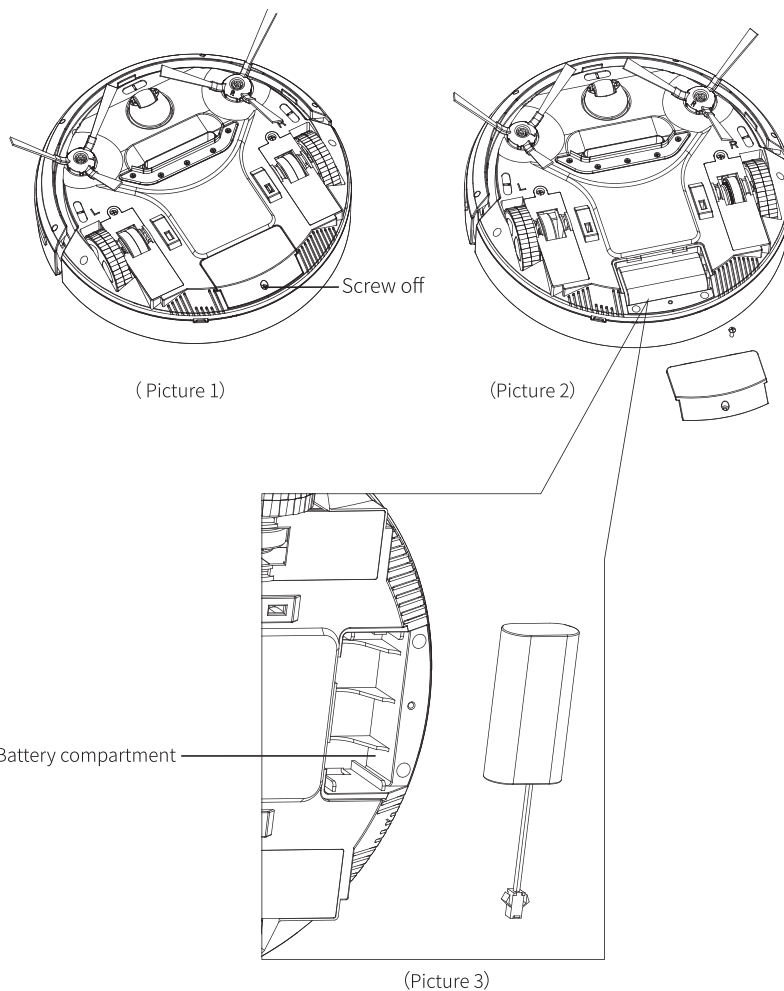

How to charging

1. To ensure the longest battery life and efficacy, suggest to fully charging 6-7 hours.
2. Pls make sure the power is off and the battery is installed.
3. Pls pay attention that connect the charging cable with cleaner via Micro USB port first, then insert the power adapter into the socket, and now the red light will be flashing and green light will be off.
4. When fully charged, the red light will be off, and green light will be on.

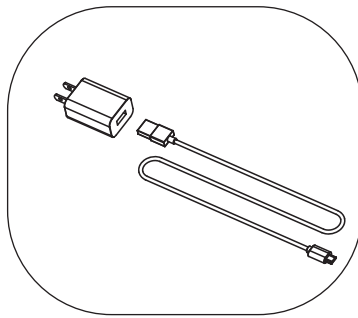

Power adapter and cable

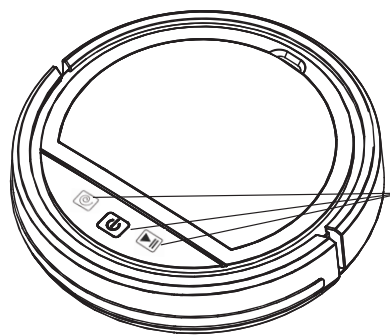

Power display and sweeping mode selection

General Operation

Start working

※Attention!! Pls take the mopping cloth and brushes off when using on the short-hair carpet to avoid potential damage.

※ Pls do not used on fuzzy or long hair carpet.

- 1.Pls empty the dust box and install the filter properly before using.
- 2.Put the cleaner in the open area of the room and power on.
- 3.The cleaner will stop automatically when the battery is empty. Pls do power off if you do not use it or charging it.

How to install and dismantle brushes

※The brushes can be installed and dismantled by bare hands, no need tools

- 1.Install: press the brush directly onto the axle. (see Picture 4)
- 2.Dismantle: pull the brush out of the axle directly. (see Picture 5)

Press to install

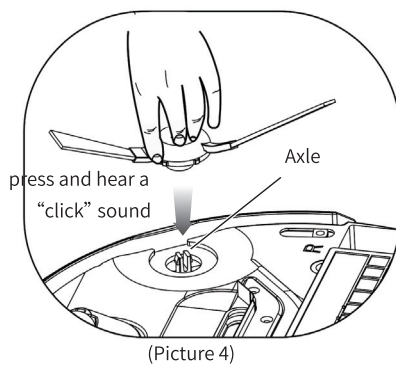

Pull to dismantle

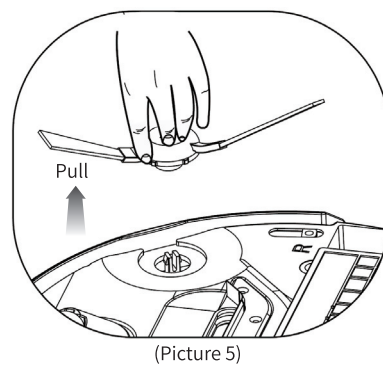

Use mopping cloth

※Attention!! Do not use the mopping function on the carpet or in a carpeted environment.

Also remove the brush from the bottom of the cleaner

1: First find the mopping pad holes ①② (see Picture 6)

2: Put the mopping cloth into the water and soak the water (see Picture 7)

3: Stick the mopping cloth to the corresponding position as shown

4: Remove the mopping cloth: directly tear the two magic plate positions

Reminder: Please clean the mopping cloth every time you drag the ground

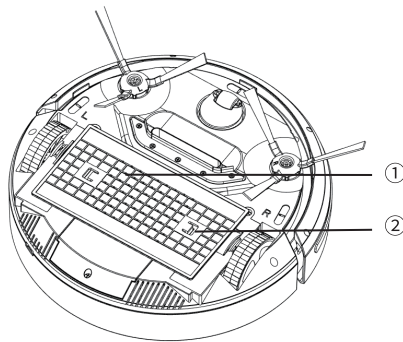

(Picture 6)

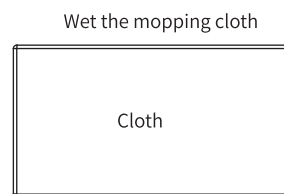

(Picture 7)

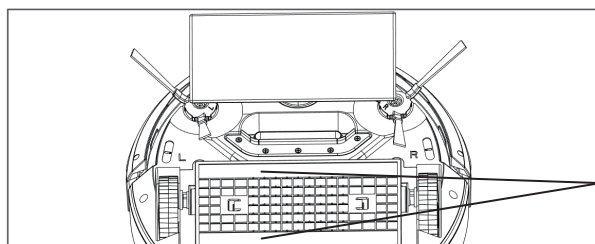

(Picture 8)

How to Connect With WiFi APP

1. Download TuyaSmart from App Store or directly scan the below QR code to download



2. Turn on the cleaner and long press  for around 3 seconds until the green light blinking rapidly.

3. Open App, click Add Device

4. A. Add Manually: Select Small Home Appliance /Robot Vacuum (red boxes in the below picture) Or

B. Click Auto Scan until the green light stops flashing and few seconds later, the App will find sweeper, then click Next to get connected.

Below is the guide for Add Manually:

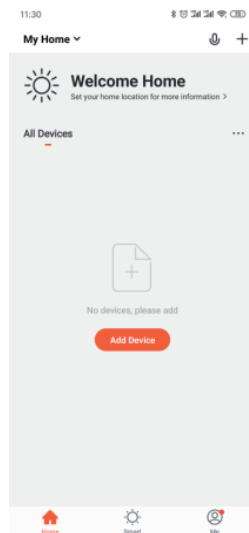

3.

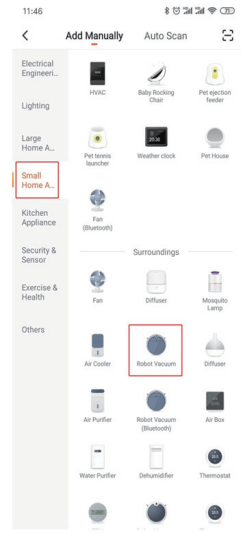

4.

How to Connect With WiFi APP

5. Input Wifi passwords, only support 2.4G Wifi
 6. Click Fast flashing (0.5 seconds/1 time)
 7. Can use App to control the cleaner if the connection succeed
- succeed

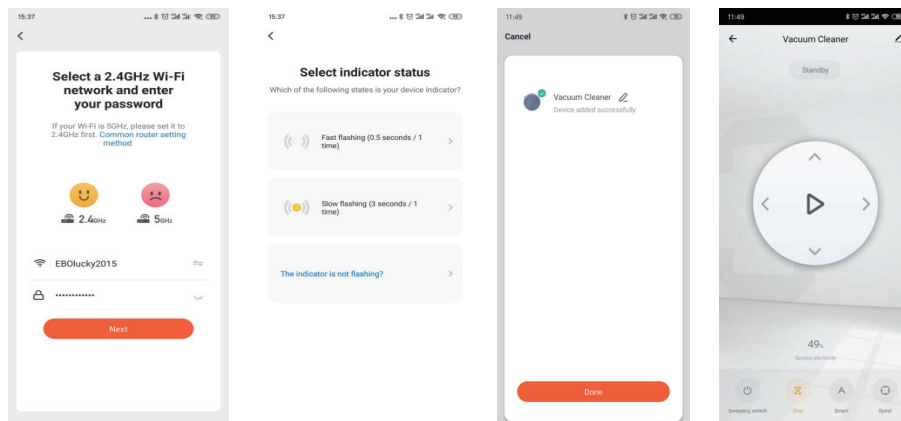

5.

6.

7.

Due to the App (TuYa) is a third-party platform and it will upgrade from time to time. The actual App interface may be different from this manual, but the basic operation will be the same. Thank you for your understanding!



Cleaning and maintenance

Clean up the dust box

1. Open the top cover as shown.
2. Put your hand in the groove of the dust box, and take it out .

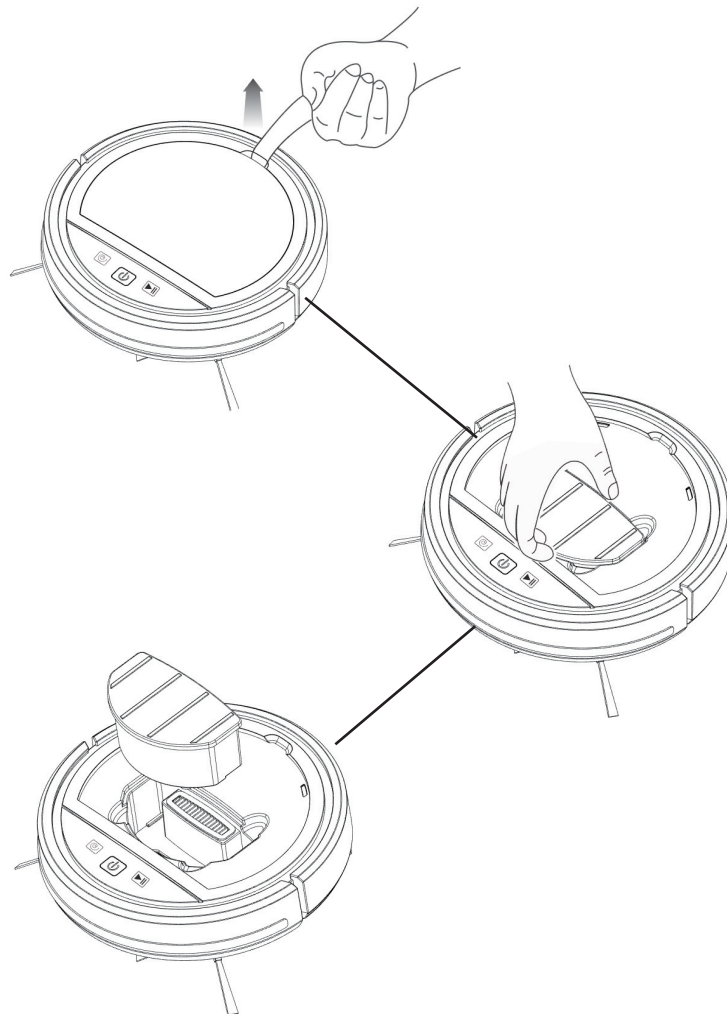

Cleaning and maintenance

3. Open the cover of dust box .
4. Take out the internal filter.
5. Empty the debris in the dust box.

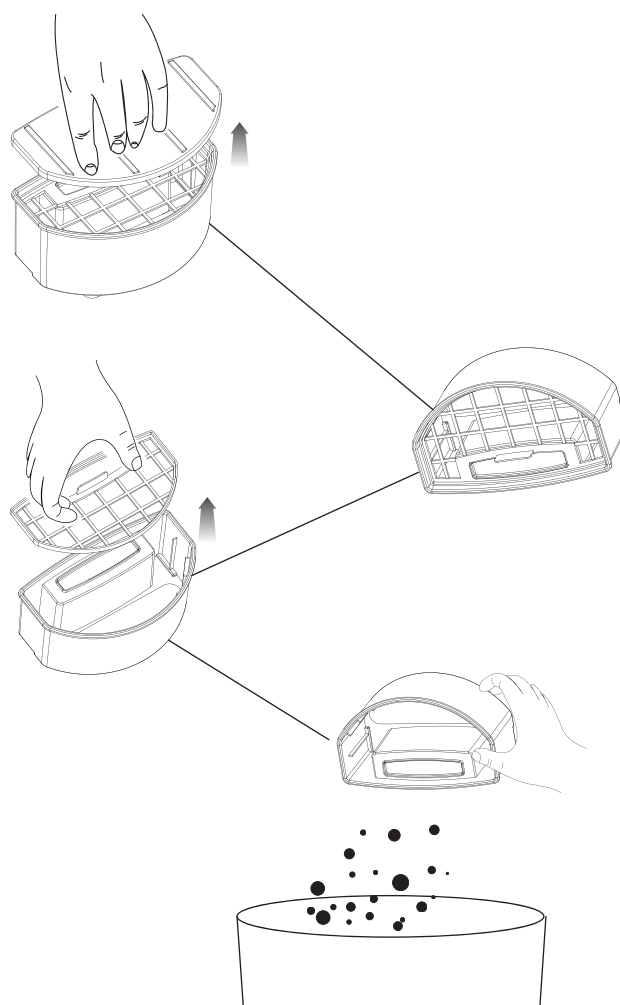

Cleaning and maintenance

6. Rinse the dust box under the tap and do not put it in the washing machine, dishwasher, or other machine.
 7. Gently clean the surface of the filter with a brush.
 8. After drying, please be sure to replace the filter and garbage cover in sequence.
 9. Put the dust box back and cover it back.
 10. The dust box & filter must be dried and applied after cleaned before use next time, otherwise the vacuum effect will be affected.
- ※ Note! ! Please confirm that the filter is installed correctly before starting the vacuum cleaner. if it is not loaded, it may cause machine failure.
- Attention please, thank you!

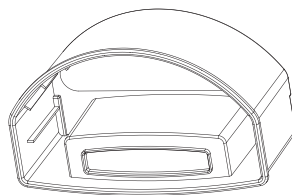
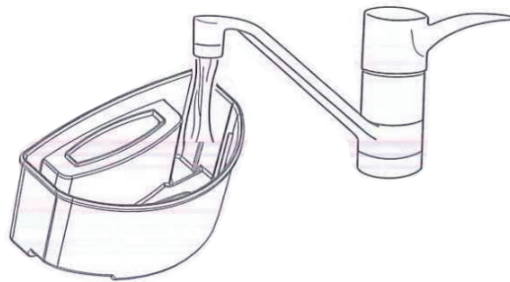

Place it in a dry place and install it when dry

Cleaning and maintenance

Clean up the dust suck-in hole

After a period of use, dust and dirt will accumulate in the dust suck-in hole at the bottom of the machine, so it must be cleaned regularly to make the airflow smooth to avoid the vacuuming effect.

- 1.First turn off the power to the machine.
- 2.Clean up the dirt that has accumulated in the dust box suction port

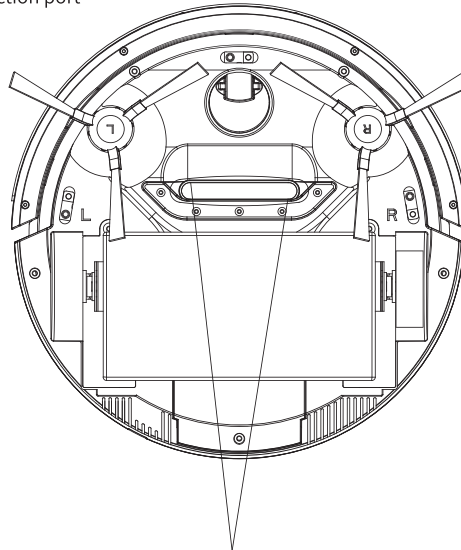

Clean up the dust suck-in hole

Clean the sweeping brush

1. Turn off the vacuum cleaner, place the bottom of the vacuum cleaner up, and put it on a flat floor or tabletop. Hold the sweeping brush and pull up to remove the sweeping brush for cleaning.
- 2.After finishing the process, press the sweeping brush directly into the center of the brush holder to replace the sweeping brush.
- 3.Please replace the sweeping brush with a new one to achieve maximum cleaning benefits if it is worn out.

Simple troubleshooting table

	Fault Types	Fault Display	Solution
1	Collision stuck fault	The red light is always on and the green light is off. The buzzer sounds 1 time per 5 seconds.	Check if the front collision of the machine is stuck, please clear
2	Robot machine suspension failure	The red light is always on and the green light is off. The buzzer sounds 2 times per 5 seconds	Check if the machine is left floating
3	Side brush current is too large	The red light is always on and the green light is off. The buzzer sounds 3 times per 5 seconds.	Check if the side brush of the machine is entangled or stuck, please clear
4	Wheel current is too large	The red light is always on and the green light is off. The buzzer sounds 2 per 5 seconds, then per 1 second, 1 sound	Check if the machine wheel is entangled or stuck, please clear
5	Fan current is too large	The red light is always on and the green light is off. The buzzer sounds 3 times per 5 seconds, then per 2 seconds, 2 sounds	Check if the inside of the fan is entangled or stuck, please clear
6	Battery voltage is too low	Red light is always on and the green light is off. The buzzer sounds fast	Battery is too low, please charge