

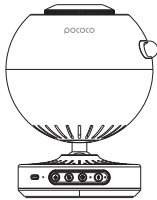

Galaxy Lite Star Projector

USER GUIDE



Thank you for purchasing POCOCO Galaxy Lite Star Projector. The projection film could be replaced. The user guide should be kept properly. Please read it carefully before operating your projector.

Shenzhen LUBON Technology Co., Ltd.

△ Please check before operating:
1. Whether the product is damaged;
2. Whether the USB power cord is damaged.
If it is damaged, please contact the relevant maintenance service immediately instead of using it.
Before operating your projector, please read the “Before you Begin” section and “Caution” section of this user guide.

CAUTION

- ▲ When used by children, it must be guided by a guardian.
- ▲ Avoid direct eye exposure.
- ▲ Be careful of children ingesting spare parts.

PACKAGE LIST



1× Star Projector



1× User Guide

-1-

- 4× Replaceable Films
- 1× USB Power Cord

PRODUCT INTRODUCTION

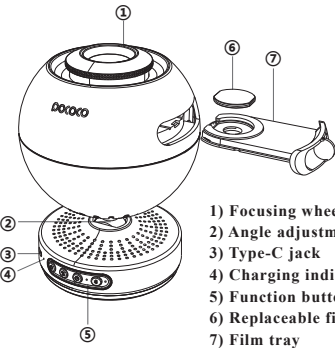

-2-

BEFORE YOU BEGIN

1. Environmental Requirements:

The product should be used in a dark room, please turn off other light, place the product on a flat solid surface, and aim toward desired ceiling/wall.

2. Buttons and Indicators:

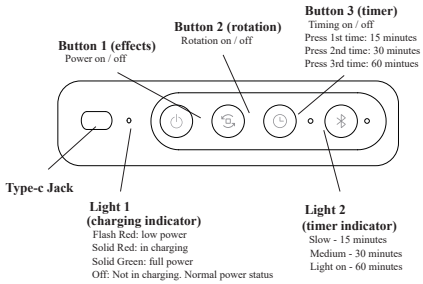

3. Power Supply:

The lithium battery of this product works as follows:

- 1) Charging: Use the USB power cord to connect the

-3-

host to a 5V charger. The indicator light turns from red to green when the lithium battery is fully charged. The light does not light up when the battery can be used normally.

- 2) Maintenance: If you will not use it for a long time, please turn off the power and charge it once a month to avoid shortening the life of the lithium battery.

OPERATING STEPS

1. Pull out the film tray.
2. Press the film in the film tray, align the straight edges of the film and the installation position.
3. Insert the tray back into the device.

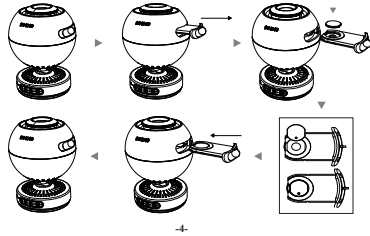

4. Rotate the focus wheel to achieve a clear projection.
5. The angle of projection can be changed within the range from -30° to 30° as needed.

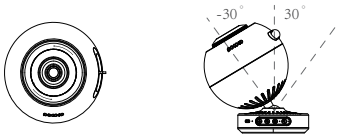

CAUTION

Please use a matching power adapter (5V).

This product is not a fireproof and waterproof projection. Use and store in a normal temperature and humidity environment.

It is not recommended to disassemble and modify machine parts at will.

-5-

SPECIFICAION

Name: Galaxy Lite Star Projector
Size: 157*120*120 mm
Weight: ≤500 g
Housing: ABS+PC plastic
Comfortable Viewing Distance: 2~2.5m (The diameter of the projection pattern is 3.2~4 m)
Power Adapter Output: 5V ~~~
Lithium Battery: 3.7V 2000mAh
Standard: UL62368
Version Number: POLT01
Color: Black/ White

LIMITED WARRANTY

The warranty period of this product is twelve months after purchase. If it is used correctly within the warranty period, but the product has problems due to its own quality, we can provide warranty service.

When you need to provide warranty service, please provide proof of purchase and warranty card.

-6-

The following conditions are not covered by the warranty:

Damage caused by incorrect installation, operation, or inappropriate use environment.

Damage caused by disassembling the main engine for repair and modification.

Damage caused by man-made or natural disasters.

If the warranty card is changed, this card will be invalid.

Warranty Card	
Version Number	
Your Name	
Your Email	
Order ID	
Purchase Date	

Please send the details to support@pococo.net, the support team will reply within 24 hours.

-7-

Warning: Changes or modifications to this unit not expressly approved by the party responsible for compliance could void the user's authority to operate the equipment.

NOTE: This equipment has been tested and found to comply with the limits for a Class B digital device, pursuant to Part 15 of the FCC Rules. These limits are designed to provide reasonable protection against harmful interference in a residential installation. This equipment generates, uses and can radiate radiofrequency energy and, if not installed and used in accordance with the instructions, may cause harmful interference to radio communications. However, there is no guarantee that interference will not occur in a particular installation. If this equipment does cause harmful interference to radio or television reception, which can be determined by turning the equipment off and on, the user is encouraged to try to correct the interference by one or more of the following measures:

- Reorient or relocate the receiving antenna.
 - Increase the separation between the equipment and receiver.
 - Connect the equipment into an outlet on a circuit different from that to which the receiver is connected.
 - Consult the dealer or an experienced radio/TV technician for help
- The device must not be co-located or operating in conjunction with any other antenna or transmitter.

This device complies with Part 15 of the FCC Rules.

Operation is subject to the following two conditions:
(1) this device may not cause harmful interference, and (2) this device must accept any interference received, including interference that may cause undesired operation.

The minimum separation generally be used is at least 20 cm.

-8-

