

F11

FAST WIRELESS CHARGE DOCK
USER MANUAL

⚠ Attention: Must use DC12V=2A/19V=2A/5V=3A adapter if fully loading.

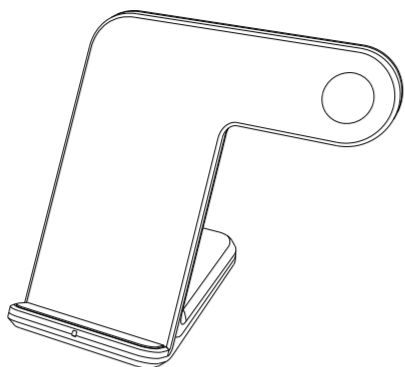

CE FC RoHS

Product Introduction

This Wireless Charge Dock is newly designed which can wirelessly charge your iPhone and Apple Watch simultaneously. The built-in magnetic charging module aligns your Apple Watch magnetically, so you can begin charging instantly. With double coil wireless charging module and Apple Watch Magnetic Charging module, you can charge your phone in either portrait or landscape position, then it will be comfortable to browse webs, listen to music, or stream podcasts.

Product Appearance

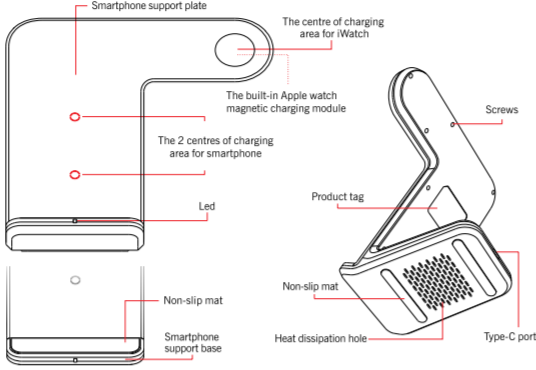

Smartphone and iWatch Charging Schematic Diagram



Applicable Devices

Devices which wireless charging receiver built-in:

1.Support wireless charging for 3 W:

Apple Watch series 1, 2, 3, 4, 5, 6, SE, 7

2.Support wireless charging for 7.5 W:

Apple: iPhone8 Series, iPhoneX, XS Series, iPhone11 Series, iPhone 12 Series, iPhone 13 Series.

3.Support wireless charging for 10 W:

Samsung: S10, S10+, S9, S9+, S8, S8+, S7, S7 edge, S6 edge+, Note10, Note10+, Note9, Note9+, Note8, Note8+, Note5.

4.Support wireless charging for 5 W:

Apple: iPhone8 Series, iPhoneX, XS Series, iPhone11 Series, iPhone 12 Series, iPhone 13 Series.

Samsung: S9, S9+, S8, S8+, S7, S7 edge, S6, S6 edge, S6 edge+, S6 G9209,

S6 Active, Note 9, Note 8, Note FE, Note 5,

Xiaomi: Mi9, Mi9 Pro, Mi9 SE, Mi9T, Mi9T Pro, Mi9T Pro 5G, HUAWEI: Mate RS Porsche edition,

NOKIA: 8 Sirocco, Lumia 1520, Lumia 1020, Lumia 930, Lumia 929,

Lumia 928, Lumia 925, Lumia 920, Lumia 830, Lumia 920,

LG: V30, THINQ V30, G6+, G3, G2, NEXUS-NEXUS 7, 6, 5, 4,

HTC: HTC 8X (US edition), Droid DNA (US edition), HTC D2X, VOTA, Vota Phone 2,

Motorola: Droid Turbo 2, SONY: Xperia X22, Xperia Z4V, GIONEE: M7 Plus,

Other mobiles need a wireless charging receiver (include android phones and iPhones).

(Note: All devices must be Qi standard)

Product Specification

Input: DC12V=2A/19V=2A/5V=3A

Output: 15W/10W/7.5W/5W

+3W

Transmission distance: ≤8mm

Conversion rate: ≥73%

Product Size: 140X104X121mm

Standard Accessories

Wireless Charge Dock

Type-C cable

User manual

FCC STATEMENT

This device complies with Part 15 of the FCC rules. Operation is subject to the following two conditions:

1) this device may not cause harmful interference, and

2) this device must accept any interference received, including interference that may cause undesired operation.

Changes or modifications not expressly approved by the party responsible for compliance could void your authority to operate the equipment.

NOTE: This equipment has been tested and found to comply with the limits for a Class B digital device, pursuant to Part 15 of the FCC Rules. These limits are designed to provide reasonable protection against harmful interference in a residential installation.

This equipment generates uses and can radiate radio frequency energy and, if not installed and used in accordance with the instructions, may cause harmful interference to radio communications. However, there is no guarantee that interference will not occur in a particular installation. If this equipment does cause harmful interference to radio or television reception, which can be determined by turning the equipment off and on, the user is encouraged to try to correct the interference by one or more of the following measures:

- Reorient or relocate the receiving antenna.
- Increase the separation between the equipment and receiver.
- Connect the equipment into an outlet on a circuit different from that to which the receiver is connected.
- Consult the dealer or an experienced radio/TV technician for help.

The use distance should be more than 20cm from the human body