

Model: CSTPA0

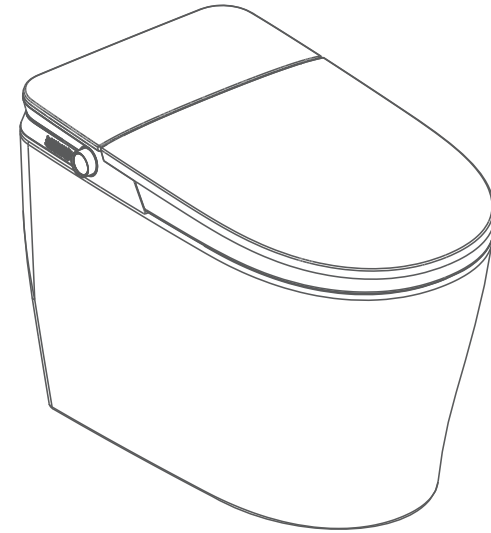

Smart Toilet Installation Manual

Thank you for choosing our product.
Please read the instructions carefully before installation and keep it available for
future maintenance or reference.

Radio frequency specification of remote control

FCC:

This device complies with Part 15 of the FCC Rules. Operation is subject to the following two conditions: (1) this device may not cause harmful interference, and (2) this device must accept any interference received, including interference that may cause undesired operation.

Changes or modifications to this unit not expressly approved by the party responsible for compliance could void the user's authority to operate the equipment.

NOTE: This equipment has been tested and found to comply with the limits for a Class B digital device, pursuant to Part 15 of the FCC Rules. These limits are designed to provide reasonable protection against harmful interference in a residential installation. This equipment generates uses and can radiate radio frequency energy and, if not installed and used in accordance with the instructions, may cause harmful interference to radio communications.

However, there is no guarantee that interference will not occur in a particular installation. If this equipment does cause harmful interference to radio or television reception, which can be determined by turning the equipment off and on, the user is encouraged to try to correct the interference by one or more of the following measures:

Reorient or relocate the receiving antenna. Increase the separation between the equipment and receiver. Connect the equipment into an outlet on a circuit different from that to which the receiver is connected. Consult the dealer or an experienced radio/TV technician for help.

IC:

This device contains licence-exempt transmitter(s)/receiver(s) that comply with Innovation, Science and Economic Development Canada's licence-exempt RSS(s). Operation is subject to the following two conditions:

- (1) This device may not cause interference.
- (2) This device must accept any interference, including interference that may cause undesired operation of the device.

L'émetteur/récepteur exempt de licence contenu dans le présent appareil est conforme aux CNR d'Innovation, Sciences et Développement économique Canada applicables aux appareils radio exempts de licence. L'exploitation est autorisée aux deux conditions suivantes :

- 1) L'appareil ne doit pas produire de brouillage;
- 2) L'appareil doit accepter tout brouillage radioélectrique subi, même si le brouillage est susceptible d'en compromettre le fonctionnement.

This equipment complies with FCC's and IC's RF radiation exposure limits set forth for an uncontrolled environment. The antenna(s) used for this transmitter must be installed and operated to provide a separation distance of at least 10 cm from all persons and must not be collocated or operating in conjunction with any other antenna or transmitter. Installers must ensure that 10cm separation distance will be maintained between the transmitter and users.

Cet équipement est conforme aux limites d'exposition aux rayonnements RF de FCC et d'ic établies pour un environnement non contrôlé. L'antenne (S) utilisée (S) pour cet émetteur doit être installée et actionnée de façon à assurer une distance de séparation d'au moins 10 cm par rapport à toutes les personnes et ne doit pas être localisée ou fonctionner conjointement avec une autre antenne ou un autre émetteur. Les installateurs doivent s'assurer que la distance de séparation de 10cm sera maintenue entre l'émetteur et les utilisateurs.

IMPORTANT SAFEGUARDS

When using electrical products, especially when children are present, basic safety precautions should always be followed, including the following **READ ALL INSTRUCTIONS BEFORE USING**

DANGER-To reduce the risk of electrocution:

1. Do not use while bathing.
2. Do not place or store product where it can fall or be pulled into a tub or sink.
3. Do not place in or drop into water or other liquid.
4. Do not reach for a product that has fallen into water, Unplug immediately.

WARNING-To reduce the risk of burns, electrocution, fire, or injury to persons.

1. Close supervision is necessary when this product is used by, on, or near children or on, or near children or invalids.
2. Use this product only for its intended use as described in this manual. Do not use attachments not recommended by the manufacturer.
3. Never operate this product if it has a damaged cord or plug, if it is not working properly, if it has been dropped or damaged, or dropped into water. Return the product to a service center for examination and repair.
4. Keep the cord away from heated surfaces.
5. Never block the air openings of the product or place it on a soft surface, such as a bed or couch, where the air openings may be blocked. Keep the air openings free of lint, hair, and the like.
6. Never use while sleeping or drowsy.
7. Never drop or insert any object into any opening or hose.
8. Do not use outdoors or operate where aerosol (spray) products are being used or where oxygen is being administered.
9. Connect this product to a properly grounded outlet only. See Grounding Instructions.
10. Fill reservoir with water only unless otherwise specified by manufacturer.

SAVE THESE INSTRUCTIONS

GROUNDING INSTRUCTIONS

this product should be grounded in the event of an electrical short circuit, grounding reduces the risk of electric shock by providing an escape wire for the electric current. This product is equipped with a cord having a grounding wire with a grounding plug. The plug must be plugged into an outlet that is properly installed and grounded.

DANGER — Improper use of the grounding plug can result in a risk of electric shock. If repair or replacement of the cord or plug is necessary, do not connect the grounding wire to either flat blade terminal. The wire with insulation having an outer surface that is green with or without yellow stripes is the grounding wire. Check with a qualified electrician or serviceman if the grounding instructions are not completely understood, or if in doubt as to whether the product is properly grounded.

This product is for use on a nominal 120 V circuit, and has a grounding plug that looks like the plug illustrated in sketch A. A temporary adapter, which looks like the adapter illustrated in sketches B and C, may be used to connect this plug to a 2-pole receptacle as shown in sketch B if a properly grounded outlet is not available. The temporary adapter should be used only until a properly grounded outlet (sketch A) can be installed by a qualified electrician. The green colored rigid ear, lug, and the like extending from the adapter must be connected to a permanent ground such as a properly grounded outlet box cover. Whenever the adapter is used, it must be held in place by the screw.

Grounding methods

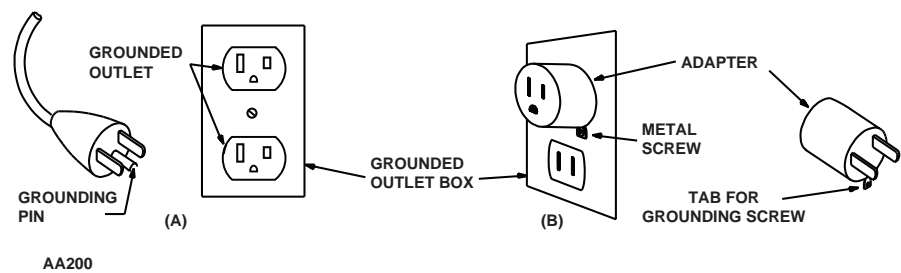

Function

Function		Model	CSTPA0
Seat	Seat temp adjustable		●
	Anti-bacterial		●
	Sensor		●
S&C open	Auto lid open		●
	Foot sensor lid/Seat		●
Light	Knob light		●
	Night light		●
Flushing	Off seat auto flush		●
	Foot sensor flush		●
Deodorization	catalyst deodorization		●

- Standard configuration
- Optional configuration

exploded view

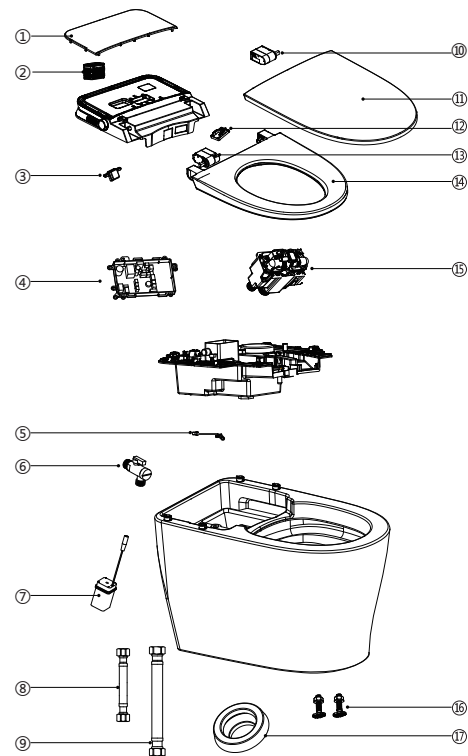

No.	Description
1	Decorative Cover
2	Deodorization Filter
3	Microwave Module
4	Main PCB
5	Night Light
6	Angle Valve
7	Battery Pack
8	23 " (580 mm) Hose
9	28 " (720 mm) Supply Line
10	Gearbox for Lid
11	Lid
12	Gearbox PCB
13	Gearbox for Seat
14	Seat Rim
15	Flush Valve
16	Floor Fixing Bolts & Screws
17	Wax Ring

Catalogue

● Attention	01	Before use
● Packing List	07	
● Product Description	08	
● Precautions Before Installation	10	Installation and Use
● Install The Toilet	11	
● Install Remote Control	13	
● Testing after Installation	14	
● Function Description	15	
● Instructions For Remote Control	18	
● Cleaning and Maintenance	20	Others
● Fault Analysis and Treatment	21	
● Technical Parameters	22	
● Product Environmental Information	23	
● Warranty	24	
● Customer Care	25	

Attention

1. Please read this manual carefully, so that you can use the product correctly. Please do read through all the precautions listed here, which are important content related to safety.
2. After reading, please keep the manual and warranty card together for future reference.
3. Please fill in the purchasing date and place carefully when purchasing.
4. We are not responsible for accidents or injuries caused by failure to install the product in accordance with the method shown in the manual or failure to use the specified components during the installation.

Identifications



Warning

- Warning Misoperation by ignoring the sign may lead to serious injury or death.



Prohibiting

- Prohibited operation.



- Do not disassemble or modify this product without authorization.



- Do not soak or spray.



- Class I appliances must be grounded



Attention

- Misoperation by ignoring the sign may lead to personal injury or property damage.



Compulsory

- Operations must be observed.



- Do not touch with wet hands



- High temperature and flammable materials are prohibited.



- Use of Extension Cords Prohibited

Prohibiting

Precautions for Us

Prevention of low temperature scald

Anyone (including children) that has physical, perception, or intellectual deficiencies or lacks of experience and common sense (including children) are not allowed to use the product without supervision, in consideration of their limited cognitive abilities and/or lack of necessary knowledge, unless they use the product under the supervision or instruction of the person responsible for the use safety of product. Make ensure children are not allowed to use the equipment alone without authorization and that the product is beyond their reach.

Low-temperature burning may happen, if the heated seat ring is in contact with the skin for a long time. Please set the seat ring temperature at [Low gear] or [Off] before using the product, if you are:
Children and the elderly who cannot adjust the temperature to an appropriate level by themselves;
People who cannot move freely, such as the sick and the disabled;
People who are drowsy and overly tired due to hypnotics (such as sleeping pills, cold medicines, etc.).

Warning

Do not disassemble, repair or transform the product by yourself

- It may cause fire, electric shock and other accidents or injuries.

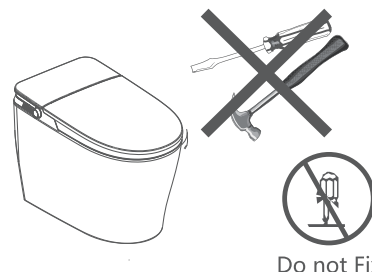

Do not Fix

Do not pour water or detergent on the product or power plug

- It may cause fire, electric shock and other accidents or injuries.

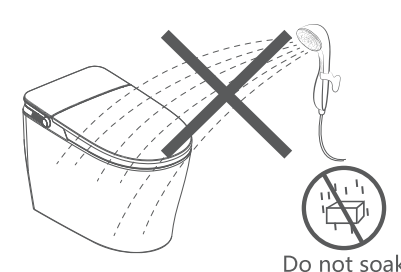

Do not soak

Ground connection: Please ensure that the power receptacle is grounded.

- Non-grounded receptacle may pose an electric shock hazard.

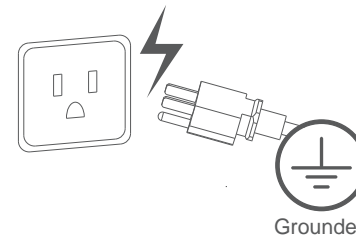

Grounded

Do not use wet hands to plug or unplug the power.

- May cause an electric shock.

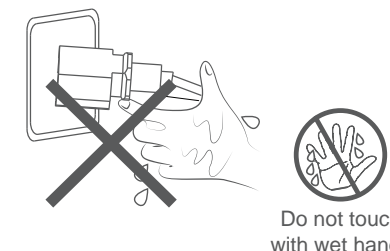

Do not touch with wet hands

Do not use a receptacle that is loose or faulty.

- May cause fire or electric shock.

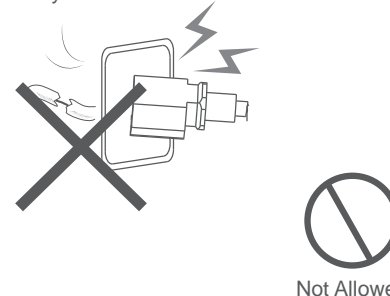

Not Allowed

Do not place heavy objects or stand on the cover of the toilet seat. Do not hit the product.

- Product breakage can result in personal injury.

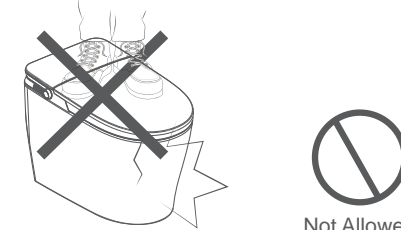

Not Allowed

Do not remove power cord.

- If the power cord is damaged, it must be replaced by a licensed electrician.

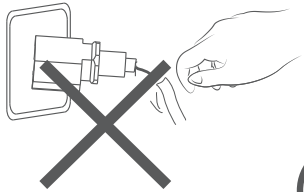

Not Allowed

Use an AC120V,60Hz 15A receptacle.

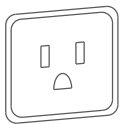

120V ☒
60Hz ☒
Above 15A ☒

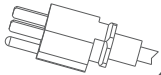

Must

Do not put fingers or other objects in the nozzle.

- May cause electric shock or malfunction.

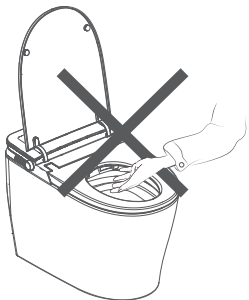

Not Allowed

Do not twist or break supply line.

- Otherwise it may cause a leak.

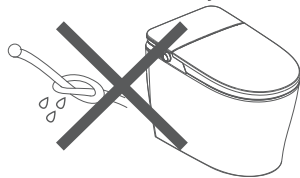

Not Allowed

Please use new (included) Supply line

- Old Supply Line will cause the product to malfunction.



Must

Avoid direct sunlight.

- The toilet may change color and work incorrectly.

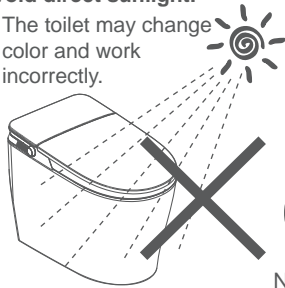

Not Allowed

Do not flush foreign objects

- it may lead to clogging of the toilet and overflow of sewage.

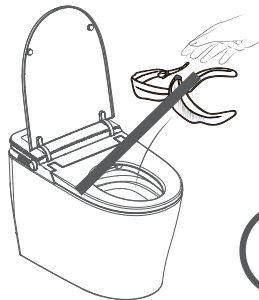

Not Allowed

Do not hit the ceramic with metallic objects to prevent leakage from damage.

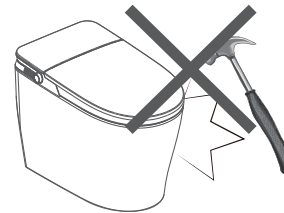

Not Allowed

Do not use below 32°F (0°C).

- Please refer to the instructions on long-term storage or winterizing below 32°F(0°C) .

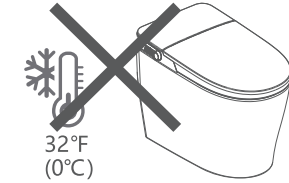

Not Allowed

Please use non-abrasive dish washing detergent for cleaning toilet.

Do not use cleaning chemicals for toilets, volatile agents, abrasive cleaners, etc.



Not Allowed

Do not flush newsprint, sanitary pads and other articles that may clog the toilet.

- it may lead to clogging of the toilet and overflow of sewage.

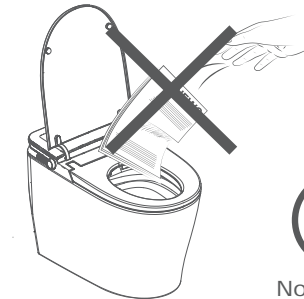

Not Allowed

Please do not use cloth cover or cushion on seat.

- Will cause toilet malfunction.

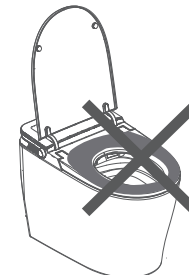

Not Allowed

Do not force the lid or seat closed.

- The product may be damaged.

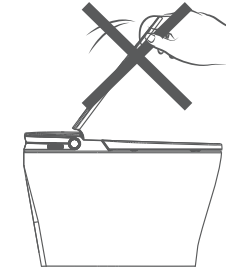

Not Allowed

Disconnect the plug from receptacle for protection against power surges during thunder storms.

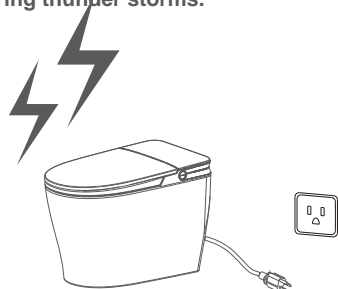

The unit should be unplugged, in case the toilet is backed up.

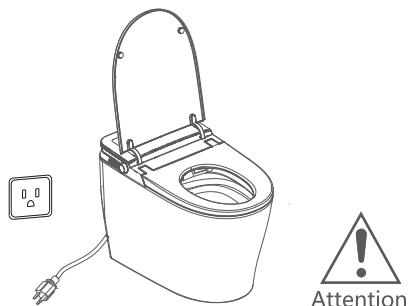

Please do not sit on the lid when it is closed, and do not lean on the lid when it is open.

- It may scratch the lid or it may cause a malfunction.

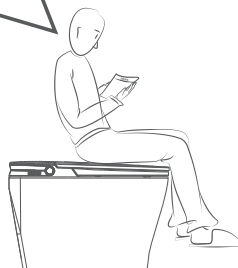
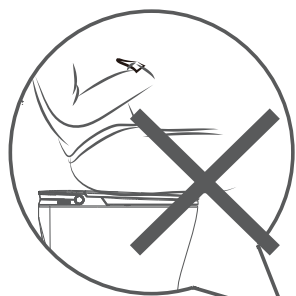

Not Allowed

Do not damage the power cord.

1. Avoid damage, abrasion, or excessive heat for the power cord;
2. Do not bend, kink or pull power cord;
3. Do not place heavy objects or sharp objects on the power cord. Using the toilet with a damaged power cord may result in fire, short circuit, electric shock and other dangerous conditions.

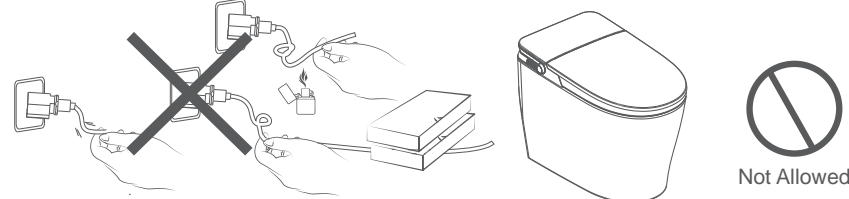

Not Allowed

This is an electronic product, avoid places of high humidity and direct water splashing. Please install a bathroom fan to maintain good ventilation in the bathroom.

- Otherwise it could lead to malfunction, fire or electric shock.

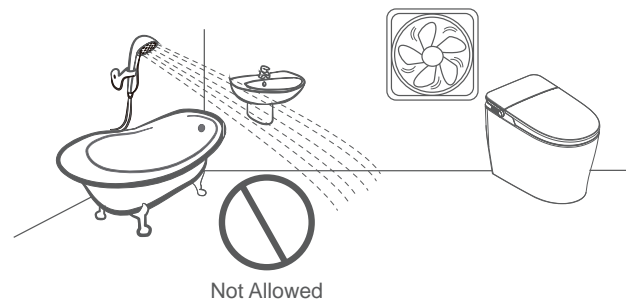

Not Allowed



Must

In case of leakage, close the Angle valve.

- Avoid flooding, slipping or electric shock.

Prevent damage caused by freezing.

- Freezing temperatures will cause water in the supply line and in the toilet to freeze causing damage and water leakage.

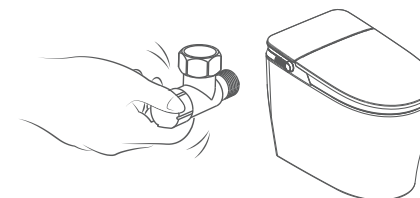

Notice

The product diagrams are for reference only. Your unit might be slightly different

Packing List

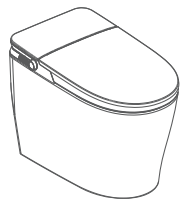

Toilet



Wax Ring

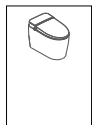

Instructions



Warranty card
(Attached to the manual)

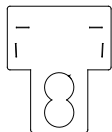

Installation template

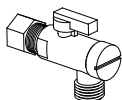

Angle Valve

* Please replace the old valve before installation



Battery box



Screws

Product Description - External Dimensions

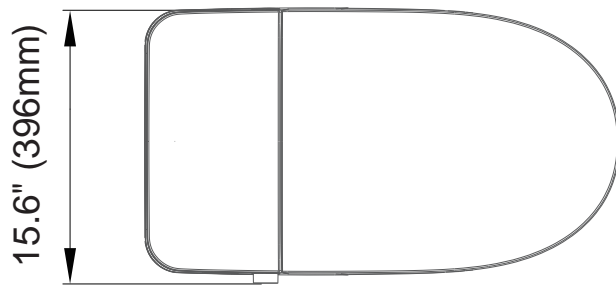
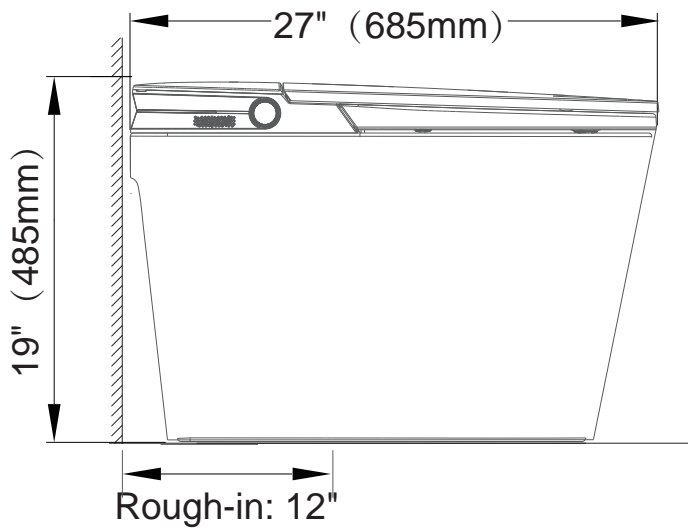

Product Description - Part Name

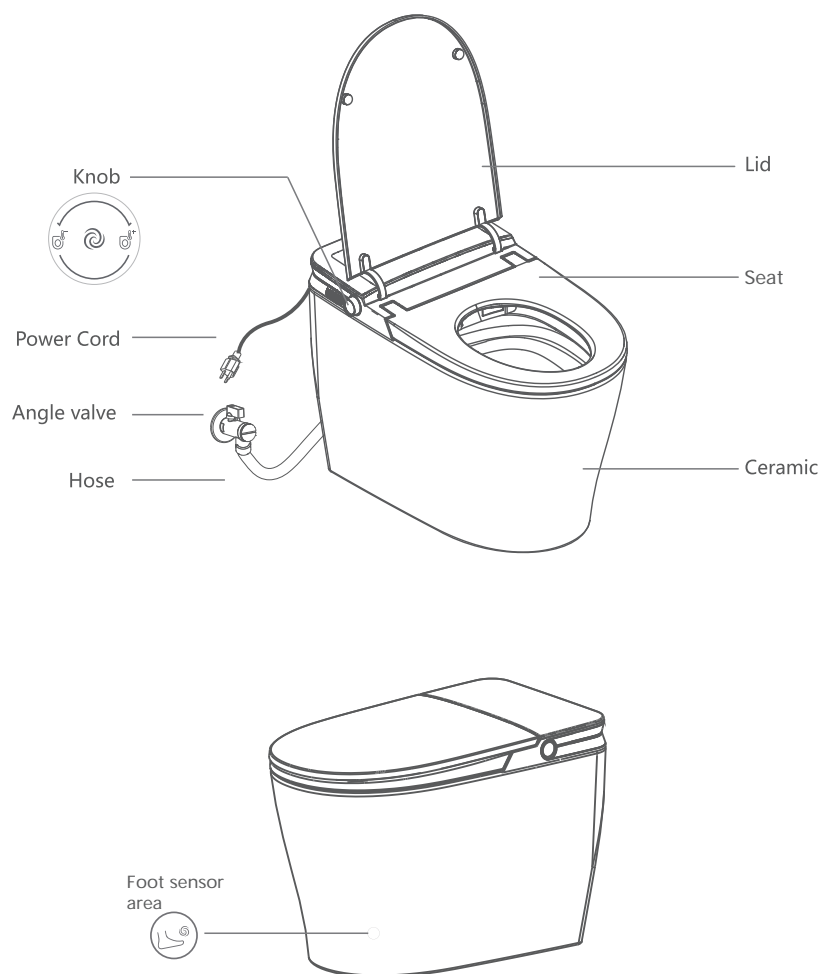

Attention before Installation

Check the Minimum Necessary Water Pressure and Flow Rate

Minimum necessary water pressure: 20psi (0.14Mpa). Minimum flow rate: 4.75gpm (18L/min). The product will not work properly if the pressure or flow rate cannot be reached. (Please refer below if no water pressure test device is available)

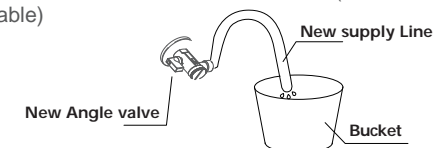

Open the angle valve for 10 seconds. Check water volume. It should be higher than 0.8 Gallons (3 Litres) for the toilet to work properly.

Confirm power supply

The power cord must be plugged into a GFCI receptacle or a receptacle in a GFCI protected circuit complying with: 120V, 60Hz and 15A .

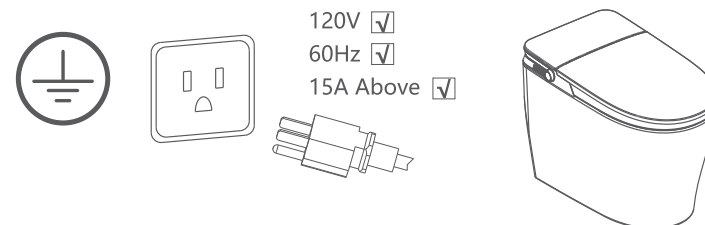

- (1) Do not spray water on the toilet.
- (2) If toilet is below 50 F (10°C), place it in a warm room for 2 hours before installing.
- (3) Failure to comply with the recommendations in the installation manual may lead to personal injury, electric shock or other accidents. Read and follow ALL the manual instructions.

Toilet Installation

Installation Steps

1.Lift the cover upward, unscrew the ring wash flex hose, the main jet flex hose and the foot sensor cable. Remove the cover.

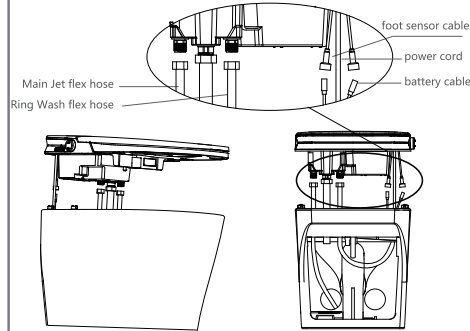

2. Place the installation template as shown below. Confirm rough in. Trace the toilet back and side profile using the hollowed lines on template.

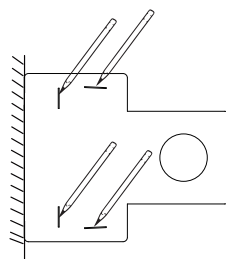

3. Install the supplied angle valve on the corresponding position on the wall.

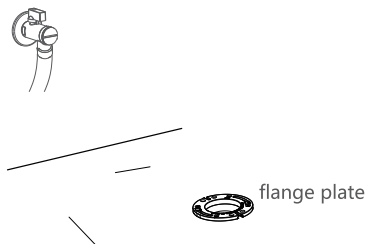

4. Place the bolts into the flange grooves.

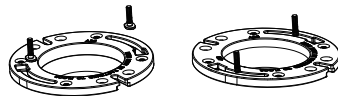

5. Install wax ring centering it on the flange.



6. Install the ceramic aligning the contour line you traced. (Note: the fixing bolts need to pass through the holes at the bottom of the ceramic.)

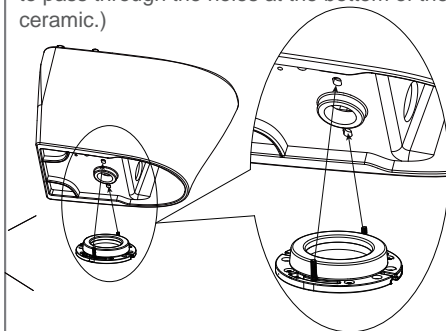

Install Toilet

Installation Steps

7. Install the washers and locking nuts securing the toilet to the flange.

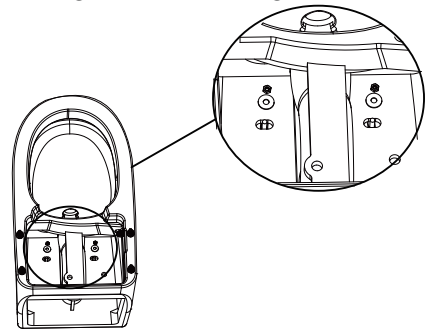

8.Install the ring wash flex hose, the main jet flex hose and the foot sensor connection cable.Align 4 posts in the ceramic with the holes in the back part of the cover and push down.

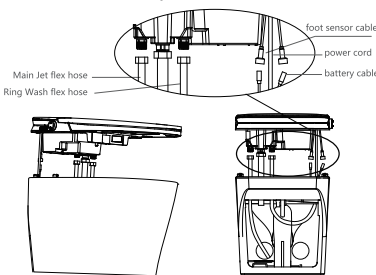

9.Connect the supply line to the angle valve.

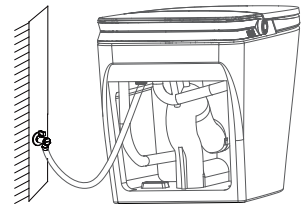

Testing after Installation

1. Turn on the angle valve

- Open the angle valve a little bit. Check for leaks.
- Open the valve completely after checking everything is dry.



2. Product self-diagnosis

- After connecting to the power supply, the product will give a "beep" sound. Knob lamp will go on indicating the completion of self-diagnosis.

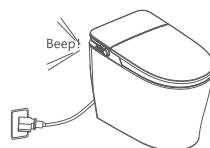

3. Product test

Flushing test

- Press the flush button on the knob to flush the toilet.

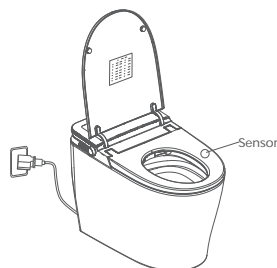

3. Drainage inspection

Before applying the caulking, please flush the toilet several times to see if there is any leakage in the ceramic. After inspection caulk around the ceramic. Make sure that the ceramic is sealed in place.

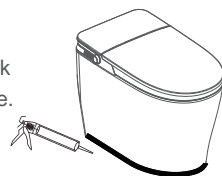

Function Description

Power-on Self-diagnosis

1. Each time the toilet is plugged in, all lights will be on, a "beep" will sound and all functions will be reset to factory settings.
2. Seat temperature will reset to 91 °F (33 °C).

Knob Functions



1. Turn the knob clockwise to raise the seat temperature. Turn the knob counterclockwise to lower the seat temperature.

- Prompt sound "didi" indicates highest temperature level has been reached.

- Prompt sound "di" indicates lower one level of temperature.

- Prompt "long beep" indicates seat heating is off.

2. Short press the knob to perform a big flush.

3. When nobody is seated, long press the knob to turn all lights on/off.

4. When someone is seated, long press the knob to turn the prompt sound on/off.

5. In the setting mode, Long press the button again and turn on the microwave distance setting the white light will flash at 4 Hz:

- The default range of clockwise rotation is 0.2-0.4m "beep" for level 1

- 0.2-0.8m "beep, beep" for level 2

- 0.2-1.2m "beep beep, beep" for level 3

- Turn off the microwave "long beep"

Other Function Description

Other Functions

1. Low temperature scald prevention seat function.

After sitting down, the system will enter the low-temperature scald prevention mode automatically.

2. Foot sensor lid/seat open and flushing function

(1) When both the lid and seat are closed, the lid will open automatically once the user touches the foot sensor area.

(2) When the lid is open and seat is closed, the seat will open automatically once the user touches the foot sensor area.

(3) When the lid and seat are open, both of them will close and start small flushing once the user touches the foot sensor area.

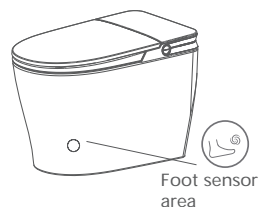

3. Automatic flush

The toilet will close seat, close lid and flush automatically after 1 minute of leaving the toilet area (If a flush is executed before the lid closed, the toilet won't flush automatically again.)

4. Auto lid open function

(1) When someone walks to the toilet and into the sensing area, the lid will open automatically.

(2) The lid will close automatically after 1 minute someone leaves the sensing area.

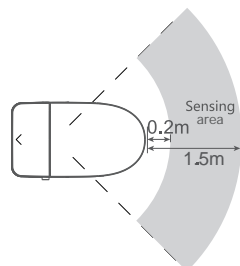

Other function description

5. Power off flush function

When power is off, the lithium battery will take over. Short press the knob to flush.

No other functions will work.

Changing / adding batteries



1. Open the battery pack with a phillips screwdriver.

2. Remove the battery tray.

3. Load 4 size AA batteries into the battery tray being careful with the polarity of the batteries.

4. Reassemble the battery pack and install in the toilet.

Reminder

1. This toilet is designed to flush using batteries during a power outage. Check batteries at least once a year to ensure they are in good working condition.

2. Strictly follow the "+" and "-" signs in the battery pack when inserting batteries. Reverse connecting batteries may cause battery damage and safety hazards such as explosion or combustion.

3. Only size AA batteries should be used. Old and new batteries should not be mixed. Different models and brands of batteries should not be mixed. When replacing batteries, all of them should be replaced at the same time.

4. Handle battery pack with care. After replacing the batteries, make sure the battery pack is securely locked and sealed to prevent bathroom moisture from entering the compartment (this could cause battery corrosion and damage).

5. When replacing batteries, disconnect the battery compartment from the main unit.

6. DO NOT USE RECHARGEABLE BATTERIES.

Cleaning and Maintenance

1.Maintenance of product surface and ceramics.

The detachable accessories can be removed before maintenance

Note before maintenance:

- (1)Make sure the power supply is disconnected.
- (2) Do not let water enter the product during the maintenance process.
- (3) Be sure to wipe off any detergent after cleaning to avoid residue at the gap between the main ceramic body and the cover.

● Product surface cleaning

Wet a soft cloth with water, wring it, and then wipe the product. If the toilet is dirty, you can use a soft cloth with a little of diluted neutral detergent to clean it. Then use a clean damp cloth to wipe it clean.

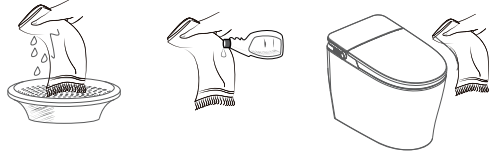

2.Maintenance of valve if water performance is low

- 1. Turn off the angle valve. Unscrew the filter screen cap at the front of the valve with a straight screwdriver.
- 2. Use a small brush to scrub the filter screen, and flush away debris with clean water.
- 3. Reinstall the filter on to the angle valve and tighten it.



Troubleshootings

Problem	Check	Solution
The toilet does not work.	Check whether cloth covers, cushions, etc. are being used on the seat sensing area.	Remove cloth covers, cushions or any other item.
	Check if there is a power outage.	Wait for power supply recovery.
	Check if the plug is loose or making poor contact	Plug in to ensure good power supply.
The seat is not heating	Check if there has been electricity leakage (the GFCI receptacle indicator light is off or the GFCI breaker has tripped)	Unplug the power plug. Press the reset button on the GFCI receptacle or reset the GFCI breaker. If it still does not work, contact customer service.
	Check if the seat temperature is set to low or off.	Reset the seat temperature using the seat temperature knob.
Toilet light and knob light don't work.	Check if there is a power outage.	Wait for power supply recovery.
The toilet does not flush.	Check if the fault still exists after doing a reset by unplugging, waiting 30 seconds and re-plugging unit..	Contact customer service.
	Angle valve is closed.	Open the angle valve.
	The filter is blocked.	Refer to Maintenance of the Valve.
The toilet doesn't flush properly.	The filter is blocked.	Refer to Maintenance of the Valve.

Product Technical Parameters

Items		CSTPA0
Rated Voltage		120V ~ , 60Hz
Rated Power*		55W
Power Cord Length		about 1.1m
Water Supply Pressure		Min. Dynamic pressure: 20psi (0.14 MPa). Max. Static pressure: 110psi (0.75MPa).
Water Supply Temperature		41~95°F (5~35°C)
Waterproof Level		IPX4
Toilet Flush		≤1.26G(4.8L)
Seat Ring Heating	Heater power	50W
	Safety equipment	Thermostat + fuse
	Surface temperature	3 levels: aprox. 91/100 °F /off (33/38 °C /off)
Others	Antibacterial material	Seat ring
	Low temperature scald protection	Included
	Prompt for abnormalities	Alarm sound
	Seat sensing	Included
	Light control	Included

Rated Power:
This product's energy consumption is tested under the following conditions: at an ambient temperature of 73±3.6°F,with the seat heating set to its maximum temperature setting. The test is conducted after the seat heating has stabilized for 15 minutes, measuring the power consumption over five cycles of 3 minutes each, and then calculating the average.

Product Environmental information

Part name	Harmful substances					
	(Pb)	(Hg)	(Cd)	(Cr(VI))	(PBB)	(PBDE)
PCBA	X	O	O	O	O	O
Plastic parts	O	O	O	O	X	X
The motor	X	O	O	X	O	O
Others	X	O	O	O	O	O

This form is prepared according to the provisions of SJ/T11364

O : Indicates that the content of the hazardous substance in all homogeneous materials of the component is below the limit specified in CB/T26572

X : Indicates that the content of the hazardous substance in all homogeneous materials of the component exceeds the limit specified by CB/T26572

The number in this label indicates that the environmental protection period of the product in normal use is 10 years

WARRANTY

CTM Maison Elite Inc. grants this limited warranty to the original purchaser of this Smart Toilet from the date of purchase. Proof of purchase is required when requesting any warranty assistance.

Ceramic,imited 10 years:If any of the ceramic parts of your Smart Toilet fails during your first 10 years of ownership due to a defect in material or workmanship, as determined solely by CTM Maison Elite Inc, we will provide you with a replacement ceramic basin.If no replacement ceramic can be provided for your Smart Toilet, we will provide a comparable or superior replacement ceramic or Smart Toilet at our sole discretion.

Other Parts, Limited One year:CTM Maison Elite Inc. warrants that all other parts, to be free from defects in workmanship and material at the time of manufacture for a period of one year. We agree to send a replacement part without charge or at our option replace it with a comparable or superior part.

To the extent permitted by law, CTM Maison Elite Inc. disclaims any and all warranties.including but not limited to those of merchantability and fitness for a particular purpose.There is no other express warranty. The duration of any implied warranty which cannot be disclaimed is limited to the period specified in the express warranty. Some states do not allow a limitation on how long an implied warranty lasts. The time limitation may not apply to you. Some states do not allow the exclusion of incidental or consequential damages, so the above limitation may not apply to you. This warranty gives specific legal rights. You may also have other rights which vary from state to state. The retailer shall not beliable for incidental, consequential, or damages arising out ofor in connection with product use or performance except as may otherwise be accorded by law.

This limited warranty is non-transferable and only to the original purchaser of this Waste Disposer and will be void if unit is removed from its original installation.

This warranty does not cover: ordinary wear and tear, minor cosmetic blemishes, batteries light bulbs, refurbished units, Smart Toilets that are not owned by the original purchaser,acts of God, plugging, overflowing, flooding, changes in finish including pitting, tarnishing,calcium or mineral deposit marks.

Damage to any part by accident, misuse, abuse, improper installation, improper care and maintenance, improper electric supply or power surge, failure to follow the in structions in the enclosed manual or by any modification to the unit are not covered by this warranty.

All costs of shipping parts, removing, repair labour and reinstalling the product are not covered by this warranty. Please do not ship your Smart Toilet or any parts to CTM Maison Elite Inc. Shipment will not be accepted.

This warranty supersedes al prior warranties.

FOR WARRANTY PURPOSES PLEASE REGISTER YOUR PRODUCT.

Customer Care

Thank you for purchasing a FORNO ACQUA product. Please read the entire instruction manual before operating your newappliance for the first time. Whether you are an occasional user or an expet, it will be beneficial to familiarize yourself with the safety practices, features, operation and care recommendations of your appliance. Both the model number and serial number are listed on the product., For warranty purposes, you will also need the date of purchase. Record this infomation below for future reference.

Record this information below for future reference

Product Information	Service Information
Model Number: _____	Use these numbers in any correspondence or services calls concerning your appliance.
Serial Number: _____	If you received a damaged appliance, immediately contact the dealer (or builder) that sold you the appliance.
Date of Purchase: _____	
Purchase Address And Phone: _____ _____ _____	Save time and money. Before you call for service, check the Troubleshooting Guide. It lists the causes of minor operating problems that you can correct yourself.

CUSTOMER SERVICE:

Keep the instruction manual handy to answer your questions. If you don't understand something or you need more assistance, please call our Customer Service: **1-866-231-8893** or email: **mysupport@fornoworld.com**

Our contact:CTM Maison Elite inc.
11420 Albert Hudon, Montréal, Québec H1G 3J6, Canada

The instruction manual can be downloaded from www.fornoworld.com.