

机
型
编
号

TYPE

厦门融技精密科技有限公司

研发部文件受控章

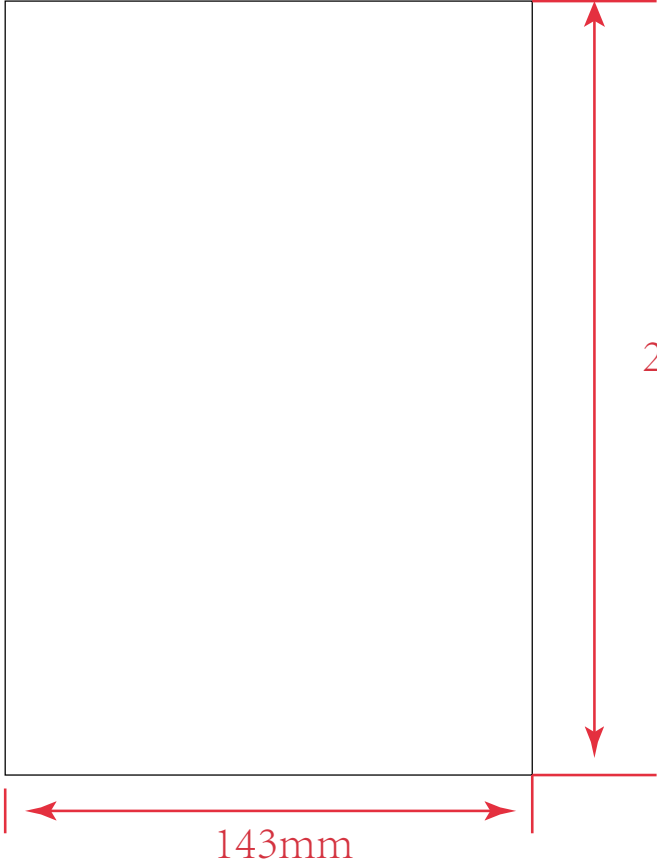

版本 REV.	修改记录 MODIFICATION	日期 DATE	签名 SIGN
1.0	新建	2025.01.13	周立志
2.0	版面更新	2025.04.03	周立志

设计 DRAWN BY	周立志	2025.04.03	材质 MATERIAL	100G双胶纸	名称 TITLE	说明书/143*210mm/S16 Lite/ 英文/FWL
审核 CHECKED	周立志	2025.04.03	颜色 COLOR	单黑印刷	编号 PART NO.	5606471
批准 APPROVAL	周立志	2025.04.03				
单位 UNIT	mm		备注 OTHER	印刷清晰，裁切整齐	<div>R&J</div> <div>厦门融技精密科技有限公司</div> <div> XIAMEN R&J PRECISION TECHNOLOGY CO., LTD</div>	
公差 TOLERANCE	± 1					

修订履历

版本：1.0版

[illegible]

Maintenance Record

Maintenance Record			
Date	Maintenance Projects	Maintenance Department	Signature



Model: S16 Lite

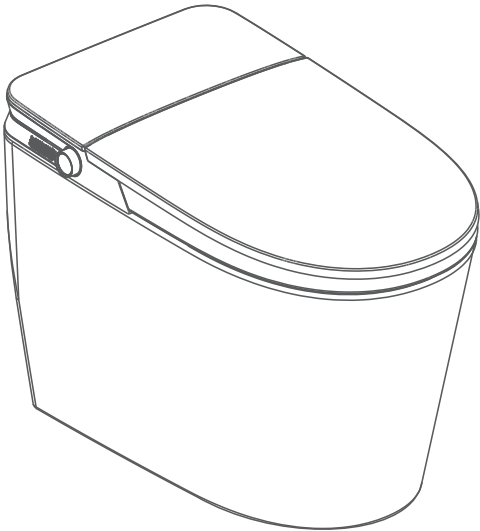

Rivix®
Smart Toilet
Installation Manual

Thank you for choosing our product.
Please read the instructions carefully before installation and keep it available for future maintenance or reference.

Radio frequency specification of remote control

FCC:

This device complies with Part 15 of the FCC Rules. Operation is subject to the following two conditions: (1) this device may not cause harmful interference, and (2) this device must accept any interference received, including interference that may cause undesired operation.

Changes or modifications to this unit not expressly approved by the party responsible for compliance could void the user's authority to operate the equipment.

NOTE: This equipment has been tested and found to comply with the limits for a Class B digital device, pursuant to Part 15 of the FCC Rules. These limits are designed to provide reasonable protection against

harmful interference in a residential installation. This equipment generates uses and can radiate radio frequency energy and, if not installed and used in accordance with the instructions, may cause harmful interference to radio communications.

However, there is no guarantee that interference will not occur in a particular installation. If this equipment does cause harmful interference to radio or television reception, which can be determined by turning the equipment off and on, the user is encouraged to try to correct the interference by one or more of the following measures:

- Reorient or relocate the receiving antenna.
- Increase the separation between the equipment and receiver.
- Connect the equipment into an outlet on a circuit different from that to which the receiver is connected.
- Consult the dealer or an experienced radio/TV technician for help.

IC:

This device contains licence-exempt transmitter(s)/receiver(s) that comply with Innovation, Science and Economic Development Canada's licence-exempt RSS(s). Operation is subject to the following two conditions:

(1) This device may not cause interference.

(2) This device must accept any interference, including interference that may cause undesired operation of the device.

L' émetteur/récepteur exempt de licence contenu dans le présent appareil est conforme aux CNR d' Innovation, Sciences et Développement économique Canada applicables aux appareils radio exempts de licence. L' exploitation est autorisée aux deux conditions suivantes :

1) L' appareil ne doit pas produire de brouillage;

2) L' appareil doit accepter tout brouillage radioélectrique subi, même si le brouillage est susceptible d' en compromettre le fonctionnement.

IMPORTANT SAFEGUARDS

When using electrical products, especially when children are present, basic safety precautions should always be followed, including the following READ ALL INSTRUCTIONS BEFORE USING

DANGER-To reduce the risk of electrocution:

1. Do not use while bathing.
2. Do not place or store product where it can fall or be pulled into a tub or sink.
3. Do not place in or drop into water or other liquid.
4. Do not reach for a product that has fallen into water, Unplug immediately.

WARNING-To reduce the risk of burns, electrocution, fire, or injury to persons.

1. Close supervision is necessary when this product is used by, on, or near children or on, or near children or invalids.
2. Use this product only for its intended use as described in this manual. Do not use attachments not recommended by the manufacturer.
3. Never operate this product if it has a damaged cord or plug, if it is not working properly, if it has been dropped or damaged, or dropped into water. Return the product to a service center for examination and repair.
4. Keep the cord away from heated surfaces.
5. Never block the air openings of the product or place it on a soft surface, such as a bed or couch, where the air openings may be blocked. Keep the air openings free of lint, hair, and the like.
6. Never use while sleeping or drowsy.
7. Never drop or insert any object into any opening or hose.
8. Do not use outdoors or operate where aerosol (spray) products are being used or where oxygen is being administered.
9. Connect this product to a properly grounded outlet only. See Grounding Instructions.
10. Fill reservoir with water only unless otherwise specified by manufacturer.

SAVE THESE INSTRUCTIONS

GROUNDING INSTRUCTIONS

this product should be grounded in the event of an electrical short circuit, grounding reduces the risk of electric shock by providing an escape wire for the electric current. This product is equipped with a cord having a grounding wire with a grounding plug. The plug must be plugged into an outlet that is properly installed and grounded.

DANGER — Improper use of the grounding plug can result in a risk of electric shock. If repair or replacement of the cord or plug is necessary, do not connect the grounding wire to either flat blade terminal. The wire with insulation having an outer surface that is green with or without yellow stripes is the grounding wire. Check with a qualified electrician or serviceman if the grounding instructions are not completely understood, or if in doubt as to whether the product is properly grounded.

This product is for use on a nominal 120 V circuit, and has a grounding plug that looks like the plug illustrated in sketch A. A temporary adapter, which looks like the adapter illustrated in sketches B and C, may be used to connect this plug to a 2-pole receptacle as shown in sketch B if a properly grounded outlet is not available. The temporary adapter should be used only until a properly grounded outlet (sketch A) can be installed by a qualified electrician. The green colored rigid ear, lug, and the like extending from the adapter must be connected to a permanent ground such as a properly grounded outlet box cover. Whenever the adapter is used, it must be held in place by the screw.

Grounding methods

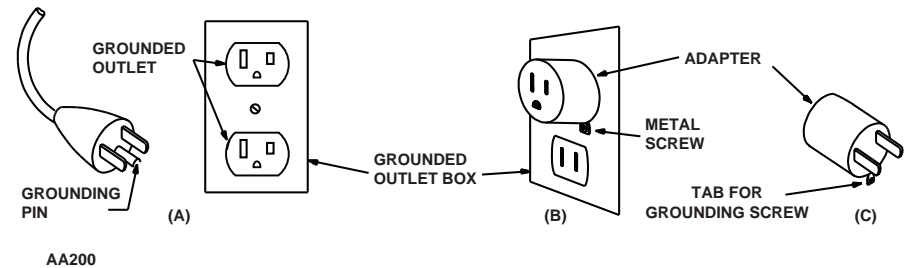

Function

Function		Model	S16 Lite
Heating mode	FC Instant heating		●
Wash	Thermostatic cleaning		●
	Rear cleaning		●
	Lady cleaning		●
	Self-clean nozzle		●
	Water temp adjustable		●
	Flow rate adjustable		●
	Cold & hot cleaning		●
	Child model		●
	Oscillating Wash		●
Seat	Seat temp adjustable		●
	Anti-bacterial		●
	Sensor		●
S&C open	Auto lid open		●
	Foot sensor lid/Seat		●
Light	Night light		●
Warm air	Wind temp adjustable		●
	Start key		●
Flushing	Off seat auto flush		●
	Power off flush		●
	Foot sensor flush		●
Controller	Side knob		●
	Remote control		●

- Standard configuration
○ Optional configuration

Catalogue

● Attention	01	Before using
● Packing List	07	
● Product Description	08	
● Attetion Before Installation	10	Installation and use
● Install Toilet	11	
● Install Remote Control	13	
● Testing After Installation	14	
● Function Description	15	
● Function Description-Remote Control	17	
● Cleaning And Maintenance	19	others
● Troubleshootings	20	
● Product Technical Parameters	22	
● Product Environmental information	23	
● Warranty Card	24	
● Maintenance Record	25	

Attention

1. Please read this manual carefully, so that you can use the product correctly. Please do read through all the precautions listed here, which are important content related to safety.
2. After reading, please keep the manual and warranty card together for future reference.
3. Please fill in the purchasing date and place carefully when purchasing.
4. We are not responsible for accidents or injuries caused by failure to install the product in accordance with the method shown in the manual or failure to use the specified components during the installation.

Identifications



Warning

- Warning Misoperation by ignoring the sign may lead to serious injury or death.



Prohibiting

- Prohibited operation.



- Do not disassemble or modify this product without authorization.



- Do not soak or spray.



- Class I appliances must be grounded



Attention

- Misoperation by ignoring the sign may lead to personal injury or property damage.



Compulsory

- Operations must be observed.



- Do not touch with wet hands



- High temperature and flammable materials are prohibited.

Precautions for Us

Prevention of low temperature scald

Anyone (including children) that has physical, perception, or intellectual deficiencies or lacks of experience and common sense (including children) are not allowed to use the product without supervision, in consideration of their limited cognitive abilities and/or lack of necessary knowledge, unless they use the product under the supervision or instruction of the person responsible for the use safety of product. Make ensure children are not allowed to use the equipment alone without authorization and that the product is beyond their reach.

Low-temperature burning may happen, if the heated seat ring is in contact with the skin for a long time. Please set the seat ring temperature at [Low gear] or [Off] before using the product, if you are:

Children and the elderly who cannot adjust the temperature to an appropriate level by themselves;
People who cannot move freely, such as the sick and the disabled;
People who are drowsy and overly tired due to hypnotics (such as sleeping pills, cold medicines, etc.).

Warning

Do not disassemble: Absolutely do not disassemble, repair or transform the product by yourself.

- It may cause fire, electric shock and other accidents.

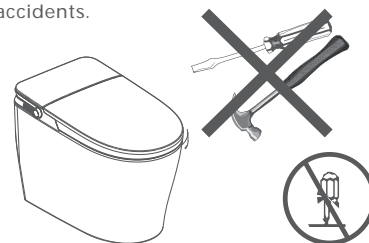

Prohibited remove

Do not spray: Do not pour water or detergent on the product or power plug.

- It may cause fire, electric shock and other accidents.

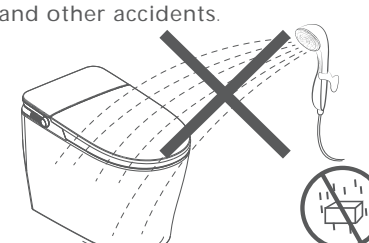

Prohibited spray

Ground connection: Please check whether the power socket is grounded.

- Ungrounded may pose an electric shock hazard.

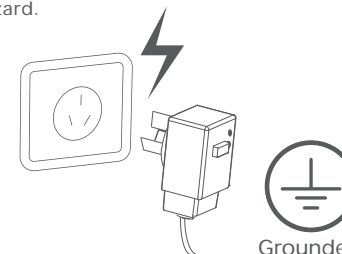

Grounded

Do not touch with wet hands: Do not use wet hands to plug or unplug the power.

- It could cause an electric shock.

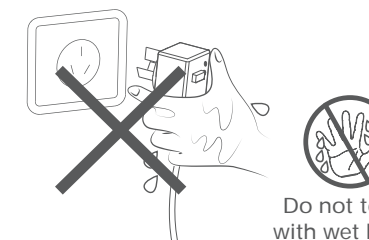

Do not touch with wet hands

Do not approach products such as lit cigarettes or burning species.

- It could start a fire.

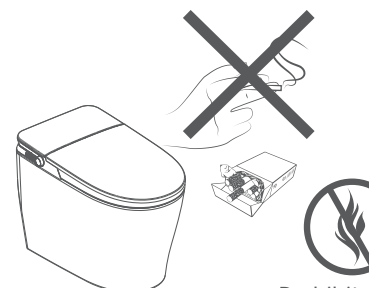

Prohibited fire

Do not stand heavy objects or people on the cover of the toilet seat, and do not hit the product.

- Product fragmentation can result in personal injury

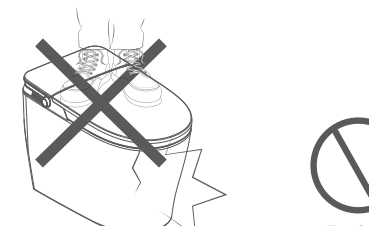

Forbid

Please use tap water or potable well water.

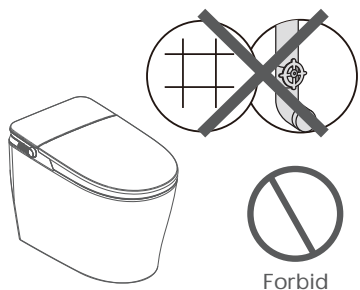

Do not twist or break the inlet pipe.

- Otherwise it may cause a leak.

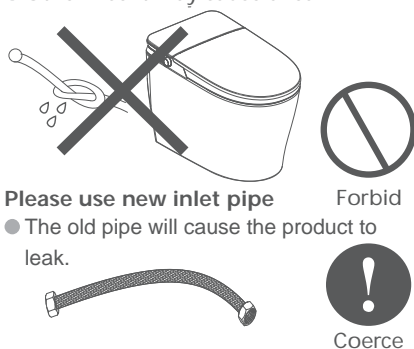

Please use new inlet pipe

- The old pipe will cause the product to leak.



Forbid



Coerce

Do not use a socket that is too loose or faulty.

- May cause fire or electric shock.

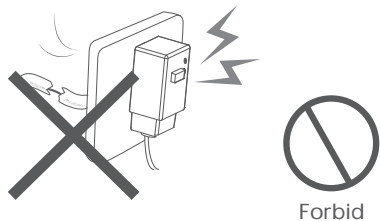

Forbid

Do not remove power cord by yourself.

- If the power cord is damaged, it must be replaced by the manufacturer or its maintenance department.

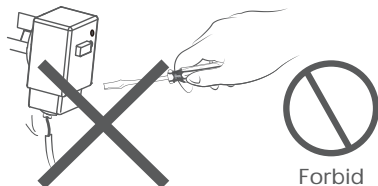

Forbid

Do not put fingers or other objects into the nozzle outlet.

- May get electric shock or burn out.

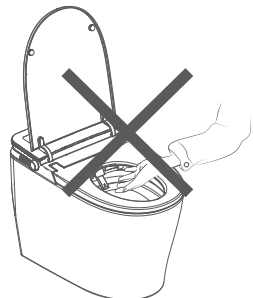

Forbid

Do not flush other things

- it may lead to clogging of the toilet and overflow of sewage.

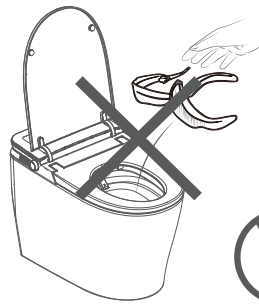

Forbid

Do not hit the ceramics with gravity to prevent leakage from damage.

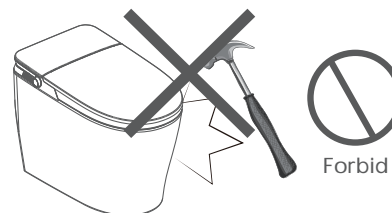

Forbid

Do not use at 32°F or below.

- Below 32°F, please refer to the instructions on long-term non-use.

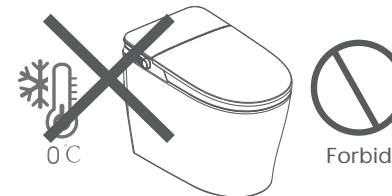

Forbid

Please use kitchen cleaning agent (neutral) during maintenance.

Do not use the following items:

Cleaning agents for toilets, residential cleaning agents, volatile agents, banana oil, etc.



Forbid

Do not flush newsprint, paper urinal pad, feminine sanitary towel and other articles that are easy to jam into the toilet.

- it may lead to clogging of the toilet and overflow of sewage.

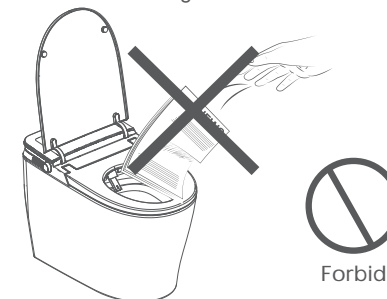

Forbid

Please insert the power plug into the ac AC120V, 60Hz or above 13A (including) socket.

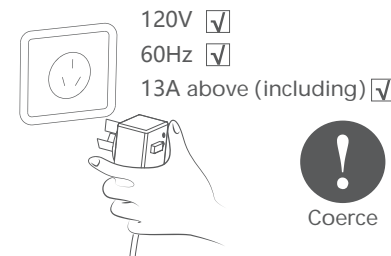

120V ✓

60Hz ✓

13A above (including) ✓

Coerce

Please avoid direct sunlight.

- the product itself may change color and work incorrectly.

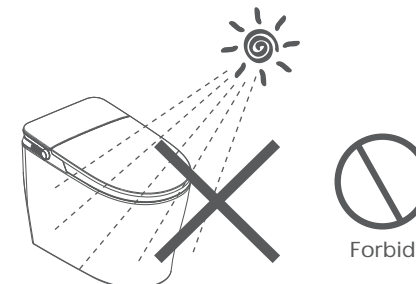

Forbid

In case of thunder, disconnect the plug from the socket.

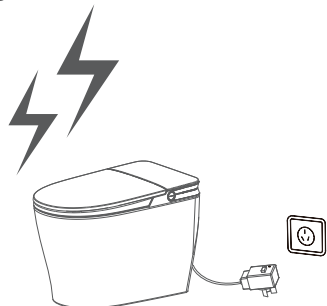

Do not forcibly close the stool cover and seat ring.

- The product may be damaged.

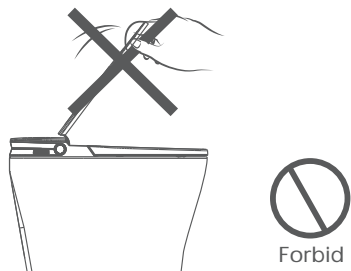

Please do not use cloth cover or cushion in the circle.

- May cause the seat induction is not good.

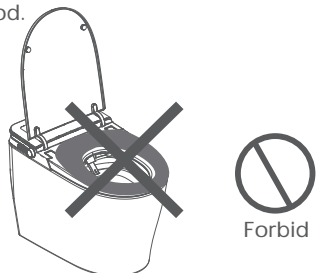

When the toilet is blocked, the power must be turned off, in case the sewage does not pass the flushing baffle.

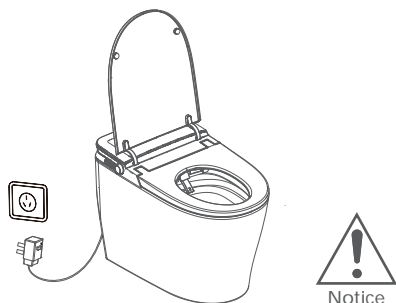

Please do not sit on the seat cover when it is closed, and do not lean on the seat cover when it is open.

- Otherwise it may scratch the seat cover and cause a malfunction.

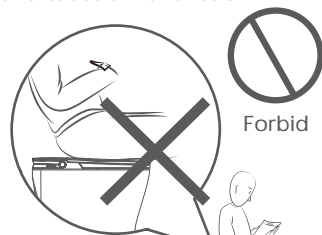

Do not damage the power cord.

1. No damage, no processing, no heating;
2. do not bend, do not curl, do not pull;
3. Do not place heavy objects on the power cord.

Failure to use the product despite damage may result in fire, electric short circuit and other conditions.

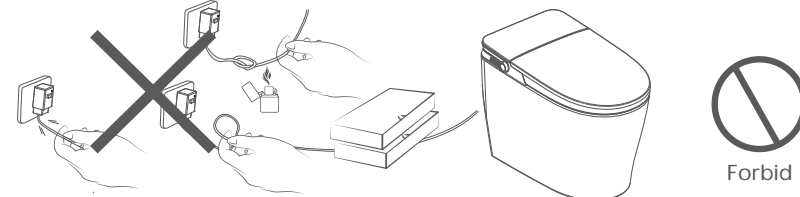

This product belongs to electrical products, so do not put it in the place of water or high humidity. Please install it when using it in the bathroom A ventilator or a ventilator outlet maintains good ventilation in the bathroom.

- Otherwise it could lead to fire or electric shock.

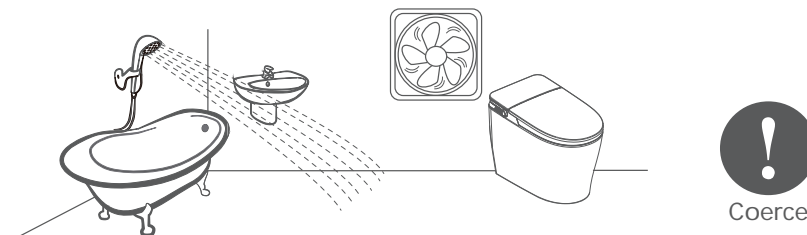





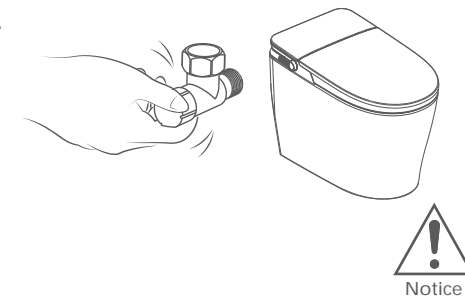

In case of leakage, close the inlet Angle valve.

Prevent damage caused by freezing.

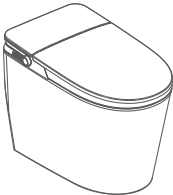
- Freezing will cause water inlet hose and product internal damage, and then cause water leakage.

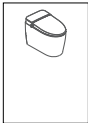

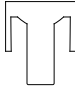
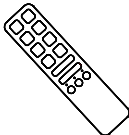
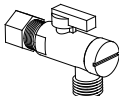
Packing List

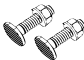
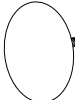
	
Toliet	Seal Sludge
	
Instructions	Warranty card (Attached to the manual)
	
Install template	Remote control
	
T- Valve	Battery box
* Please replace the valve before installation	
	
Screw	Decorative cover

Product Description - External Dimensions

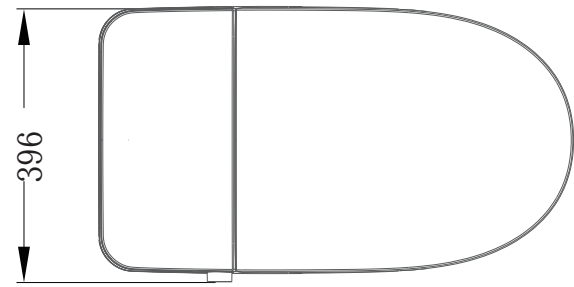
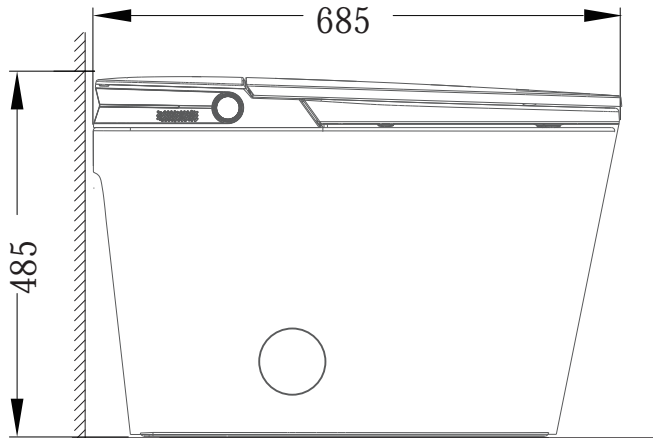

Unit: mm

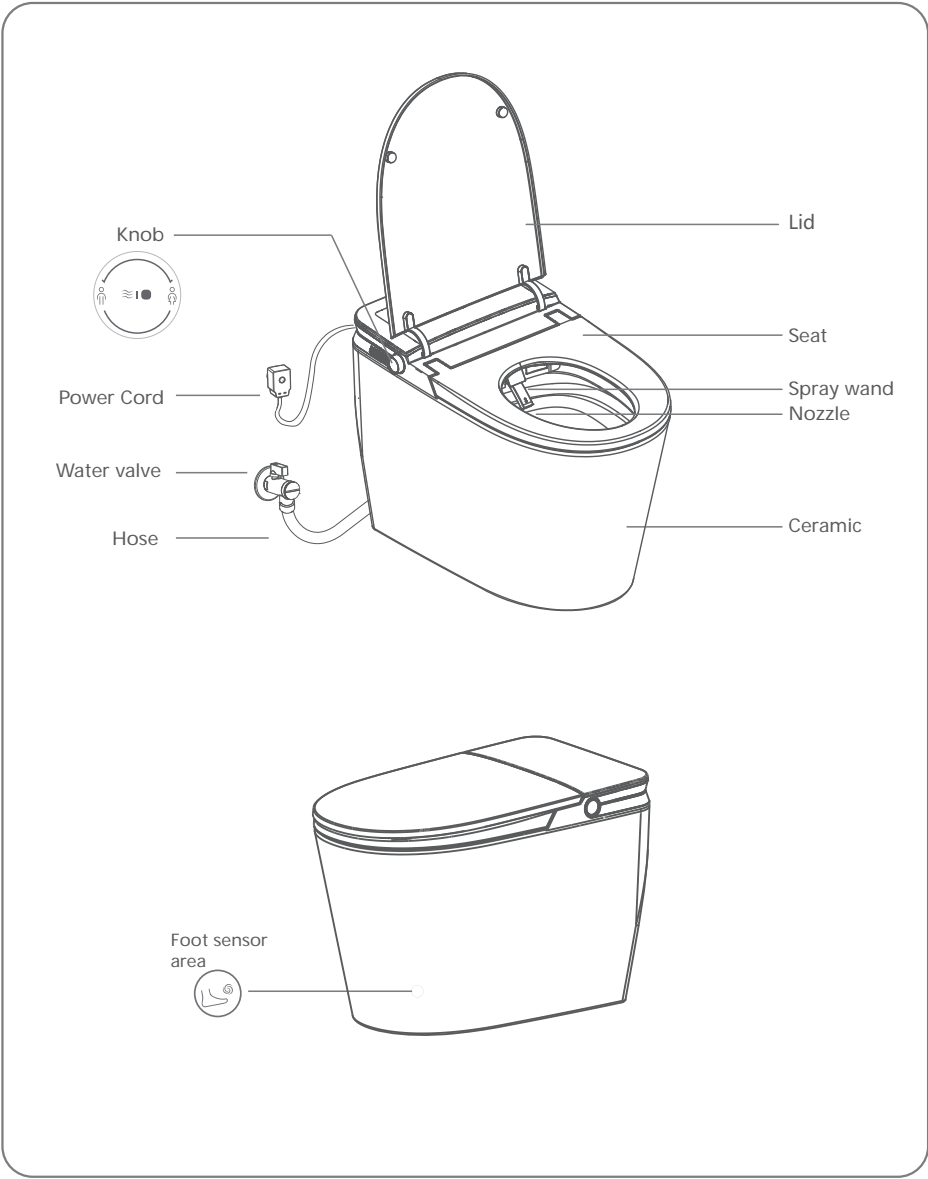

Product Description - Part Name



Attetion Before Installation

Confirm

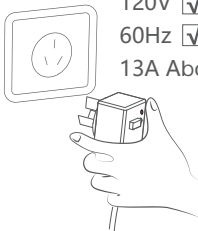
The power cord must be plugged into a socket with safety grounding above 120V, 60Hz and 13A (including).



120V ☒
60Hz ☒
13A Above ☒

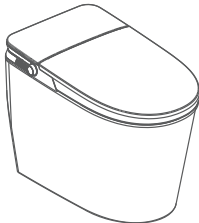



Notice

(1) Do not spray water on the toilet.

(2) If installed in cold environment, please keep it in a warm room for 2 hours before installation.

(3) In case of accident or failure to use specified parts during installation due to failure to install according to the method shown in the installation instructions In the event of injury, the company is not responsible.

Install Toilet

Installation Steps

1. Confirm the drain holes center and place the installation template as shown in below picture. Trace the toilet profile at backside along the hollowed position on template

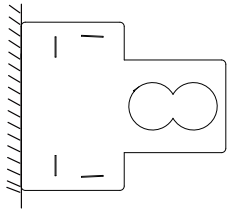

2. Install the angle valve on the corresponding position of the wall.



3. Place the bolt into the flange notch.

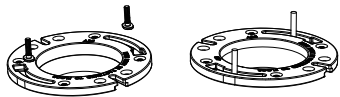

4. Align center the flange and putting sealing sludge.

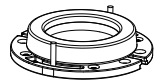

5. Install the ceramic align its contour line.
(Note:the fixing block needs to pass through the hole at the bottom of the ceramic.)

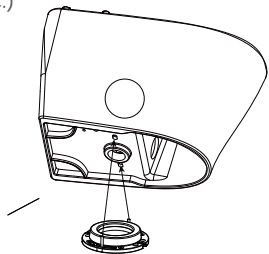

6. Secure the toilet to the floor with screws through the side opening.

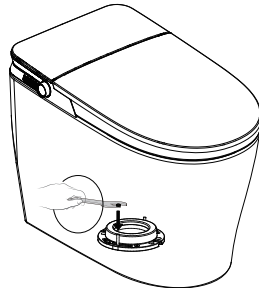

Install Toilet

Installation Steps

7. Attach the trim plate to the toilet

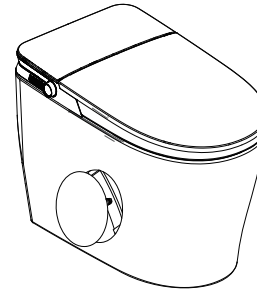

8. Flush several times to check for leaks.

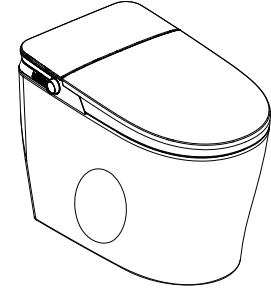

Install Remote Control

1.Remote control installation

Installation location: The figure shows the recommended installation location for the remote control. The installation location can be selected according to the actual use at home.

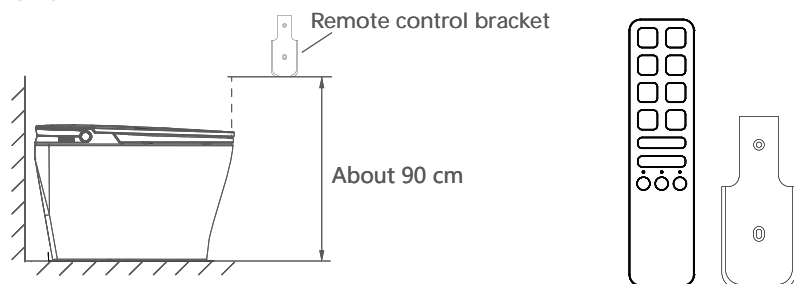

Installation steps:

- ① Drill two holes with a diameter of 6mm on the wall with a depth of more than 45mm, the distance between two holes is the same as the distance between the installation holes of the remote control.
- ② Insert the two expansion pipes in the accessory package into the two holes on the wall respectively.
- ③ Tear the double-sided adhesive tape off the remote control bracket, paste the remote control bracket on the wall, pay attention to align the hole of the remote control with the hole on the wall.
- ④ Fix the remote control bracket with two screws in the accessories package.
- ⑤ Open remote control battery cover, put the batteries in and put back battery cover.
- ⑥ Place the remote control on the bracket.

2. Match remote control

After the battery is loaded into the remote control, it can be used normally.

If the product has no action, the remote control can be repaired in the following ways:

- ① Disconnect the power supply.
- ② Long press the stop button of the remote control until the gear light flashes.
- ③ Put the remote control close to the flush button, and then turn on the power.
- ④ The gear light stops flashing when the match is successful.

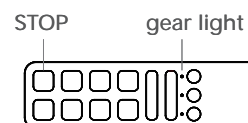

Testing After Installation

1.Turn on the angle valve

- Open the valve a little bit, observe whether there is leakage in each installation part.
- After confirming, open the valve completely.



2.Product self-inspection

- After connect to the power supply, the product will give a "beep" sound prompt, knob lamp and key lamp on indicating the completion of self-test.

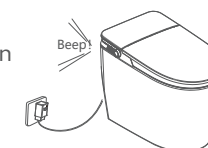

3.Product test

Washing test

- After being connected to the power supply, turn on the knob directly and the product will continue to self-clean to prevent spillage.
- You must sit on the seat to use washing function.

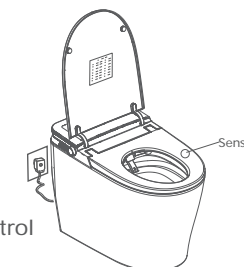

Flushing test

- Press the middle button of the knob or the remote control flush button to flush the toilet.

Notes: If there is no flushing, there may be residual air in the water pump, and this key needs to be repeatedly pressed to exhaust the water pump. (Repeating keys requires an interval of more than 40 seconds)

Function Description

Power-on Self-check

1. After power-on, all lights will be on, a "beep" sound will give out and all functions will be recovered to factory setting;
2. Water temp at about 95°F; Seat temp. at about 95°F.

Cleaning Function Description

1.Rear/lady cleanse function

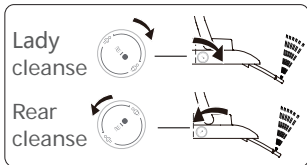

- When seated, rotating the knob frontward to start lady cleanse, rotating again to oscillating wash. Stop washing after three minutes.
- When seated, rotating the knob backward to start rear cleanse, rotating again to oscillating wash. Stop washing after three minutes.
- Cleaning mode will stop auto after three minutes and then start flush toilet, then start dryer for four minutes.

2.Self-clean nozzle function

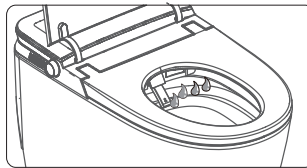

- The nozzle will self-clean when start wash function.
- At the mode of rear/lady wash, rotating the knob oppositely, the spray wand will retract to self-clean and then extend for cleaning.

Both washing and dryer mode can be stopped by pressing the middle key of the knob.

Button



1. Dryer function

Short press , to start the dryer function(seated mode), Pressing again or getting up to stop the dryer function.

2. Flushing function

Short press , to start flushing (not seated)

Other Function Description

Other Functions

1. Water temperature protection function

- (1) If the water temperature exceeds 109.4°F during use, it will automatically switch to continuous self-cleaning mode and give out an alarm;
- (2) At this time, reconnect power supply before it can be used normally.

2. Low temperature scald prevention function of seat.

After sitting down, the system will enter the low-temperature scald prevention mode automatically.

3. Foot sensor flushing function

- (1) Touches the foot sensor area to flush the toilet.

4. Power off flush function

When power off, put the lithium battery into the battery box on the toilet, and then short press the knob to flush.

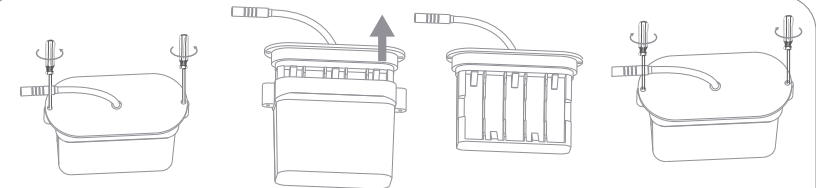
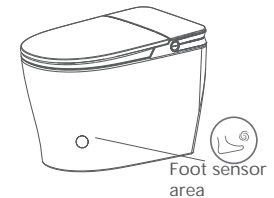

1. Open the battery compartment with a phillips screwdriver.
2. Remove the battery tray.
3. Load 10 pcs size AA batteries into the battery tray.
4. Put the battery tray back into the compartment.

Kindly Reminder

- 1.This product is designed for water flushing during a power outage. It is recommended to connect to the main unit when the power is off.
- 2.Strictly follow the "+" and "-" symbols in the battery compartment when inserting batteries. This battery compartment is a series battery pack and must not have reverse-connected cells, as this may cause battery damage, and in severe cases, safety hazards such as explosion or combustion.
- 3.Only size AA batteries should be used, and old and new batteries must not be mixed. Different models and brands of batteries must not be mixed. When replacing batteries, all of them should be replaced at the same time.
- 4.Do not disassemble the battery compartment casually. After replacing the batteries, make sure the battery compartment is securely locked and sealed to prevent bathroom moisture from entering the compartment, which could cause battery corrosion and damage.
- 5.When replacing batteries, disconnect the battery compartment from the main unit.
- 6.This product is not rechargeable to avoid danger.

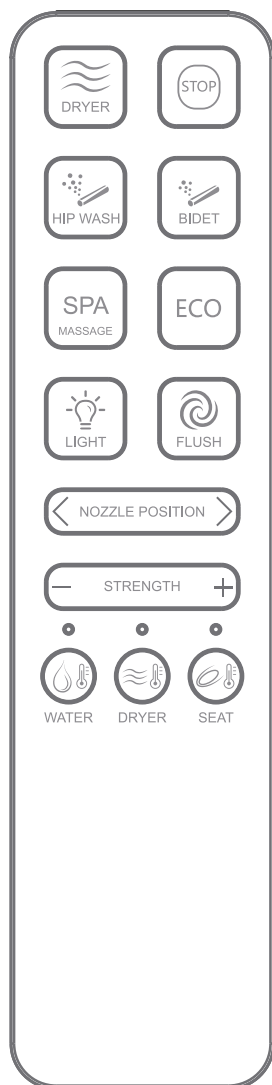

1. Make the toilet is not on status of washing, then press to flush.(In order to ensure the flushing effect and save water, it should wait for 40 seconds before reuse.)

2. After sitting down, press or to turn on the rear wash or lady wash function, and press again to turn on oscillating wash function.

During the washing process:

- Short press to set the water temperature according to the following cycle.

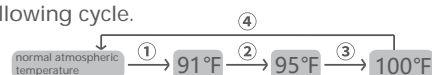

- Nozzle position can be adjusted by < or > , with five gears adjustable.

- The washing water volume can be adjusted by — or +, four levels adjustable.

- Short press to change cleaning mode.

During washing process, press or get up directly to finish washing.

3. After sitting down, short press to turn on the warm air function. Short press to set the warm air temperature according to the following cycle.

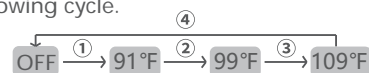

4. Short press to set the seat ring temperature according to the following cycle.

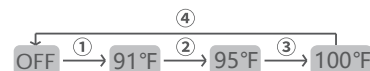

5. Short press to enter the energy-saving mode, and adjust the seat temperature to the lowest level(If the seat temperature is closed before starting the energy-saving mode, it will keep the close after the energy-saving mode). At this time, only the flushing function is available. If the user is seated, it will temporarily exit the energy-saving mode. It will automatically return to the energy-saving mode after the user leaves.

Press this button again to exit the energy-saving mode.

6. Short Press to set the light according to the following cycle.

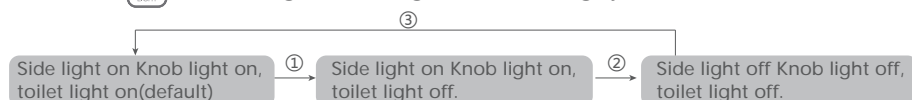

7. Different functions level with different light color, unlight/blue/pink/red is for off/low/middle/high.

8. Children's cleaning function.

Long press to enter children's cleaning mode, the water temperature, wind temperature, and seat temperature are all in the middle range (If the seat temperature is in "close" level, it will be still "close" level in children's clean mode) . The nozzle position is at the front end. The cleaning water volumn is at the lowest range. Perss or finish cleaning can exit children's cleaning mode.

9. Other function

Long press to turn on/off off seat automatic flushing.

Long press to turn on/off off prompt sound.

Long press < to turn on/off foot touch sensing flush.

Long press to turn on/off nozzle self-cleaning.

Long press to Enter/Exit ECO mode.

Cleaning And Maintenance

1.Maintenance of product surface and ceramics.

The detachable accessories can be removed before maintenance

Note before maintenance:

- (1) Make sure the power supply is disconnected.
- (2) Do not let water enter the product during the maintenance process.
- (3) Be sure to wipe off the detergent after cleaning to avoid its residue at the gap between the main body and the toilet.

● Product surface cleaning

Wet the soft cloth with water, wring it, and then wipe the product. If the product is dirty, you can use a soft cloth dipped a little of diluted neutral detergent to wipe it, and then use a clean damp cloth to wipe it clean.



2.Maintenance of the nozzle

- ① Press the "SPA" key on the remote control to start the nozzle cleaning. The nozzle start self-clean first and then extend. (Keep 15 minutes, the nozzle will retract automatically.).
- ② Dip a soft cloth, sponge, or small brush in neutral detergent, then hold the spray wand, wipe it and the nozzle.
- ③ Press any key to exit the mode after cleaning.

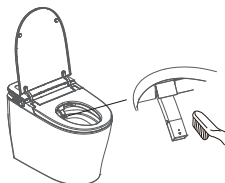

3.Maintenance of valve

1. Turn of the angle valve and rotate the filter screen down with a straight screwdriver.
2. Use a small brush to scrub the filter screen, and flush away the internal silt with clean water.
3. Reinstall the filter on to the angle valve and tighten it.



Troubleshootings

Failures	Confirmation	Solution
The product does not work.	Confirm whether cloth covers, cushions, etc. are used on the seat sensing area.	► Please remove cloth covers, cushions and other items.
	Confirm whether there is a power outage.	► Please wait for the power supply recovery.
	Confirm whether the socket is loose or in poor contact	► Please plug in to ensure good power supply.
No water when turning on the knob.	Confirm whether the water supply is cut off.	► Please wait for the water supply recovery.
	Confirm whether the water inlet valve is blocked by dirt.	► Open the water inlet angle valve.
	Confirm whether the water supply hose is bent and blocked.	► Straighten the bent part of the water supply hose.
The spray rod does not extend after turning on the knob.	No one is sitting on the seat .	► Sit on the sensing area of the seat (with a beep prompt), and then turn on the knob again to flush normally.
	Someone is sitting on the seat but not in the sensing area.	
	Solenoid valve fails.	► Contact after-sales personnel for repairing.
The nozzle extends too slowly.	Self-clean before cleaning	► The nozzle stretches out and starts cleaning in 7s.
	No enough water.	► Clean the filtermesh; a filter is recommended.
	While someone sitting on and washing, there is continuously alarm and dripping. The remote buttons are invalid at the same time.	
Low water temperature.	Trigger safety protection or hardware failure.	► Stop using and reconnect to the power supply. If fault still remains, please contact after-sales personnel for replacement.
	The water temperature is set to a lower level.	► Set water temperature to a higher level.

Troubleshootings

Failures	Confirmation	Solution
The seat is not heated	Confirm whether the seat temperature is set in low level or closed state. Confirm whether there is a power outage.	Reset the seat temperature through the seat temperature setting button. Please wait for the power supply recovery
No response when pressing the warm air button.	The Warm air function needs to be activated after sitting down.	Start the warm air after sitting down.
No wind temperature after the warm air is turned on.	Thermostat is disconnected.	Reconnect power supply after disconnection.
	Fuse is melted.	Contact after-sales personnel for repairing.
Toilet light and knob light don't work.	Confirm whether the night light/knob light is turned off. The fault still exists after reconnect power supply.	Long press the knob button to turn on the night light/knob light. Contact after-sales personnel for repairing.
The toilet does not flush.	Angle valve is closed. The filter is blocked. There is residual air inside the water pump.	Open the angle valve. Refer to the previous description for cleaning and maintenance. Drain the air from water pump by repeatedly press the middle button of the knob or the water flush key on remote control (notes: Each operation requires an interval of 40 seconds)
The toilet doesn't flush properly.	The filter is blocked.	Refer to the previous description for cleaning and maintenance.

Product Technical Parameters

Items		S16 Lite
Rated Voltage		120V ~ , 60Hz
Rated Power*		1050W
Max. Instantaneous Power		1350W
Power Cord Length		about 1.1m
Water Supply Pressure		0.1 ~ 0.75MPa (static pressure)
Water Supply Temperature		41~95°F
Waterproof Level		IPX4
Toilet Flush		≤4.8L
Cleaning Device	Water volume adjustment	4 gears in total
	Water temperature adjustment	4 gears:about 91/95/100°F/off
	Heating method	Instant heating
	Anti-backflow device	Anti-siphon valve
	Safety equipment	Double thermostat + pressure relief valve
Seat Ring Heating	Heater power	50W
	Safety equipment	Thermostat + fuse
	Surface temperature	4 gears:about 91/95/100°F/off
Warm Air	Heater power	300W
	Safety equipment	Thermostat + fuse
	Warm air temperature	4 gears:about 91/99/109°F/off(Test at an ambient temperature of 73±3.6°F)
Others	Antibacterial material	Seat ring
	Low temperature scald protection	Available
	Prompt for abnormalities	Alarm sound
	Seat sensing	Available
	Lighting control	Available

Rated power: This product is powered on and turned on at an ambient temperature of 73±3.6°F, an inlet water static pressure of 0.18±0.02MPa, and an inlet water temperature of 59±1.8°F.
 Adjust the water temperature and seat temperature to higher levels and turn on hip cleaning function and test according to the maximum flow rate (the reference flow rate is about 600ml/min).
 Measure the average power of the product working for a cleaning cycle (3 min) continuously and stably.

Product Environmental information

Part name	Harmful substances					
	(Pb)	(Hg)	(Cd)	(Cr(VI))	(PBB)	(PBDE)
PCBA	X	O	O	O	O	O
Plastic parts	O	O	O	O	X	X
The motor	X	O	O	X	O	O
Others	X	O	O	O	O	O

This form is prepared according to the provisions of SJ/T11364

O : Indicates that the content of the hazardous substance in all homogeneous materials of the component is below the limit specified in CB/T26572

X : Indicates that the content of the hazardous substance in all homogeneous materials of the component exceeds the limit specified by CB/T26572



The number in this label indicates that the environmental protection period of the product in normal use is 10 years

Warranty Card

To Dear Customers:

Thank you for choosing our product! If any problem occurs during use, please simply remove and check the problems pursuant to the user's manual. When you cannot remove such problems, contact your local supplier or call the service hotline.

I. Information:

Customer information	Customer name		
	Address		
	TEL		
Dealer information			
	TEL		
Model		Product series number	
Purchase date	Y	M	D
		Warranty period	5-Year Warranty, Replacement Only, No Repairs.

II. Notes to warranty card:

1. Please complete the warranty card.
2. Warranty cards and invoices are important for the warranty service. If the product failure occurs during warranty period, please show the warranty card and the invoice when the dealer or after-sales service personnel of the Company provide on-site maintenance and repair.
3. The warranty card cannot be reissued, please keep it properly.

III. Rules on free maintenance

During the warranty period, the Company will provide repair free of charge according to the use instructions, precautions for normal use.

IV. Paid maintenance is required in the following circumstances that do not fall within the scope of free maintenance:

1. Out of warranty.
2. The valid invoice and warranty card cannot be provided during the warranty period.
3. Failure or damage caused by transportation, collision after purchase.
4. Product damage during abnormal use, failure and damage during the warranty period caused by human factors or natural disasters, such as fire, earthquake, flood, lightning or environmental pollution, etc.
5. Failure or damage caused by unauthorized disassembly, modification or maintenance due to user's cause or responsibility.
6. Failure or damage caused by violation of maintenance regulations in use, such as improper use of cleaning agent or wiping and maintenance methods not compliant with maintenance requirements.
7. The consumable items (such as sealing rings, etc.) or products have failed or damaged due to sand and impurities.
8. Conduct the secondary transfer according to the customer's requirements.

