

尺寸：205x100mm

DIMMER KIT FOR STRING LIGHTS

USE MANUAL

Thank you for purchasing Dimmer Kit for string light, please read this use manual carefully first, we will introduce some of the important features and operating procedures of this products, please keep this manual in a safe place for future reference.

PACKAGE CONTENTS

Dimmer kit x1
Remote control x1
User Manual x1

SPECIFICATIONS

Item	Data
Operation power	265 W total
Input Voltage	AC120V 60HZ
Control distance	30M (Optimum distance 10M)

INSTALLATION

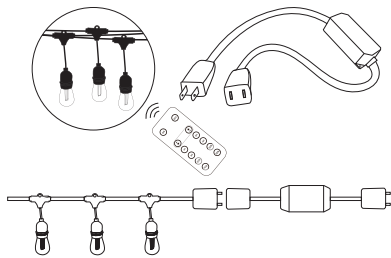

REMOTE CONTROLLER

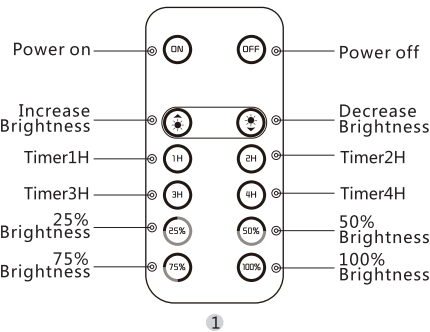

CAUTIONS & WARNINGS

- * It can be match with majority dimmable string lights.
- * The dimmer kit operates with 120V AC power only. Do not use with any other power supply type.
- * When using the remote control for the first time, check that the battery is in place and remote any plastic protection sleeves that may be alongside the battery.
- * Disconnect power at source prior to connecting cord set, installing light bulbs into sockets and etc.
- * Do not operate light string with any open sockets.
- * For outdoor string light, do not connect cord set to light strings during rain or other inclement weather conditions.
- * Do not overload sockets or light string. Do not exceed the maximum number of connected strings or total feet (and sockets) as listed.
- * When the remote control is not sensitive , pls check whether the insulation piece is removed completely or the battery has enough power.

Please informed that 265W is the maximum power for operating. Regarding the number of connecting string lights, please note the power of per bulb first. Count as below example :

Power: 1.5w/bulb
Power: 22.5w/ 15bulbs per string
Available numbers of strings will be at 8 sets:
265 w/22.5w= 10sets

▲WARNING

Please check if you overload use the dimmer when the string lights stop working by automatically. The dimmer kits will be work normally after unplug 1-2 minutes.

RF warning statement:

The device has been evaluated to meet general RF exposure requirement. The device can be used in portable exposure condition without restriction.

FCC STATEMENT :

This device complies with Part 15 of the FCC Rules. Operation is subject to the following two conditions:
(1) This device may not cause harmful interference, and
(2) This device must accept any interference received, including interference that may cause undesired operation.

Warning: Changes or modifications not expressly approved by the party responsible for compliance could void the user's authority to operate the equipment.

NOTE: This equipment has been tested and found to comply with the limits for a Class B digital device, pursuant to Part 15 of the FCC Rules. These limits are designed to provide reasonable protection against harmful interference in a residential installation. This equipment generates uses and can radiate radio frequency energy and, if not installed and used in accordance with the instructions, may cause harmful interference to radio communications. However, there is no guarantee that interference will not occur in a particular installation. If this equipment does cause harmful interference to radio or television reception, which can be determined by turning the equipment off and on, the user is encouraged to try to correct the interference by one or more of the following measures:

- * Reorient or relocate the receiving antenna ;
- * Increase the separation between the equipment and receiver ;
- * Connect the equipment into an outlet on a circuit different from that to which the receiver is connected ;
- * Consult the dealer or an experienced radio/TV technician for help.

CORRECT DISPOSAL OF THIS PRODUCT

 (Waste Electrical & Electronic Equipment) This marking shown on the product, or its literature, indicate that it should not be disposed with other household wastes at the end of it is working life.

To prevent possible harm to the environment or human health from uncontrolled waste disposal, please separate this form other types of wastes and recycle it responsibly to promote the sustainable reuse of material resources.

Household user should contact either the retailer where they purchasing this product, or their local government office, for details of there and how they can take this items for environmentally safe recycling.

Business users should contact their supplier check the terms and conditions of the purchase contacts. This product should not be mixed with other commercial waste for disposal.