

Thank you for your reading!

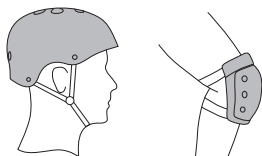

Strictly abide by local laws and regulations and traffic laws.  
Do not ride this scooter under the condition of low visibility.  
Do not use this car to do stunt, wheel or take-off, it will increase the probability of injury and damage to the scooter. Do not carry passengers.



There is a risk of falling down and injury during the course of study. Please wear a helmet and protective gear throughout the study.

### Charging precautions

When charging the electric scooter L9 PRO+, please pay attention to the following points.

- 1) Ensure that it is charged in dry and clean environment, the input voltage is guaranteed between 100V-240V and the other end connects the charging port of L9 PRO+ electric scooter. The red light indicates the scooter is being charged.
- 2) The indicator light of the charger shows the green light, indicating that the charging is completed.
- 3) Don't turn on the scooter during charging for your safety.
- 4) Disconnect the scooter from the charger when the charging is complete.



L9 PRO+  
Electric scooter

-5-

### Maintenance

1) Battery maintenance: In order to guarantee the battery life, when the battery level is low, please charge the scooter timely (Note: When it is not in use for a long time, it is recommended that charge it once a month). If you want to check or replace the battery, please do it with the assistance of professionals. The most suitable temperature of the battery storage is 15°C -25°C; don't use and place the scooter when the environmental temperature is higher than 40°C, in order to avoid the lithium battery's failure, and even lead to the combustion. Do not place the scooter in the car during the hot seasons, because it may lead to the lithium battery's failure or even the combustion.

2) Tire maintenance: In order to guarantee the tire life, please check the tires of the scooter regularly. Once the wheel is abnormal, please repair or replace timely, so as not to cause unnecessary damage during the riding.

3) Appearance maintenance: Swab the scooter body with water or mild detergent, it will make your scooter clean. Please do not clean the scooter with irritant poisons or any chemical reagents.

### Common Failures and Solutions

1) The display board is working but the motor doesn't work	
Reason analysis	Solutions
a. The break handle is damaged	a. Pull out the socket of the break handle (normally open type brake handle). If the motor works, then it is the failure of break handle, should replace the break handle.
b. The speed regulating steering handle is damaged	b. Firstly check the speed regulating steering handle and motor's hall switch are short circuit or not. Generally it is easier to cause the joint short circuit after rain affected with damp, so notice the short circuit of steering handle and the motor hall switch. Otherwise there will be a continuous damage of the replacement controller!
c. The motor is damaged	c. If the motor power is damaged, inspect the motor's hall switch and turning handles' signal. Once the power on the controller shell is very hot, generally it is short circuit of the controller internal power tube, should immediately cut off the power.
2) Charging doesn't work	
Reason analysis	Solutions
a. The battery charging port is loose	a. Change a good charging port.
b. The connection of the charger plug is not well	b. Change a good charger connector.
3) Can't turn on the scooter	
Reason analysis	Solutions
a. The battery is dead	a. Charge the scooter for 1-2 hours according to the user manual.
b. The power button is out of order	b. Check the power button which has got stuck or not.

-6-

## L9 PRO+ Electric scooter



A. Please read the user manual and get to know the performance of L9 PRO+ intelligent electric scooter before using the product. Don't lend the scooter to the people who can't handle it.

### Product diagram

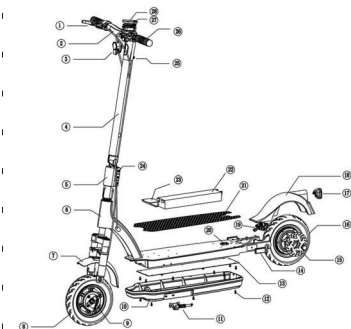

-1-

### Specification

Performance index	Item	Specs
Materials & Size	Color	Black/Red/others
	Material	Aluminum alloy
	Folded Size(mm)	1190*570*1200mm
	Unfolded Size(mm)	1190*570*540mm
Weight	Deck height(mm)	80mm
	User height	155-200cm
	N.W	17.7kg
	Max Load	120kg
Scooter	Max speed(km/h)	25km/h
	Max range(km)	35-40km
	Max incline	<15°
	Using terrain	Flat road with incline <20°
Motor	Using temperature	0°C-45°C
	Waterproof level	IPX4
	Rated power(W)	350W
	Rated volt(V)	36V
Battery	Rated current(A)	9A
	Rated torque(N.m)	16N.m
	No-load current	≤0.9A
	No-load rotate speed	1200±5%
Charger	Front Wheel Size	10inch
	Rear Wheel Size	10inch
	Brand	China battery 18650 30cell
	Capacity(Ah)	10Ah
Charger	Rated volt(V)	36V
	Input volt(V)	42V
	Rechargeable times	500-800times
	Rated input volt(V)	100-240V AC 50/60HZ
Charger	Rated current(A)	2A
	Charging time(H)	5-6H
	Rated output volt(V)	42V
	Rated output current(A)	2A

-2-

### Folding

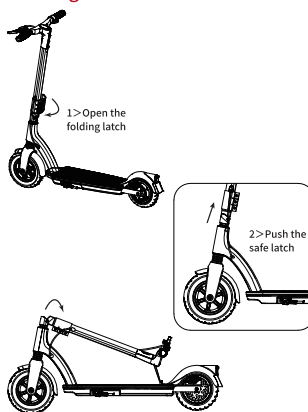

3>Put the hook into the hook hole

### Display

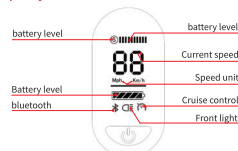

-3-

### Operation steps

#### Power button function description:

1. Power on/off:  
Press and hold the red power button on the right side to power the scooter on.  
Press and hold the button again to turn it off.
2. Gear switch:  
Gear switch: Tap the left red button to change gears.  
There are four gears: P0, P1, P2 and P3.
3. Lighting:  
To turn the lights on or off, tap the power button quickly. On or off, then again for off.

#### Safe Driving

1. Avoid accentuating the body while accelerating or decelerating and do not keep the body weight on the handle.
2. Riding a standing position, please keep the two feet one after the other, so that riding more stable, and easy to step on the rear brake.
3. Keep your body and handle parallel when turning. Please confirm the road condition before turning and keep safe.
4. Brake - When braking, please shift your body weight back. You'd better learn to control your body's center of gravity when you brake. Otherwise it will cause two situations:  
A Scooter forward, causing personal injury.  
B Braking and steering system damage

-4-

**FCC Caution:**

This device complies with part 15 of the FCC Rules. Operation is subject to the following two conditions: (1) This device may not cause harmful interference, and (2) this device must accept any interference received, including interference that may cause undesired operation.

Any Changes or modifications not expressly approved by the party responsible for compliance could void the user's authority to operate the equipment.

**Note:** This equipment has been tested and found to comply with the limits for a Class B digital device, pursuant to part 15 of the FCC Rules. These limits are designed to provide reasonable protection against harmful interference in a residential installation. This equipment generates uses and can radiate radio frequency energy and, if not installed and used in accordance with the instructions, may cause harmful interference to radio communications. However, there is no guarantee that interference will not occur in a particular installation. If this equipment does cause harmful interference to radio or television reception, which can be determined by turning the equipment off and on, the user is encouraged to try to correct the interference by one or more of the following measures:

- Reorient or relocate the receiving antenna.
- Increase the separation between the equipment and receiver.
- Connect the equipment into an outlet on a circuit different from that to which the receiver is connected.
- Consult the dealer or an experienced radio/TV technician for help.

The device has been evaluated to meet general RF exposure requirement. The device can be used in portable exposure condition without restriction.

## **IC Caution:**

This device complies with Industry Canada's licence-exempt RSSs. Operation is subject to the following two conditions:

- (1) This device may not cause interference; and
- (2) This device must accept any interference, including interference that may cause undesired operation of the device.

The device has been evaluated to meet general RF exposure requirement. The device can be used in portable exposure condition without restriction.

Le présent appareil est conforme aux CNR d'Industrie Canada applicables aux appareils radio exempts de licence. L'exploitation est autorisée aux deux conditions suivantes:

- (1) l'appareil ne doit pas produire de brouillage, et
- (2) l'utilisateur de l'appareil doit accepter tout brouillage radioélectrique subi, même si le brouillage est susceptible d'en compromettre le fonctionnement.

L'appareil a été évalué pour répondre aux exigences générales d'exposition RF. L'appareil peut être utilisé dans des conditions d'exposition portables sans restriction.