



# User manual

Lefant M330 Series Robotic Vacuum Cleaner



Scan the QR code for the English version of the online user manual.

Scannen Sie den QR-Code, um das Online-Handbuch auf Deutsch zu erhalten.

Scannez le QR code pour obtenir le manuel en ligne en français.

Scansiona il codice QR per ottenere il manuale online in italiano.

Escanee el código QR para obtener el manual en línea en español.

コードをスキャンして、日本語のオンライン マニュアルを取得します。



Please read this instruction manual carefully before using the product and keep it in a safe place.

Thank you for choosing Lefant.

This manual will guide you through a comprehensive understanding and quick installation of the robotic vacuum cleaner (referred to as "robot" hereafter), providing detailed important information regarding usage and maintenance to help you achieve the best product experience.

If you encounter any issues during usage, please dial the service hotline. Lefant technical support experts will be dedicated to assisting you with any inquiries.



[www.lefant.com](http://www.lefant.com)



NA: [support.us@lefant.com](mailto:support.us@lefant.com)

EU: [support.eu@lefant.com](mailto:support.eu@lefant.com)

Other countries: [support@lefant.com](mailto:support@lefant.com)



Facebook: [@LEFANTOFFICIAL](https://www.facebook.com/LEFANTOFFICIAL)

You can scan the QR code or download the "Lefant" app from the app store to connect to the robot and unlock more features.



Scan the QR code to get the installation video for the charging dock.

Tips:

- \* Follow the guidance in the Lefant app to register, login, and pair the robot.
- \* Please make sure that the mobile phone is connected to your Wi-Fi network before pairing the robot.

Products are subject to physical appearance and specific details may differ from those shown.

# IMPORTANT SAFETY INSTRUCTIONS

**WARNING:** Read all safety warnings and instructions. Failure to follow the warnings and instructions may result in electric shock, fire or serious injury.

**READ ALL INSTRUCTIONS BEFORE USING THIS APPLIANCE.**

For Household use only

When using an electrical appliance, basic precautions should always be followed, including the following:

1. The robot must be used in accordance with the directions in this user manual. Our company cannot be held liable or responsible for any damages or injuries caused by improper use.
2. Do not allow to be used as a toy. Close attention is necessary when used by or near children.  
Do not allow children to sit on the vacuum.
3. Clear the area to be cleaned. Remove power cords and small objects from the floor that could entangle the Robot. Tuck rug fringe under the rug base, and lift items such as curtains and table cloths off the floor.
4. If there is a drop off in the cleaning area due to a step or stairs, you should operate the robot to ensure that it can detect the step necessary to place a physical barrier at the edge to keep the unit from falling. Make sure the physical barrier is not a trip hazard.
5. Only use as described in this manual. Only use attachments recommended or sold by the manufacturer.
6. Please make sure your power supply voltage matches the power voltage marked on the docking station.
7. Do not handle or plug appliance with wet hands.
8. Non-rechargeable batteries are prohibited.
9. Do not use without dust bin and/or filters in place.
10. Do not operate the robot in an area where there are lit candles or fragile objects on the floor to be cleaned.
11. Do not use and store in extremely hot or cold environments (below -5°C /23°F or above 40°C/104°F). Please charge the robot in temperature above 0°C/32°F and below 40°C/104°F. Follow all charging instructions and do not charge the battery pack or appliance outside of the temperature range specified in the instructions. Charging improperly or at temperatures outside of the specified range may damage the battery and increase the risk of fire.
12. Keep hair, loose clothing, fingers, and all parts of body away from any openings and moving parts.
13. Do not operate the robot in a room where an infant or child is sleeping.
14. For INDOOR use ONLY. Do not use the robot in outdoor, commercial or industrial environments. Do not use robot on wet surfaces or surfaces with standing water.
15. Do not allow the robot to pick up large objects like stones, large pieces of paper or any item that may clog

the robot.

16. Do not use the robot to pick up flammable or combustible materials such as gasoline, printer or copier toner, or use in areas where they may be present.

17. Do not use the robot to pick up anything that is burning or smoking, such as cigarettes, matches, hot ashes, or anything that could cause a fire.

18. Do not put any object into openings. Do not use with any opening blocked; keep free of dust, lint, hair, and anything that may reduce air flow.

19. Take care not to damage the power cord. Do not pull on or carry the robot or the docking station by the power cord, use the power cord as a handle, close a door on the power cord, or pull power cord around sharp edges or corners. Do not run the robot over the power cord. Keep power cord away from hot surfaces. Do not unplug by pulling on cord, To unplug, grasp the plug, not the cord.

20. If the power cord is damaged, it must be replaced by the manufacturer or its service agent in order to avoid a hazard.

21. Do not use the docking station if it is damaged.

22. Do not use the robot or the docking station if it is not working properly, has been dropped, damaged, left outdoors, or come in contact with water. It must be repaired by the manufacturer or its service agent in order to avoid a hazard.

23. Turn off the power switch before cleaning or maintaining the robot. Turn off all controls.

24. The plug must be removed from the receptacle before cleaning or maintaining the docking station.

25. Remove the robot from the docking station, and turn off the power switch to the robot before removing the battery for disposal of the robot.

26. The battery must be removed and discarded according to local laws and regulations before disposal of the robot.

27. Please dispose of used batteries according to local laws and regulations.

28. Do not incinerate the robot even if it is severely damaged. The batteries can explode in a fire.

29. When not using the docking station for a long period of time, please unplug it.

30. Prevent unintentional starting. Ensure the switch is in the off position before connecting to battery pack, picking up or carrying the robot. Carrying the robot with your finger on the switch or energizing the robot that have the switch on invites accidents.

31. When battery pack is not in use, keep it away from other metal objects, like paper clips, coins, keys, nails, screws, etc., that can make a connection from one terminal to another. Shorting the battery terminals together may cause burns or a fire.

32. Under abusive conditions, liquid may be ejected from the battery; avoid contact. If contact accidentally occurs, flush with water. If liquid contacts eyes, additionally seek medical help. Liquid ejected from the battery may cause

irritation or burns.

33. Do not use a battery pack that is damaged or modified. Damaged or modified batteries may exhibit unpredictable behavior resulting in fire, explosion or risk of injury.

34. Do not expose a battery pack or appliance to fire or excessive temperature. Exposure to fire or temperature above 130°C/265°F may cause explosion.

35. Have servicing performed by a qualified repair person using only identical replacement parts.

36. Do not modify or attempt to repair the robot or the battery pack (as applicable) except as indicated in the instructions.

37. Do not operate the robot in a room that has lit candles on furniture that the vacuum may accidentally hit or bump into.

38. Recharge only with the charger specified by the manufacturer. A charger that is suitable for one type of battery pack may create a risk of fire when used with another battery pack.

39. Use the robot only with specifically designated battery packs. Use of any other battery packs may create a risk of injury and fire.

40. The robot contains batteries that are only replaceable by skilled persons. To replace the robot's battery, please contact Customer Service.

41. If the robot is not going to be used for a long time, fully charge the robot, power it off, and unplug the docking





station.

42. Please remove any fragile and miscellaneous items from the floor (such as vases, plastic bags, etc.) to prevent the robot from being obstructed or causing damage to valuable items in the home due to minor collisions.

## SAVE THESE INSTRUCTIONS

To satisfy RF exposure requirements, a separation distance of 20 cm or more should be maintained between this device and persons during device operation.

To ensure compliance, operations at closer than this distance is not recommended. The antenna used for this transmitter must not be co-located in conjunction with any other antenna or transmitter.

|                                                                                   |                        |
|-----------------------------------------------------------------------------------|------------------------|
|  | For indoor use only    |
|  | Direct current         |
|  | Alternating current    |
|  | detachable supply unit |

**WARNING:** For the purposes of recharging the battery, only use the detachable supply unit provided with this appliance.

## Correct Disposal of this Product

This marking indicates that this product should not be disposed of with other household waste throughout the EU. To prevent possible harm to the environment or human health from uncontrolled waste disposal, recycle it responsibly to promote the sustainable reuse of material resources. To recycle your used device, please use the return and collection systems or contact the retailer where the product was purchased. They can safely recycle this product.



## Federal Communications Commission (FCC) Interference Statement

This equipment has been tested and found to comply with the limits for a Class B digital device, pursuant to Part 15 of the FCC Rules.

These limits are designed to provide reasonable protection against harmful interference in a residential installation. This equipment generate, uses and can radiate radio frequency energy and, if not installed and used in accordance with the instructions, may cause harmful interference to radio communications. However, there is no guarantee that interference will not occur in a particular installation. If this equipment does cause harmful interference to radio or television reception, which can be determined by turning the equipment off and on, the user is encouraged to try to correct the interference by one of the following measures:

- Reorient or relocate the receiving antenna.
- Increase the separation between the equipment and receiver.
- Connect the equipment into an outlet on a circuit different from that to which the receiver is connected.
- Consult the dealer or an experienced radio/TV technician for help.

This device complies with Part 15 of the FCC Rules. Operation is subject to the following two conditions: (1) This device may not cause harmful interference, and (2) this device must accept any interference received, including interference that may cause undesired operation.

### FCC Caution:

Any changes or modifications not expressly approved by the party responsible for compliance could void the user 5s authority to operate this equipment.

### RF exposure warning

This equipment complies with FCC radiation exposure limits set forth for an uncontrolled environment. This equipment must be installed and operated in accordance with provided instructions and the antenna(s) used for this transmitter must be installed and antenna(s) used for this transmitter must be installed to provide a separation distance of at least 20 cm from all persons and must not be collocated or operating in conjunction with any other antenna or transmitter.

## IC Caution:

- English:

This device contains licence-exempt transmitter(s)/receiver(s) that comply with Innovation, Science and Economic Development Canada's licence-exempt RSS(s). Operation is subject to the following two conditions:

(1) This device may not cause interference.

(2) This device must accept any interference, including interference that may cause undesired operation of the device. Any changes or modifications not expressly approved by the party responsible for compliance could void the user's authority to operate the equipment.

RF exposure statement:

The equipment complies with IC Radiation exposure limit set forth for uncontrolled environment. This equipment should be installed and operated with minimum distance 20cm between the radiator and your body.

- French:

Cet appareil contient des émetteurs / récepteurs exemptés de licence conformes aux RSS (RSS) d'Innovation, Sciences et Développement économique Canada. Le fonctionnement est soumis aux deux conditions suivantes:

(1) Cet appareil ne doit pas causer d'interférences.

(2) Cet appareil doit accepter toutes les interférences, y compris celles susceptibles de provoquer un fonctionnement indésirable de l'appareil.

Tout changement ou modification non expressément approuvé par la partie responsable de la conformité pourrait annuler l'autorité de l'utilisateur à utiliser l'équipement.

Déclaration d'exposition RF:

L'équipement est conforme à la limite d'exposition aux radiations de la IC établie pour un environnement non contrôlé.

Cet équipement doit être installé et utilisé avec une distance minimale de 20cm entre le radiateur et votre corps.



# A Product Introduction

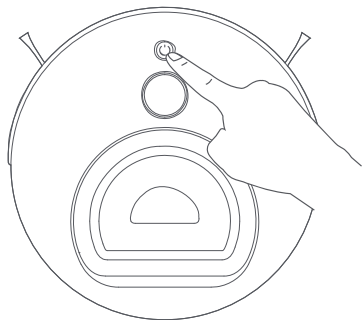

## — How to use buttons

Hold for 3 seconds: **Turn on** (Robot charging will turn on automatically)

Fast press: **Start/Pause**

Fast press twice: **Auto-recharge**

Hold for 6 seconds: **Enter network pairing mode**

(Networking operation: Open the App, select 'Add Device', then press and hold for 6 seconds to hear the voice prompt, wait for the App to scan the device and then follow the networking guidelines to pair it.)

Hold for 12 seconds: **Turn off**

## — Indicator Meaning

| Robot status                                  | Indicator status                |
|-----------------------------------------------|---------------------------------|
| Cleaning                                      | Blue light on                   |
| Pause/standby                                 | Blue light on                   |
| Charging                                      | Purple/Blue light interchanging |
| Low battery automatic returns for charging    | Red light on                    |
| Automatic returns for charging after cleaning | Purple light on                 |
| Enter network pairing mode                    | Blue light flash                |
| Successful network pairing                    | Blue light on                   |
| Error                                         | Red light on/flash              |

### A1 Robot (Top View)

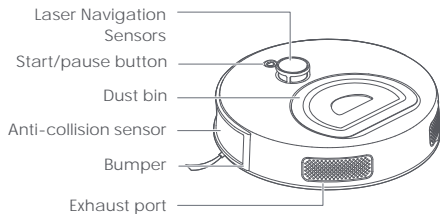

### A3 Dust bin

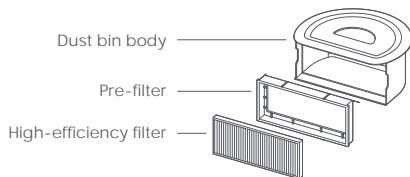

### A2 Robot (Bottom View)

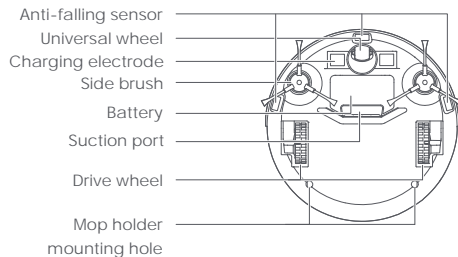

### A4 Docking station

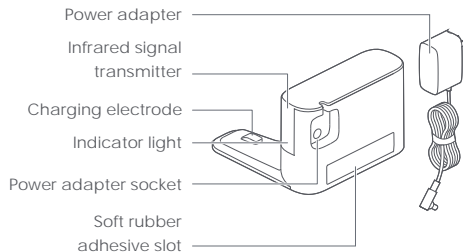

**A5** Mop Holder

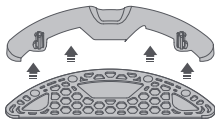

**A6** Cleansing wipes



**A7** Cleaning brush



**A8** Double-sided soft rubber



**A9** Quick guide



**A10** User manual



## B Product Installation

### B1 Special Note

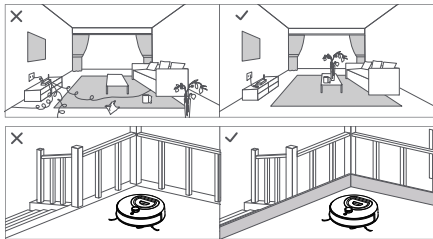

1. Before starting, please clear the floor of scattered wires, hard objects, sharp items (such as nails, glass), and other debris. Also, remove items that are easily toppled, fragile, valuable, or could potentially cause danger. Avoid situations where the robot may become entangled, stuck, dragged, or cause harm to individuals or property.

2. If using this product in an environment with drop-offs, it is essential to employ sturdy physical barriers to prevent the robot from accidentally falling and causing harm to individuals or property.

#### Tips:

- During the initial cleaning process, it is advisable to accompany the robot throughout the entire session to assist with addressing any minor issues that may arise. Once resolved, the robot will be able to proceed with autonomous cleaning smoothly in subsequent sessions.
- Avoid letting the robot vacuum up hard or sharp objects (such as construction debris, glass, nails, etc.), as this may cause damage to both the robot and the floor surface.

### B2 Remove protective film

Remove the protective film on the robot and docking station.

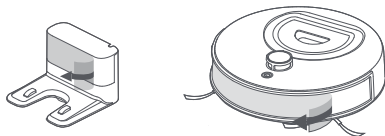

### B3 Install the side brush

Push down firmly and a "click" is heard to indicate that it is in place.

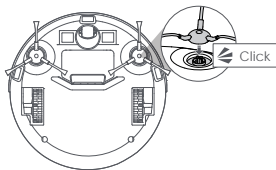

## B4 Docking station Installation

### 1. Docking station Connection Adapter

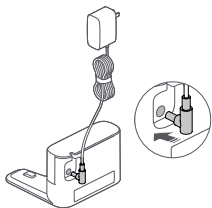

### 2. Position the docking station and connect it to the power supply

Place the docking station against the wall on a flat surface. Ensure there are no items within 0.5m to the left or right and 1.5m in front to avoid blocking the charging signal. Avoid having reflective objects, such as floor mirrors, near the docking station to prevent signal reflection.

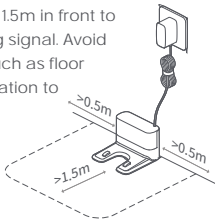

### 3. Instructions for using double-sided soft adhesive

After placing the charging dock in position, attach the double-sided soft adhesive to the back or bottom of the charging dock to secure it to the wall or floor.

#### Method 1:



#### Method 2:



### 4. Charging

Place the robot with its button side facing the docking station. When the button light starts to blink, it indicates correct placement. (As shown below) Charging time is approximately 6.5 hours.

- ❗ When the robot is charging under powered off status, it will automatically turn on during the charging process.

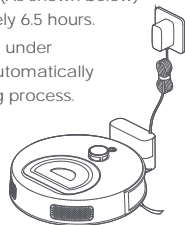

**B5** Install cleaning wet or dry wipes on the mop holder.

1. Separate the mop bracket's [Top Cover] and [Bottom Cover].



2. Lay out the cleaning wipe (wet or dry), with the textured side facing downwards.

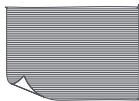

3. As shown in Figure A, place the [bottom cover] with the silicone side facing down on the upper half of the cleaning wet or dry wipe.

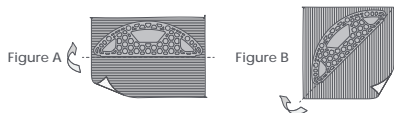

❗ If a face towel with a shorter size is used, you can refer to the diagonal placement method shown in Figure B.

4. Fold the cleaning wipe around the [Bottom Cover].

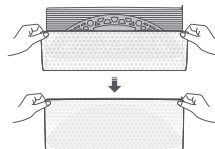

5. Attach the [Top Cover] onto the [Bottom Cover] and press down to secure the wipe in place, ensuring that the magnets are aligned.



6. Install the mop bracket assembly onto the vacuum cleaner, and start the mopping function once set up is completed.

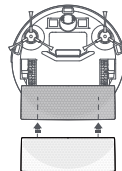

**B6** Replace the cleaning wet or dry wipes on the mop holder.

1. Remove the mop bracket assembly from the vacuum cleaner.

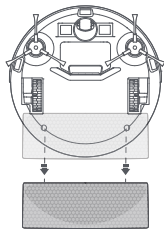

2. Detach the [Top Cover].

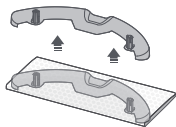

3. Remove the used cleaning wipe from the [Bottom Cover].

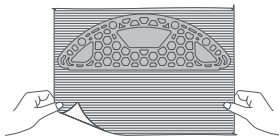

4. Dispose of the used cleaning wipe into the waste bin.

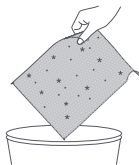

5. Install the new wet or dry wipe according to [B5 Mop Holder Installation of Cleaning Wet or Dry Wipes].

# C Maintenance

## C1 Dust bin

⚠ WARNING: The HEPA Filter should not touch the water.



1. Open the faceplate and take out the dust bin

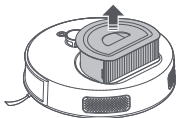

2. Remove the filter assembly first, then the HEPA Filter

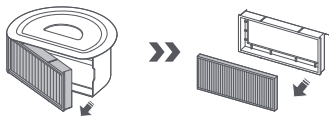

3. Dumping of garbage



4. Clean the HEPA Filter with a cleaning brush, do not use water.



5. The main body of the dust box and the primary filter can be cleaned with water.

Rinse and allow to dry completely for at least 24 hours before returning to use.

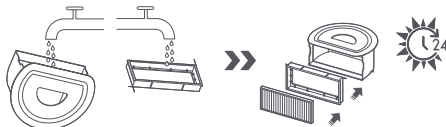



## C2 Side brush

Remove the side brush by pulling it off firmly, clean the side brush and put it back on.

Replace the brushes with new ones according to the wear and tear.

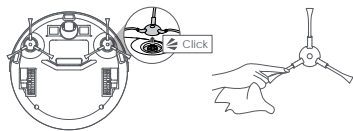

## C3 Robot Sensors

Clean the various sensors of the robot by wiping them with a soft dry cloth, including:

- ① Obstacle avoidance sensor;
- ② Laser Navigation
- ③ Fall prevention sensor (it is recommended to clean the fall prevention sensor once a week to avoid dust blocking and affecting the signal).

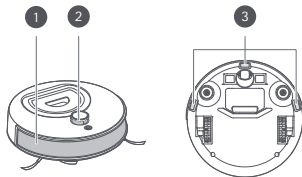

## C4 Robot components

Clean all parts of the robot by wiping with a soft, dry cloth, including:

- ① Universal Wheel
- ② Charging electrode
- ③ Suction port
- ④ Driving wheel

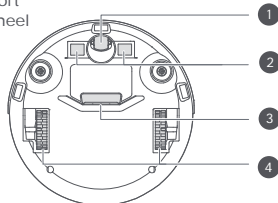

## C5 Docking station

- ① Clean the charging electrode of the docking station to ensure smooth charging;
- ② Clean the infrared signal sensor lens of the docking station to avoid signal interference.



## Technical parameters

### Robotic Vacuum Cleaner

|                         |                         |
|-------------------------|-------------------------|
| Product model           | M330 Series             |
| Wireless Connections    | WiFi Smart Fast Connect |
| Robot operating voltage | 14.4V $\equiv$          |
| Robot rated power       | 30W                     |
| Charging time           | < 5.5 hours             |

#### Adapter model

|                         |                 |
|-------------------------|-----------------|
| K30-V1000R190-019A0-US  | AD-0121900060US |
| K30-V1000R190-019A0-DE  | AD-0121900060EU |
| K30-V1000R190-019A0-GB  | AD-0121900060UK |
| K30-V1000R190-019A0-AU  | AD-0121900060AU |
| V30-V0600R190-012AA0-US | AD-0191900100US |
| V30-V0600R190-012AA0-DE | AD-0191900100EU |
| V30-V0600R190-012AA0-GB | AD-0191900100UK |
| V30-V0600R190-012AA0-AU | AD-0191900100AU |

## Environmental Protection Instructions

### Battery Removal Steps

\* The following information is applicable only when disposing of this robot and is not part of regular operating instructions.

The chemicals contained in the lithium-ion battery built into this product may pollute the environment. Before disposal, remove the battery and dispose of it at a designated battery recycling facility.

1. Allow the robot to run until it completely discharges and shuts down automatically without being connected to the charging dock.
2. Ensure the robot is powered off.
3. Remove the screws securing the battery cover on the bottom shell of the robot.
4. Open the battery cover.
5. After removing the battery, unplug the connector plug from the battery.

Battery Cover

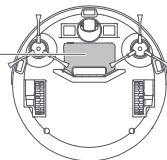

### Tip:

- When disassembling the battery, ensure it is fully discharged and operate without being connected to the charging dock.
- Please remove the entire battery pack together. Do not damage the battery pack casing to prevent short circuits or leakage of hazardous substances.
- If the battery leaks and comes into contact accidentally, rinse with plenty of water and seek medical attention promptly.

# Abnormal symptoms

When the robot runs into trouble, its red indicator light will be on or flash and an error message will be broadcast. The following table summarizes the corresponding causes:

| No.               | Voice Prompt                                                                                             | Solutions                                                                     |
|-------------------|----------------------------------------------------------------------------------------------------------|-------------------------------------------------------------------------------|
| Red light on      |                                                                                                          |                                                                               |
| 1                 | The wheels are not wokring. Please check                                                                 | Please check whether the driving wheel is tangled , and clean up it.          |
| 2                 | The side brush is not working. Please check                                                              | Please check whether the side brush is tangled , and clean up the side brush. |
| 3                 | The rolling brush is not working. Please check                                                           | Please clean the waste in the rolling brush.                                  |
| 4                 | Mop missing. Please install again                                                                        | The mop holder has come off, please put the mop holder back on the robot      |
| Red light flashes |                                                                                                          |                                                                               |
| 1                 | I am suspended. Please put me back on the ground                                                         | The robot hangs in the air. Please move it to the ground.                     |
| 2                 | I am stuck, please help me out                                                                           | Fail to get rid of a dilemma; please move to an open place.                   |
| 3                 | low battery. Can't return to charging dock.<br>Please put me back to the charging dock to start charging | Please move the robot to the docking station for charging.                    |
| 4                 | Abnormal charging voltage.<br>Please use the original power adapter to charge.                           | Clean the electrode and ensure the original adapter.                          |
| 5                 | Unable to start charging. Please toggle the power button on the side of robot to try again.              | Check if the robot is turned on.                                              |

\* If the above method cannot resolve the problem, please try the following operations: turn on the ON/OFF button on the side to restart the robot.

# Troubleshooting

If the following problems occur in the application process of the product, users can resolve them independently by comparison and inquiry.

| Fault                          | Possible causes                                                                  | Solutions                                                                                                                                                                                                                        |
|--------------------------------|----------------------------------------------------------------------------------|----------------------------------------------------------------------------------------------------------------------------------------------------------------------------------------------------------------------------------|
| Abnormal cleaning              | Cleaning components blockage                                                     | It is recommended to replace consumables regularly, such as high-efficiency filters (HEPA), pre-filter, side brushes, etc.                                                                                                       |
|                                | Dust on sensors and other components                                             | Please refer to the chapter [Maintenance] of the manual to clean the robot.                                                                                                                                                      |
| Unable to connect to App       | Not entered Wi-Fi pairing mode                                                   | Keep pressing  button for 6 seconds: Entering Wi-Fi pairing mode, please refer to the App Networking Guide for details.                         |
|                                | 2.4G Hz network isn't used.                                                      | You need to switch to 2.4G Hz network, please refer to the App Networking Guide for details.                                                                                                                                     |
| Difficult to return and charge | Incorrect placement of docking station                                           | Please place the docking station in an open and flat area.                                                                                                                                                                       |
|                                | The docking station is powered off or moved manually                             | Please check whether the docking station is connected to the power supply. Do not move the position of the docking station when the robot is working.                                                                            |
|                                | The home is too large, and the environment is complex                            | Please refer to the chapter [BI Special Note] of the manual.                                                                                                                                                                     |
|                                | The robot didn't clean from the docking station                                  | Let the robot clean from the docking station.                                                                                                                                                                                    |
| Unable to charge               | The power supply is not connected, or the plug is loose                          | Check if both ends of the power cord are connected and if the docking station indicator light is on.                                                                                                                             |
|                                | Poor contact between the robot and the charging electrode of the docking station | Ensure that the charging electrode of the robot and the docking station are fully connected, and clean the charging electrode of the robot and the docking station regularly.                                                    |
|                                | Battery deterioration caused by non-long-term use                                | It's recommended to use this product regularly. If not used for an extended period, charge fully, turn off the robot, and ensure it's charged once a month. If the battery can't be charged, please contact after-sales service. |

\* If the issue cannot be eliminated according to the operation in the table, contact our customer service representative.

# Warranty

This warranty covers the repair or replacement of the malfunction device at our company's discretion for a period of 1-year. In addition this certificate is void if altered. The serial number must be provided as well as all accessories to be eligible for warranty coverage. Please kindly fill in below form accurately and completely.

**Order Number:** \_\_\_\_\_

**Serial Number:** \_\_\_\_\_

**Date of Purchase:** \_\_\_\_\_

## Important:

When returning this device, carefully pack the product to avoid damage in shipping. Damage in shipping is not covered by the Warranty and shall be the sole responsibility of Buyer. Damage or loss not covered by this Warranty or occurring outside the warranty period will require a fee to cover the cost of handling and shipping. All such fees and costs shall be the sole responsibility of Buyer.

## Exclusion

Unless agreed in writing, the warranty will not apply if the defects relate to:

- Consumable parts such as filters, or brushes etc, that are subject to normal wear and tear, and require regular maintenance and/or replacement to ensure the proper functioning of your unit.
- Defects caused by rough or inappropriate handling or use or damage caused by accident, misuse, neglect, fire, water, lighting or other acts of nature, external sources such as weather, electrical outages or power surges.
- Improper operation or maintenance, use not in accordance with the product instructions or connection to improper voltage supply.
- Accident, abuse, misapplication, or any unauthorized repair, modification, or disassembly of the product.
- Any failure to adequately package the product for transportation.
- Use of parts not in accordance with the product instructions.
- Use of parts and accessories other than those produced or recommended by our company.
- Use in a commercial environment as the product is designed for residential use only.
- Consequential and incidental damages.
- Any product(s) purchased from unauthorized dealers/resellers.
- Products used outside the country of purchase.
- Lost and/or stolen products.







Official website

🌐 Website: [www.lefant.com](http://www.lefant.com)

✉ Email: NA: [support.us@lefant.com](mailto:support.us@lefant.com)

EU: [support.eu@lefant.com](mailto:support.eu@lefant.com)

Other countries: [support@lefant.com](mailto:support@lefant.com)

📘 Facebook: [@LEFANTOFFICIAL](https://www.facebook.com/LEFANTOFFICIAL)

👤 Community: [facebook.com/groups/Lefantofficalcommunity](https://www.facebook.com/groups/Lefantofficalcommunity)

Shenzhen USEER Robotics Co., Ltd.

Building 2, Fashion Brand Industrial Park, E'Bu Town,  
Shenzhen-Shanwei Special Cooperation Zone, Shenzhen, Guangdong, China.