

Laser Twilight with Timer
US Shipments (Class II, 1 mW)

A4 size - front

INSTRUCTIONS FOR LASER TWILIGHT

Congratulations on your purchase of Laser Twilight.

Before we begin, it is important for you to know that Laser Twilight works best in a completely dark room. Any ambient light will diminish the optical effects. Laser Twilight is self-focusing – never touch the lens or try to adjust it. Laser Twilight is not a toy - it is an ever-changing home theater experience that will never fail to astound.

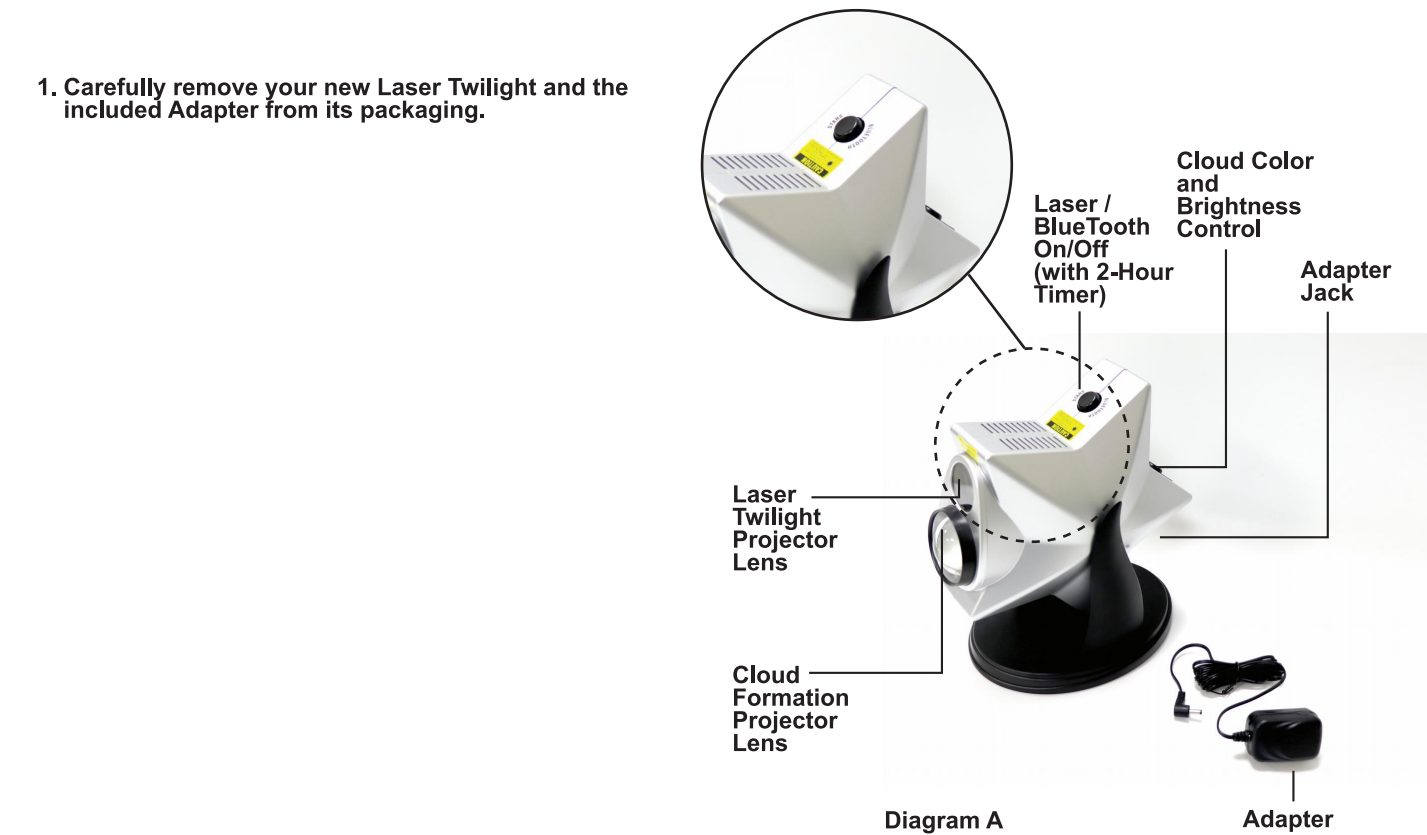

2. Place your Laser Twilight on a table or flat surface and plug the male end of the included Adapter into the Adapter Jack (see Figure 1). Plug the adapter into your wall outlet.
3. Adjust your Laser Twilight unit so that the projection lens is pointed towards the ceiling and away from you (see Figure 2A & 2B).

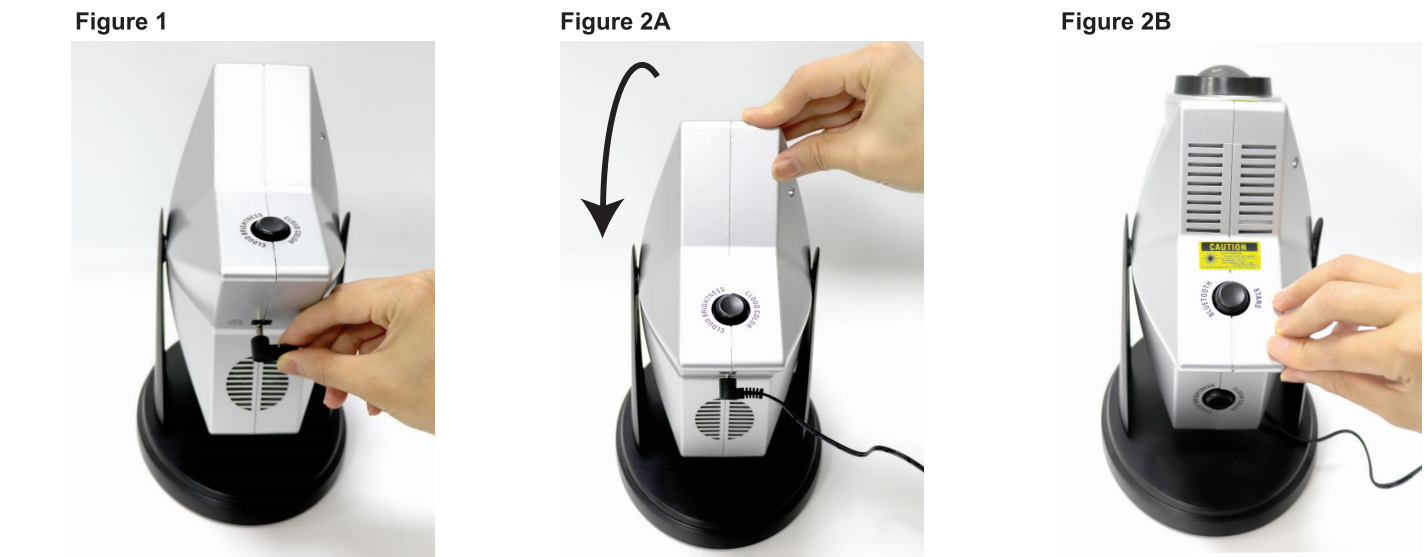

Laser Twilight with Timer
US Shipments (Class II, 1 mW)

A4 size - back

USING YOUR LASER TWILIGHT

Your Laser Twilight has 2 distinct “projections” that can be used independently of each other or use them together to create a wondrously slow-moving & hypnotic Laser Light Show which resembles a vast universe of green stars and nebulous cloud formation.

There are 2 main controls on the Laser Twilight:

- **Laser / Bluetooth On/Off** – This controls the green laser star field and the Bluetooth speaker
- **Cloud Color and Brightness Control** – This controls the ON / OFF function, color and brightness of the amount of clouds you want to project into the laser star field.

There are 3 ways to view the Laser Twilight:

1. **Green Laser Star Field** – You can view your light show as a green laser star field only. To achieve this effect, make sure that the Cloud Color / Brightness Control is off. Now push down once on the Laser / Bluetooth On/Off. The Laser Twilight should now be projecting the green laser star field onto the projection surface that you selected.
2. **Full Laser Twilight effect** – This is the ultimate lighting effect that can be achieved by your Laser Twilight. Here you will have the full power of both the green laser and the nebulous cloud. To achieve this effect, push down on the Laser / Bluetooth On/Off button once and release. Once again the green laser star field will be projecting on to the selected projection surface. Now push down on the Cloud Color and Brightness Control and the Cloud Formation will come on. Holding the button down will adjust the brightness of the Cloud Formation. Pressing the Cloud Color and Brightness Control again will change the Cloud Formation color. There are **7 different colors** to choose from. You can turn the Cloud Formation off by cycling through all the colors.
3. **Nebulous Cloud Effect** – This effect allows you to project the Nebulous Cloud by itself. For this effect, you leave the Green Laser Star Field off and turn on the Cloud as was just explained above.
4. **Bluetooth Speaker** – Pressing twice on the Laser / Bluetooth On/Off button to turn on the Bluetooth Speaker, you will hear a tone telling you that the Speaker is now discoverable. Turn on the Bluetooth on your device and connect to Xpecial Audio. Another tone will be heard once connection is completed.

TIMER FEATURE
The Laser Twilight has 2 Built-in Timers: 1 timer controls the green laser and 1 timer controls the blue cloud formation and they both operate independently of each other. Once you turn ON either or both of the controls (the laser star field or cloud formation) each has a 2-hour timer. Once turned ON, the timers will shut themselves off after 2 hours of continuous use. To turn the function back on, simply press the button to turn it back On. These timers not only help to increase the longevity of the delicate electronic parts used in the Laser Twilight, they also allow you to use the Laser Twilight as the coolest night light you will ever own.

Cleaning Instructions:
-Never touch any of the lenses with your fingertips.
-To clean your unit, use only a clean damp cloth.
-Never submerge your unit in water.
-Never use abrasive detergents of cleaners.

SAFETY DIRECTIONS FOR LASER TWILIGHT (NO. 25106)
CAUTION: Remember – Never look directly into the Laser Twilight.

The Laser Twilight has been designed for safe, trouble free operation. For your protection, warning labels and product identification labels have been affixed on the Laser Twilight.

CAUTION –
Use of controls or adjustments or performance of procedures other than those specified herein may resuly in hazardous radiation exposure, you should NEVER attempt to disassemble or service this product. See Diagram A to find where the following labels can be found on your Laser Twilight

For home use only. This is not for stage use.
In an environment with electrostatic discharge your product may malfunction and may need to be reset.
To reset the unit, simply unplug the jack for 1 minute and replace it.

Manufactured by
We're Always Thinking
Frisco, TX 75035



Caution: The user is cautioned that changes or modifications not expressly approved by the party responsible for compliance could void the user's authority to operate the equipment.

Note: This equipment has been tested and found to comply with the limits for a Class B digital device, pursuant to part 15 of the FCC Rules. These limits are designed to provide reasonable protection against harmful interference in a residential installation. This equipment generates uses and can radiate radio frequency energy and, if not installed and used in accordance with the instructions, may cause harmful interference to radio communications. However, there is no guarantee that interference will not occur in a particular installation. If this equipment does cause harmful interference to radio or television reception, which can be determined by turning the equipment off and on, the user is encouraged to try to correct the interference by one or more of the following measures:

- Reorient or relocate the receiving antenna.
- Increase the separation between the equipment and receiver.
- Connect the equipment into an outlet on a circuit different from that to which the receiver is connected.
- Consult the dealer or an experienced radio/TV technician for help.

FCC RF Radiation Exposure Statement:

This equipment complies with FCC radiation exposure limits set forth for an uncontrolled environment. This equipment should be installed and operated with a minimum distance of 20cm between the radiator and any part of your body.

FCC Supplier's Declaration of Conformity

Product name / model number : LASER TWILIGHT – BLUETOOTH / 25106

This device complies with part 15 of the FCC Rules. Operation is subject to the following two conditions: (1) This device may not cause harmful interference, and (2) this device must accept any interference received, including interference that may cause undesired operation.

Suppliers Name : WE'RE ALWAYS THINKING,LLC

Suppliers Address (USA) : 10616 COPPERWOOD DRIVE FRISCO,TX 75035

Suppliers phone number and / or internet contact information : harold@werealwaysthinking.com