

A 面

74.00 mm

100.00 mm

Woban®

User Manual

LED cabinet light CS6



Safety instructions

- *The user of the product must have read and understood these original operating instructions prior to its first use in order to safely implement this device.
- *Please comply with all safety instructions! If you disregard any of the safety instructions you may place yourself and others at risk.
- *Store all operating information and safety instructions for future reference.
- *This product is not designed for commercial use.
- *This product is not a toy and should not be played with children.
- *Never open any of the electrical parts or insert any kind of object into them.
- *This product is battery powered, never throw it to fire or water, the battery may explode.
- *Do not expose the product to high temperatures or moisture, the product may be damaged.
- *Please do not look straight at the LED chip, it may cause your eye uncomfortable.

Technical Data

Total: 6 PCS strip bar	IP Rate: IP20
Strip size: L500*W8mm	Wattage: 16W
Color temperature: 2700K	CRI > 80
LEDs: 30PCS /bar	Lumen: 1500lm

Function

1 16-key RF remote. Battery type: CR2025, 3V. Function as below:

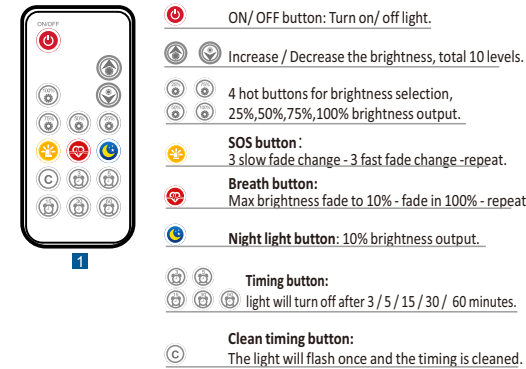

2 LED Controller:

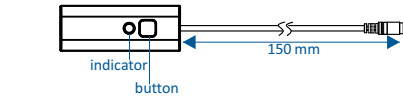

1. Click the button to turn on/ off light.
2. Press the button to adjust the brightness, the brightness will go down, then up to MAX.

5 straight connector

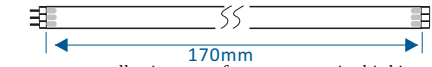

* There are some adhesive tapes for connectors in this kit.

1. Use it to connect two LED strips, go through the spacer. Depending on the length of the spacer, 2 to 5 PCS of this connector can be connected together.

2. Work as corner connectors:

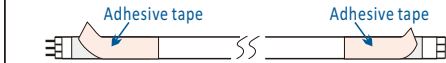

Firstly backed 2 adhesive tapes to each end of the connector, then bend it by corner, stick connector on, connect with other led strips.

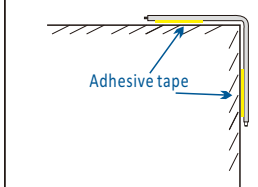

3 Adapter

Input: AC100-240V, 50/60Hz
Output: DC12V*2A

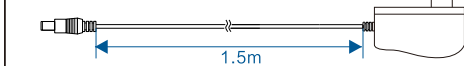

Additional function

If you have several kits, you can use one remote to control all the kits by "match" function. Just use one remote to re-match all the controller.

How to "re-match" remote with controller?

After plug in the power, turn off the light (the power is still on), then press the button on the controller to go into the "match" status, press the on/off button on the remote at the same time. The controller will be matched with the remote.

When controller is in "match" status, the strip will flick.
When "re-match" is done, the strip will change to constant on mode.

*When you want to control multiple LED controllers with one remote, make sure that multiple LED controllers are within the control range of the remote control. Mostly the range is 15 meters (Barrier free).

*If the remote doesn't work, please re-match with the controller. otherwise the battery built-in remote ran out, please replace the battery, the battery type is CR2025.

Installation

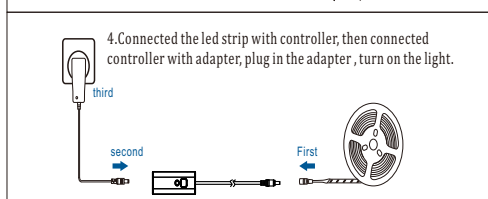
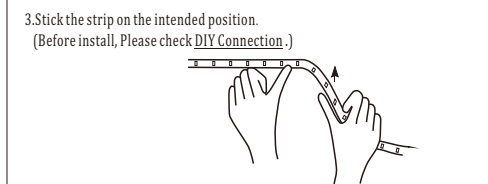
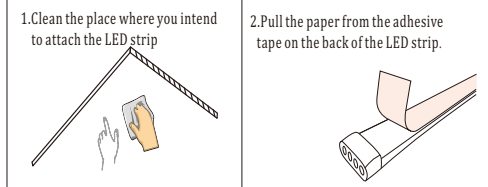

Notes: The strips and controller are backed with strong adhesive tape. Before install, Please make sure the intended position is clean, oil-free, dust-free, dry.

DIY Connection

a. Option 1 (length: 1.5 meter):

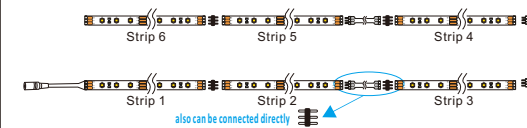

b. Option 2 (Length: 3 meter):



c. Option 3 (Length: 1 meter):

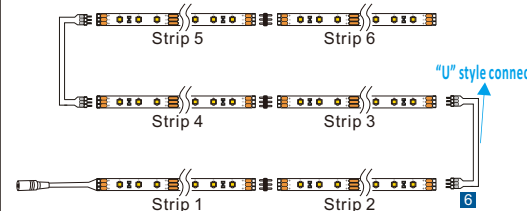

FCC Warning
This device complies with part 15 of the FCC rules. Operation is subject to the following two conditions: (1) this device may not cause harmful interference, and (2) this device must accept any interference received, including interference that may cause undesired operation.

Changes or modifications not expressly approved by the party responsible for compliance could void the user's authority to operate the equipment.

NOTE: This equipment has been tested and found to comply with the limits for a Class B digital device, pursuant to part 15 of the FCC Rules. These limits are designed to provide reasonable protection against harmful interference in a residential installation. This equipment generates uses and can radiate radio frequency energy and, if not installed and used in accordance with the instructions, may cause harmful interference to radio communications. However, there is no guarantee that interference will not occur in a particular installation. If this equipment does cause harmful interference to radio or television reception, which can be determined by turning the equipment off and on, the user is encouraged to try to correct the interference by one or more of the following measures:

- Reorient or relocate the receiving antenna.
- Increase the separation between the equipment and receiver.
- Connect the equipment into an outlet on a circuit different from that to which the receiver is connected.
- Consult the dealer or an experienced radio/TV technician for help.

Manufacturer: Shenzhen Bason Electronics Technology Co., Ltd.
Address: 5/F., Bldg B, Huilongda Industrial Park, Shiyuan Street, Baoan, Shenzhen, China

B 面