

Walkie Talkies

Model: YG-820/YG-821

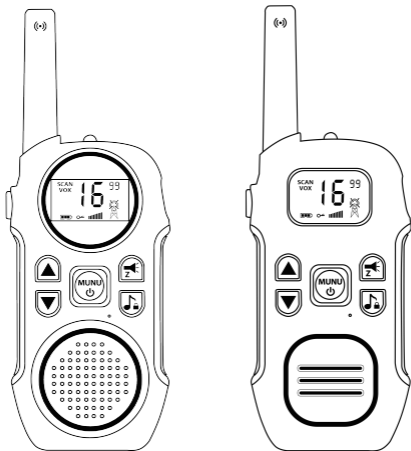

User Manual

Caution

- 1.1 This product contains small parts (such as belt clips) that may cause suffocation if swallowed by children.
- 1.2 Consult your doctor before use if you are carrying any kind of personal medical device.
- 1.3 To avoid the risk of burns, do not use the device if the antenna is damaged in any way.
- 1.4 Do not use the device near the radio to avoid interference.
- 1.5 The device cannot be used to contact emergency services.
- 1.6 Please do not disassemble or assemble it by yourself.
- 1.7 To avoid electromagnetic interference or electromagnetic compatibility problems, please turn off the walkie-talkie when there is a “please turn off the walkie-talkie” sign.
- 1.8 Turn off the walkie-talkie before entering the flammable and explosive environment.
- 1.9 Do not charge the battery in a flammable or explosive environment.



Product Description

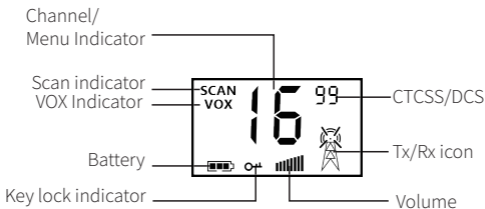
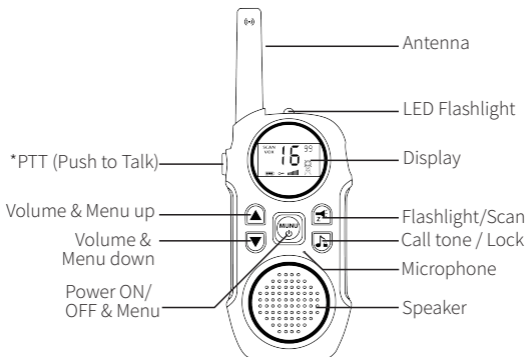

***PTT(Push to Talk) :** Push to Talk, release to listen;

***Call tone/ Lock:** Short press to call, long press to lock or unlock keyboard.

***Flashlight/Scan:** Short to turn on or off flashlight, long press to scan channels.

***Power key:** Short press to enter menu setting, long press to power on or off.

***▲/▼:** In non-menu setting state, short press to turn up/down volume; In menu setting state, short press to set related functions.

Belt Clip removal

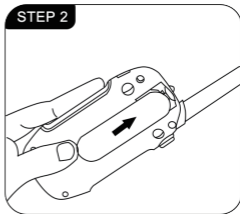
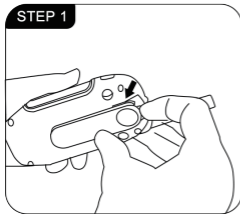

Lift the plastic clip and push it outward.

Before Use



- Please charge it before using it for the first time, please use a 5V 1A/2A charger.
- Please charge in time. When the battery icon flashes, it means that the battery is low. When fully charged, the battery icon will stop flashing.

How to Use

1. Power on or off.

Long press  to power on or off.

2. Set the Channel:

- Channel: Short press  one time, the channel starts to flash, press ▲/▼ to set the channels, There are 22 channels for you to set, after selected, press PTT to confirm;
- Sub-code: Short press  2 times, the sub-code starts to flash, press ▲/▼ to set the sub-code, you can set 01-99, OF means no code, 01-38 means CTCSS code, 39-99 means DCS code, press PTT to confirm;

- To communicate, all walkie-talkies in the group must be set to the same channel and sub-code;
- Hold the walkie-talkies 2-3inches(5-7cm) away from your mouth and speak directly into the microphone. Don't cover the microphone when you're talking, and when you're finished, release the PTT (Push to Talk, release to listen)

Note:

You must set the sub-code to OF in order to communicate with other FRS radio stations that do not have the Interference cancellation code.

3. VOX (voice-operated exchange) ,You can talk into a walkie-talkie microphone instead of pressing a PTT button.

Set: Short press  3 times to enter VOX setting, default OF(off), press ▲ / ▼ to set the sensitivity level (Level 1,2,3,level 3 is the most sensitive), press PTT to confirm.

4. Adjust the volume:

Press ▲ / ▼ to turn up or down the volume(level 1-8).

5. Channel scanning:

Long press  to scan the channel, short press PTT to stop scanning.

6. Call:

Short press  to call group.

7. Set the call tone:

Short press  4 times, screen will display “CA⁰¹”, and “01” will start to flash, press ▲ / ▼ to select the tone (10 calling tones) press PTT to confirm.

8. Turn button sounds on and off:

Short press  5 times, screen will display “CO^{on}”, “on” starts to flash, press ▲ / ▼ to turn on or off the button sounds.

9. End call tone:

- Short press  6 times, screen will display “CO^{on}”, press ▲ / ▼ to turn on or off.
- “ON” means there will be a tone when PTT is released, “OF” means there will be no tone.

10. Lock the keyboard:

- Long press  to lock or unlock the keyboard.
- When locked, only PTT/Call tone is available. Others are not available.

11. Flashlight:

Short press  to turn on or off the flashlight.

Warranty

The manufacturer's warranty is void under the following circumstances but not limited to:

Improper or inadequate maintenance or modification. Accident, misuse, abuse, contamination, or other external causes.

The use of unspecified adapter and accessories, Loss or damage in transit.

Damages occur as a result of one's failure to follow the instructions.

This warranty does not apply to expendable or consumable parts.

Customer Service:

We have a customer service team that guarantees hassle-free solutions to any issue you might have within 24 business hours.

FCC Warning

15.19 Labeling requirements.

This device complies with part 15 of the FCC Rules. Operation is subject to the following two conditions: (1) This device may not cause harmful interference, and (2) this device must accept any interference received, including interference that may cause undesired operation.

15.21 Information to user.

Any Changes or modifications not expressly approved by the party responsible for compliance could void the user's authority to operate the equipment.

15.105 Information to the user.

Note: This equipment has been tested and found to comply with the limits for a Class B digital device, pursuant to part 15 of the FCC Rules. These limits are designed to provide reasonable protection against harmful interference in a residential installation. This equipment generates uses and can radiate radio frequency energy and, if not installed and used in accordance with the instructions, may cause harmful interference to radio communications. However, there is no guarantee that interference will not occur in a particular installation. If this equipment does cause harmful interference to radio or television reception, which can be determined by turning the equipment off and on, the user is encouraged to try to correct the interference by one or more of the following measures:

- Reorient or relocate the receiving antenna.
- Increase the separation between the equipment and receiver.
- Connect the equipment into an outlet on a circuit different from that to which the receiver is connected.
- Consult the dealer or an experienced radio/TV technician for help.

Absorption Rate (SAR) information:

This device meets the government's requirements for exposure to radio waves. The guidelines are based on standards that were developed by independent scientific organizations through periodic and thorough evaluation of scientific studies. The standards include a substantial safety margin designed to assure the safety of all persons regardless of age or health.

FCC RF Exposure Information and Statement

The SAR limit of USA (FCC) is 1.6 W/kg averaged over one gram of tissue. This device was tested for typical body-worn operations with the back of the device kept **0mm** from the body. To maintain compliance with FCC RF exposure requirements, use accessories that maintain an appropriate separation distance between the user's body and the back of the device. The use of belt clips, holsters and similar accessories should not contain metallic components in its assembly. The use of accessories that do not satisfy these requirements may not comply with FCC RF exposure requirements, and should be avoided. Use only the supplied or an approved antenna.