

Wireless Charger

USER MANUAL

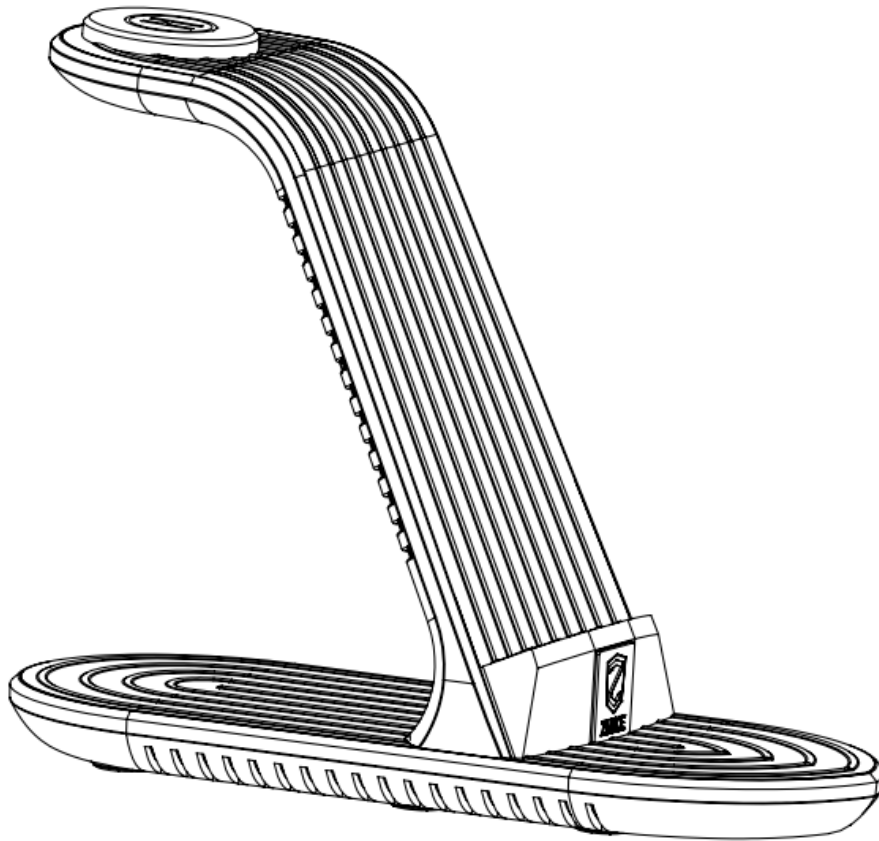

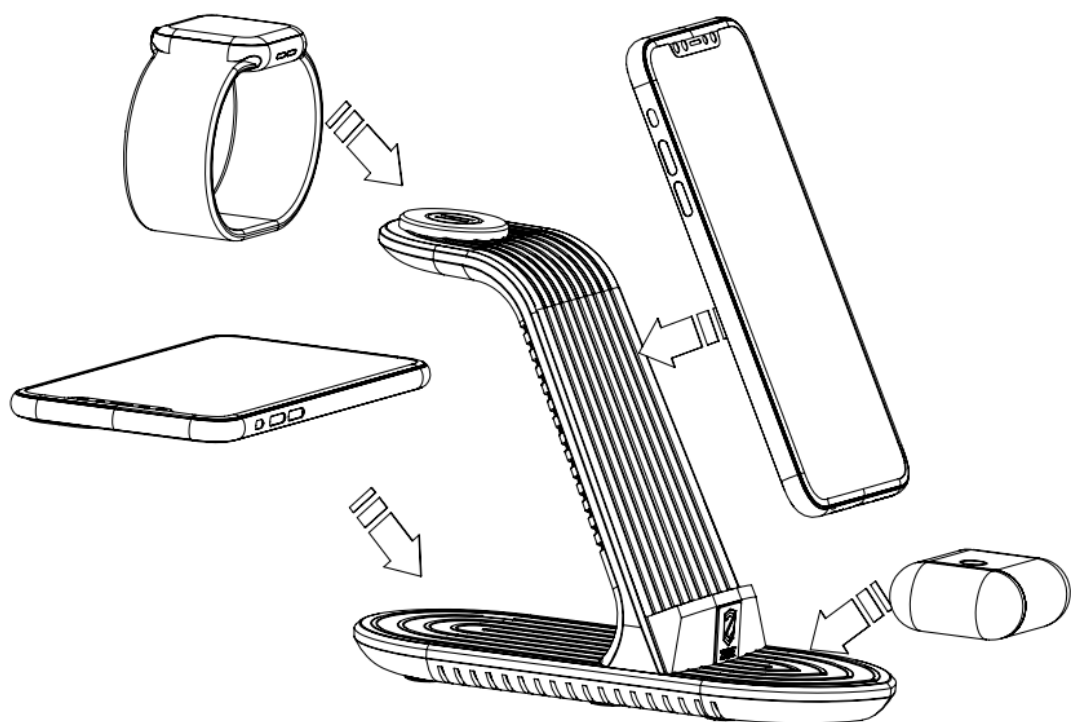

•Be sure to use certified QC 3.0 adapter

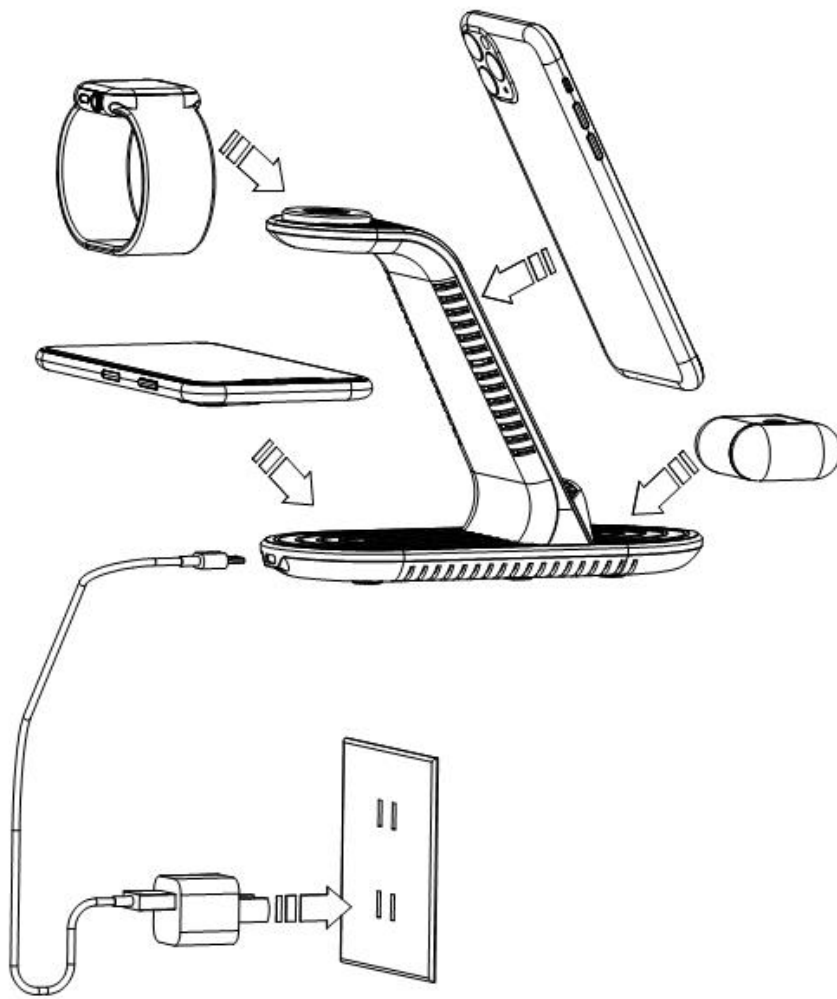

•Be sure to use certified QC 3.0 adapter

IMPORTANT SAFETY INSTRUCTIONS

Please read the user manual carefully before using this unit

- Do not store device in high-temperature environment, including heat caused by intense sunlight or other forms of heat. Do not place device in fire or other excessively hot environments. Exposure to fire or temperature above 212°F(100°C) may cause explosion.
- Do not use the wireless charger in excess of its output rating. Overloading outputs above rating may result in a risk of fire or injury to persons.
- Do not expose the wireless charger to rain or snow.
- Do not modify, repair or disassemble the unit, if so, please contact the manufacturer.

Switch off the wireless charger when not in use. The wireless chargers will automatically switch off when disconnected from its wall charger.

Applicable Devices:

1. Smart Phone

- iPhone 8 / 8 Plus / X / XS / XR / XS Max / 11 / 11 Pro / 11 Pro Max ect
- Samsung Galaxy S7 / S7 Edge / S6 Edge Plus / Note 5
- Samsung Galaxy S8 / S8 Plus / Note 8
- Samsung Galaxy S10 / S10 Plus / S10e / Note 10
- More cell phones compatible with Qi wireless charge.

2. Headphone

- Apple AirPods 1/2, AirPods Pro or other TWS earphones compatible with Qi wireless charge

3. Smart Watch

Apple Watch or Samsung Watch compatible with Qi wireless charge(Please check the rechargeable model on the box.)

Please Note:

1. The Watch Wireless Charging Area only supports Apple Watch or Samsung Watch, please check the model on the box.
2. Please remove your phone case before charging if the thickness > 3 mm, or if the phone case will make your phone size longer than 164 mm.
3. Please use certified QC 3.0 Fast Charging Wall Adapter to charge, do not plug into computer USB port or any other non certified USB port. We are not responsible for malfunction due to unsupported adapter use.
4. The QC 3.0 fast charging adapter is required when charging 3 devices simultaneously or want to have a fast charging effect.
5. Place your qi-enabled device accurately in the wireless charging area when charging.
6. Make sure to disconnect the device from power when cleaning.

7. It is normal and safe to hear a humming noise when very close to the charger. It means that the wireless charger is adjusting its temperature to achieve a more efficient charging speed.

8. If your device can't be fully charged, it may be due to high environmental temperature, please recharge after the temperature is lowered. Our charger has temperature control to safeguard your device when charging.

Question & Answer:

Q: If the LED light flashes and the wireless charging dock doesn't work, what should I deal with this problem?

A:

1. Make sure your device supports the Qi wireless charging function before using this wireless charger.
2. Check if you use the QC 3.0 adapter to power our wireless charger.
3. Test with other USB cables.
4. Check whether your device's case comes with metal objects. Magnetic and metal attachments will make an LED flash and prevent charging.

Earphone, bracelet coil is less than or equal to 5 watts.

Mobile phone coil is less than or equal to 10 watts.

FCC WARNING

This device complies with part 15 of the FCC Rules. Operation is subject to the following two conditions: (1) this device may not cause harmful interference, and (2) this device must accept any interference received, including interference that may cause undesired operation.

Any changes or modifications not expressly approved by the party responsible for compliance could void the user's authority to operate the equipment.

NOTE: This equipment has been tested and found to comply with the limits for a Class B digital device, pursuant to Part 15 of the FCC Rules. These limits are designed to provide reasonable protection against harmful interference in a residential installation. This equipment generates, uses and can radiate radio frequency energy and, if not installed and used in accordance with the instructions, may cause harmful interference to radio communications. However, there is no guarantee that interference will not occur in a particular installation.

If this equipment does cause harmful interference to radio or television reception, which can be determined by turning the equipment off and on, the user is encouraged to try to correct the interference by one or more of the following measures:

- Reorient or relocate the receiving antenna.
- Increase the separation between the equipment and receiver.
- Connect the equipment into an outlet on a circuit different from that to which the receiver is connected.
- Consult the dealer or an experienced radio/TV technician for help.

To maintain compliance with FCC's RF Exposure guidelines, This equipment should be installed and operated with minimum distance between 20cm the radiator your body: Use only the supplied antenna.