

# User Manual

Bird feeder with dual camera

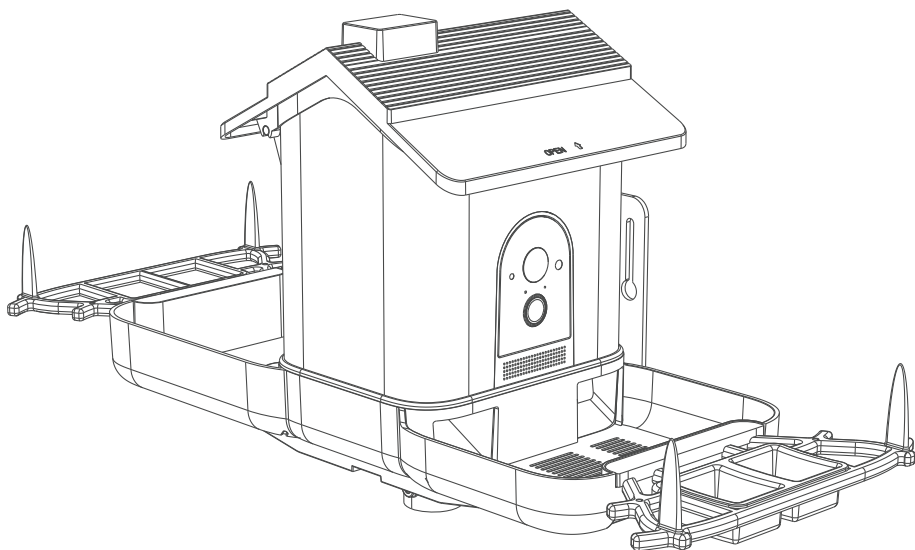

# Contents

1. What's In the Box	<01>
2. Product Overview	<03>
3. Assemble the Bird Camera	<05>
4. Set Up the Camera	<07>
5. Install the Bird Camera	<15>
6. Install the Solar Panel	<19>
7. Add Seed & Water	<21>
8. Clean & Maintenance	<23>
9. FAQ	<24>
10. FCC Compliance Statement	<28>

## Note:

The manufacturer reserves the right to make product improvements and updates. Due to the possibility of recent changes, the information in this manual might not perfectly reflect the latest product specifications. In such cases, the actual product received shall prevail over the manual.

# What's In the Box

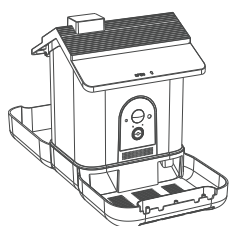

Bird Feeder & Bath  
with Camera

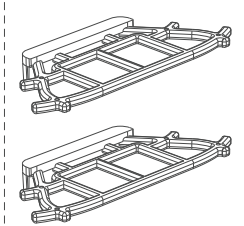

Bird Perch

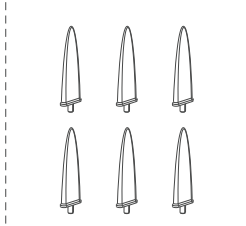

Fruit Holder

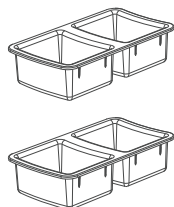

Jelly Feeder

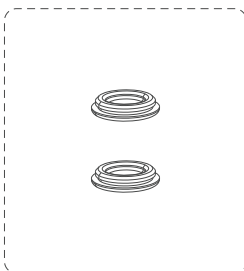

Silicone Plug  
for Bird Bath

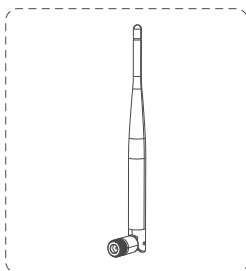

Antenna

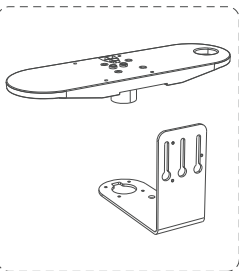

Mounting Bracket  
Kit

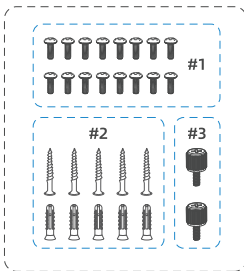

Screw Kit

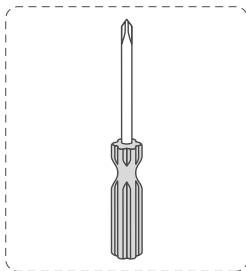

Screwdriver

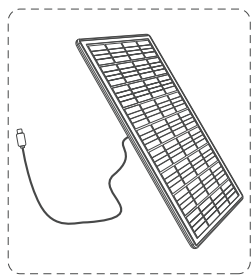

Solar Panel

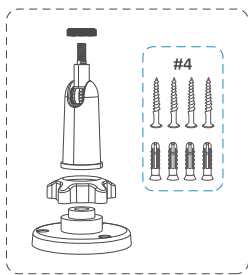

Solar Panel Fix Kit

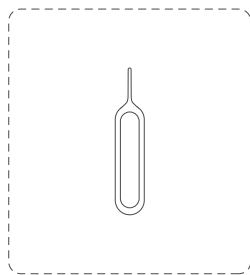

Reset Pin

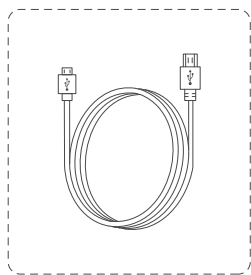

Charging Cable

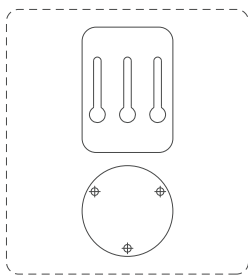

Drilling Positioning  
Sticker

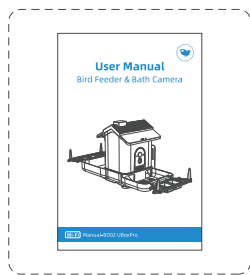

User Manual

# Product Overview

## Bird feeder view

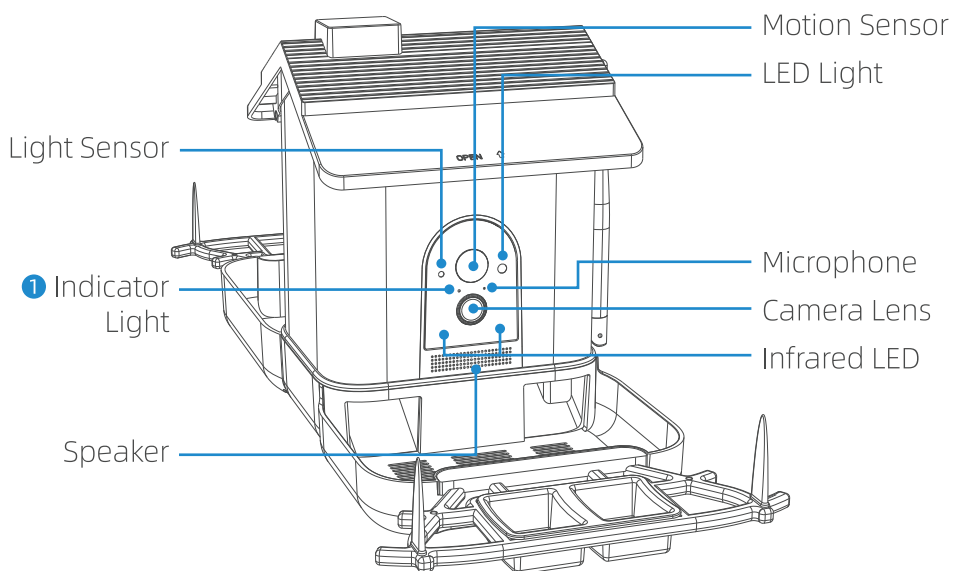

## Bird bath view

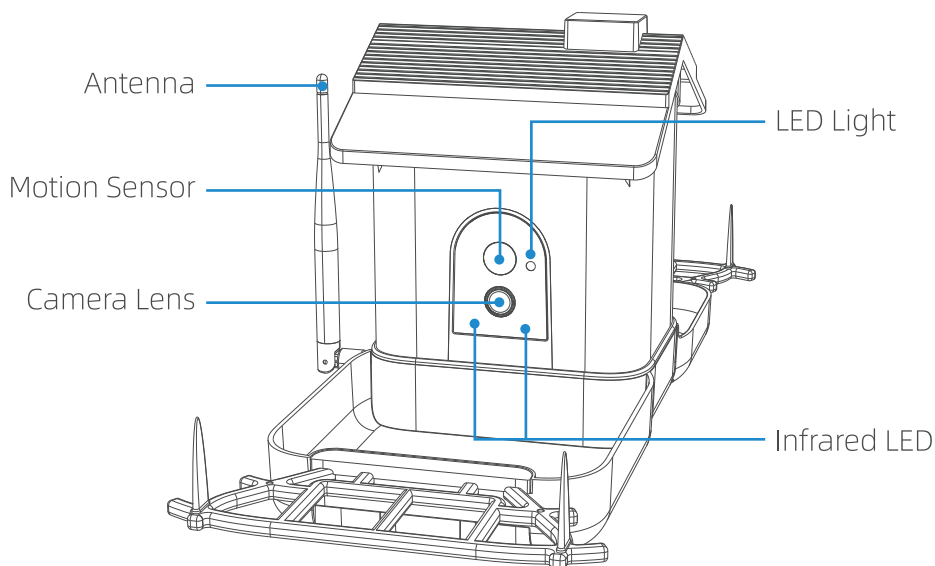

**Side view**

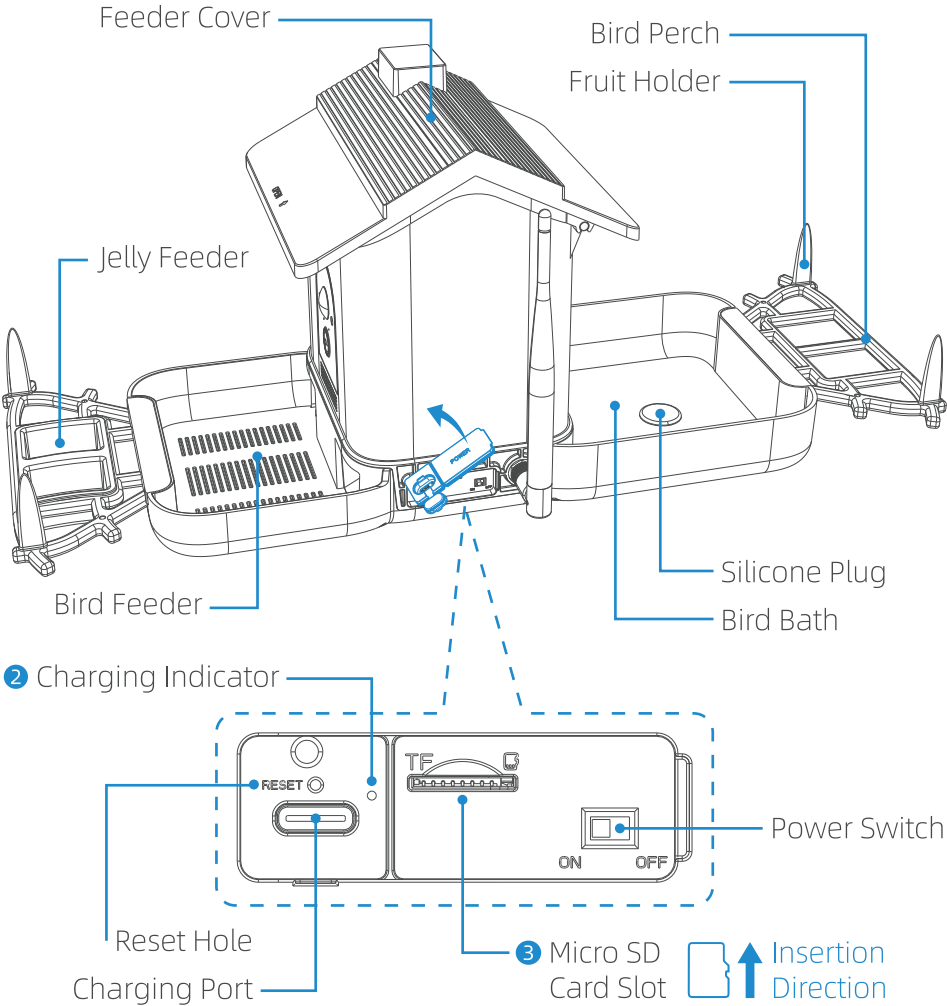

- 1 **Indicator Light:** Lights up red when powered on, after the blue light is flashing, you can add the camera.
- 2 **Charging Indicator:** The indicator will be in solid orange when charging and will turn off when it is fully charged.
- 3 **Micro SD Card:** Supports up to 128GB SD card (not included). Always power off the camera before inserting the SD card.

# Assemble the Bird Camera

## Assemble the antenna

- Insert the antenna into the connector on the side of the bird seed container and twist it tight.

### Note:

If the antenna is disconnected or not attached properly, the app will not be able to connect to the smart bird feeder.

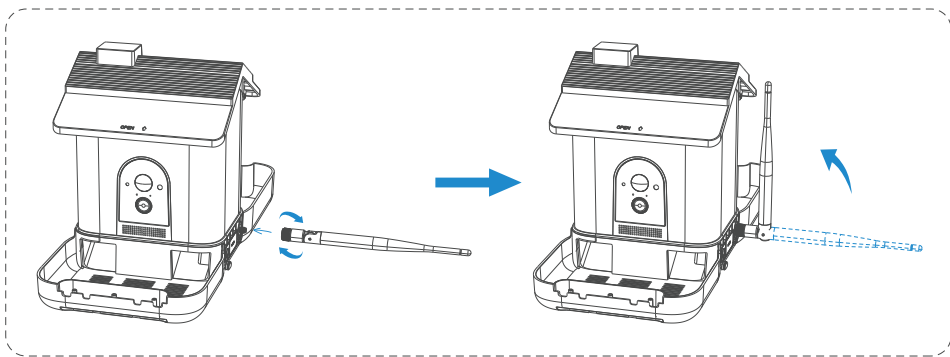

## Assemble the bird perch

- Align the towers on the bird perch with the holes in the bird feeder base, then press the bird perch into place.

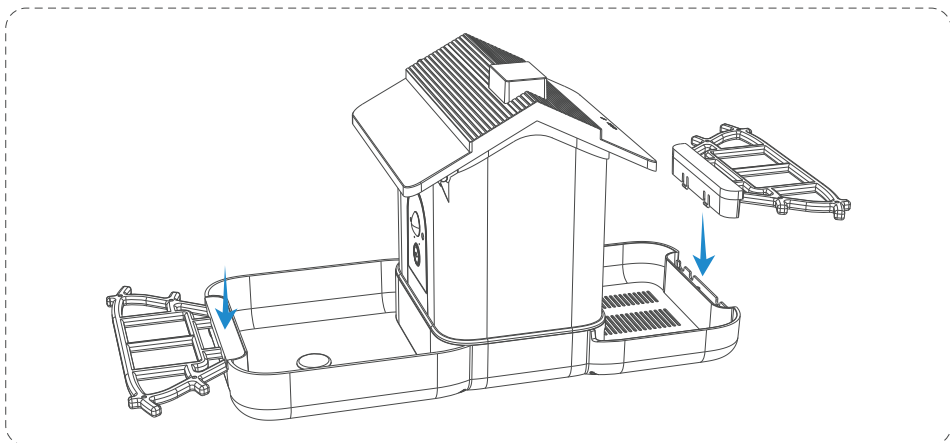

## Assemble the add-ons

- Attach the jelly feeder and fruit holder to the bird perch as you need them as shown in the picture below.

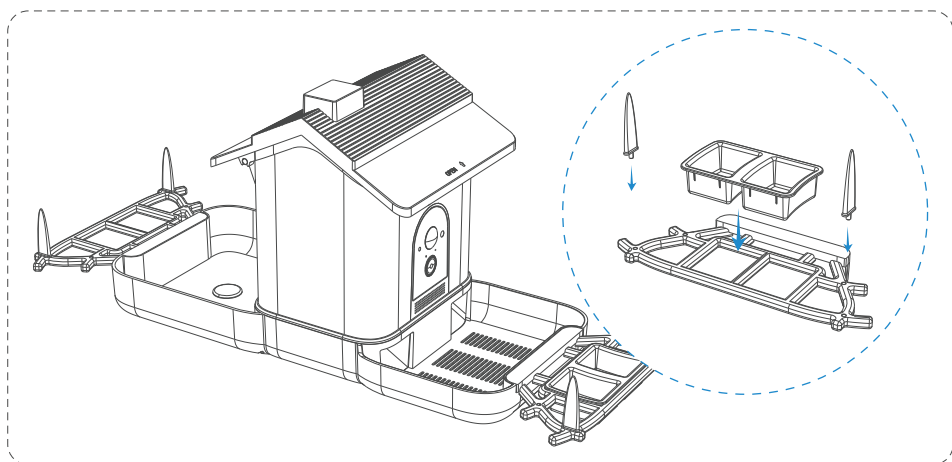

## Cover the silicone plug

- Cover the silicone plug on bird bath in the direction as shown below.

### Note:

Please make sure the silicone plug is tightly capped or the water may leak.

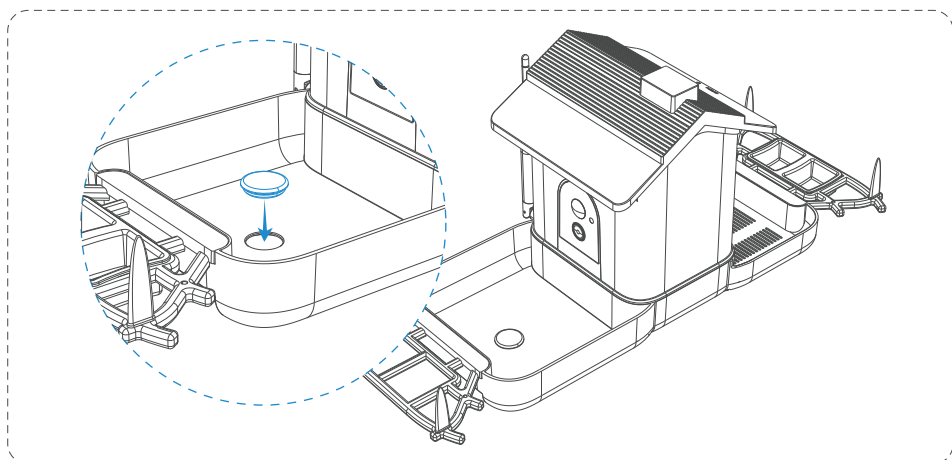



# Set Up the Camera

## Download and Install UBoxPro App

- Scan the QR code below or search "UBox Pro" on APP Store or Google Play Store to download and install the app.

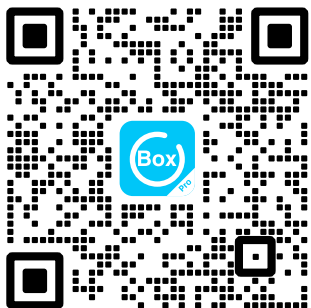

### Note:

Please click "**Allow**" or "**Agree**" while downloading the App and setting up an account, so that the UBox Pro App can access the camera and some permissions of mobile phone (Camera, Location, Storage, Microphone, Notifications, Bluetooth and Wireless Data).

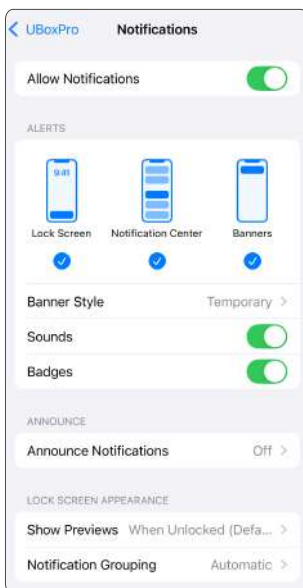

# Sign Up

- Open the UBox Pro App, select your country and then tap **"Register"**.
- Input your E-mail, check and gree the User Agreement, then click **"Next"**.
- Set the login password and re-enter it to confirm. Inout the verification code show on picture. Click **"Sign up"**.

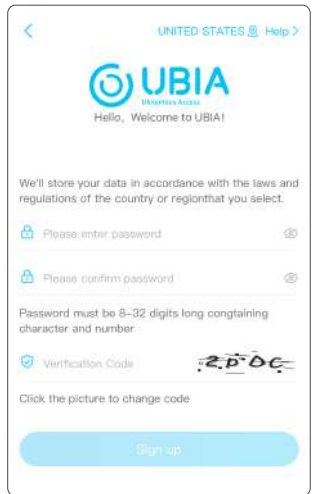
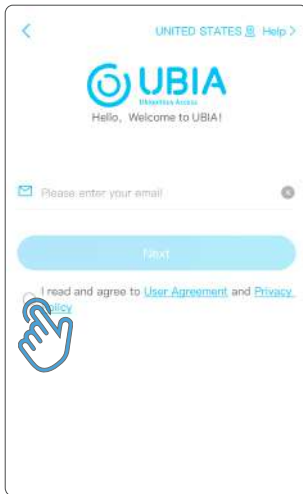
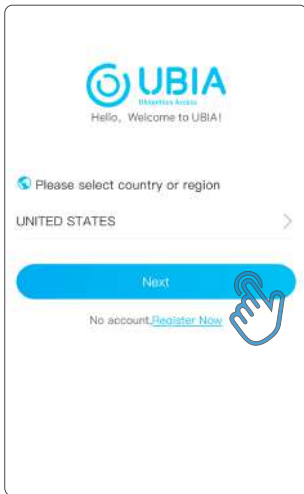

- You will receive an email with a link to verify your email address. Click on the link in the email to complete the verificat. You will then be able to log into your account.

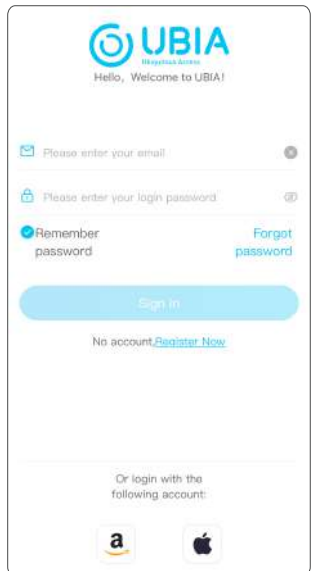

# Turn on & off the camera

	Operation	Status
Turn on the camera	Turn on the power switch	Light: Red → blue
Turn off the camera	Turn off the power switch	Light: off
Enter the network configuration mode	Long press the reset button for 5s <sup>*</sup>	Paring sound Light: Flashing blue

## Note:

Resetting the camera and entering into the network configuration mode requires a long press on the RESET button **while the camera is powered on**.

# Charging the Camera

- Please fully charge the camera with a 5V/2A or 1A USB adapter before using (Adapter not included). It takes about 6-8 hours to fully charge your camera.

## Note:

During charging, the charging indicator is solid orange. And when the camera is fully charged, the indicator light will turn off.

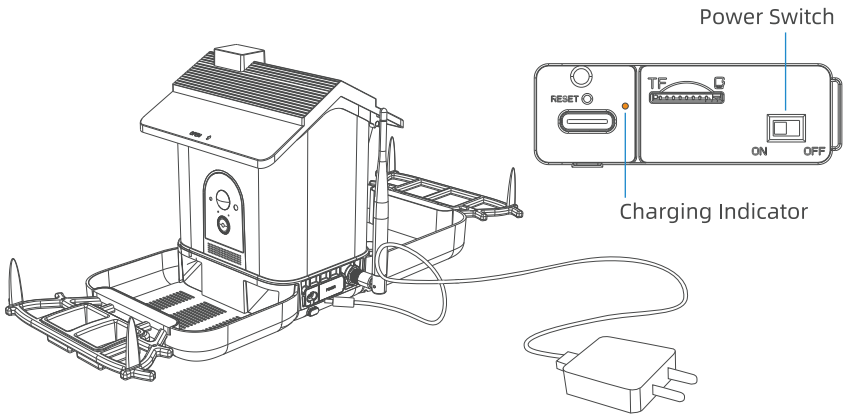

# Add the Camera

- Add your Device location. (Make sure the location is set correctly, this will affect the proper functioning of the cloud services.)

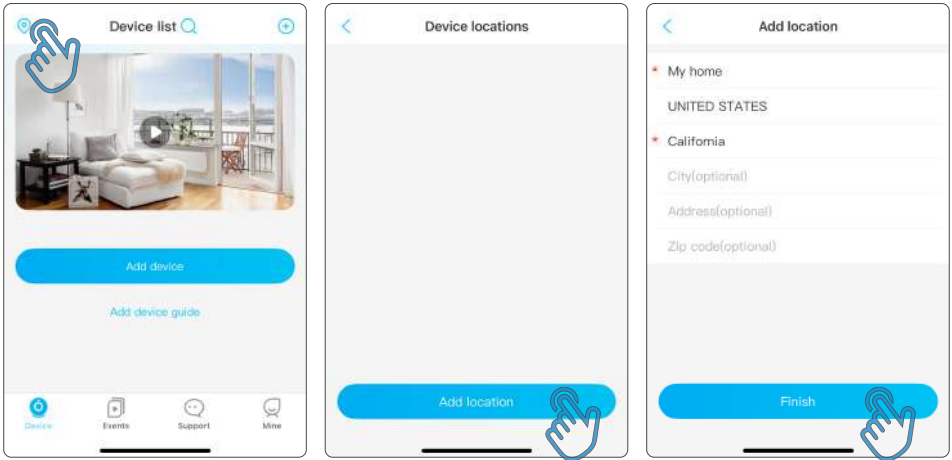

- Click "**Add Device**". turn on the power switch to turn on the camera. Use the reset pin to insert into the **RESET** hole then press and hold for 5 seconds to enter the pairing mode. You will hear the voice prompt "**The camera is now ready to begin pairing**" and the blue indicator is blinking.

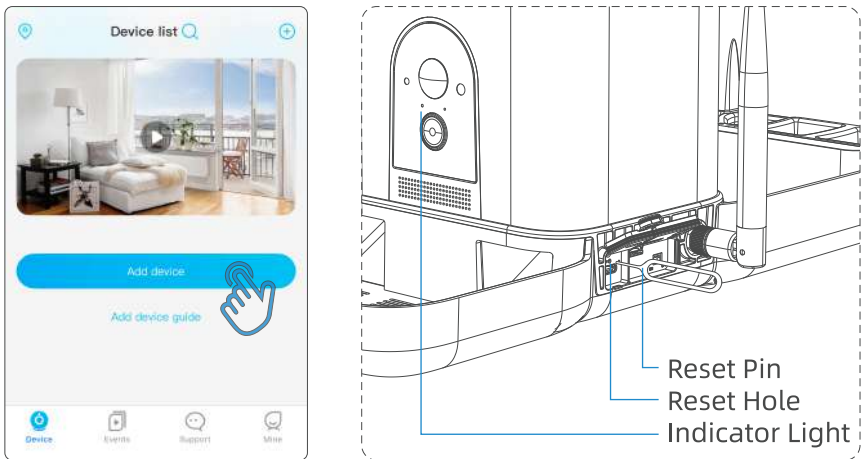

- After making sure the camera is in pairing mode, click "**Next**".
- Waiting for your phone detects the camera, click the device to the next step.

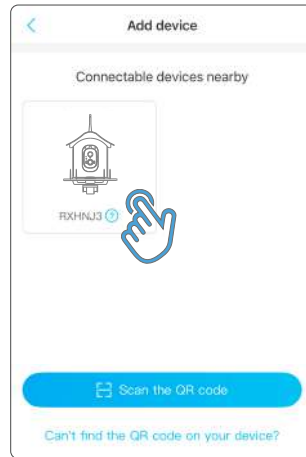

- Customise the device name or use the default name and click "**Next**".
- Enter the correct router WiFi password. Click the eye icon to reconfirm that you entered the correct password, then click on "**Next**".
- Keep your phone at a distance of 1-2 meters from the camera. Wait for the connection to establish.

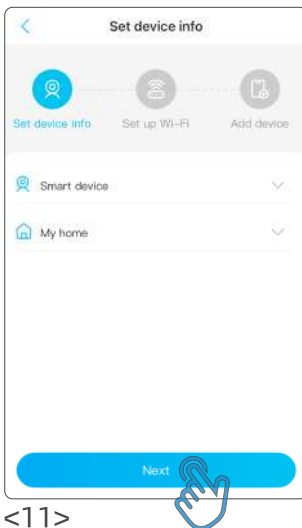

## Note:

If the App did not detect the device, please check if the Bluetooth permission of the App is turned on and camera is under pairing mode.

The smart bird feeder only supports 2.4GHz Wi-Fi network.

- Congratulations! You have connected the camera to the App successfully, now you can watch the live video on your phone anytime and anywhere which is captured by the camera.

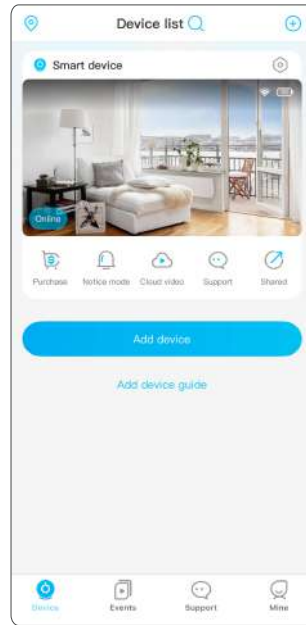

## Note:

If the camera cannot be located by bluetooth, you can also pair the camera by scanning QR code.

- Click on "**Scan the QR code**" and use your cell phone to scan the QR code on the camera.
- Then follow the instructions of the app: check the camera is under pairing mode, set camera name and location, enter the WiFi name and password. At this time, the app interface will display a QR code.



- Place the phone with QR code on it in front of the lens and keep a distance of 10 cm, you will hear a confirmation voice after the camera scanned successfully.
- When the pairing is successful, there will be a pop-up prompt, click OK to confirm.

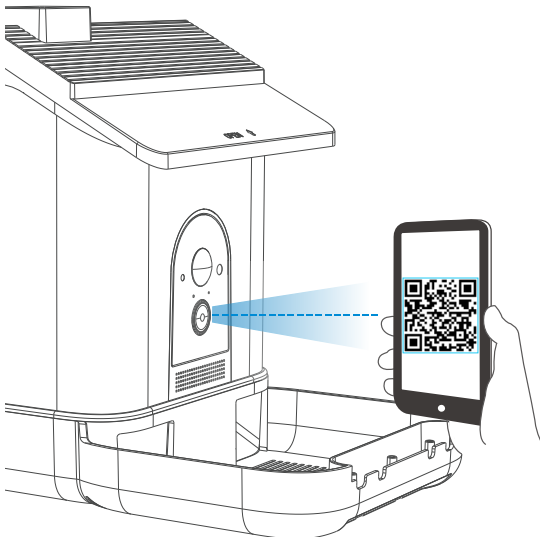

4 inches (10 cm)

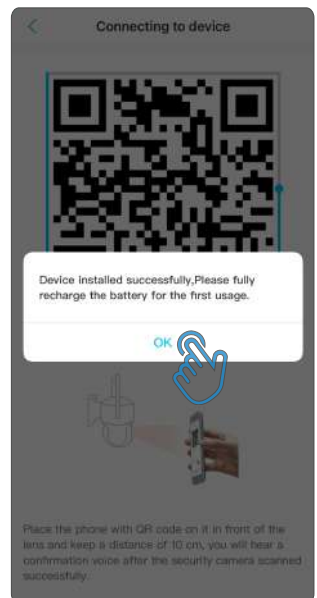

# Possible Problems with Connecting

- If you fail to connect the camera via Bluetooth, please follow the prompts to add the camera by scanning the QR code.
- Before adding the device, please make sure that the device is in a blinking blue light state. If the indicator light is abnormal, please reset the camera to factory settings (press and hold the reset button for 5 seconds to reset the camera. Release the button after hearing a sound) and then re-add the camera.
- Make sure your phone is connected to your 2.4GHz Wi-Fi. When your 2.4GHz Wi-Fi is properly connected to your phone, your Wi-Fi name will be recognized by the camera and the Wi-Fi input page will pop up automatically.
- Let your phone forget your 5GHz Wi-Fi connection from your phone Wi-Fi list to avoid priority pairing.
- Keep your phone, camera and router within 15 feet for strong Wi-Fi signal strength during pairing process.

## Note:

If you encounter any problems during the pairing process, you can seek help by contacting online customer service in the app. Scan the QR code on your device and describe the problem you are experiencing, then submit it.

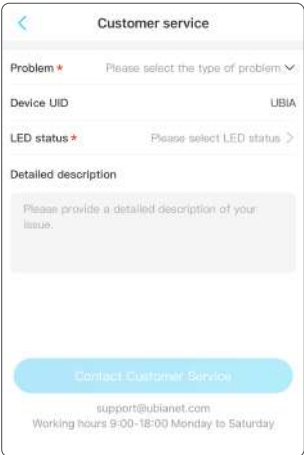
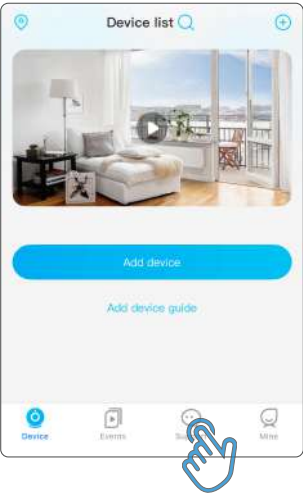



# Install the Bird Camera

## Before Installation

- The device has been successfully added to the app.
- Keep Smart bird feeder and all accessories out of reach of children and pets.
- Make sure the camera has been fully charged (DC 5V/1-2A).
- Working temperature: -10°C to 45°C (14°F to 113°F), working relative humidity: 0-95%.

### Note:

- Smart bird feeder only works with 2.4 Ghz Wi-Fi.
- Strong lights may interfere with the device's ability to scan QR codes.
- Avoid placing the device behind furniture or near microwaves products. Try to keep it within range of your Wi-Fi signal.

## During Installation

### 1. Find a position with good signal

- Please install the smart bird feeder in a position where its view is not blocked and ensure that it is within range of the Wi-Fi network. Bring the Bird Camera to the location where you plan to install it (where birds are often active) and make sure that the app can still smoothly view the camera video.

### 2. Assemble the mounting bracket

- Assemble the metal bracket and plastic bracket together as shown in the illustration. Then use the screws provided to secure them in place.

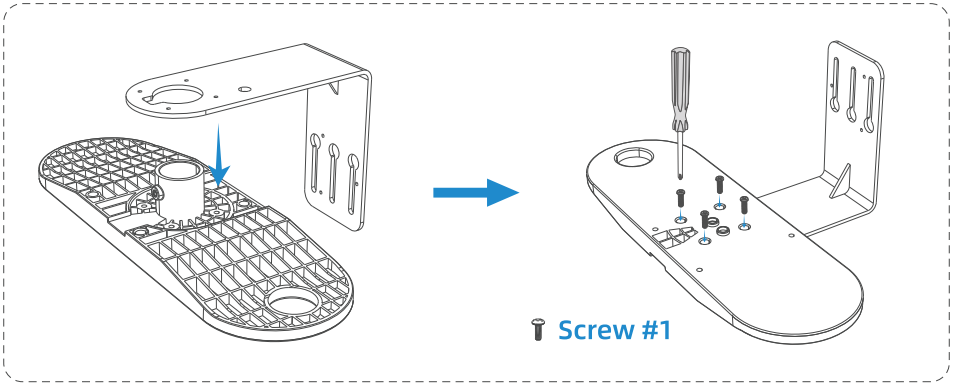

### 3. Wall Mounting

- Mark the location of the holes on the wall by using the included drilling template stickers. Then use a drill bit to drill holes on the wall.
- Install anchors to fix the bracket screws.

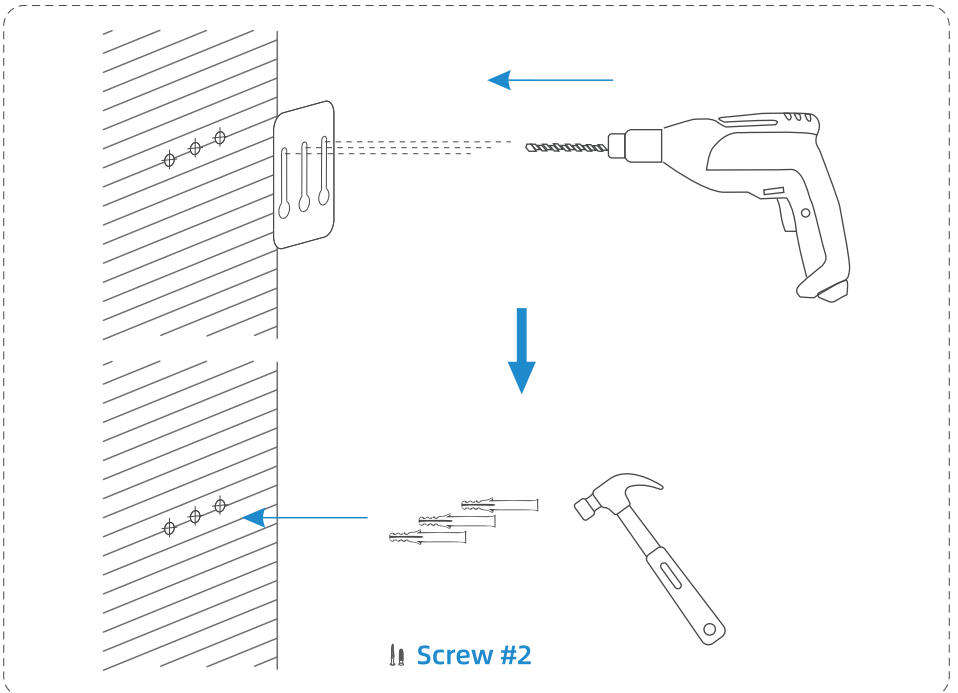

- Install the mounting bracket on your wall with the bracket screws provided.

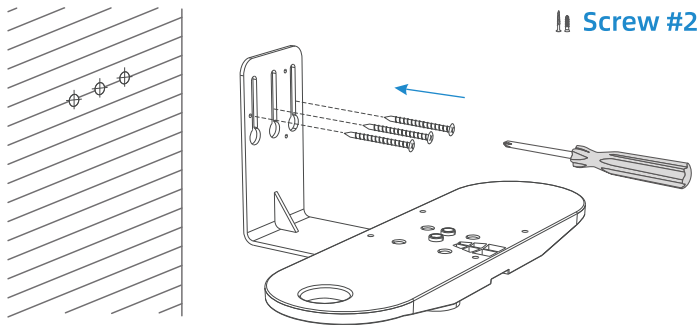

- Attach the base to the mounting bracket. Align the screw holes in the base with the holes in the bracket then lock the fixing screws on the bottom.

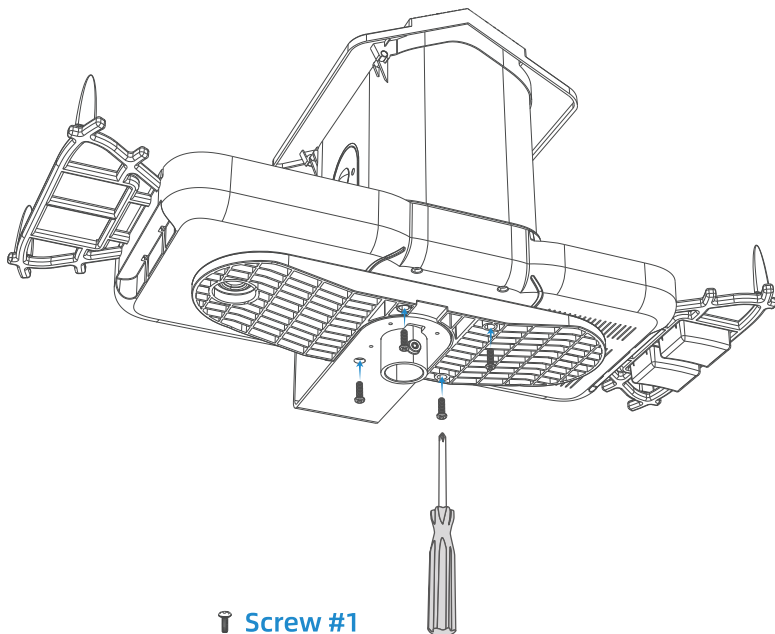

#### 4. Pole Mounting (Optional)

- Attach the base to the mounting bracket. Align the screw holes in the base with the holes in the bracket then lock the fixing screws on the bottom.

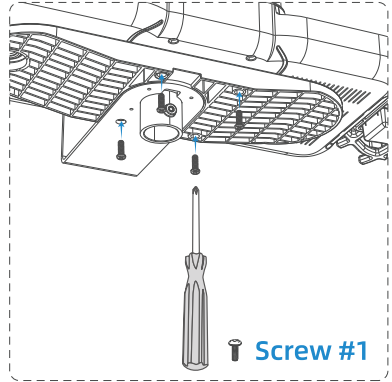

- Insert the pole into the ground, then place the bird feeder on the pole, and finally tighten the screw.
- It fits any standard-sized birdhouse pole, with a 1" / 2.5cm diameter. Please note that the pole itself is not included in the package.

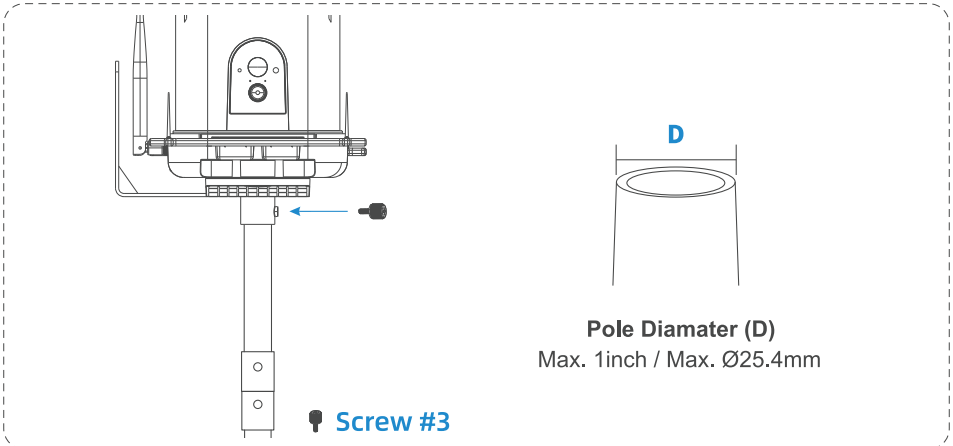

#### Note:

The mounting bracket and base should be securely fastened together so they don't wobble when birds fly away or the wind blows.

# Install the Solar Panel

- Please select a position with the most sunlight through out the year for your solar panel. The solar panel only needs a few hours to direct sunlight to sufficiently power your camera daily. The amount of energy that the solar panel can produce is affected by the weather conditions, seasonal changes, geographic locations, etc.

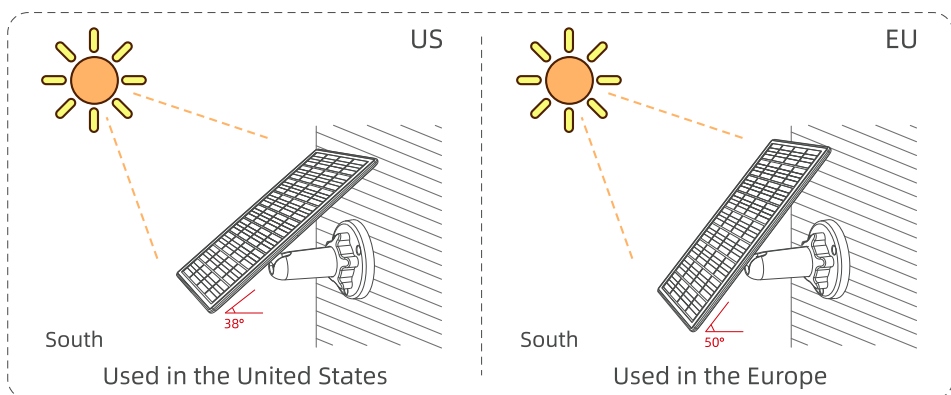

- Use the drilling tool to punch holes in the wall or tree according to the hole distance of the base. It is recommended to mark the holes on the wall or tree before drilling with the drilling template sticker. Screw the anchors into the holes, and then connect the solar panel bracket to the anchors with screws. (the anchors and screws used here are all in the Solar Panel Kit)

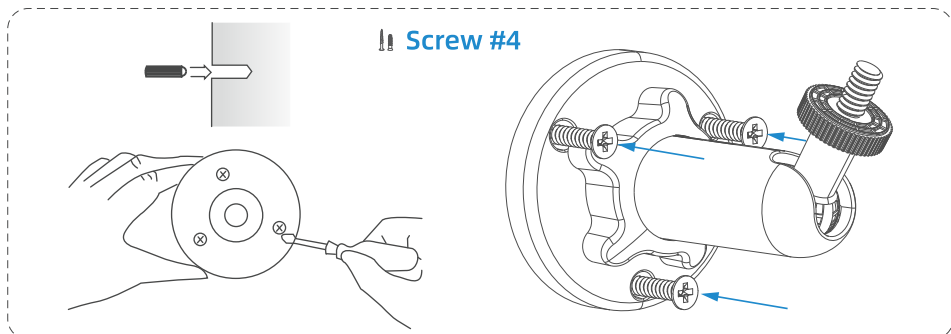

- Slot the solar panel into the bracket and make sure it's secure. Loosen the adjusting control on the bracket and adjust the angle of the solar panel to make it receive direct sunlight, and then re-tighten the adjusting control to secure your setting.

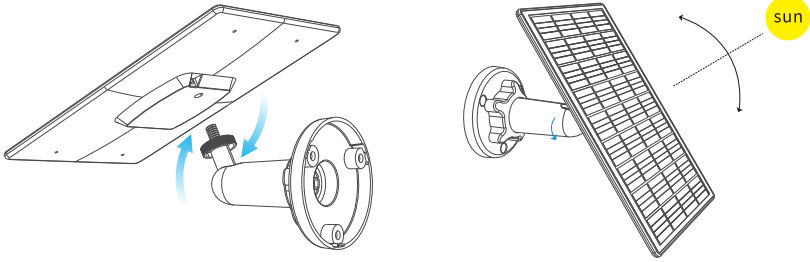

When using a pole to mount your feeder, you can also screw the solar panel bracket directly to the mounting bracket.

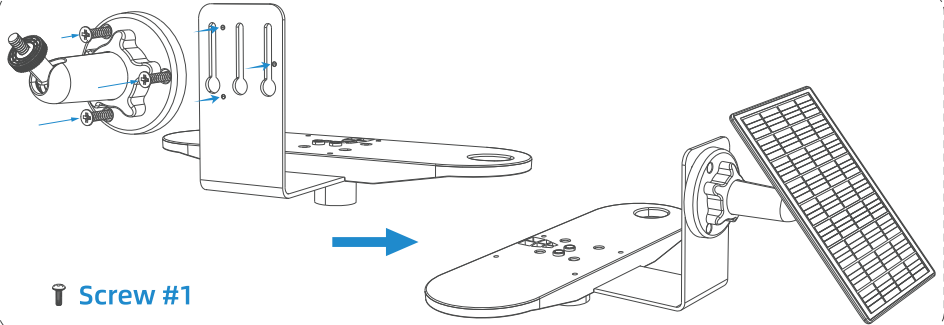

 **Screw #1**

- Connect the solar panel to the charging port of the bird feeder with the equipped 3-meter Type-C charging cable.

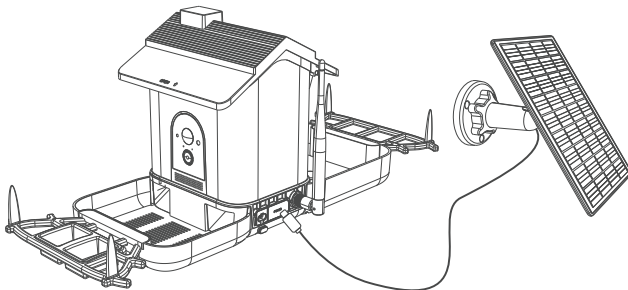

# Add Seed & Water

## 1. Add Bird Seed

- Pull the buckle on the roof of the bird feeder outward, then lift the roof upward to open it. (See image below)

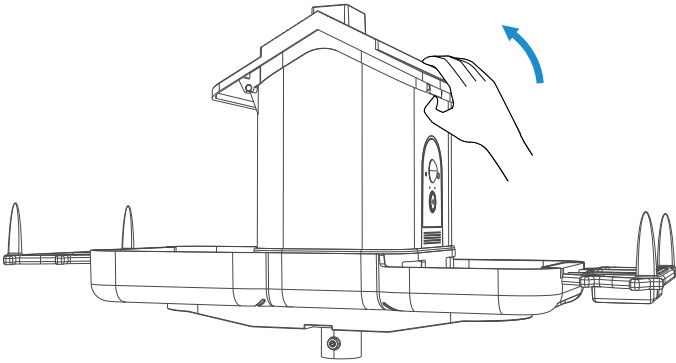

- After adding bird food, rotate the top cover back to its original position, and press down the clasp to secure it.

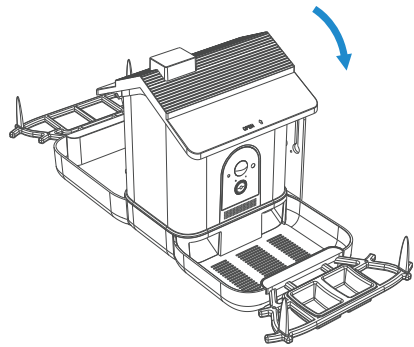
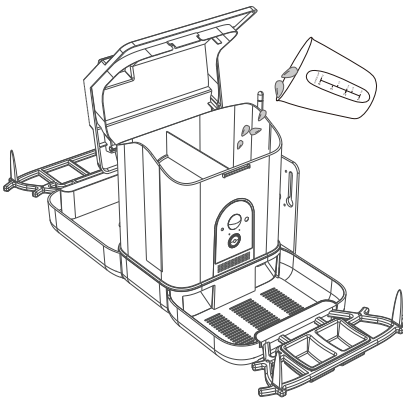

## 2. Add Water

- Tighten the silicone cap in the direction shown in the figure below, then add an appropriate amount of clean water to the bird bath.

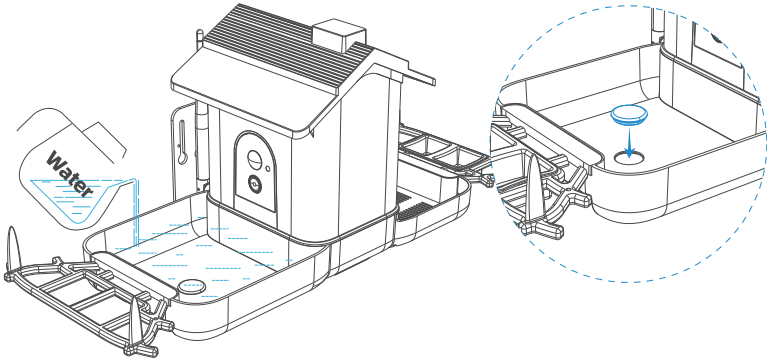

## 2. Change the Water

- Remove the silicone cap in the direction shown in the figure below, and the remaining water in the bird bath will flow out from the water outlet. Then tighten the silicone cap and add an appropriate amount of clean water.

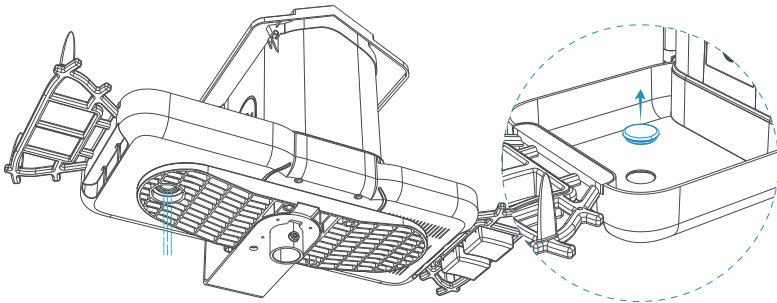



# Clean & Maintenance

## Note:

Bird camera is designed with the safety and comfort of our feathered friends in mind and is incredibly easy to clean. Cleaning your feeder is the most effective and most important step towards preventing the spread of avian diseases. We recommend cleaning the feeder once a week with a brush and a mild disinfectant.

- **Cleaning the smart bird camera lens:** Add a drop or two of lens cleaning fluid or rubbing alcohol to a microfiber cloth or a cleaning wipe, then wipe the lens gently to remove finger prints, oil, smudges, dirt and dust.
- **Cleaning the base:** After removing the bird seed container, wash it directly with water, you can use a soft brush to clean away the extra seeds and dirt.
- **Cleaning the inside of the bird seed container:** Wipe the inside of the seed container with a damp cloth, then dry it with a dry cloth. Please do not rinse the seed container directly with water to avoid damage.
- **Other:** If the feeder cover, bird perch, mounting bracket, solar panel and other parts of the bird seed container get dirty, rinse them gently with water and wipe them with a clean cloth.

## FAQ

- **If alarm notifications for activity are too frequent or missing.**
  - (1) Adjust the sensitivity of the activity detection to suit your needs: Navigate to Device Settings -> Activity Detection and choose the appropriate detection sensitivity (High, Medium, Low) based on your requirements.
  - (2) Check if other objects are incorrectly triggering the PIR sensor, such as outdoor units of air conditioners, leaves, lighting conditions, passing cars, or pedestrians. Adjust the mounting angle of the device to reduce false alarm triggers.
- **How to share your camera?**
  - (1) Click "🔗" from the "Device List" page, click "Share" and select the option to share.
  - (2) Enter the email address of the person you want to invite.

### Note:

Invited users must register a Ubox account with their email before they can start sharing your camera. Invited users should then open the UBox app, go to "Me" -> "My Friends" to accept the sharing invitation.

- **What to do if the image is blurry?**
  - (1) Switch the image mode to "HD": Go to real-time video -> click on "SD" and switch to "HD" resolution located in the upper left corner.
  - (2) Ensure that the lens protective film has been removed.
  - (3) Check for any dirt or stains on the lens.

### Note:

The camera's default resolution is standard definition (SD). If you wish to adjust the settings, go to the "Me" section in the app -> Common settings -> Default resolution.

- **What to do if you can not see any video recordings?**

- (1) Click on the "Cloud/TF" menu in the bottom right corner of the real-time video page to verify if you can view the video recordings.
- (2) Confirm if the cloud storage recording is enabled (Live video -> Device settings -> Memory card -> open "Cloud Video")
- (3) Ensure that the SD card (supporting up to 128GB) has been correctly installed and formatted (FAT32).

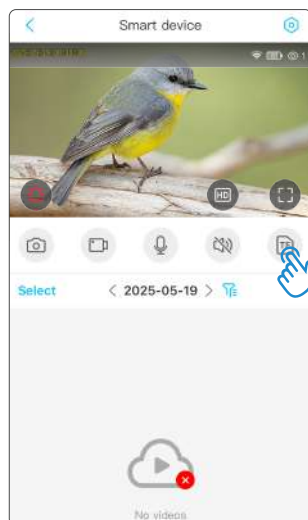

- **The camera battery is draining quickly and cannot be charged?**

- (1) Try unplugging and re-plugging the solar panel power plug to ensure proper charging.
- (2) Use an external power source to charge the camera and monitor if the battery level increases.

If both methods fail to charge the camera or connect it to the network, please contact customer service for assistance.

- **How to reset the camera?**

Press and hold the reset button for 5 seconds to reset the camera. Release the button when you hear a sound. Note that after resetting the camera, you will need to re-add the camera to use it again. Refer to page 10 for the instructions on re-adding the camera.

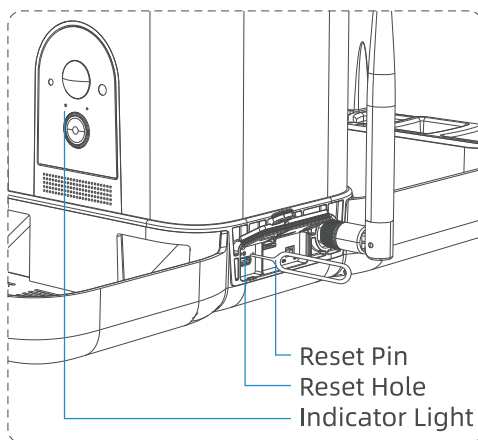

- **What to do if the mobile app cannot display real-time video (disconnected) or if the real-time video is choppy?**
  - (1) Move the camera closer to the router to improve the signal strength. Ensure the signal strength is greater than 1 bar.
  - (2) Check the camera's battery power and functionality. If the camera does not turn on, connect it to a power source to trouble shoot.
  - (3) Verify the router is functioning properly and the Wi-Fi signal is stable. Check for any changes in the router password or settings. If the issue persists, reset the camera to factory settings and reconnect it to the network.
- **How far should the camera be from the router?**

If the router is placed outdoors and there are no obstructions between the router and the camera, the maximum distance it can connect is about 100 meters. However, the actual distance may vary depending on Wi-Fi strength and the surrounding environment (thick walls, electromagnetic devices, large metal objects, etc. may interfere with the Wi-Fi signal). Please ensure that the camera displays a signal strength of at least 2 bars or is located at a distance where the real-time video is smooth. If the camera's connection signal is weak or unstable, move the camera closer to the router until the real-time video is smooth.
- **How to deal with solar panels not charging?**
  - (1) Check if there are any foreign objects covering the surface of the solar panel.
  - (2) Ensure that the solar panel receives direct sunlight and is exposed to sunlight for as long as possible.
  - (3) Check if the solar panel connection lines are properly inserted, and reinsert them if necessary.

- **How do I resolve the issue of the camera not recognizing the SD card?**

- (1) The camera supports SD cards with a capacity of 8-128 GB.
- (2) With the camera powered off insert the SD card into the camera's SD card slot in the correct orientation, and then power on the camera. If the SD card cannot be recognized or a prompt to format the SD card appears, click "Format SD Card". If the SD card still cannot be recognized, use a card reader to "format the SD card" to FAT32 or exFAT format on a computer, then insert it back into the camera.
- (3) If the SD card can not be recognized during use, remove and reinsert the SD card to confirm whether it can be recognized. If it still cannot be recognized, reformat the SD card or replace it with a more stable storage card.

- **The camera can not recognize birds.**

- (1) AI bird recognition requires a subscription, we offer a 30 -day free trial. Choose "Single Purchase", click "AI Bird Fans Plan", click" Free Trial" to get the free AI bird recognition.
- (2) Please adjust the camera angle to ensure that it can capture birds.
- (3) If you find errors in bird recognition, please adjust the camera angle or contact our customer service to improve it.

- **How can I re-connect the camera after changing my router or Wi-Fi password?**

First, delete the previously added camera from the APP, press and hold the reset button for 5 seconds (release the reset button when you hear the sound), and then follow the steps "Pairing the camera with the App" to select a new Wi-Fi SSID or password, and re-connect the camera.

# FCC Compliance Statement

## **FCC WARNING:**

Any changes or modifications not expressly approved by the party responsible for compliance could void the user's authority to operate the equipment. This device complies with part 15 of the FCC Rules.

Operation is subject to the following two conditions:

(1) This device may not cause harmful interference.

(2) This device must accept any interference received, including interference that may cause undesired operation.

Note: This equipment has been tested and found to comply with the limits for a Class B digital device, pursuant to part 15 of the FCC Rules. These limits are designed to provide reasonable protection against harmful interference in a residential installation. This equipment generates uses and can radiate radio frequency energy and, if not installed and used in accordance with the instructions, may cause harmful interference to radio communications.

However, there is no guarantee that interference will not occur in a particular installation. If this equipment does cause harmful interference to radio or television reception, which can be determined by turning the equipment off and on, the user is encouraged to try to correct the interference by one or more of the following measures:

Reorient or relocate the receiving antenna.

Increase the separation between the equipment and the receiver.

Connect the equipment to an outlet on a circuit different from that to which the receiver is connected.

Consult the dealer or an experienced radio/TV technician for help.

## **FCC RADIATION EXPOSURE STATEMENT:**

This equipment complies with FCC radiation exposure limits set forth for an uncontrolled environment.

This equipment should be installed and operated with a minimum distance of 20cm between the radiator & your body. This transmitter must not be co-located or operated in conjunction with any other antenna or transmitter.