

TROLLEY SPEAKER

AVAiH

MODEL: AVAH-S8



If you have any questions, please contact us, we are very willing to help you!

Email address 1: LANREALYAN@163.com

Email address 2: wangsibo1911@gmail.com

Facebook Page: " Lanreal " (<https://www.facebook.com/Lanrealy>)



TROLLEY SPEAKER

To Customers

Welcome to purchase and use our Digital Multimedia Trolley Speaker. To ensure that this speaker could bring you desired effects when using it, please read this instruction carefully.

This product can be connected to sound equipment such as PC, TV, CD, VCD, DVD, TUNER, TAPE, USB, SD card, etc. With outstanding sound quality, this trolley speaker is portable, multifunctional and perfectly-designed. We are confident that it will give you a completely new feeling.

Safety Instructions

To ensure safe use, please read this instruction carefully before using this product and use it in a right way according to the instruction. Please keep this instruction properly for future reference.

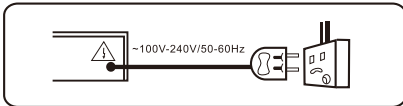

Power: The product can only work with power supply which is indicated in this instruction or specified in the product.



No Heavy Objects & Overheating: Do not place heavy objects on the product. It should avoid sun burning and keep away from hot source e.g. oven. No raining or immersion or put it in high temperature or moist conditions.

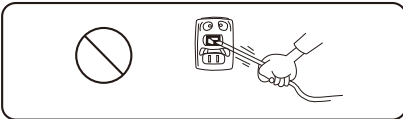

Power Line Protection: Power line should not be stepped, squeezed or dragged.

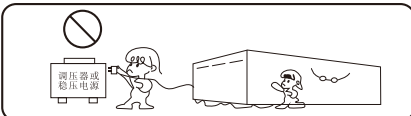

Don't use low power voltage regulating and regulated power supply, to avoid burning down the product or the regulated power supply.



This product is only suitable for use in places below 2000 meters above sea level. It may cause danger risk when it is used over 2000 meters above sea level.



Mind Electricity Shock: Don't plug or unplug the power supply with wet hands to prevent the electricity shock.

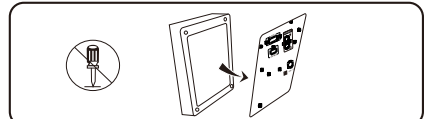

Rear Plate Dis-assembly: Please do not disassemble the rear plate. If repair is needed, please ask the professional to operate.

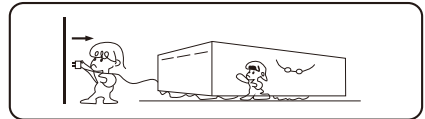

Non-use Period: If you do not use this product for a long time, please turn off the power and unplug the power supply.

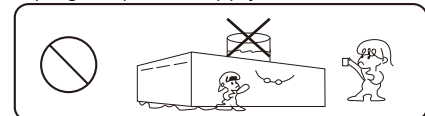

The Speaker Top: Don't place objects like vase or container filled with liquid. Please maintain air ventilation to dissipate heat.



This product is only suitable for use under non-tropical climate conditions. It may cause danger risk when it is used under tropical climate conditions.

Parameter&Data

1. Portable speaker system
High power PA speaker style
wireless connection system
Color Auto Flashing LED Party Light
Built-in 18650 rechargeable lithium battery
With digital display, with FM function
Input audio from external equipment, Aux (3.5mm) input connector jack
USB, TF card read function (MP3 only)
1/4 inch / 6.35mm microphone input
Battery indicator (red when charging, off when fully charged)
Rugged molded cabinet design
Suitable for street performances, karaoke, classroom teaching, family gatherings, etc.
2. wireless connection system
Simple and easy pairing
Works on all the latest devices today
Smartphone, tablet, laptop, computer, etc.
Wireless microphone range: up to 10 meters
wireless connection range: up to 8 meters
3. Technical specifications:
Frequency response: 55-20KHz
Signal to noise ratio: 76dB +/- 3dB
SPL : 94dB (1W / M)
T.H.D. : <2%
USB interface type: 2.0
Digital audio file support: MP3
Remote control battery: 3V button battery

The role of numeric keys

Instrument Jack Connection

Please turn "ECHO" to "- min", then insert guitar etc output to "MIC-IN" socket. (Instrument jack for Guitar/Drum Kit/Elect keyboard etc.)

MIC.IN is used as an instrument input interface

Instrument Jack Connection

Please turn "ECHO" to "- min", then insert guitar etc output to "MIC-IN" socket. (Instrument jack for Guitar/Drum Kit/Elect keyboard etc.)

Bluetooth connection instructions:

Press the MODE button on the panel to switch to Bluetooth mode, the display shows BLUE, the word BLUE is flashing, use the mobile phone to turn on the Bluetooth function to search for the Bluetooth audio device, check the Bluetooth audio device, click the Bluetooth audio device name on the phone Connect the Bluetooth speaker. After the connection is successful, the speaker will have a (dingdong) beep,

PROMPT

Since the product is updated relatively quickly, the manual parameters and operating instructions may be different from the actual product, and the final interpretation right belongs to the product company.

TROLLEY SPEAKER

Instructions for Function & Operation

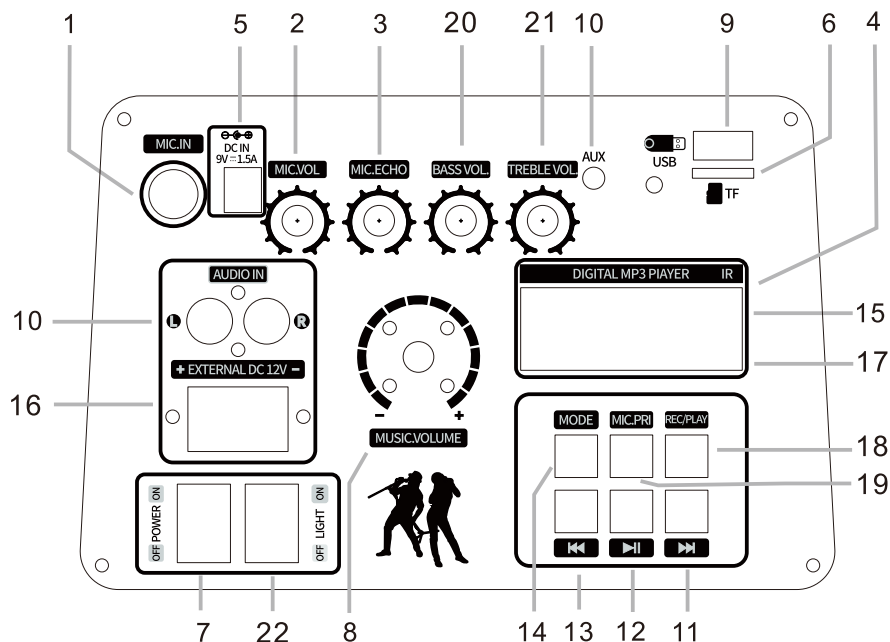

1. Wired microphone input interface
2. Wired / wireless microphone volume adjustment
3. Wired / wireless microphone reverberation adjustment
4. Digital display window
5. Charge input interace
6. TF card inPut socket
7. Power control switch
8. Master volume adjustment
9. USB input jack
10. External audio input interface
11. Next song (the next station in FM status)
12. Play / Pause (Automatically search for radio stations in FM status)
13. Previous song (last station in FM status)
14. Mode switch button: AUX-USB-Wireless connection-FM, 4 modes in 1 button
15. Remote control signal reception
16. External DC input interface
17. Charging status indicator
18. Recording function button: (must insert USB or TF card)
REC function: 1. Insert USB/TF card, press "REC" button about 2 seconds, when "REC" appears in display screen, the function started. Only can record the sound of wired or wireless microphone, music can't be recorded. 2. Press "REC" button again to stop recording and start playing the recording.
19. Microphone priority function switch, (when this function is turned on, music is playing, the microphone has sound input, the volume of the music is automatically reduced, and when there is no sound input from the microphone, the music changes back to the original volume level)
20. Music bass adjustment.
21. Music treble adjustment
22. LED light switch
23. USB playback status, next song (the next radio in FM status)
24. Master volume increased
25. Recording function keys
26. Repeat play button under USB and TF card state, single cycle, all cycle, cancel cycle
27. Mute button: mute / restore sound
28. Digital song selection key in USB state, you can select channels in FM state (please complete the automatic station search operation first) *
29. AUX-USB- wireless connection-FM mode switch button
30. Remote control switch
31. USB playback status: play / pause (FM status: auto search station / stop station search)
32. USB playback status: previous song (FM status: previous radio station)
33. USB,wireless connection playback status:equalizer sound switching
34. Master volume decreases
35. VHF wireless microphone

Problems & self –check list

Problems	Solutions
No sound from Speaker	A. If using internal battery, check whether it is on DC track; B. If using AC, check whether the power plug is plugged in and it is in the boot state; C. Check whether the minimum sound is adjusted; D. Check whether the pattern corresponds to the source channel
Noisy when playing	A. Check auxiliary AUX input, unplug the input cable or replace the memory. B. Check if the power supply of the wireless microphone or headset is off.
Remote control is invalid or distance is short	A. Check if the remote control installs the battery and check that the battery is sufficient. B. Check whether it is aimed at the receiver window or whether it exceeds the effective reception distance.
No sound from microphone	A. Check if the microphone installs the battery correctly and check that the battery is sufficient; B. Check if the microphone is on and its volume, or whether it exceeds the effective reception distance; C. Check whether the microphone frequency is the same as the machine receiving frequency.
Microphone whistling/ noise/distortion	A. Check if the battery is sufficient; B. Adjust the microphone volume or reverb properly; C. Adjust the distance between the microphone and the speaker, prohibit the microphone directly towards the speaker
Invalid external battery	A. Check if place the batteries correctly and the screws are tighten; B. Check if DC mode is on; C. Check if the battery is sufficient and the cables are connected.
U disk/SD card can't be read	A. Check whether U disk/TF card is plugged correctly; B. Check whether there are video files in the U disk/TF card
Playback is choppy and sound distortion	A. Check if the battery is sufficient; B. Check if MIC PRIORITY is on, if yes, please turn off
Can't record or recording sound is small	A. Check if the memory is inserted and see if the capacity of the storage is full; B. Check that the speaker or microphone volume is on when recording and adjust the appropriate volume.

FCC Warning Statement

Changes or modifications not expressly approved by the party responsible for compliance could void the user's authority to operate the equipment. This equipment has been tested and found to comply with the limits for a Class B digital device, pursuant to Part 15 of the FCC Rules. These limits are designed to provide reasonable protection against harmful interference in a residential installation. This equipment generates uses and can radiate radio frequency energy and, if not installed and used in accordance with the instructions, may cause harmful interference to radio communications. However, there is no guarantee that interference will not occur in a particular installation. If this equipment does cause harmful interference to radio or television reception, which can be determined by turning the equipment off and on, the user is encouraged to try to correct the interference by one or more of the following measures:

- - Reorient or relocate the receiving antenna.
- - Increase the separation between the equipment and receiver.
- - Connect the equipment into an outlet on a circuit different from that to which the receiver is connected.
- - Consult the dealer or an experienced radio/TV technician for help.

This device complies with part 15 of the FCC Rules. Operation is subject to the following two conditions: (1) This device may not cause harmful interference, and (2) this device must accept any interference received, including interference that may cause undesired operation.

The device has been evaluated to meet general RF exposure requirement.