



Datasheet



All Software & files can be downloaded from
<https://www.milesight.com/resources/download-center>

Make Sensing Matter

Milesight | www.milesight.com



QUICK START GUIDE

4G Solar-powered Camera Kit (SP111)



Designed for Off-grid
& Remote Security

Table of Content

1. Package Contents.....	2
2. Hardware Overview.....	5
3. Dimensions.....	7
4. Installation.....	8
5. Assigning an IP Address by Using Smart Tools.....	18
6. Assigning an IP Address via Browser.....	19
7. Accessing from the Web Browser.....	19
8. FCC Statement.....	20

1. Package Contents



4G Solar-powered
Camera x 1

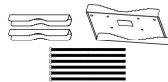

Pole Mount Bracket

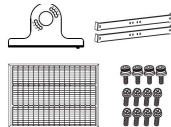

Solar Panel



Screw Packet x 3

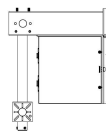

Main housing x 1



Battery x 4



Screw Packet x 16



Spring Plate x 10



Washer x 10



Hexagonal Nuts x 14



Expansion Bolts x 6



Safety Latch x 1



Kit Safety Latch



Screwdriver x 1



Dust Cover x 2



12V 3.3A Adapter



Warranty Card x 1



Quick Start Guide x 1



Solar Panel Connection
Cables x 1



Power Cable x 1



DC 12V Output
Cable x 1

Optional



Battery



Waterproof Power
Supply Adapter



SA02 Bracket

Solar Expansion Kit



Washer x 12



Hexagonal Nuts x 8



Spring Plate x 8

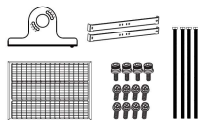

Solar Panel

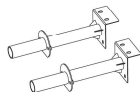

Mounting Brackets x 2

2. Hardware Overview

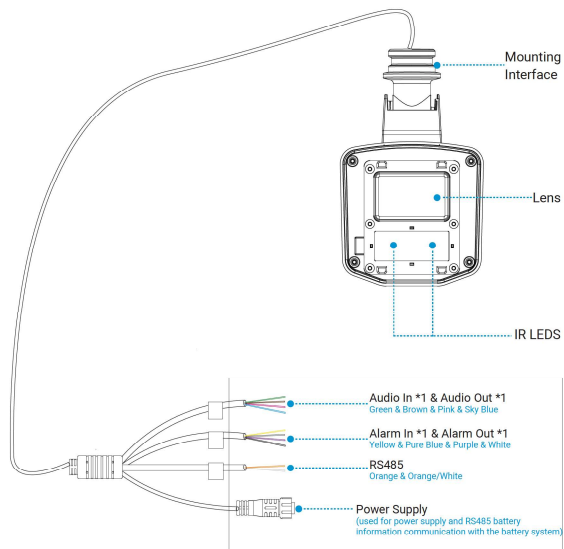

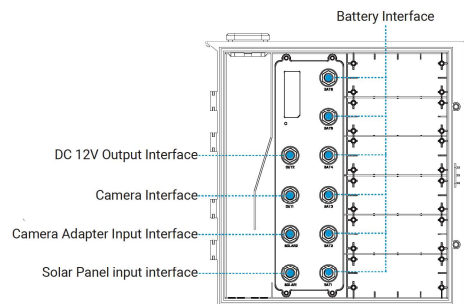
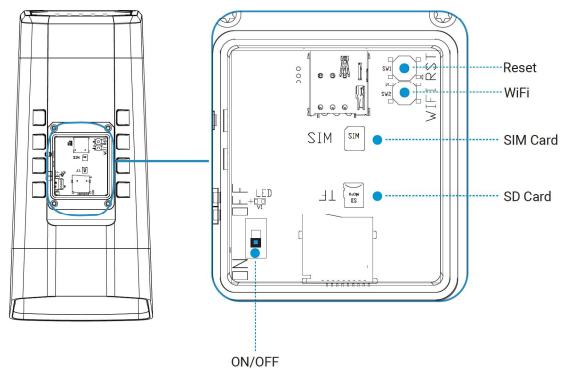

3. Dimensions

KIT

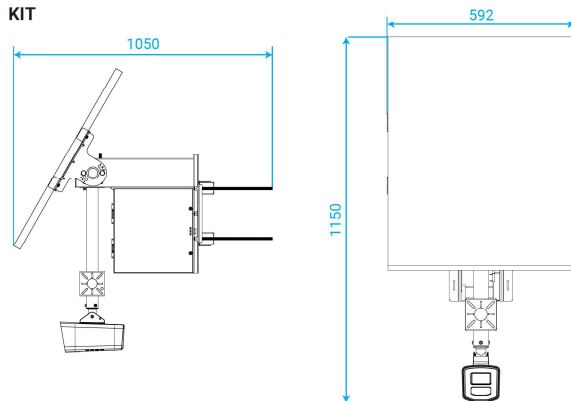

CAMERA

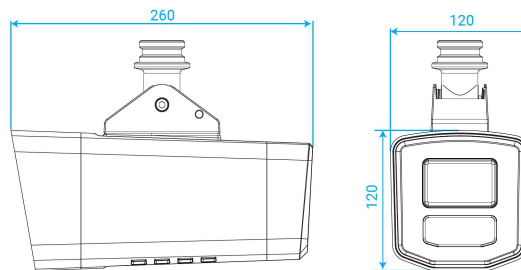

SA02

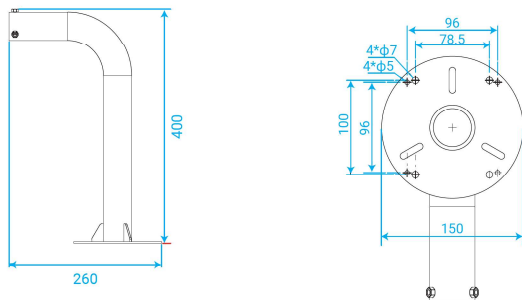

4. Installation:

Step1: Use a screwdriver to open the back cover at the bottom of the camera. Insert the SD card and SIM card.

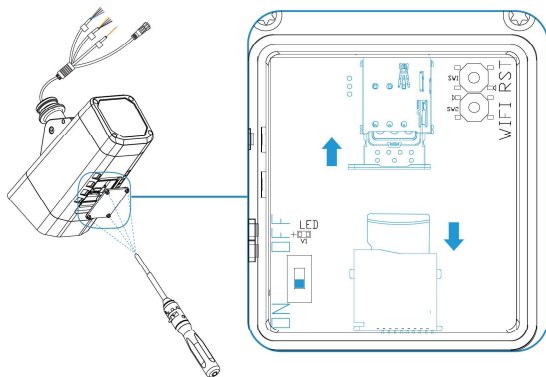

Step2: Assemble the solar panel.

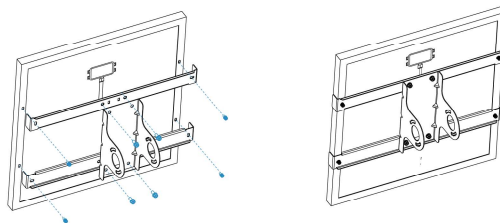

Step3: Use a screwdriver to remove the screws from the battery box and open it. Unscrew the protective cover of the battery connector, connect the battery to the power system, tighten the connector, and finally secure the battery with screws.

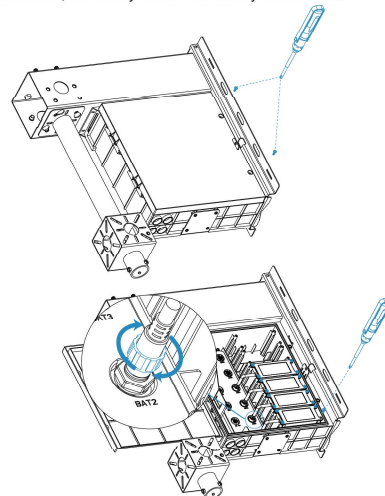

Step4: Take out the previously assembled solar panel. Run the solar cables through the bracket and connect them to the battery system.

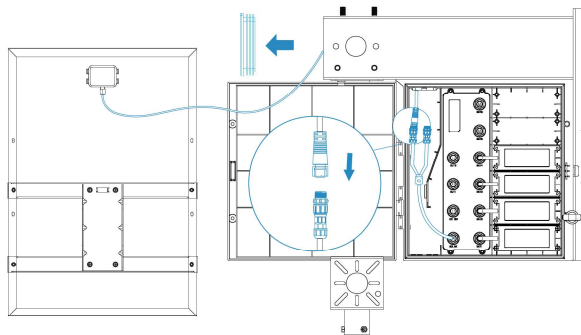

Step5: Attach the solar panel to the bracket. Tighten the screws to secure the solar panel at the desired angle.

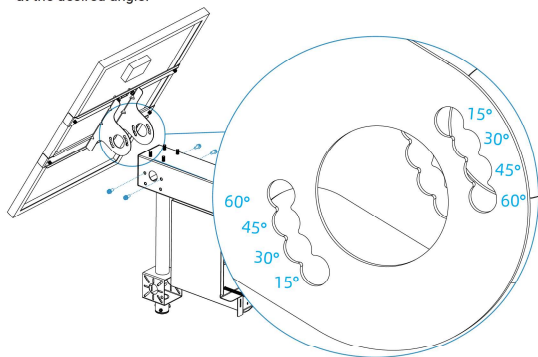

Note: Adjust the panel to the desired angle and secure it by tightening the screws in the corresponding holes on the bracket.

Step6: Install the pole-mount bracket.

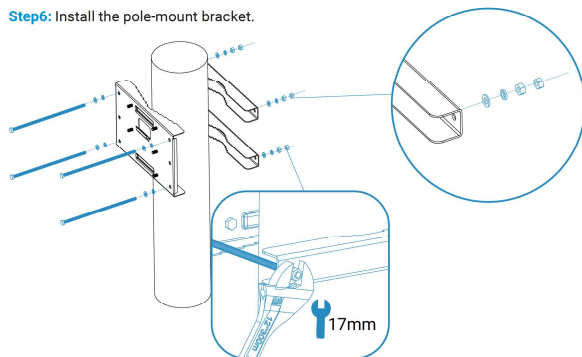

Step7: Use a safety latch to connect the fully assembled bracket to the pole.

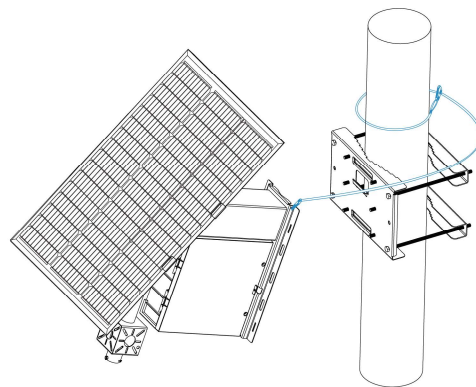

Step8: Hook the bracket onto the mounting hook on the pole.

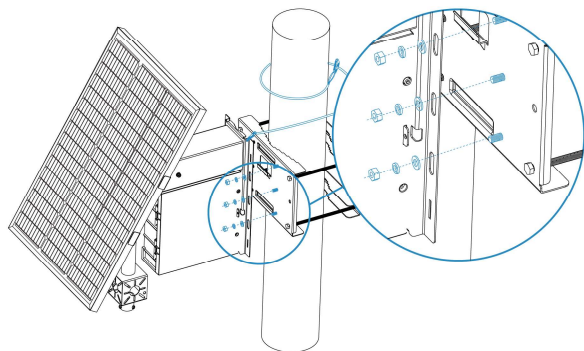

Step9: Secure the bracket using hex nuts.

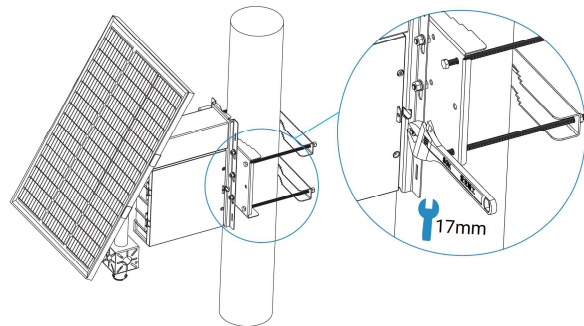

Step10: Use a safety latch to securely attach the camera to the bracket interface. Opening the front cover of the bracket allows for easier threading of the camera's tail cable through the interface to the battery system.

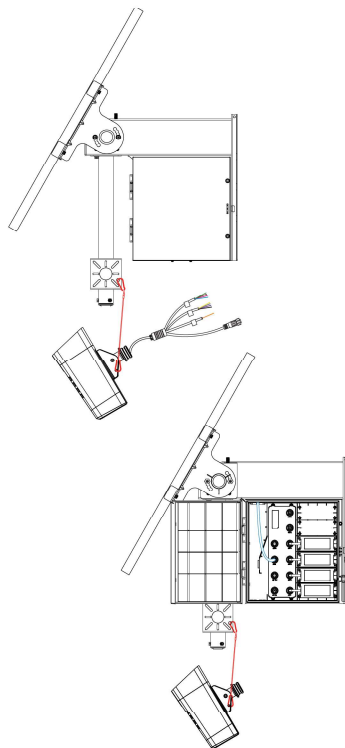

Step11: The camera can be freely rotated to adjust the angle. Once the desired angle is set, tighten the screws between the camera and the bracket.

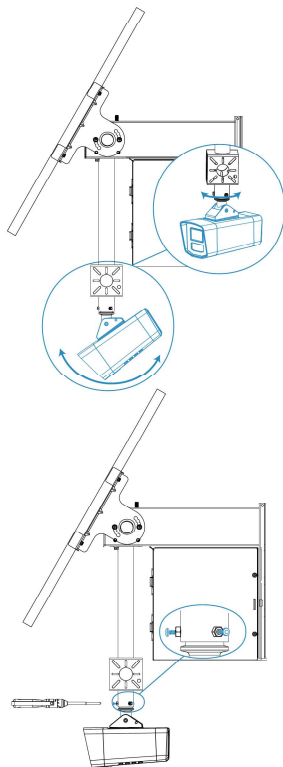

Note: You can also use expansion screws to mount the entire assembled bracket directly onto the wall.

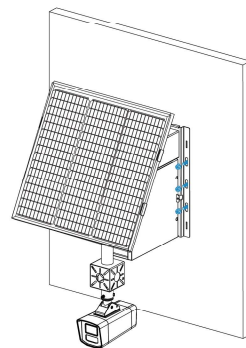

Solar Expansion Kit Installation

Step1: If you have purchased the Solar Expansion Kit, attach the additional bracket to the main bracket and secure it with screws.

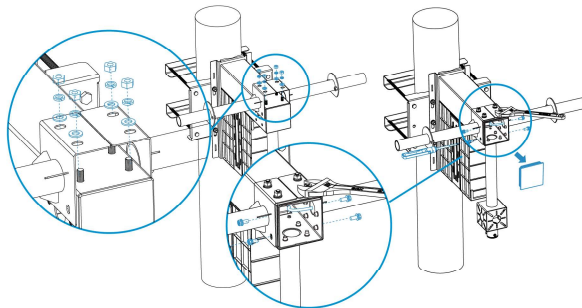

Step2: Secure the assembled solar panel to the additional bracket.

