

NOTE: If the wifi connection problem or your router problem, only the blue indicator light will blink slowly.

► Operation

Turn ON/Off

Method: Press the icon to enter the app, tap the power button to turn it ON/OFF.



Night Light Adjusting

Method: Enter the night light screen to adjust the light.

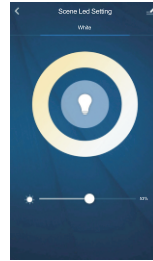

► Device sharing with Family members

Once the Smart plug paired to a cell phone, you can share this device with family members as soon as they have a Smart life account on the smart phones. No need to pair again. You can set up at "Profile"- "Device Sharing".

NOTE: A Smart plug can be paired to one cell phone Only.

You can delete this Smart plug on the App or by Pressing and holding the Power Button for 5 seconds, it will be removed from App automatically.

Support voice control via Amazon Alexa and Google assistant.

► Troubleshooting

1.What devices can I control with the Smart Plug outlet?

You can control lights, fans, humidifiers, Coffee maker, portable heaters, and any small appliances in accordance with the Smart Plug's specifications.

2.What should I do when I can't turn devices ON/OFF?

- Make sure the devices connected to the Smart Plug are turned on.
- Make sure your mobile device and the Smart Plug are connected to the same network.
- Check to make sure the Smart Plug isn't placed too far from your wireless router. It must be within a 164 ft (50m) visible range from the router.

3.What should I do when the indicator blue light blink slowly?

A solid blue indicates no network connection, or that the App-Config process has failed. You can:

- Check your network connectivity.
- Check for Wi-Fi interference or relocate the Smart Plug to another location within the signal range.
- Repeat the App-Config process.

4.Why will the app not allow me to add a device?

- Re-configure the Smart plug;
- If the Smart Plug was set up by other user, you can have them to share the Plug with you. Then you can control them on another phones.(You can go the "Profile" of the home screen- "Device Sharing" for setup.)
- Take the Smart plug out from the power supply for seconds, and put it back to re-configure it.

► Warranty

We are dedicated to make the best quality products. We offer 24 months quality warranty from the date of your original purchase. If any problem occurs, you can contact us. We will repair or replace for you.

SMART PLUG WITH NIGHT LIGHT

User Guide

Thank you for purchasing the Smart Wi-Fi Plug with Night Light. Below are few steps to help you get started.

► Product Diagram:

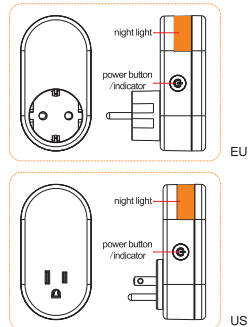

► Specifications

Item	Specification
Input	AC 100V~240V
Output	AC 100V~240V, 16A 50~60Hz
Max Load	16A
Max Power	2000 W~3500W
Material	PC
Operating Humidity	5%~90%RH, Non-condensing
Operating Temperature	-15℃~50℃ (32°F~104°F)
Wi-Fi Operation Frequency	2.412Ghz~2.484Ghz

► Setup

① Download and install "Smart Life" or "Tuya" APP from App Store or Google Play

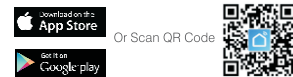

② "Register" to create an account using your phone number. Input the verification code sent by SMS and set your password here. There are other 3 ways to register, such as Email, QQ and Wechat for option.

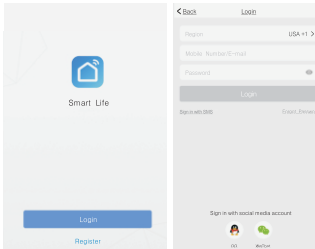

► Configuration

1. Open Smart Life app
2. Tap "Add Device" or the "+" button on the top right corner of the home screen.

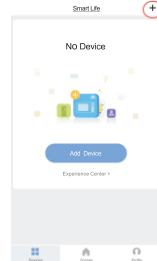

3. Select "Electrician" → "socket(Wi-Fi)" to get into next step.

4. Smart Mode connection: Plug the Smart Plug into wall socket, then blue indicator & night light will blink rapidly. That means this smart plug is ready to connect to WIFI via smart mode.

NOTE: (1. If you face problem via smart mode connection. You may try the "other mode" → "AP Mode": hold the power button for 5 seconds, the blue indicator & night light will blink slowly, then operate step by step as per the app instruction. 2. You may hold the power button for 5 seconds to shift between smart mode and AP Mode.)

5. Tap "Confirm indicator rapidly blink"

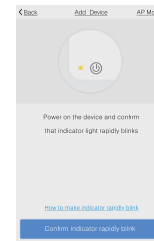

6. Input your Wi-Fi network ID and password here, tap "Confirm". Connect your mobile phone and Smart Plug to your 2.4GHz Wi-Fi network.

NOTE: The Smart Plug only supports 2.4GHz networks.

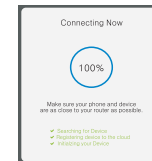

NOTE: During the setup, make sure your mobile phone and Smart Plug are in same Wi-Fi network.

7. It will take seconds to connect the Smart plug to your phone, once completed, the icon will appear on the app home screen.

Warranty Card

Customer Name: _____
Phone Number: _____
Product Name: _____
Date of Purchase: _____
Address: _____
Notes: _____

成品尺寸	45*80mm
材质	105g铜版纸
颜色	白
加工工艺	风琴四折页，正反印刷
印刷色	四色彩色印刷

231*166mm (出血3mm)

Warning:

This device complies with Part 15 of the FCC Rules. Operation is subject to the following two conditions: (1) this device may not cause harmful interference, and (2) this device must accept any interference received, including interference that may cause undesired operation.

changes or modifications not expressly approved by the party responsible for compliance could void the user's authority to operate the equipment.

NOTE: This equipment has been tested and found to comply with the limits for a Class B digital device, pursuant to Part 15 of the FCC Rules. These limits are designed to provide reasonable protection against harmful interference in a residential installation. This equipment generates, uses and can radiate radio frequency energy and, if not installed and used in accordance with the instructions, may cause harmful interference to radio communications. However, there is no guarantee that interference will not occur in a particular installation. If this equipment does cause harmful interference to radio or television reception, which can be determined by turning the equipment off and on, the user is encouraged to try to correct the interference by one or more of the following measures:

- Reorient or relocate the receiving antenna.
- Increase the separation between the equipment and receiver.
- Connect the equipment into an outlet on a circuit different from that to which the receiver is connected.
- Consult the dealer or an experienced radio/TV technician for help.

NOTE: This device and its antenna(s) must not be co-located or operation in conjunction with any other antenna or transmitter

RF Exposure Statement

To maintain compliance with FCC's RF Exposure guidelines, This equipment should be installed and operated with minimum distance of 20cm the radiator your body. This device and its antenna(s) must not be co-located or operation in conjunction with any other antenna or transmitter