

MINI智能挂锁 使用说明书

型号:PL-M1L



感谢您购买本产品，为了您使用方便，请仔细阅读读本说明书后正确使用，并妥善保管。

产品图解

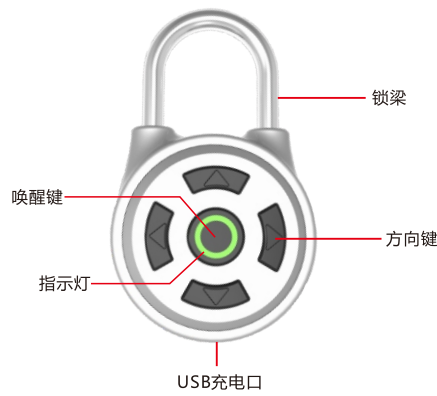

APP下载

● 软件下载

- 1.用户扫描下方二维码根据系统下载APP并进行安装。
- 2.设备最低版本要求安卓4.0；IOS7.0；蓝牙4.0。



初始密码和恢复出厂设置

● 初始按键密码

- 1.按下设备上的唤醒键。
- 2.长按顺序输入按键初始密码解锁。



● 恢复出厂设置

- 1.开启挂锁,拉出锁梁,使得挂锁在开锁状态下。
- 2.长按唤醒键直到指示灯熄灭,恢复成功,密码变更为初始密码。
- 3.如果APP已经绑定此设备，在恢复出厂设置后APP需要重新绑定设备才能使用。
- 注意事项
- 1.在输入正确密码解锁后，如果没有拔出锁梁，设备会在5秒后自动上锁。
- 2.键盘密码如果5次输入错误后，设备会有3分钟的锁定时间，在3分钟之内不能再次输入密码。
- 3.用户在使用设备时，请在第一时间更改初始密码，设置新密码。

键盘解锁与指示灯

● 键盘解锁

- 1.按下设备上的唤醒键。
- 2.按顺序输入初始密码或已修改的键盘密码即可解锁。
(输入完成后指示灯显示绿色为解锁成功,指示灯显示红色密码错误解锁失败)

● 指示灯状态



APP主界面

● APP界面



“记录查询”界面

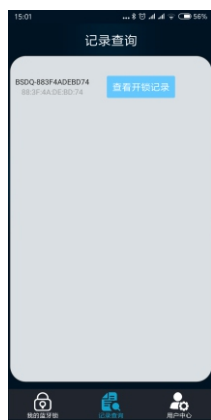

“用户中心”界面



● 主界面介绍

- 1.首次打开APP后首先进入“登入”界面设置手势密码。
- 2.设置完手势密码，进入操作页面共有三个界面：分别是“我的蓝牙锁”、“记录查询”、“用户中心”。
- 3.“用户中心”界面可以关闭手势密码，其中“安全问题”是“登入界面”忘记手势密码时提供使用的一种提示方式。

APP绑定设备

● 初次绑定蓝牙锁

- 1.打开APP,进入“我的蓝牙锁”界面。
- 2.按下蓝牙挂锁上的唤醒键。
- 3.点击“添加蓝牙锁”栏，点击“刷新”搜索到设备后点击“添加”完成蓝牙锁设备添加。

“添加蓝牙锁”

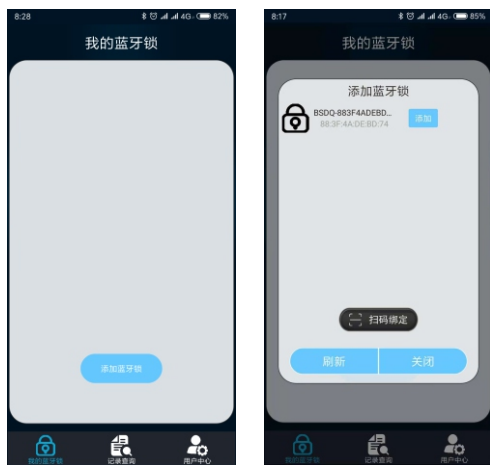

设备管理与解锁方式

● APP连接设备解锁

- 1.添加完成后，设备显示在“我的蓝牙锁”界面中。
- 2.按下蓝牙挂锁上的唤醒键。
- 3.点击 ，连接上蓝牙挂锁后，再点击“开锁”完成解锁。
如果是ios系统需要在“开锁”时输入初始密码。

“未连接”状态

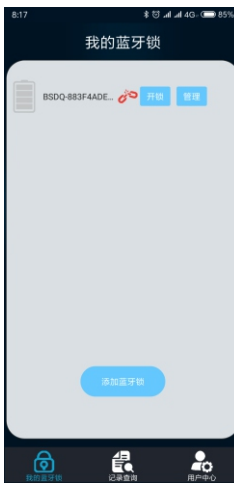

“已连接”状态

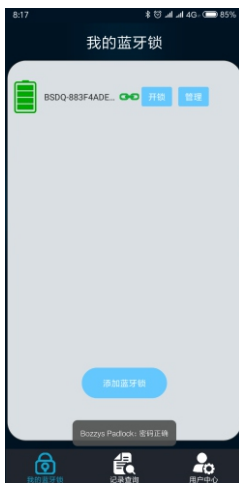

● APP连接设备的初始密码

APP开锁初始密码：“123412”

注意：绑定后点击“管理”修改初始密码
(初始密码务必修改,防止陌生人绑定挂锁)。

● 点击“管理”进入“设备管理”设置界面

- 1.界面中可以设置设备的名称、密码、开锁方式、分享和删除。



● APP自动解锁

- 1.按下设备上的唤醒键。
- 2.点击 ，连接上蓝牙挂锁。
- 3.点击“管理”，点击“自动开锁设置”开启,完成自动开锁设置。
- 4.再次开锁时在蓝牙范围内,按下蓝牙挂锁唤醒键即可解锁。
(必须在手机蓝牙开启和APP后台运行的条件下)



密码修改

● 修改密码

- 1.手机APP连接设备。
- 2.点击“管理”进入设备管理点击“修改密码”进行修改
(该密码为蓝牙挂锁绑定密码)。



● 修改按键密码

- 1.手机APP连接设备。
- 2.点击“管理”进入设备管理点击“修改按键密码”进行修改。
(只能用绑定的手机修改)

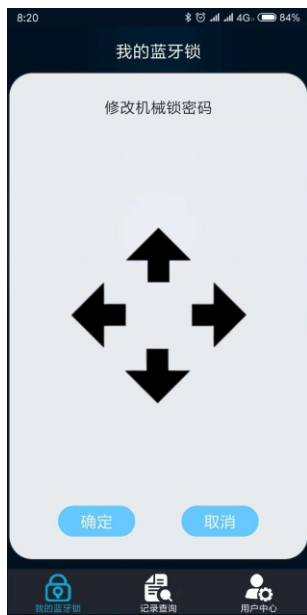

APP密钥分享

● 分享密钥

- 1.手机APP连接设备。
- 2.点击“管理”进入设备管理点击“分享密钥”进入后显示二维码；用手机通过APP添加“扫码绑定”将设备的密钥分享给对方。
(该密码为蓝牙开锁密钥)。



规格参数

项目	规格
产品名称	MINI智能挂锁
产品型号	PL-M1L
锁体尺寸	38mm*36mm*20mm
锁梁尺寸	直径Φ4mm,高度20mm宽度26mm
锁体材质	锌合金
无线距离	1米
支持系统	安卓4.0 IOS7.0 以上
电池	锂电池
电池容量	60mAh

产品特点

- 1.锁体小巧
- 2.按键密码解锁
- 3.蓝牙连接APP解锁和设置

MINI智能挂锁

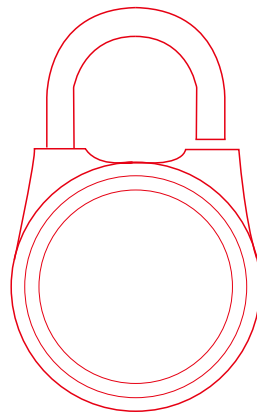

型号:PL-M1L

MINI Smart Padlock
Using instructions

Type:PL-M1L



Thank you for the purchase of this product. For your convenience, please read this instruction carefully and keep it properly.

PRODUCT GRAPHIC

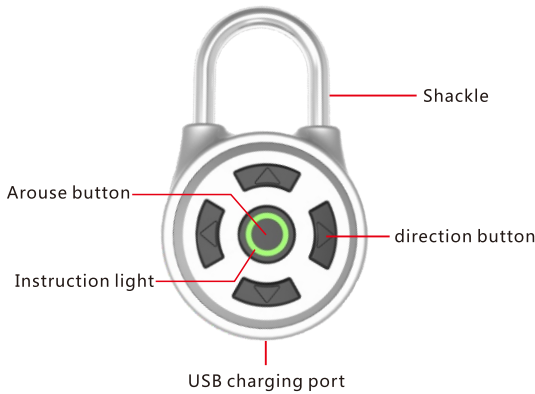

APP DOWNLOAD

Software Download

- 1.users scan the two-dimension code below according to system to download APP to install.
- 2.The lowest version requires: Android 4.0, IOS7.0, Bluetooth 4.0.

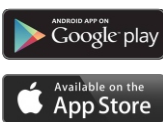

INITIAL PASSWORD AND RESET

Initial keyboard settings

- 1.Press the wake button on your device.
- 2.Enter the keyboard initial password in order to unlock.



Restore factory settings

1. Open the padlock and pull out the lock beam so that the padlock is unlocked.
2. Press and hold the awake button until the indicator light goes out, the recovery is successful, and the password is changed to the initial password.
3. If the APP is already bound to this device, the APP needs to re-bind the device to use it after restoring the factory settings.

Precautions

1. After unlocking the correct password, if the lock beam is not removed, the device will automatically lock after 5 seconds.
2. If the keyboard password is entered incorrectly 5 times, the device will have a lock time of 3 minutes, and the password cannot be entered again within 3 minutes.
3. When the user is using the device, please change the initial password and set the new password at the first time.,

KEYBOARD UNLOCK AND INDICATOR

Keyboard unlock

1. Press the wake button on your device.
2. Enter the initial password or the modified keyboard password in order to unlock it.
(After completing the input, the indicator light shows green that means unlock successfully, the indicator light shows red that means password is wrong)

Indicator light status



APP MAIN INTERFACE

APP interface

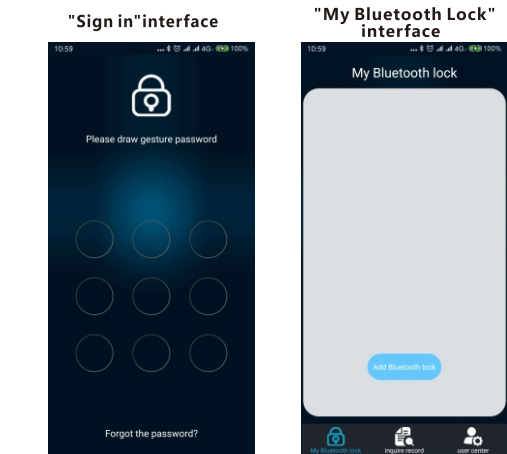

"Record query" interface

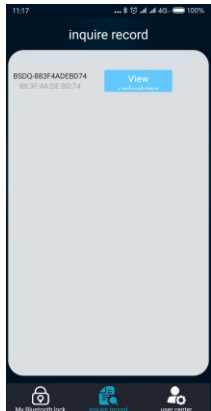

"User Center" interface

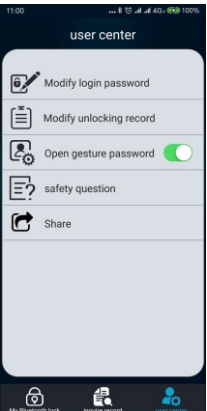

Main interface introduction

1. After opening the app for the first time, first enter the "Login" interface to set the gesture password.,
2. After setting the gesture password, there are three interfaces on the operation page; They are "My Bluetooth Lock", "Record Query", "User Center".
3. The User Center interface can turn off gesture passwords, where "security issues" It is a way to provide a way to use the "login interface" when forgetting the gesture password.

APP BINDING DEVICE

Initially bind the Bluetooth padlock

1. Open the app and go to the "My Bluetooth Lock" interface.
2. Press the wake button on the Bluetooth padlock.
3. Click the "Add Bluetooth Lock" field, click "Refresh" to search for the device and click "Add" to complete the Bluetooth lock device addition.,

"Add Bluetooth Lock"

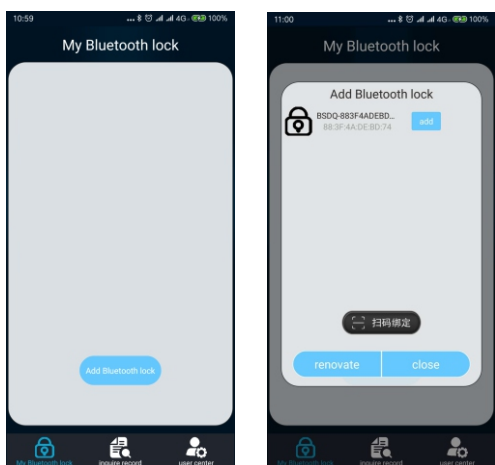

DEVICE MANAGEMENT AND UNLOCKING METHOD

APP connected device unlocked

1. When the addition is complete, the device appears in the My Bluetooth Locks screen.
2. Press the wake button on the Bluetooth padlock.
3. Click , connect the Bluetooth padlock (), and then click "Unlock" to complete the unlock (). If the ios system needs to enter the initial password when "unlocking".

"not connected" status

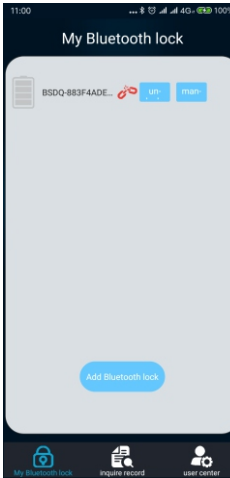

"Connected" status

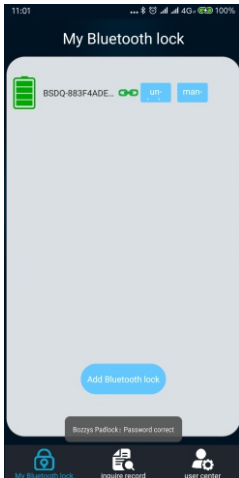

The initial password of the APP connected device

Digital initial password : "123412"

Note: After binding, click "Manage" to modify the initial password. (The initial password must be modified to prevent strangers from binding padlocks)

Click "Manage" to enter the "Device Management" settings interface

1. The device name, password, unlock mode, share and delete can be set in the interface.

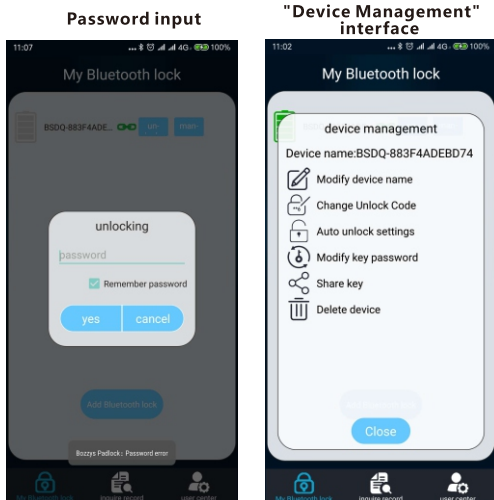

APP automatically unlock

1. Press the wake button on your device.
2. Click () and connect the Bluetooth padlock ().
3. Click "Management", then click "Automatic unlock settings" to open, complete automatic unlock settings.
4. It will be in the Bluetooth range when unlock again, press the wake-up button of the Bluetooth padlock to unlock it. (Must be on the conditions that the mobile Bluetooth is open and APP is running in the background)

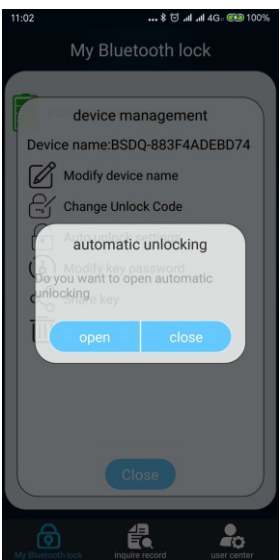

PASSWORD MODIFICATION

change Password

1. Mobile APP connects to the device.
2. Click "Manage" to enter the device management and click "Change Password" to modify (This password is the Bluetooth padlock binding password)

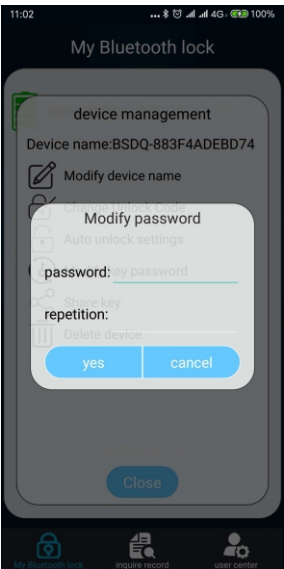

Modify the key password

1. Mobile APP connects to the device.
2. Click "Manage" to enter the device management point "Modify button password" to modify. (Can only be modified with the bound phone)

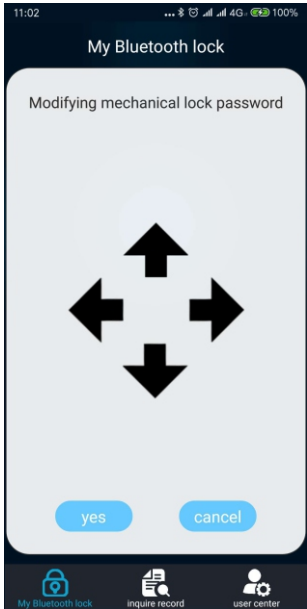

APP KEY SHARING

Sharing key

1. Mobile APP connects to the device.
2. Click "Manage" to enter the device management. Click "Share Key" to enter the QR code. Use the phone to add "Scan Code Binding" to share the device key to the other party. (The password is a Bluetooth unlock key).

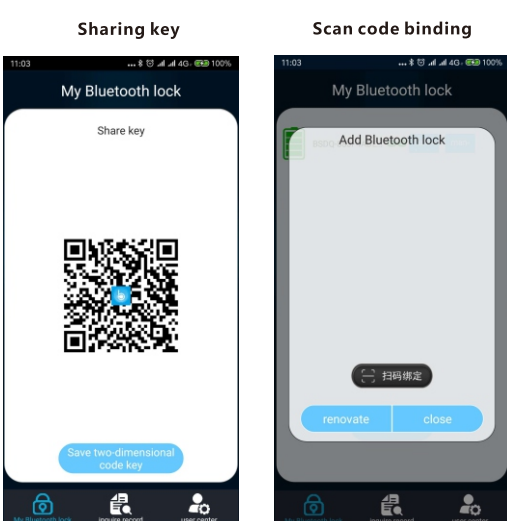

SPECIFICATION PARAMETER

PROJECT	SPECIFICATIONS
Product name	MINI Smart Padlock
type	PL-M1L
Lock size	38mm*36mm*20mm
Lock beam size	diameterΦ4mm, 20mm*26mm
Lock material	kirsite
Wireless distance	1 meter
support system	Android 4.0, IOS7.0 advanced
battery	lithium battery
Battery life	60mAh

Product features

- 1.Small lock body.
- 2.Key password unlocking.
- 3.Bluetooth connection app unlocking and setting.

MINI Smart Padlock

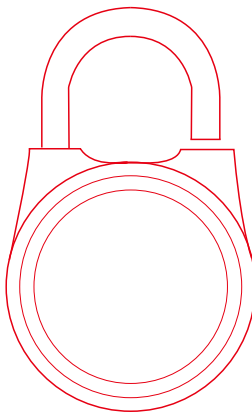

Type:PL-M1L

This device complies with part 15 of the FCC Rules. Operation is subject to the following two conditions: (1) this device may not cause harmful interference, and (2) this device must accept any interference received, including interference that may cause undesired operation.

Any changes or modifications not expressly approved by the party responsible for compliance could void the user's authority to operate the equipment.

NOTE: This equipment has been tested and found to comply with the limits for a Class B digital device, pursuant to Part 15 of the FCC Rules. These limits are designed to provide reasonable protection against harmful interference in a residential installation. This equipment generates, uses and can radiate radio frequency energy and, if not installed and used in accordance with the instructions, may cause harmful interference to radio communications. However, there is no guarantee that interference will not occur in a particular installation.

If this equipment does cause harmful interference to radio or television reception, which can be determined by turning the equipment off and on, the user is encouraged to try to correct the interference by one or more of the following measures:

- Reorient or relocate the receiving antenna.
- Increase the separation between the equipment and receiver.
- Connect the equipment into an outlet on a circuit different from that to which the receiver is connected.
- Consult the dealer or an experienced radio/TV technician for help.

The device has been evaluated to meet general RF exposure requirement. The device can be used in portable exposure condition without restriction