

# LTECH

## LED Controller

Model: CG-LINK



Manual

[www.ltech-led.com](http://www.ltech-led.com)

# System Diagram

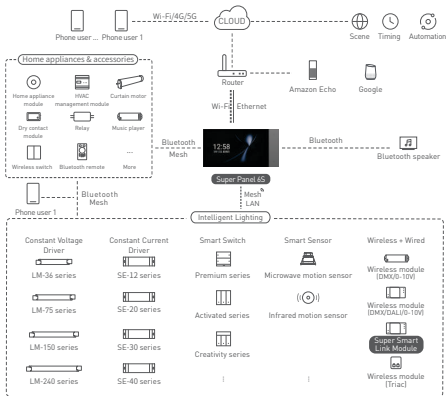

## Product Features

- Small size and light weight. The housing is made from SAMSUNG/COVESTRO's V0 flame retardant PC materials.
- Bluetooth 5.0 SIG Mesh with high networking capacity provides reliable and stable performance.
- Ultra-high compatibility, can be integrated into third-party 485 control systems to expand product flexibility;
- Diversified control, support our smart home system to connect to third-party systems;
- Can record third-party 485 system commands, no input docking, convenient and efficient;
- Support local scenes, network shutdown, controllable network disconnection, faster and more stable;
- Support OTA online upgrade function, with ultra-low power consumption function, can continuously power on and off to restore factory settings;
- Independent isolation circuit, strong signal anti-interference ability, safe and stable;
- It can be used with smart gateways to realize rich cloud scenarios, cloud automation, and local automation control.

## Technical Specs

Model	CG-LINK
Communication Type	Bluetooth 5.0 SIG Mesh, RS485
Operating voltage	100-240V~
485 interface	isolated
Wireless Frequency	2.4GHz
Baud Rate	1200-115200bps
Working Temperature	-20°C~55°C
Product Size	L84×W35×H23(mm)
Package Size	L100×W70×H42(mm)



## Product Image



## Product size

Unit: mm

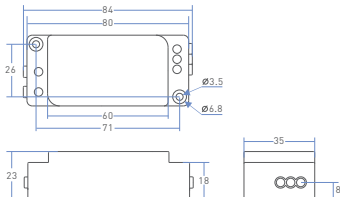

# Connection application diagram

## Third Party 485-LTECH Bluetooth Smart Home System



## LTECH Bluetooth Smart Home System-Third Party System



# Recommended Applications

1. Our equipment controls third-party equipment.



Smart Switch      Super Smart Link Module      Third-party 485 system

2. The third party 485 system controls our equipment.



Third-party 485 system      Super Smart Link Module      Bluetooth Driver      Lamp

3. The third-party 485 system controls our scene.



Third-party 485 system      Super Smart Link Module      Local scene

4. Automation: Combined with intelligent gateway, it can realize rich automation control.



Third-party 485 system      Smart Gateway      Super Smart Link Module      Automation

5. More applications of intelligent control are waiting for you to set up.

# App Operating Instructions

## 1. Account Registration

Scan the QR code below with your mobile phone, follow the prompts to complete the APP installation, and then log in/register.



Scan the QR code to download the APP

## 2. Pairing operation

After the new user creates a family on the APP, click "+" in the upper right corner of the 【Room】 interface to add it. Select "Smart Module" - "Super Smart Connection Module" in the add device list, and follow the prompts on the interface to complete the addition.

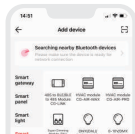
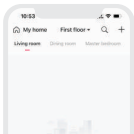

### 3. Add a device

Select the "Super Smart Link Module" card in the room interface, and follow the prompts to select "Custom Bluetooth to 485 Device" and Add the command "Customize 485 to Bluetooth device" and click "Save".

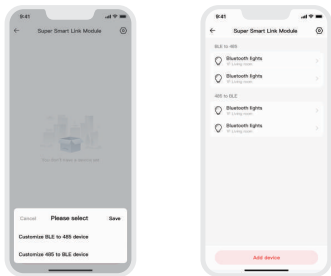



## 4. Scenario

Local scene:

Select "Local scene" in the **Smart** interface, and click "+" to create a local scene. Click Add action and select the corresponding device type action.

Cloud scene:

Make sure that a smart gateway has been added to the home, such as Super Panel 6S. Select "Cloud scene" in the **Smart** interface, and click "+" to create a cloud scene. Click Add action and select the corresponding device type action.

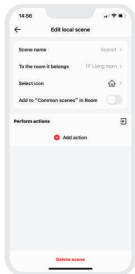

## 5. Automation

Make sure that a smart gateway, such as Super Panel 6S, has been added to your home. Select **Automation** in the "Smart" interface and click "+" to create automation. Set trigger conditions and execute actions. When the set trigger conditions are met, a series of device actions are automatically triggered to achieve remote linkage.

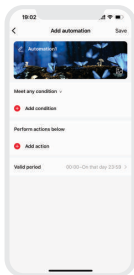
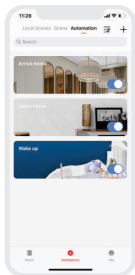

## FAQs

### 1. What should I do if I fail to search the device via APP?

Please check below:

- 1.1 Please make sure the device is powered on normally and is in the activated state.
- 1.2 Please keep you mobile phone and device as close as possible. The recommended distance between them is no more than 15 meters.
- 1.3 Please make sure the device hasn't been added yet. If it has, please reset the device to factory defaults manually.

### 2. How to log in and out of the network?

- 2.1 Exit the network: Use the power switch to turn it on and off 6 times in a row (off for 5 seconds and on for 2 seconds each time).
- 2.2 Buzzer: Power on: one beep; Network access successful: one long beep; Network exit successful: three beeps;

## Attentions

- Products shall be installed by qualified professionals.
- LTECH products are and not lightningproof non-waterproof (special models excepted). Please avoid the sun and rain. When installed outdoors, please ensure they are mounted in a water proof enclosure or in an area equipped with lightning protection devices.
- Good heat dissipation will extend the working life of products. Please ensure good ventilation.
- Please check if the working voltage used complies with the parameter requirements of products.
- The diameter of wire used must be able to load the light fixtures you connect and ensure the firm wiring.
- Before you power on products, please make sure all the wiring is correct in case of incorrect connection that causes damage to light fixtures.
- If a fault occurs, please do not attempt to fix products by yourself. If you have any question, please contact your suppliers.

\* This manual is subject to changes without further notice. Product functions depend on the goods. Please feel free to contact our official distributors if you have any question.

# Warranty Agreement

Warranty periods from the date of delivery : 2 years.

Free repair or replacement services for quality problems are provided within warranty periods.

## **Warranty exclusions below:**

- Beyond warranty periods.
  - Any artificial damage caused by high voltage, overload, or improper operations.
  - Products with severe physical damage.
  - Damage caused by natural disasters and force majeure.
  - Warranty labels and barcodes have been damaged.
  - No any contract signed by LTECH.
1. Repair or replacement provided is the only remedy for customers. LTECH is not liable for any incidental or consequential damage unless it is within the law.
  2. LTECH has the right to amend or adjust the terms of this warranty, and release in written form shall prevail.

## FCC Warning

This device complies with part 15 of the FCC Rules. Operation is subject to the following two conditions: (1) This device may not cause harmful interference, and (2) this device must accept any interference received, including interference that may cause undesired operation.

Any Changes or modifications not expressly approved by the party responsible for compliance could void the user's authority to operate the equipment.

**Note:** This equipment has been tested and found to comply with the limits for a Class B digital device, pursuant to part 15 of the FCC Rules. These limits are designed to provide reasonable protection against harmful interference in a residential installation. This equipment generates uses and can radiate radio frequency energy and, if not installed and used in accordance with the instructions, may cause harmful interference to radio communications. However, there is no guarantee that interference will not occur in a particular installation. If this equipment does cause harmful interference to radio or television reception, which can be determined by turning the equipment off and on, the user is encouraged to try to correct the interference by one or more of the following measures:

- Reorient or relocate the receiving antenna.
- Increase the separation between the equipment and receiver.
- Connect the equipment into an outlet on a circuit different from that to which the receiver is connected.
- Consult the dealer or an experienced radio/TV technician for help.

This equipment complies with FCC radiation exposure limits set forth for an uncontrolled environment. This equipment should be installed and operated with minimum distance 20cm between the radiator & your body.