

QUICK GUIDE

UV disinfection LED eye protection table lamp

OVERVIEW

This product integrates the functions of ultraviolet disinfection and desk lamp. In desk lamp mode, The light is soft and bright without flickering, energy saving, eye protection, and night light function; In the poison lamp mode, it can disinfect masks and student stationery lamps, which is very practical.

PACKING LIST







UV disinfection LED eye protection table lamp 1 se
Micro USB charging cable 1
Manual 1 copy
Product certificate 1 copy

PRODUCT FEATURES

1. UV ring lamp
2. Three-stage table lamp mode, 6000K white light, soft eye protection
3. 2700K warm light night light
4. Touch switch + remote control switch
5. Pen holder base, can be used as mobile phone holder
6. Universal tube light pole, adjustable at will
7. Charging and plugging

02

OPERATING INSTRUCTIONS

1. The ultraviolet disinfection lamp needs to use a special remote control to control it. Adjust the position of the disinfection lamp first, and then use the remote control to press the power button  after turning on, and the red light on the base will light up.
2. Press the    button on the remote control to set 5 minutes (1 blue light on) and 10 minutes respectively (2 blue lights on), 15 minutes (3 blue lights on); after selecting the time, with the beep of didi, the ultraviolet lamp lights up after 8 seconds and enters the disinfection mode.
3. In the lamp mode, press the  button to turn on the lamp, and the three-level cycle switch; Press the  keyboard to turn on/off the night light.

CHARGING INSTRUCTIONS

1. Plug one end of the power cord into the micro USB socket of the machine, and the other end of the USB Insert the USB port of the computer, or connect to the standard DC5V charging port, The red light is always on when charging; the red light is off and the blue light is on when fully charged.
2. The lamp has a built-in overcharge protection circuit, which can connect to the computer or charge for a long time. The battery can be fully charged in about 2 hours when using the device.

03

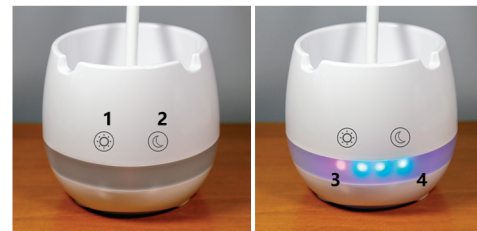

1. Lamp switch
2. Night light switch

3. UV light standby light (red light)
4. UV lamp work light (blue light)

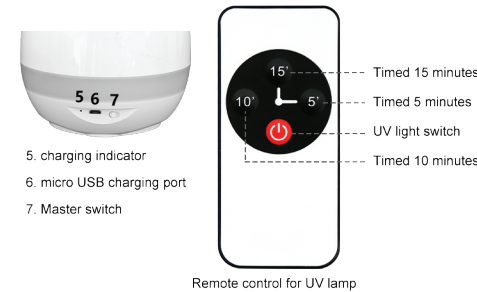

Remote control for UV lamp

04

PRODUCT PARAMETER

Product name: UV disinfection LED eye protection lamp
Power: 6W
Color temperature: table lamp 6000K, night lamp 2700K
Ultraviolet lamp: Quartz cold extreme UV ultraviolet lamp
Lamp power: 1W
Control method: touch switch + remote control switch
Battery: Rechargeable durable and safe battery

PRECAUTIONS

1. When using this product for the first time, please fully charge the product. After charging is completed, the red charging indicator light will automatically turn off and the blue indicator light will automatically turn on.
2. When not in use, turn off the power.
3. The remote control is the only way to turn on the UV lamp. Please keep the remote control properly.

05

FCC Warning Statement

Changes or modifications not expressly approved by the party responsible for compliance could void the user's authority to operate the equipment. This equipment has been tested and found to comply with the limits for a Class B digital device, pursuant to Part 15 of the FCC Rules. These limits are designed to provide reasonable protection against harmful interference in a residential installation. This equipment generates uses and can radiate radio frequency energy and, if not installed and used in accordance with the instructions, may cause harmful interference to radio communications. However, there is no guarantee that interference will not occur in a particular installation. If this equipment does cause harmful interference to radio or television reception, which can be determined by turning the equipment off and on, the user is encouraged to try to correct the interference by one or more of the following measures:

- - Reorient or relocate the receiving antenna.
- - Increase the separation between the equipment and receiver.
- - Connect the equipment into an outlet on a circuit different from that to which the receiver is connected.
- - Consult the dealer or an experienced radio/TV technician for help.

This device complies with part 15 of the FCC Rules. Operation is subject to the following two conditions: (1) This device may not cause harmful interference, and
(2) this device must accept any interference received, including interference that may cause undesired operation.