

2 IN 1

DOG TRAINING COLLAR & BARK CONTROL COLLAR

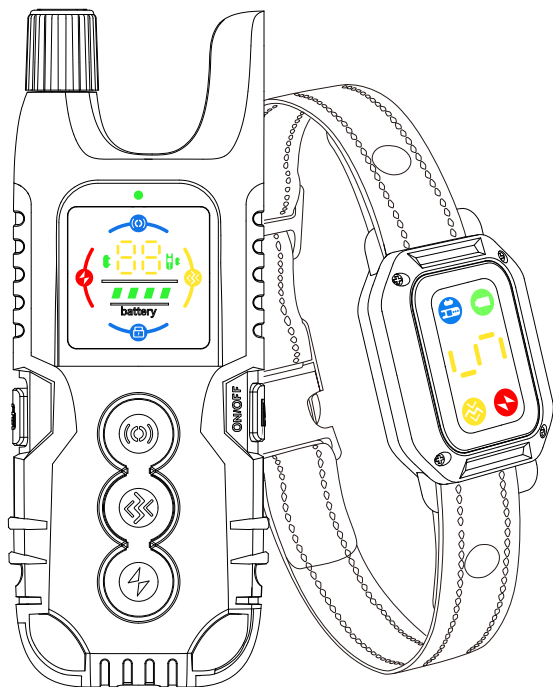

USER MANUAL

Model:OTB5

I. Important Safety Information:

WARNING

Not for use with aggressive dogs. Do not use this product if your dog is aggressive, or if your dog is prone to aggressive behavior. Aggressive dogs can cause severe injury to their owner and others. If you are unsure whether this product is appropriate for your dog, please consult your veterinarian or a certified trainer.

- For use with dogs over 6 months of age and over 5 lbs.
- DO NOT press and hold the Warning Tone Button, Vibration Button and Shock Button for more than 10 seconds constantly to avoid physical or psychological hurt to your dog.
- Your dog **SHOULD NOT VOCALIZE OR PANIC** when receiving stimulation. If this happens, the stimulation level is too high and you need to go back to the previous level and repeat the process.
- **DO NOT** charge the device near any flammable substances.
- For dog use **ONLY**. Not for use on children.
- This is not a toy, and should only be operated by a responsible adult.

CAUTION

Before your first training, please read and follow the instructions in this manual carefully. The cautions below will help keep your dog safe and comfortable. Millions of dogs are comfortable when they wear stainless steel contacts, while some dogs are sensitive to contact pressure.

- **It is vitally important that you and your dog remain safe while learning during on-leash training.** Your dog should be on a strong leash (do not attach the leash to the **2 IN 1 DOG TRAINING COLLAR & BARK CONTROL COLLAR**), long enough for him to attempt to chase an object, but short enough for him not to reach a road or other hazard. You must also be physically strong enough to restrain your dog when he tries to chase.
- **Risk of skin damage.** Proper Receiver/Bark Control Collar fitment is important. A Receiver/Bark Control Collar worn for too long or made too tight on the dog's neck may cause skin damage. Ranging from redness to pressure ulcers; this condition is commonly known as bed sores.
- **DO NOT leave the Receiver/Bark Control Collar on the dog for more than 12 hours per day.**
- When possible **re-position the Receiver/Bark Control Collar on the dog's neck every 1 to 2 hours.**
- **Check the fit to prevent excessive pressure;** follow the instructions in this manual.
- **Never connect an extra leash to the Receiver/Bark Control Collar;** it will cause excessive pressure on the contacts.
- **Clean the dog's neck area and the Metal Prongs of the Receiver/Bark Control Collar weekly** with a damp cloth.
- **Examine the contact area daily** for signs of a rash or a sore.
- **If a rash or sore is found, discontinue the use of the Receiver/Bark Control Collar** until the skin has healed. If the condition persists beyond 48 hours, see your veterinarian.
- **Receiver/Bark Control Collar meets IP67 waterproof rating,** it can be submerged in water up to 1 meter for up to 30 minutes.

II. Quick Start Guide

Dog Training Mode: please refer to step 5-8; **Bark Control Mode:** please refer to step 9-11; **Dog Training & Bark Control Mode:** please refer to step 12-14.

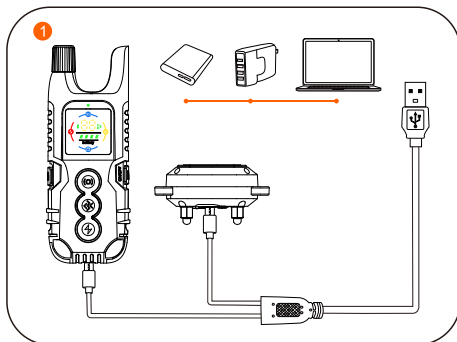

Charge the Receiver/Bark Control Collar and the Remote Transmitter for 2-3 hours with the double-headed Micro-USB cable from the package box.

Note: The charger, power bank and other charging devices shown in the above picture are not included in the box.

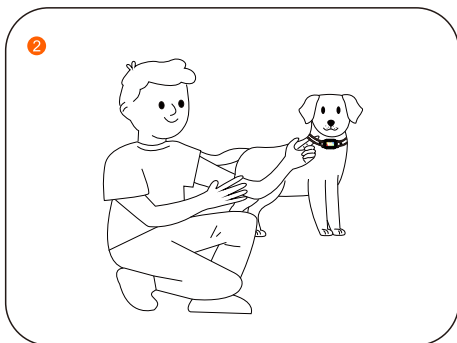

Let your dog stand on four feet or lay down fully. Fit the Receiver/Bark Control Collar to your dog by leaving one finger space between the Collar and your dog's neck. Center the Metal Prongs underneath your dog's neck, touching the skin.

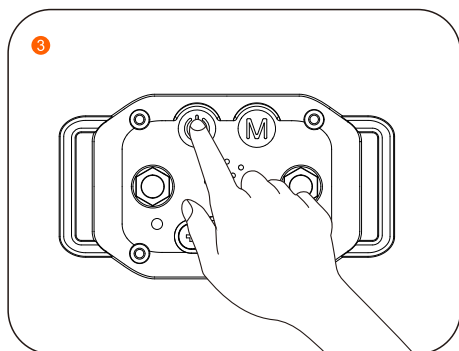

Turn on the Receiver/Bark Control Collar by pressing and holding the Power Button for 2 seconds with a Vibration to indicate that the Receiver/Bark Control Collar turns on, and then the white Indicator continues to blink regularly.

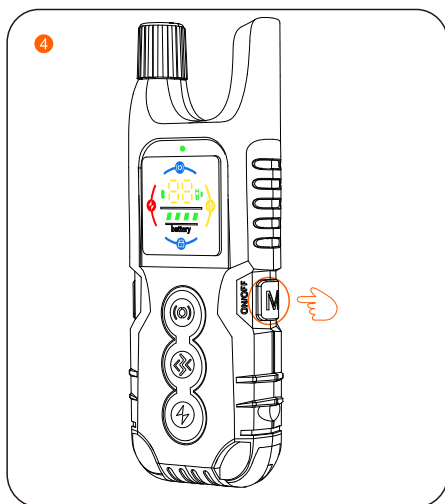

Turn on the Remote Transmitter by pressing and holding the Mode (On/Off) Button for 2 seconds.

5

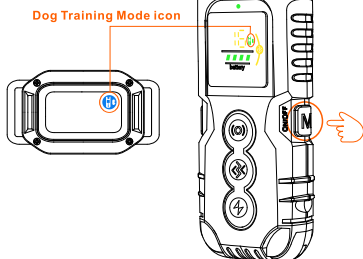

Press the Mode Button on the Remote Transmitter, the green indicator light on the Remote Transmitter will light up (both the Dog Training Mode icons on the Displays of the Remote Transmitter and the Receiver/Bark Control Collar light up simultaneously). The **2 IN 1 DOG TRAINING COLLAR & BARK CONTROL COLLAR** will enter the **Dog Training Mode**.

6

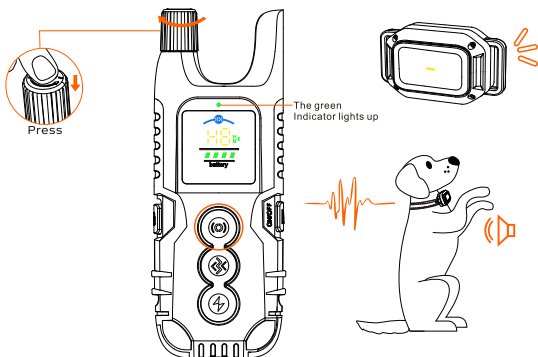

Warning Tone Command: Press the Warning Tone Button, and the green Indicator Light on the Remote Transmitter rapidly lights up. The Receiver will deliver a warning tone, and the yellow LED Indicator light on the Receiver comes up simultaneously. To adjust the warning tone level, press the Adjustment Knob to select the Warning Tone Mode first, then turn the Adjustment Knob left and right to raise/lower to the desired level, and finally press (M) button to confirm the modification.

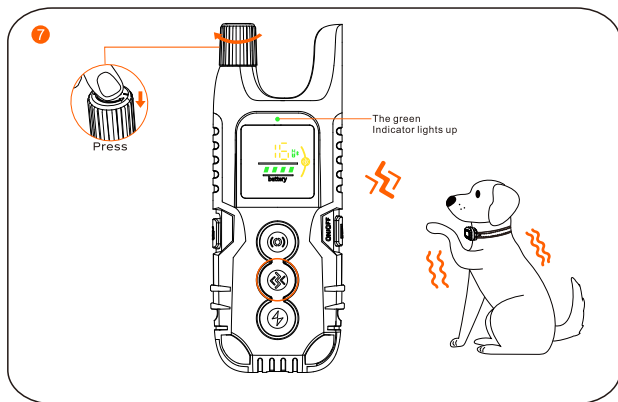

Vibration Command: Press the Vibration Button, and the green Indicator Light on the Remote Transmitter rapidly lights up. The Receiver will deliver vibration, and the yellow LED Indicator light on the Receiver comes up simultaneously. To adjust the Vibration level, press the Adjustment Knob to select the Vibration Mode first, then turn the Adjustment Knob left and right to raise/lower to the desired level, and finally press button to confirm the modification.

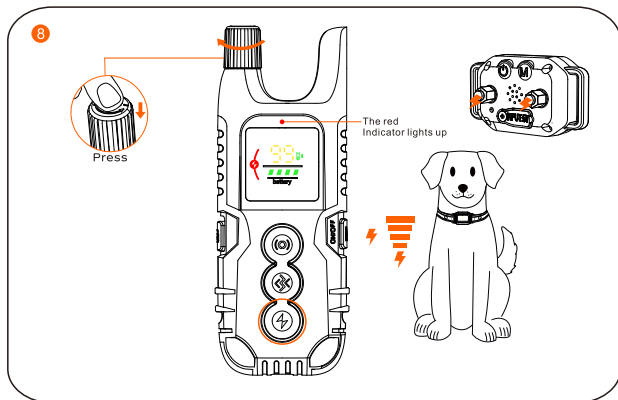

Shock Command: Press the Shock Button, and the red indicator Light on the Remote Transmitter rapidly lights up. The Receiver will deliver a shock and the yellow LED Indicator light on the Receiver comes up simultaneously. To adjust the shock level, press the Adjustment Knob to select the Shock Mode first, then turn the Adjustment Knob left and right to raise/lower to the desired level, and finally press button to confirm the modification.

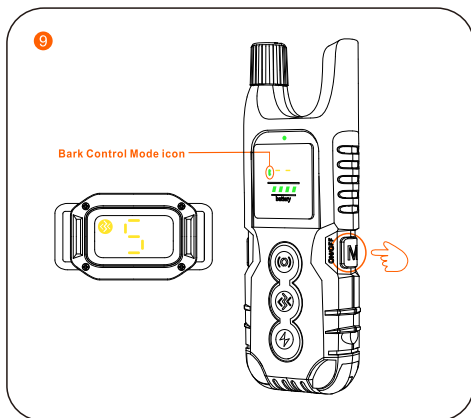

Press the Mode Button on the Remote Transmitter, the green indicator light and the Bark Control Mode icon on the Display of the Remote Transmitter will light up. The **2 IN 1 DOG TRAINING COLLAR & BARK CONTROL COLLAR** will enter the **Bark Control Mode**.

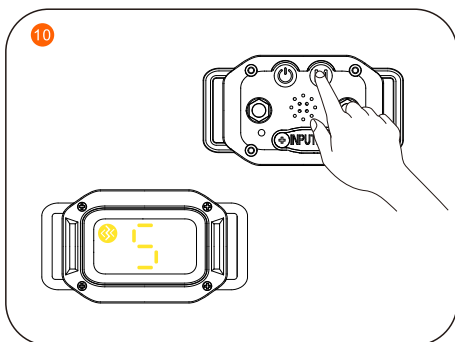

Press the Mode Button to enter the **Warning Tone +Vibration Mode**, the Working Mode is 6 Variable Warning Tone + 3 Levels of Vibration working collaboratively in 6 steps. Adjust the sensitivity level from 1-5 by pressing the Power/Set Button. Level 5 is the most sensitive and level 1 is the least sensitive.

11

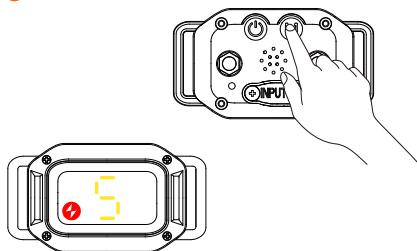

Press the Mode Button to enter the **Warning Tone + Vibration + Shock Mode**, the Working Mode is 6 Variable Warning Tone + Strong Vibration + 6 Levels of Shock working collaboratively in 6 steps. Adjust the sensitivity level from 1-5 by pressing the Power/Set Button. Level 5 is the most sensitive and level 1 is the least sensitive.

12

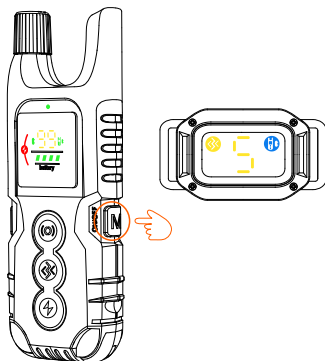

Press the Mode Button on the Remote Transmitter, the green indicator light on the Remote Transmitter will light up (the Dog Training Mode icon and Bark Control Mode icon on the Display of the Remote Transmitter and the Dog Training Mode icon on the Receiver/Bark Control Collar will light up simultaneously).

The **2 IN 1 DOG TRAINING COLLAR & BARK CONTROL COLLAR** will enter the **Dog Training & Bark Control Mode**.

13

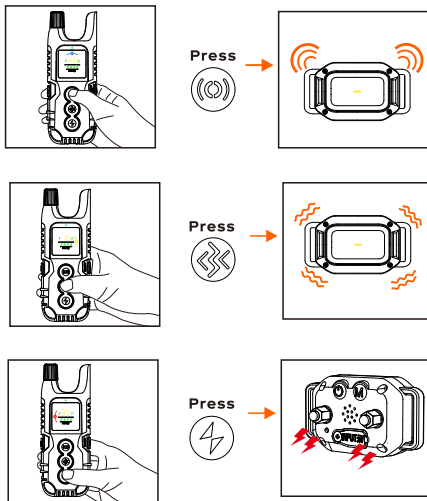

Press the Warning Tone Button, Vibration Button, or Shock Button on the Remote Transmitter, and Receiver/Bark Control Collar will respond correspondingly. Please refer to "VI. Training Mode" on page 18 for more details.

14

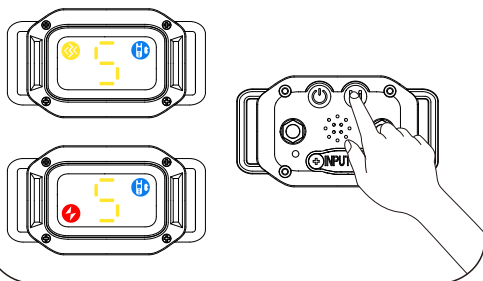

Press the Mode button to switch modes, the mode icons will be changed. Adjust the sensitivity level from 1-5 by pressing the Power/Set Button. Please refer to "VI. Training Mode" on page 18 for more details.

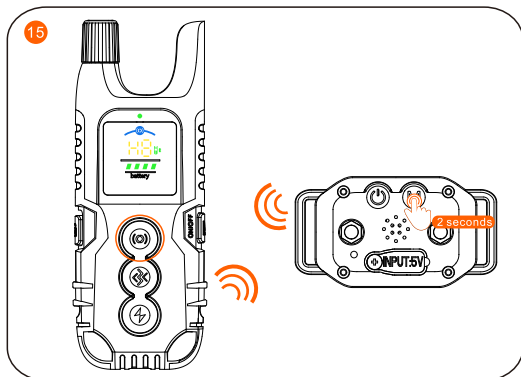

In case of the Receiver/Bark Control Collar is not responding to the Remote Transmitter, follow these steps to pair them up:

1. Press and hold the Mode Button on the Receiver/Bark Control Collar for 2 seconds to enter the Pairing Mode. You will hear a beeping tone and the Dog Training Mode icon will Blinking Fast. You will now have 10 seconds to finish the pairing;
2. Press the Beep Button, Vibration Button, or Shock Button on the Remote Transmitter, and Receiver will respond correspondingly indicating that the pairing process is completed. Please refer to "VI. Paring Up" on page 23 and 24 for more details.

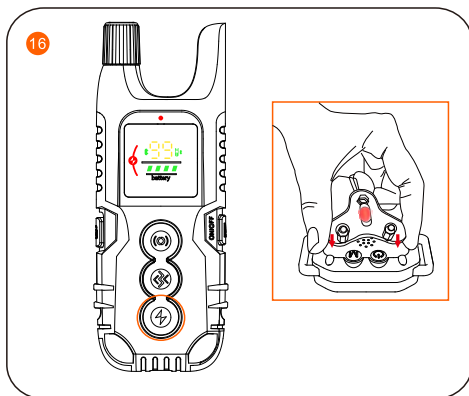

Test the Receiver/Bark Control Collar with the Test Bulb:

1. Hold the Test Bulb to the Metal Prongs on the Receiver/Bark Control Collar. Make sure the metal wire in the Test Bulb has direct contact with both of the top of the Metal Prongs.
2. Press the Shock Button on the Remote Transmitter.
3. The yellow Test Light will flash if the Receiver/Bark Control Collar works normally. At higher shock levels, the Test Bulb will flash brighter.

Note: (1) While you test the Receiver with your fingers, please put your two fingers on the top of the Contact Points separately to form a closed loop circle.

(2) Please always start from the lowest Shock level to avoid accident hurt.

III. Package Content

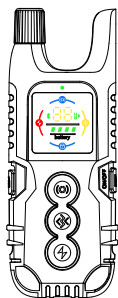

Remote Transmitter



Receiver
/ Bark Control Collar



User Manual



Silicone Caps



Test Bulb

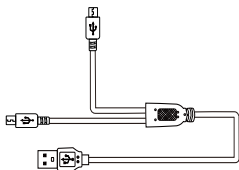

Charging Cable



Metal Prongs



Wrist Strap

IV.Product Overview

Remote Transmitter

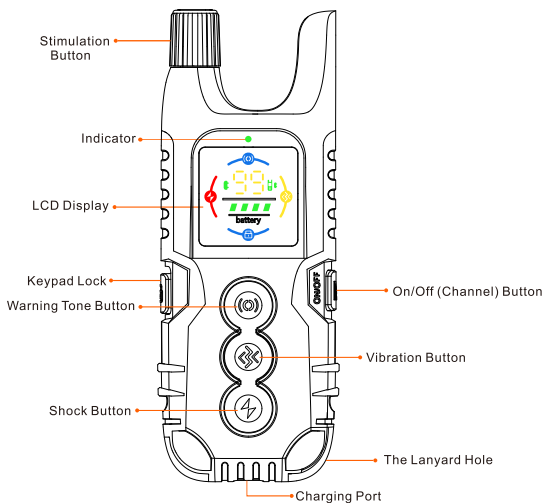

(1)The icons "88" and "////" will be displayed when the Remote Transmitter is set to the locked state.

(2)The Remote Transmitter will go into sleep mode if there is no operation in 1 minutes.

Display Screen

