

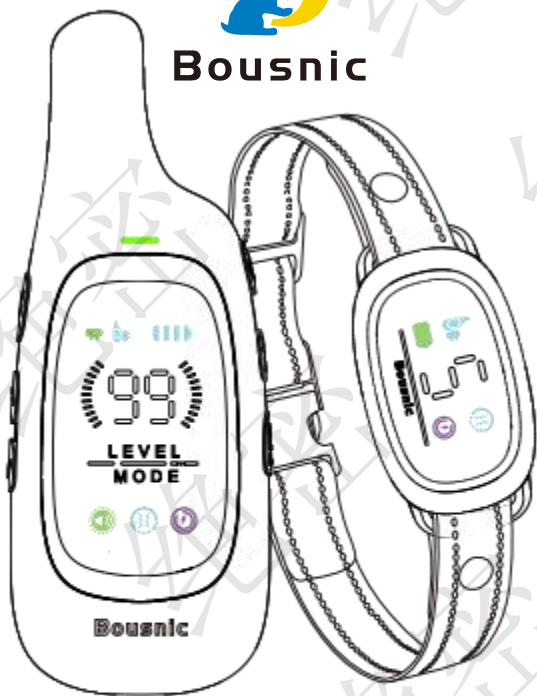

Bousnic



DOG TRAINING COLLAR

Mode:OBT3



Quick Start Guide Video

I. Important Safety Information:

WARNING

Not for use with aggressive dogs. Do not use this product if your dog is aggressive, or if your dog is prone to aggressive behavior.

Aggressive dogs can cause severe injury to their owner and others. If you are unsure whether this product is appropriate for your dog, please consult your veterinarian or a certified trainer.

- For use with dogs over 6 months of age and over 5 lbs.
- DO NOT press and hold the Warning Tone Button, Vibration Button and Shock Button for more than 10 seconds constantly to avoid physical or psychological hurt to your dog.
- Your dog **SHOULD NOT VOCALIZE OR PANIC** when receiving stimulation. If this happens, the stimulation level is too high and you need to go back to the previous level and repeat the process.
- **DO NOT** charge the device near any flammable substances.
- For dog use **ONLY**. Not for use on children.
- This is not a toy, and should only be operated by a responsible adult.

CAUTION

Before your first training, please read and follow the instructions in this manual carefully. The cautions below will help keep your dog safe and comfortable. Millions of dogs are comfortable when they wear stainless steel contacts, while some dogs are sensitive to contact pressure.

- **It is vitally important that you and your dog remain safe while learning during on-leash training.** Your dog should be on a strong leash (do not attach the leash to the **2 IN 1 DOG TRAINING COLLAR & BARK CONTROL COLLAR**), long enough for him to attempt to chase an object, but short enough for him not to reach a road or other hazard. You must also be physically strong enough to restrain your dog when he tries to chase.
- **Risk of skin damage.** Proper Receiver/Bark Control Collar fitment is important. A Receiver/Bark Control Collar worn for too long or made too tight on the dog's neck may cause skin damage. Ranging from redness to pressure ulcers; this condition is commonly known as bed sores.
- **DO NOT leave the Receiver/Bark Control Collar on the dog for more than 12 hours per day.**
- When possible **re-position the Receiver/Bark Control Collar on the dog's neck every 1 to 2 hours.**
- **Check the fit to prevent excessive pressure;** follow the instructions in this manual.
- **Never connect an extra leash to the Receiver/Bark Control Collar;** it will cause excessive pressure on the contacts.
- **Clean the dog's neck area and the Metal Prongs of the Receiver/Bark Control Collar weekly** with a damp cloth.
- **Examine the contact area daily** for signs of a rash or a sore.
- **If a rash or sore is found, discontinue the use of the Receiver/Bark Control Collar** until the skin has healed. If the condition persists beyond 48 hours, see your veterinarian.
- **Receiver/Bark Control Collar meets IP67 waterproof rating,** it can be submerged in water up to 1 meter for up to 30 minutes.

II. Quick Start Guide

Dog Training Mode: please refer to step 5-8; **Bark Control Mode:** please refer to step 9-11; **Dog Training & Bark Control Mode:** please refer to step 12-14 .

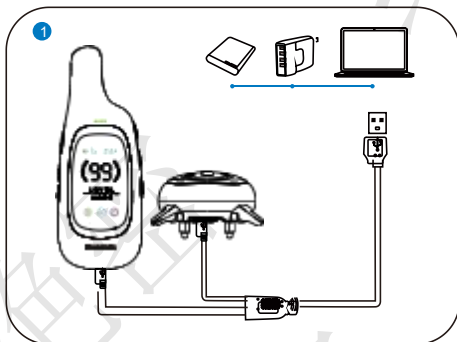

Charge the Receiver/Bark Control Collar and the Remote Transmitter for 2-3 hours with the double-headed Micro-USB cable from the package box .

Note: The charger, power bank and other charging devices shown in the above picture are not included in the box .

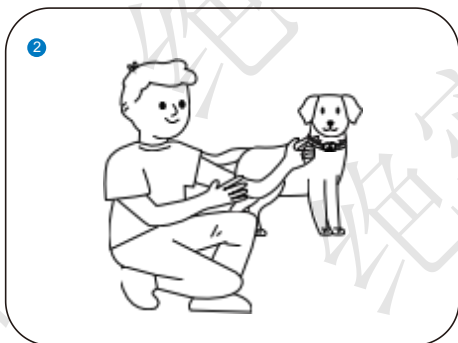

Let your dog stand on four feet or lay down fully. Fit the Receiver/Bark Control Collar to your dog by leaving one finger space between the Collar and your dog's neck . Center the Metal Prongs underneath your dog's neck , touching the skin .

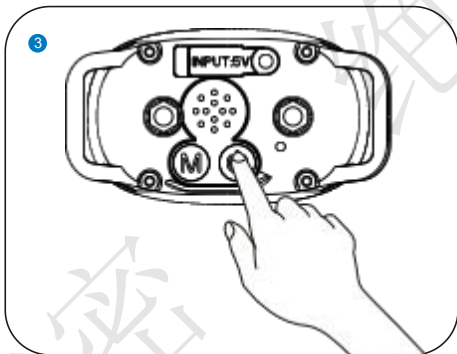

Turn on the Receiver/ Bark Control Collar by pressing and holding the Power Button for 2 seconds with a Vibration to indicate that the Receiver/ Bark Control Collar turns on , and then the white Indicator continues to blinkregularly.



Turn on the Remote Transmitter by pressing and holding the Mode (On/Off) Button for 2 seconds .



Press the Mode Button on the Remote Transmitter, the green indicator light on the Remote Transmitter will light up (both the Dog Training Mode icons on the Displays of the Remote Transmitter and the Receiver/ Bark Control Collar light up simultaneously).
The 2 IN 1 DOG TRAINING COLLAR & BARK CONTROL COLLAR will enter the Dog Training Mode .

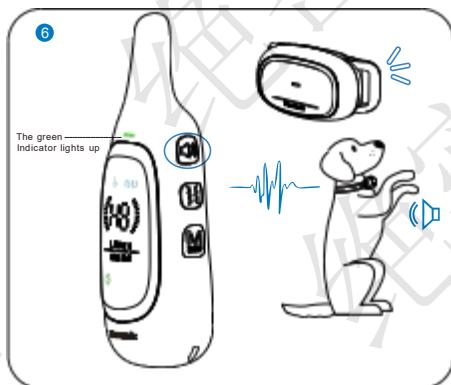

Warning Tone Command : Press the Warning Tone Button , and the Receiver/ Bark Control Collar will deliver a warning tone (the green Indicator on the Remote Transmitter and the white Indicator on the Receiver will light up).
 The Beep level is 1-8 adjustable . Adjust the Warning Tone Level by pressing the Level Up / Down Button .

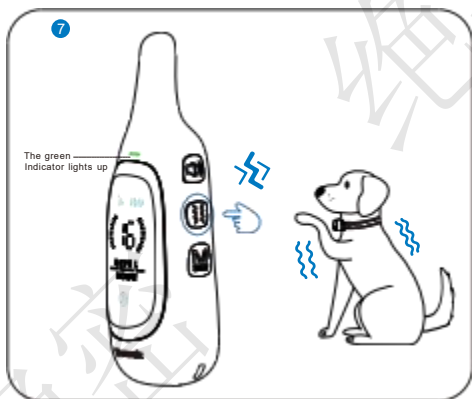

Vibration Command: Press the Vibration Button , and the Receiver/Bark Control Collar will deliver vibration (the green Indicator on the Remote Transmitter and the white indicator on the Receiver will light up). The Vibration level is 1-16 adjustable . Adjust the Vibration Level by pressing the Level Up/Down Button .

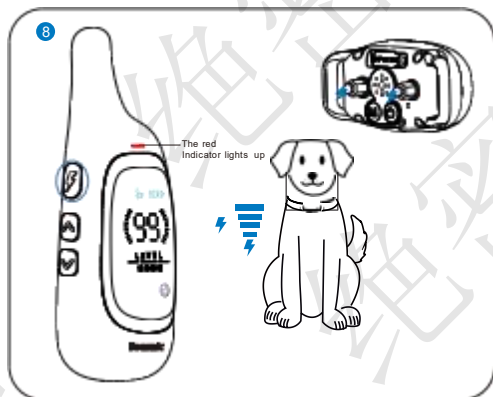

Shock Command: Press the Shock Button , and the Receiver/Bark Control Collar will deliver Shock (the red Indicator on the Remote Transmitter and the white indicator on the Receiver will light up). The Shock level is 1-99 adjustable . Adjust the Shock Level by pressing the Level Up/Down Button .

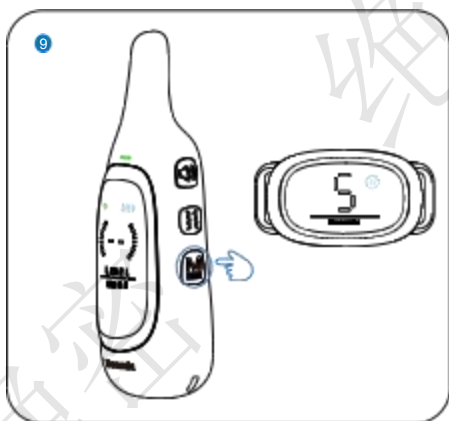

Press the Mode Button on the Remote Transmitter, the green indicator light and the Bark Control Mode icon on the Display of the Remote Transmitter will light up. The **2 IN 1 DOG TRAINING COLLAR & BARK CONTROL COLLAR** will enter the **Bark Control Mode**.

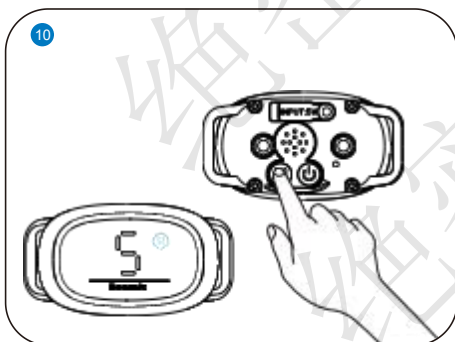

Press the Mode Button to enter the **Warning Tone +Vibration Mode**, the Working Mode is 6 Variable Warning Tone + 3 Levels of Vibration working collaboratively in 6 steps. Adjust the sensitivity level from 1-5 by pressing the Power/Set Button. Level 5 is the most sensitive and level 1 is the least sensitive.

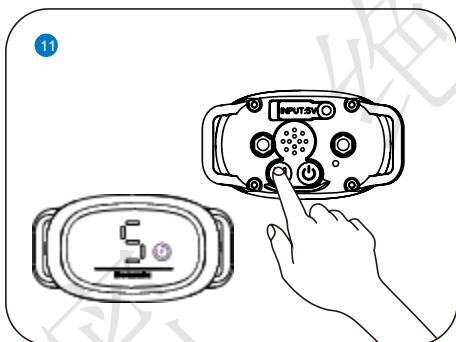

Press the Mode Button to enter the **Warning Tone + Vibration + Shock Mode**, the Working Mode is 6 Variable Warning Tone + Strong Vibration + 6 Levels of Shock working collaboratively in 6 steps. Adjust the sensitivity level from 1-5 by pressing the Power/Set Button. Level 5 is the most sensitive and level 1 is the least sensitive.

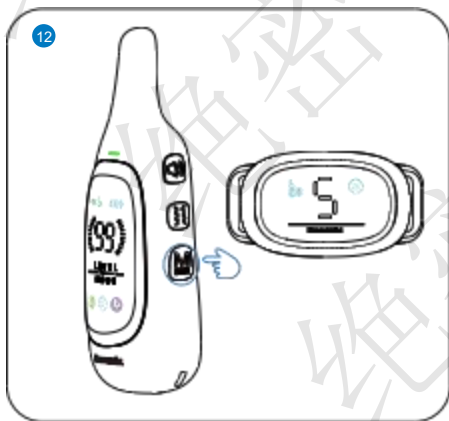

Press the Mode Button on the Remote Transmitter, the green indicator light on the Remote Transmitter will light up (the Dog Training Mode icon and Bark Control Mode icon on the Display of the Remote Transmitter and the Dog Training Mode icon on the Receiver/Bark Control Collar will light up simultaneously). The **2 IN 1 DOG TRAINING COLLAR & BARK CONTROL COLLAR** will enter the **Dog Training & Bark Control Mode**.

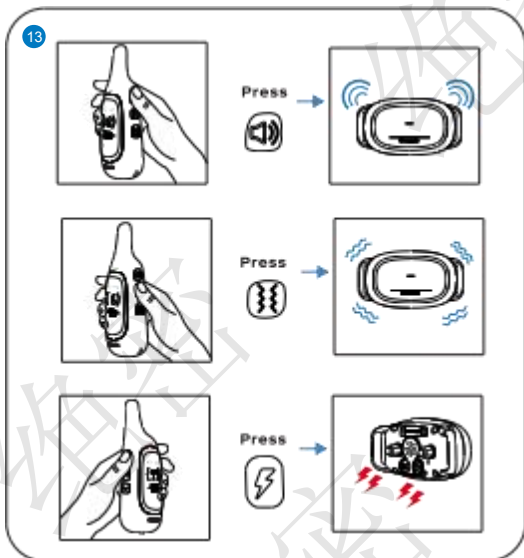

Press the Warning Tone Button , Vibration Button , or Shock Button on the Remote Transmitter, and Receiver/Bark Control Collar will respond correspondingly. Please refer to "VI. Training Mode" on page 14 for more details.

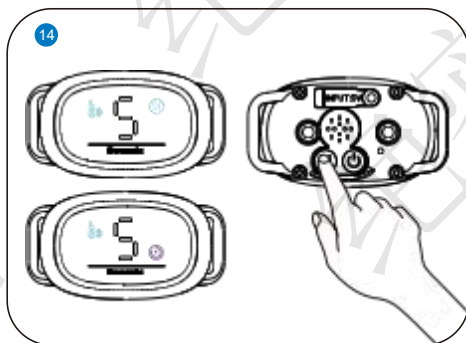

Press the Mode button to switch modes , the mode icons will be changed. Adjust the sensitivity level from 1-5 by pressing the Power/Set Button . Please refer to "VI. Training Mode" on page 15 for more details.



In case of the Receiver/ Bark Control Collar is not responding to the Remote Transmitter, follow these steps to pair them up:

1. Press the Mode Button on the Receiver/ Bark Control Collar for 2 seconds to enter the Pairing Mode. You will hear a beeping tone and the Dog Training Mode icon will Blinking Fast. You will now have 10 seconds to finish the pairing;
2. Press the Beep Button, Vibration Button, or Shock Button on the Remote Transmitter, and Receiver will respond correspondingly indicating that the pairing process is completed. Please refer to "VI. Pairing Up" on page 16 and 17 for more details.

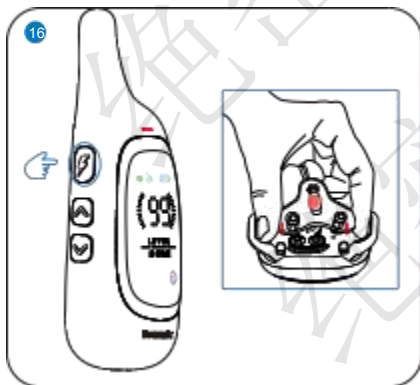

Test the Receiver/ Bark Control Collar with the Test Bulb :

1. Hold the Test Bulb to the Metal Prongs on the Receiver/ Bark Control Collar. Make sure the metal wire in the Test Bulb has direct contact with both of the top of the Metal Prongs.
2. Press the Shock Button on the Remote Transmitter.
3. The yellow Test Light will flash if the Receiver/ Bark Control Collar works normally. At higher shock levels, the Test Bulb will flash brighter.

Note: (1) While you test the Receiver with your fingers, please put your two fingers on the top of the Contact Points separately to form a closed loop circle.
 (2) Please always start from the lowest Shock level to avoid accident hurt.

III. Package Content



Remote Transmitter



Receiver
/ Bark Control Collar



User Manual



Silicone Caps



Test Bulb

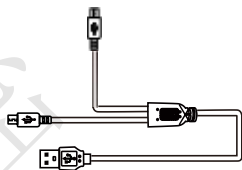

Charging Cable



Metal Prongs



Wrist Strap

IV. Product Overview

Remote Transmitter

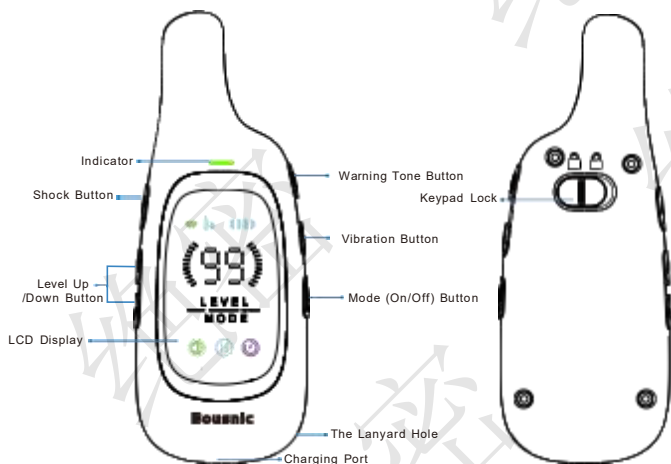

- (1) The icons "HH" and "HHH" will be displayed when the Remote Transmitter is set to the locked state.
- (2) The Remote Transmitter will go into sleep mode if there is no operation in 1 minutes.

Display Screen

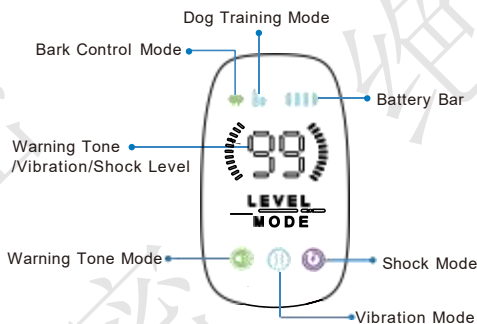

Receiver/Bark Control Collar

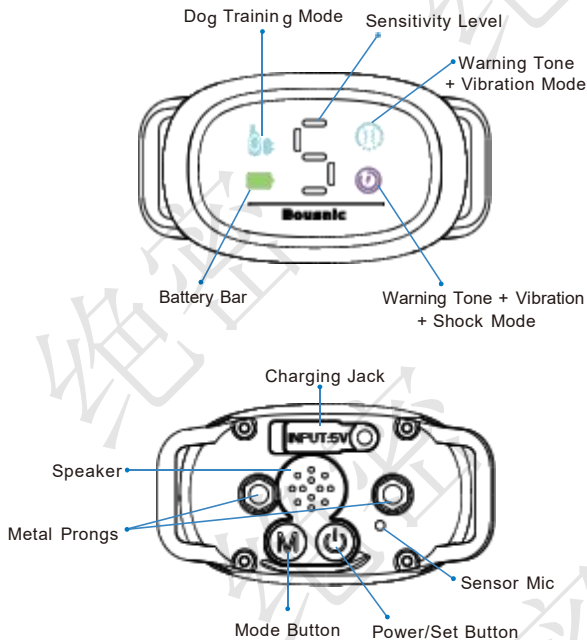

Mode Icons



Warning Tone +Vibration



Warning Tone +Vibration+Shock

Sensitivity Level

1-5

Adjust the sensitivity level from 1-5 by pressing the Power/Set Button. Level 5 is the most sensitive and level 1 is the least sensitive

protection Mode



Product is in a 30-second Protection Period

Test Mode



When the product is set on Test Mode, the digit shows 0 and then will show 5 after the test is completed, or if the test is not operated within 5 seconds

Indicators



Blinking in medium speed : the product is on charge



Blinking in low speed: the product is on standby



Blinking in high speed : the battery is low

How the System Works

The **2 IN 1 DOG TRAINING COLLAR & BARK CONTROL COLLAR** is easy to use with an advanced digital display that tells you the exact stimulation level you are using.

The **Dog Training Mode** assists you in controlling your dog without a leash. At the push of a button, your Remote Transmitter sends a signal activating your dog's Receiver. He receives a safe but annoying stimulation.

He'll quickly learn the association between his behavior and your correction, and soon you'll have a better-behaved dog. The **Bark Control Mode** detects the dog bark and automatically deliver Warning Tone, Vibration and Shock, the dogs will learn quickly from the stimulation and stop barking.

The **2 IN 1 DOG TRAINING COLLAR & BARK CONTROL COLLAR** has been proven safe, comfortable, and effective for both small and large dog breeds.

If using the **2 IN 1 DOG TRAINING COLLAR & BARK CONTROL COLLAR** consistently and correctly, any basic obedience commands can be taught and will help correct any misbehavior that your dog exhibit.

V. Setting Up

1.Charge the Product

Charge both the Receiver/ Bark Control Collar and the Remote Transmitter with the charging cable in the package box until their Indicator becomes solid green which will take around 2-3 hours .

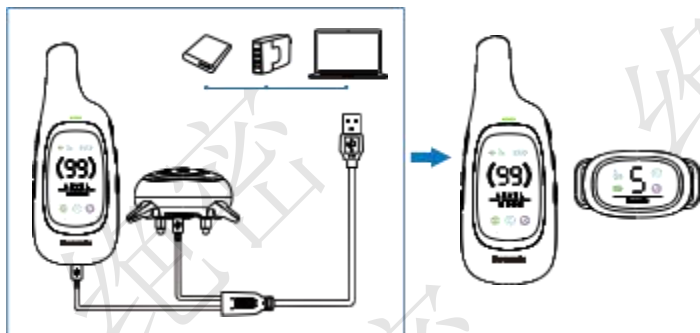

Note:

(1)The charger, power bank and other charging devices shown in the above picture are not included in the box .

(2)Use the charging cable in the package when charging. Other charging cables may not be suitable for this **2 IN 1 DOG TRAINING COLLAR & BARK CONTROL COLLAR** , which may cause electric damage .

(3)The **2 IN 1 DOG TRAINING COLLAR & BARK CONTROL COLLAR** ONLY supports a 5V-rated power source . If charged with an improper charger:

Receiver/Bark Control Collar—deliver a rapid warning tone and stop charging automatically.

Remote Transmitter—stop charging automatically with the Indicator rapidly blinking in red.

2. Turn On/Off the Product

Turn on/off the Remote Transmitter by pressing and holding the Mode (On/Off) Button for 2-3 seconds .

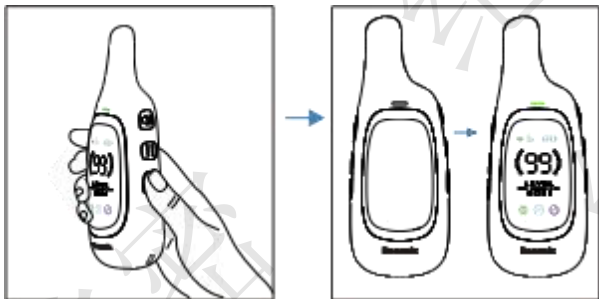

Turn on the Receiver/ Bark Control Collar by pressing and holding the Power Button for 3 seconds with vibration , as the white LED Indicator light blinks regularly.

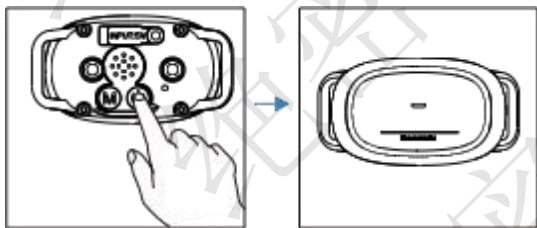

Turn off the Receiver/ Bark Control Collar by pressing and holding the Power Button for 3 seconds with a long beeping , as the white LED Indicator light stops blinking.

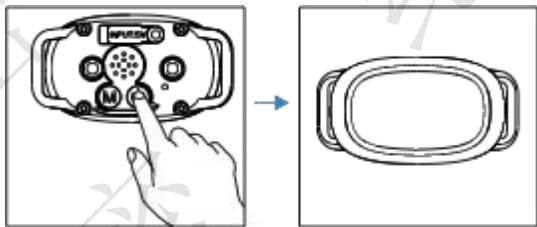

VI. Training Modes

1. Dog Training Mode

Press the Mode Button on the Remote Transmitter, the green indicator light on the Remote Transmitter will light up (both the Dog Training Mode icons on the Displays of the Remote Transmitter and the Receiver light up simultaneously). The **2 IN 1 DOG TRAINING COLLAR & BARK CONTROL COLLAR** will enter the **DOG TRAINING MODE**.

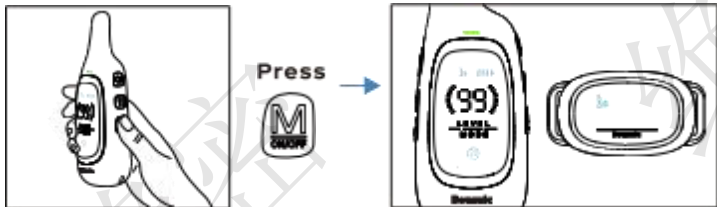

1A. Warning Tone Command:

Press the Warning Tone Button and the Receiver/Bark Control Collar will deliver a warning tone. It will cut off automatically if you press and hold the Warning Tone Button for 10 seconds. There is a total of 8 levels of Warning Tone for training which you can adjust by selecting the Warning Tone Button and pressing the Level Up/ Down Button.

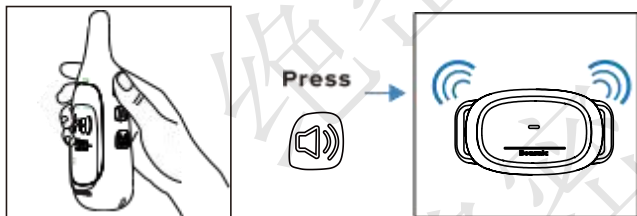

1 B. Vibration Command:

Press the Vibration Button and the Receiver/Bark Control Collar will deliver a vibration. It will cut off automatically if you press and hold the Vibration Button for 10 seconds. There is a total of 16 levels of Vibration for training which you can adjust by selecting the Vibration Button and pressing the Level Up/Down Button.

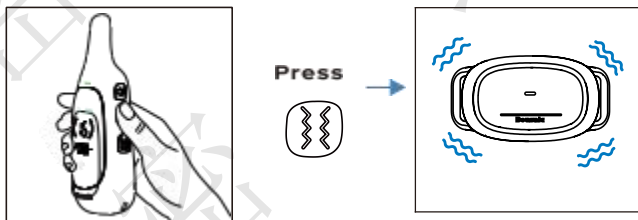

1C. Shock Command:

Press the Shock Button and the Receiver/Bark Control Collar will deliver a static shock. It will cut off automatically if you press and hold the Shock Button for 10 seconds. There is a total of 99 levels of Shock for training which you can adjust by selecting the Shock Button and pressing the Level Up/Down Button.

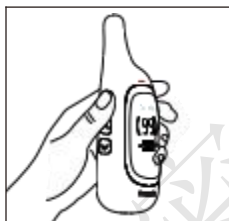

Press

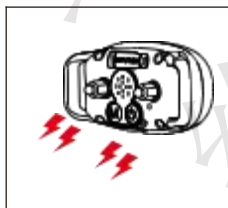

2. Bark Control Mode

Press the Mode Button on the Remote Transmitter, the green indicator light on the Remote Transmitter will light up (the Bark Control Mode icon on the Display of the Remote Transmitter will light up). The **2 IN 1 DOG TRAINING COLLAR & BARK CONTROL COLLAR** will enter the **Bark Control Mode**.

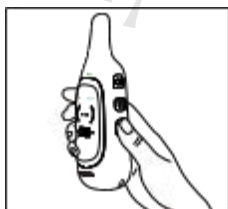

Press

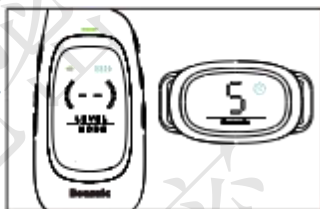

2A. Variable Warning Tone + Vibration Mode

Press the Mode Button to enter the Warning Tone + Vibration Mode, the Working Mode is 6 Variable Warning Tone + 3 Levels of Vibration working collaboratively in 6 steps. Adjust the sensitivity level from 1-5 by pressing the the Power/Set Button. Level 5 is the most sensitive and level 1 is the least sensitive.

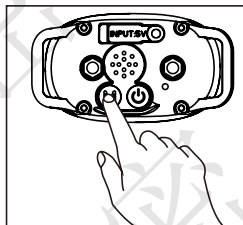

Press



2B.Variable Warning Tone + Vibration + Shock Mode

Press the Mode Button to enter the Warning Tone + Vibration + Shock Mode , the Working Mode is 6 Variable Warning Tone + Strong Vibration + 6 Levels of Shock working collaboratively in 6 steps . Adjust the sensitivity from 1-5 by pressing the Power/Set Button . Level 5 is the most sensitive and level 1 is the least sensitive .

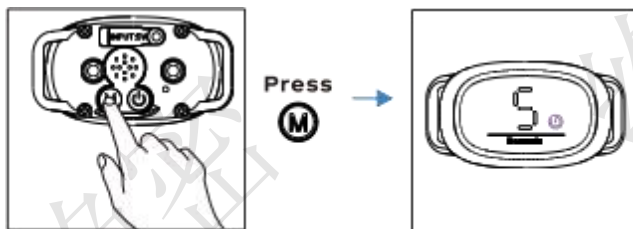

2C. How it works?

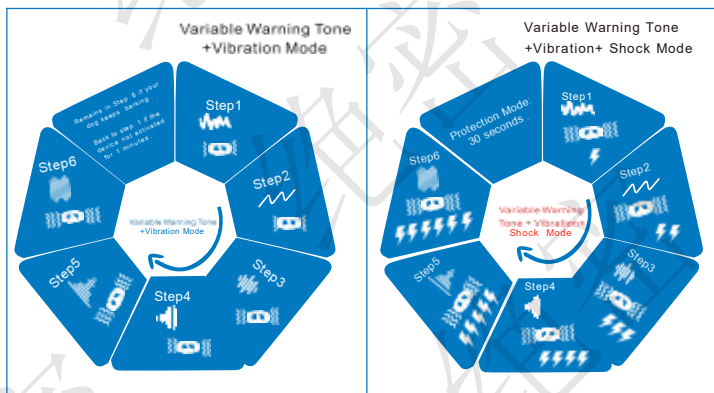

NOTES:

- (1)The product will go to the next step if your dog keeps barking within 30 seconds .
- (2)The product will automatically go back to Step 1 if it is not activated within 1 minutes .

3.Dog Training & Bark Control Mode

Press the Mode Button on the Remote Transmitter, the green indicator light on the Remote Transmitter will light up (the Dog Training Mode icon and Bark Control Mode icon on the Display of the Remote Transmitter and the Dog Training Mode icon on the Receiver/ Bark Control Collar will light up simultaneously). The **2 IN 1 DOG TRAINING COLLAR & BARK CONTROL COLLAR** will enter the **Dog Training & Bark Control Mode**.

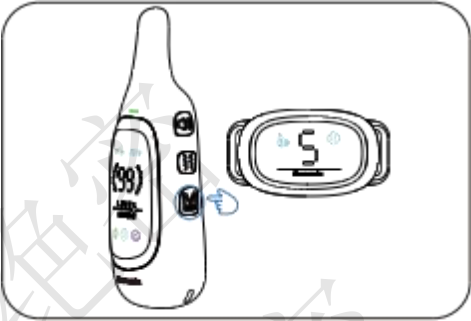

3A. Dog Training Mode:

- (1) Press the Warning Tone Button and the Receiver/ Bark Control Collar will deliver a warning tone . It will cut off automatically if you press and hold the Warning Tone Button for 10 seconds . There is a total of 8 levels of Warning Tone for training which you can adjust by selecting the Warning Tone Button and pressing the Level Up/Down Button .
- (2) Press the Vibration Button and the Receiver/ Bark Control Collar will deliver a vibration . It will cut off automatically if you press and hold the Vibration Button for 10 seconds . There is a total of 16 levels of Vibration for training which you can adjust by selecting the Vibration Button and pressing the Level Up/Down Button .
- (3) Press the Shock Button and the Receiver/ Bark Control Collar will deliver a static shock. It will cut off automatically if you press and hold the Shock Button for 10 seconds . There is a total of 99 levels of Shock for training which you can adjust by selecting the Shock Button and pressing the Level Up/Down Button .

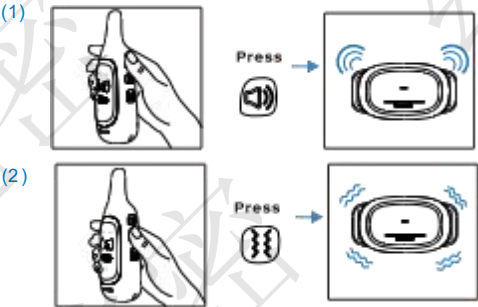

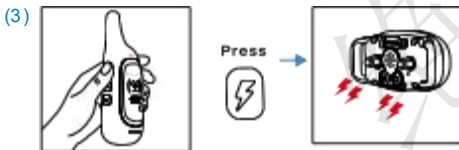

3B. Bark Control Mode

(4) Press the Mode Button to enter the Warning Tone + Vibration Mode, the Working Mode is 6 Variable Warning Tone + 3 Levels of Vibration working collaboratively in 6 steps. Adjust the sensitivity level from 1-5 by pressing the Power/Set Button. Level 5 is the most sensitive and level 1 is the least sensitive.

(5) Press the Mode Button to enter the Warning Tone + Vibration + Shock Mode, the Working Mode is 6 Variable Warning Tone + Strong Vibration + 6 Levels of Shock working collaboratively in 6 steps. Adjust the sensitivity level from 1-5 by pressing the Power/Set Button. Level 5 is the most sensitive and level 1 is the least sensitive.

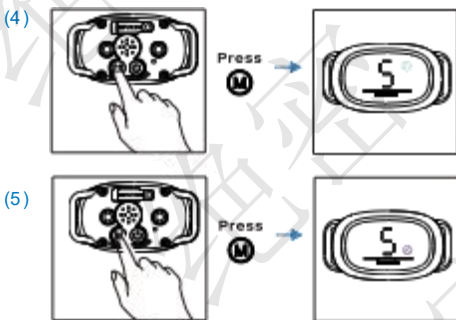

VII. Fitting the Receiver/Bark Control Collar

IMPORTANT:

The proper fit and placement of your Receiver/Bark Control Collar are important for effective training. The Metal Prongs with Conductive Silicone Caps must have direct contact with your dog's skin on the underside of his neck. To assure a proper fit, please follow these steps:

1. Make sure that the Receiver/Bark Control Collar is turned off.
2. Let your dog stand on four feet or lay down fully (A).
3. Place the Receiver/Bark Control Collar on your dog's neck close to the ears. Center the Metal Prongs underneath your dog's neck, touching the skin (B).
Note: It is sometimes necessary to trim the hair around the Metal Prongs to make sure that contact is consistent.
4. The Receiver/Bark Control Collar should fit snugly, yet loose enough to allow one finger to fit between the strap and your dog's neck (C).

5. Allow your dog to wear the Receiver/Bark Control Collar for several minutes then recheck the fit. Check the fit again as your dog becomes more comfortable with the Receiver/Bark Control Collar.

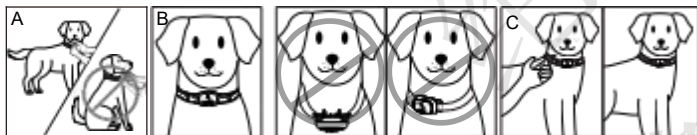

6. To attach the collar to the Receiver/Bark Control Collar, please follow the following steps as instructed to thread the strap.

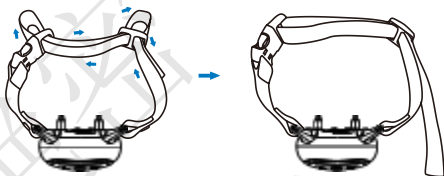

CAUTION :

It is sometimes necessary to **trim the hair around the Contact Points** to make sure that contact is consistent.

- **DO NOT** shave the dog's neck as this may increase the risk of skin irritation.
- **Check the fit regularly** to make your dog more comfortable with the Receiver/Bark Control Collar.

VIII. Pairing Up

In case of the Receiver/Bark Control Collar is not responding to the Remote Transmitter, follow these steps to pair them up:

1. Press the Mode Button on the Receiver/Bark Control Collar for 2 seconds to enter the Pairing Mode. You will hear a Beeping tone and the Dog Training Mode icon on the Receiver/Bark Control Collar blink rapidly. You will now have 10 seconds to finish the pairing.

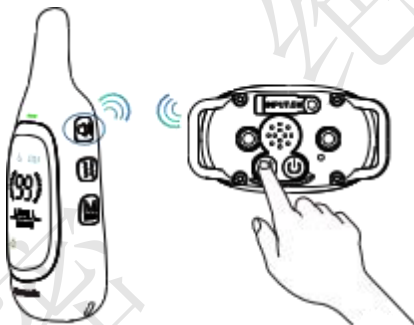

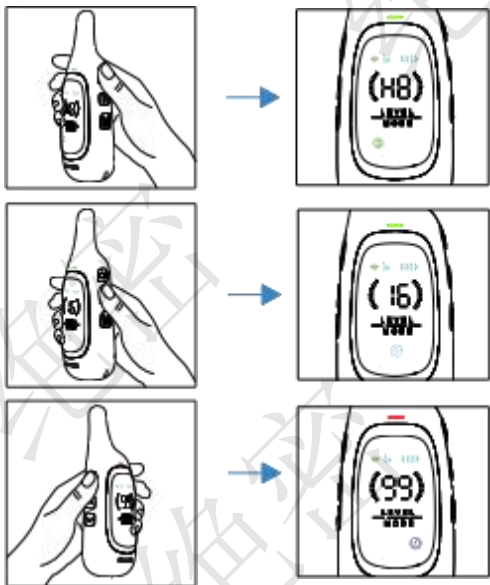

2. Press the Warning Tone , Vibration or Shock Buttons on the Remote Transmitter, and the Receiver/ Bark Control Collar will respond correspondingly indicating that the pairing process is completed.





Tips:
The Receiver/ Bark Control Collar is paired to the Remote Transmitter by the factory default setting. If you find the Receiver/ Bark Control Collar does not respond to the Remote Transmitter when you get the product or during use , please follow the above steps to pair the Receiver/ Bark Control Collar to the Remote Transmitter again .

IX. Indicator Definitions

Remote Transmitter Indicator:

Charging	The Green Indicator light blinks fast
Fully Charged	The Green Indicator light becomes solid
Press 	A Green Indicator light comes up
Press 	A Green Indicator light comes up
Press 	A Red Indicator light comes up

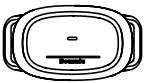
Receiver/Bark Control Collar Indicator :

	A white Indicator light comes up when the Warning Tone , Vibration and Shock function is activated
	Slowly blinking indicates the Receiver/Bark Control Collar is on
	Fast blinking indicates the Receiver/Bark Control Collar is on charge
	Faster blinking indicates the Receiver/Bark Control Collar battery is low

X. Training Tip

Important: Always start at the lowest level and work your way up. The **Dog Training Mode** has 8 types of Warning Tones , 16 levels of Vibration , and 99 levels of Shock . For Warning Tones , there are 8 types of Tones , with only frequency differences between the different types . For Vibration and Shock , level 1 is the lowest; the highest level for Vibration is level 16 , and level 99 for Shock . This allows you to choose the Stimulation level that is best for your dog . Once you have placed the Receiver on your dog , it is time to find the Stimulation Level that is best for him . This is called the Recognition Level . A slight change in your dog's behavior , such as looking around in curiosity , scratching at his collar , or flicking his ears , indicates the Recognition Level that is best for your dog .

Follow the steps below to find your dog's Recognition Level:

1. Starting at Level 1 , press the Warning Tone/Vibration/Shock Button continuously for 1 to 2 seconds .
- Note:** When the Warning Tone/Vibration/Shock Button is held down for 10 consecutive seconds , the Remote Transmitter will "time out" , and you must release and press the button again before additional stimulation can be delivered .
2. If your dog shows no reaction , repeat the Stimulation Level several times before moving up to the next level .
3. **YOUR DOG SHOULD NOT VOCALIZE OR PANIC WHEN RECEIVING STIMULATION . IF THIS HAPPENS , THE STIMULATION LEVEL IS TOO HIGH AND YOU NEED TO GO BACK TO THE PREVIOUS LEVEL AND REPEAT THE PROCESS .**
4. Move up through the Stimulation Levels until your dog reliably responds to the stimulation .
5. If your dog continues to show no response at the highest level of Vibration or Static Shock , check the fit of the Receiver . If your dog has long or thick hair , contact our Customer Care Center to obtain a longer set of Contact Points . Then go back to # 1 and repeat the process . If this still does not yield any results , your dog's . hair will need to be trimmed around the Contact Points . If after completing all of these steps , your dog still does not indicate he is feeling the stimulation , please contact our customer service .

How to Maximize the distance?

Terrain, weather, vegetation, transmission from other radio devices, and other factors will affect the maximum range.

Hold the Remote Transmitter in a horizontal position away from your body to achieve optimum range. For maximum signal strength, keep the device properly charged.

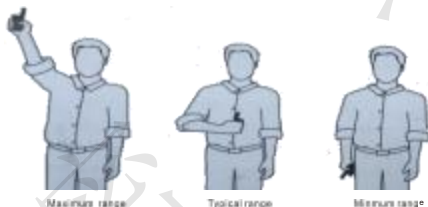

*Avoid touching the antenna or the range may decrease substantially.

XI. Frequently Asked Questions

Q: Is the Stimulation safe for my dog?

A: While the Stimulation is unpleasant, it is harmless to your dog. Electronic training devices require interaction and training from the owner to achieve desired results.

Q: How old does my dog have to be before using the Dog Training Mode?

A: Your dog should be able to recognize basic obedience commands such as "Sit" or "Stay". Dogs should be at least 6 months old before using the Trainer.

Q: Once my dog is trained and has been obeying my commands, will he have to continue to wear the Receiver/Bark Control Collar?

A: Probably not. You may need to reinforce training with the Receiver/Bark Control Collar from time to time.

Q: Is the Receiver/Bark Control Collar waterproof?

A: Yes. The Receiver/Bark Control Collar meets the IP67 waterproof rating, but make sure to keep the area dry when charging.

Note: Remote Transmitter is not waterproof.

Q: Will I get a maximum range with the Dog Training Mode?

A: The range of the Dog Training Mode will vary according to terrain, weather, vegetation, as well as transmission from other radio devices. See "How to Maximize the Distance" on page 19 for tips on maximizing your range.

Q: How long can I continuously deliver stimulation to my dog?

A: The maximum amount of time you can press the Warning Tone/Vibration /Shock button and deliver stimulation to your dog continuously is 10 seconds. After this, the Remote Transmitter will time out, and these stimulation buttons must be released and pressed again.

Q: Why doesn't the product work when the dog barks?

A: Please first ensure to fit the product snugly, yet loose enough to allow one finger to fit between the strap and your pet's neck. Some dogs have weak barking, and in this case, you will need to level up the sensitivity level. A thick coat on the neck area may also have a small chance to decrease the sensing from the barking. Please trim the coat near the area where you place the product.

Q: Why is the product triggered sometimes in a noisy environment though the dog isn't barking?

A: Though we have optimized the barking detection to the best, some environment noises may have a similar frequency to barking, which may have a small chance to activate the product. Please lower the sensitivity level.

Q: Can I use the product when other dogs are playing around?

A: Dogs will bark when playing and get excited. For the comfort and safety of your pet, we don't suggest using this product in such an environment.

Q: How do I know if I can use this product for my dog?

A: The product is designed for healthy dogs over 6 months old. Most importantly, this product cannot be used on unhealthy or aggressive dogs, and if you are unsure whether this product is appropriate for your pet, please consult your veterinarian or a certified trainer.

Q: Can this product stop my dog's howl?

A: No, this Bark Control Collar is designed to detect the barking only. It cannot detect or stop the howling.

Q: Can I charge this product with any type of charger?

A: No, you are suggested to charge this product with a charger of 5V output voltage, because a charger with an output voltage over 5V may cause damage to the product. The product will stop charging automatically if the input voltage becomes too high and deliver a warning tone.

Q: Will my dog stop barking completely?

A: The Bark Control Collar effectively and humanely stops all barking when it is worn. It should only be worn during periods of unwanted barking.

Q: Is the Bark Control Collar safe and humane?

A: Yes. The Bark Control Collar is designed to get your dog's attention, not to punish him. However, the initial Static Shock correction may startle your dog.

XII. Trouble Shooting

1. My dog does not respond when I press a button.

- Make sure the Receiver/Bark Control Collar has been turned on.
- If your range has reduced from the first time you used the Dog Training Collar Mode, the battery(-ies) may be low in either the Remote Transmitter or Receiver/Bark Control Collar.
- Many factors can impact the amount of range. For a list of these factors, see "How to Maximize the Distance" on page 19.
- Test the Receiver/Bark Control Collar with the Test Bulb.

NOTE: If the Test Bulb does not flash , recharge the Receiver/Bark Control Collar and re-test . If the Test Bulb Tool still does not flash , please contact our customer service .

- Increase the Stimulation Level. Refer to "find your dog's Recognition Level" on page 18 for more information .
- Make sure the Receiver/Bark Control Collar's Metal Prongs are placed snugly against your dog's skin . Refer to "Fitting the Receiver/Bark Control Collar" on page 15 for more information .

2.The Receiver/Bark Control Collar will not turn on .

- Make sure the Receiver/Bark Control Collar has been charged. For the initial charge , be sure to charge it for 4 hours . Subsequent charges only take 2-3 hours .

3.The Receiver/Bark Control Collar is not responding to the Remote Transmitter.

- Verify the Receiver/Bark Control Collar is on .
- If the indicator is blinking rapidly, fully charge the Receiver/Bark Control Collar.
- If the first two solutions did not resolve your problems , please check the "Pairing Up" section .

XIII. FCC Statement

USA

This device complies with part 15 of the FCC Rules . Operation is subject to the following two conditions: (1) This device may not cause harmful interference , and (2) this device must accept any interference received , including interference that may cause undesired operation .

NOTE:

This equipment has been tested and found to comply with the limits for a Class B digital device , pursuant to part 15 of the FCC Rules . These limits are designed to provide reasonable protection against harmful interference in a residential installation . This equipment generates , uses , and can radiate radio frequency energy and , if not installed and used in accordance with the instructions , may cause harmful interference to radio communications .

However, there is no guarantee that interference will not occur in a specific installation . If interference does occur to radio or television reception , which can be determined by turning the equipment off and on , the user is encouraged to try to correct the interference by one or more of the following measures :

- Reorient or relocate the receiving antenna .
- Increase the separation between the equipment and the receiver.
- Connect the equipment to an outlet on a circuit different from that to which the receiver is connected.
- Consult customer care , the dealer, or an experienced radio/TV technician for help

Model: OTB3
Made in China
Version: V1.0

FCC Warning Statement: Changes or modifications to this unit not expressly approved by the party responsible for compliance could void the user's authority to operate the equipment. This equipment has been tested and found to comply with the limits for a Class B digital device, pursuant to Part 15 of the FCC Rules. These limits are designed to provide reasonable protection against harmful interference in a residential installation. This equipment generates, uses and can radiate radio frequency energy and, if not installed and used in accordance with the instructions, may cause harmful interference to radio communications.

However, there is no guarantee that interference will not occur in a particular installation. If this equipment does cause harmful interference to radio or television reception, which can be determined by turning the equipment off and on, the user is encouraged to try to correct the interference by one or more of the following measures:

- Reorient or relocate the receiving antenna.
- Increase the separation between the equipment and receiver.
- Connect the equipment into an outlet on a circuit different from that to which the receiver is connected.
- Consult the dealer or an experienced radio/TV technician for help.

This device complies with Part 15 of the FCC Rules. Operation is subject to the following two conditions: (1) this device may not cause harmful interference, and (2) this device must accept any interference received, including interference that may cause undesired operation.

FCC Radiation Exposure Statement

The device has been evaluated to meet general RF exposure requirement. The device can be used in portable exposure condition without restriction.