

# LED Ceiling Light

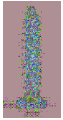

Tapping Screws X 4

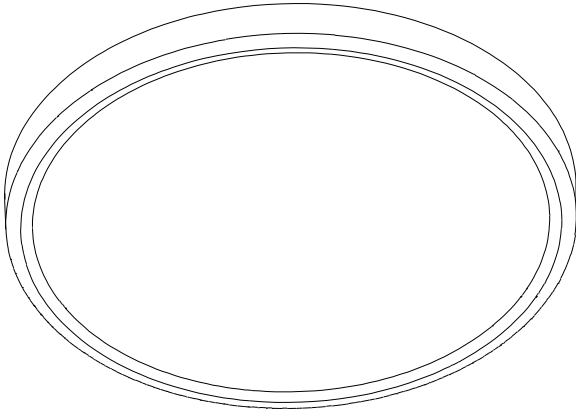

Flat Head Screws X 4



Anchorings X 4



Wire Nuts X 4

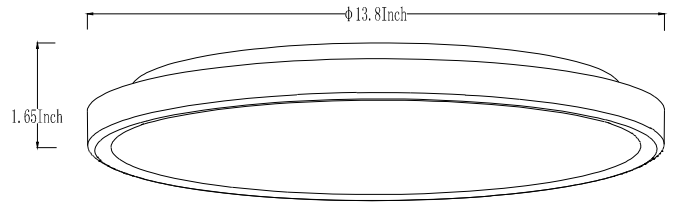

## Product Parameters

- ◆ Size:  $\phi 13.8 \times 1.65$  inch
- ◆ Input Voltage: AC 100V-277V 50/60HZ
- ◆ Working Temperature:  $-20^{\circ}\text{C}$ - $45^{\circ}\text{C}$
- ◆ Beam Angle:  $160^{\circ}$

If any problem when you install, send us email to:  
[serviceled@hotmail.com](mailto:serviceled@hotmail.com)



Warning

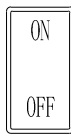

ON-OFF Switch

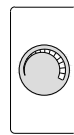

Dimmer Switch

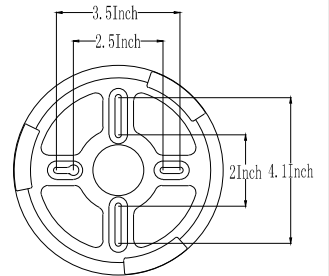
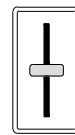

## Installation Instructions

### ① Secure base plate

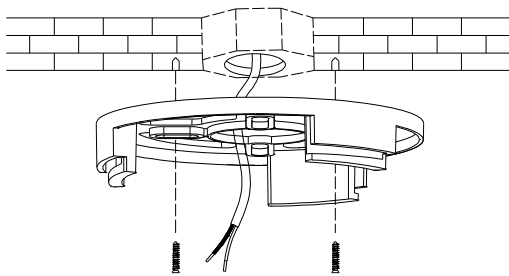

- a . Use tapping screws and Anchors for solid ceiling
- b . Use flat head screws for junction box

### ② Connect the AC cables , L /N

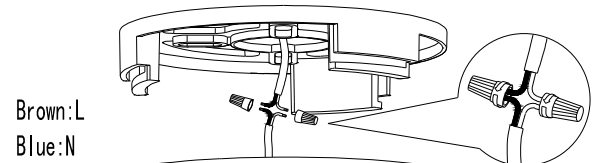

Lamp is made of insulating plastic ,so no need for ground wire

### ③ Push Wire Nuts upwards

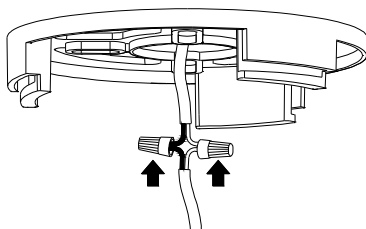

### ④ Rotating Lamp

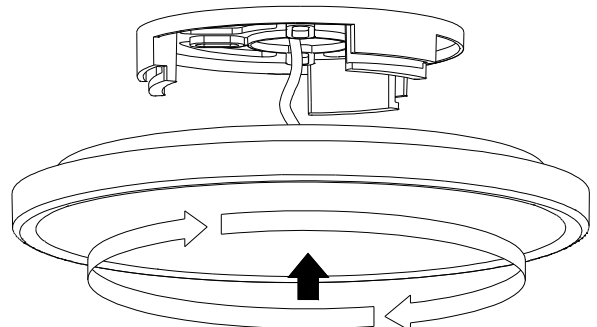

Rotate the lamp clockwise and install onto base plate ,then finish installation !

## Operating Guidance

1. Search "TuYa" at App store and install the APP (Or Scan the following QR code by your phone)
2. Log in your TuYa App (Please sign up when use at first time)



3. Click "Add device".  
Select Device "Lighting > Light Source > Light Source (Wi-Fi)"

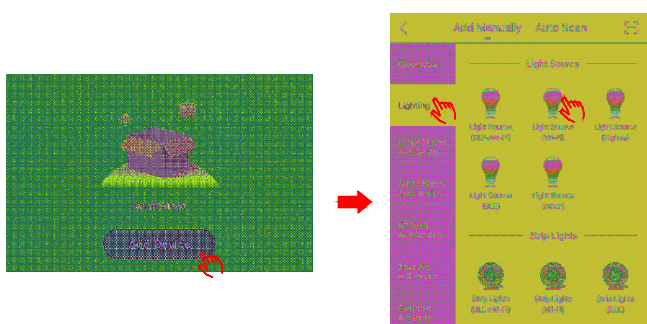

4. Firstly, ensure it in state of light off, cycle lights on/off 2 times, then turn on the light, it will start blinking. (When you turn on the light, if it's blinking fast, skip the reset step)

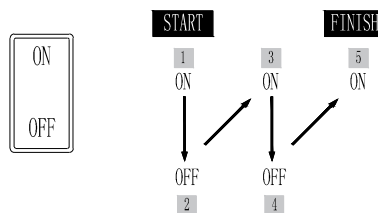

5. Confirm the lamp is blinking and connect to the 2.4g Wi-Fi

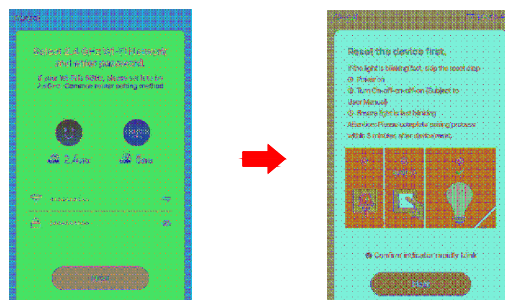

6. Click "device" into the control panel.



## How to control the light by several mobile phones at the same time?

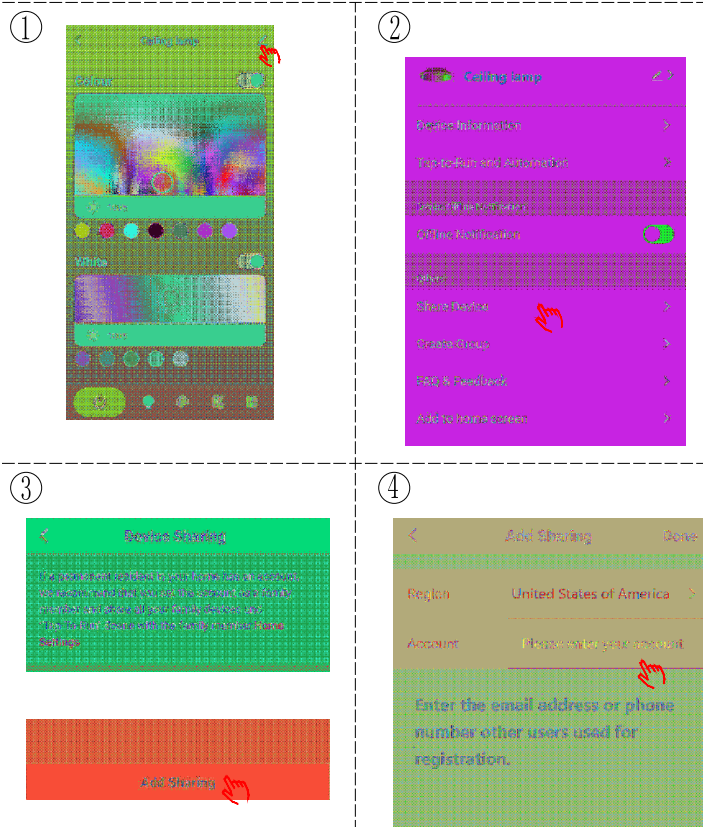
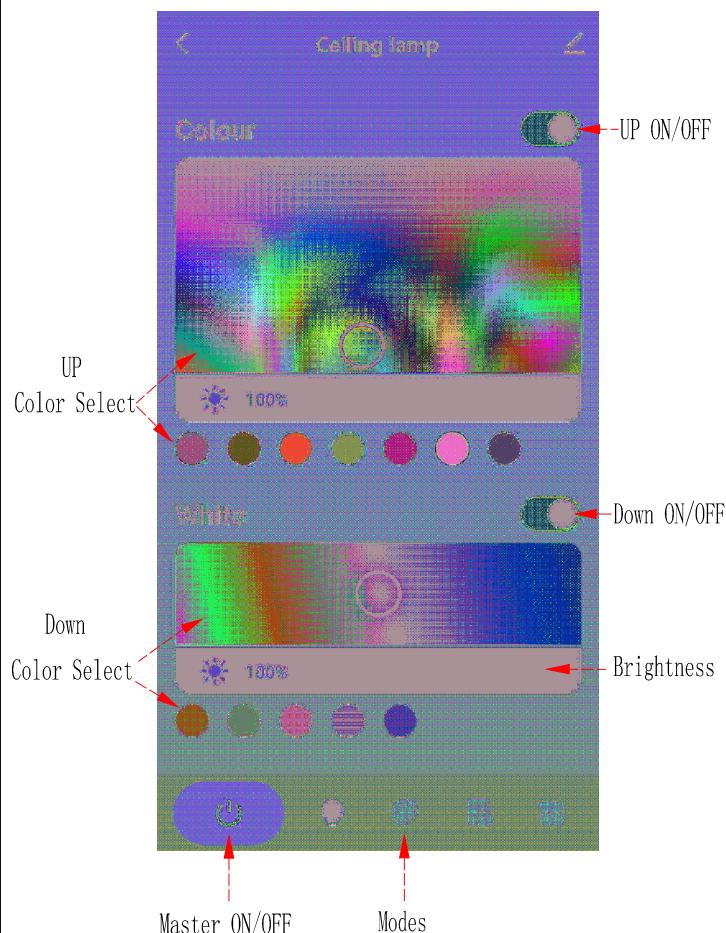

**FCC Warning**

This device complies with part 15 of the FCC rules. Operation is subject to the following two conditions: (1) this device may not cause harmful interference, and (2) this device must accept any interference received, including interference that may cause undesired operation.

Changes or modifications not expressly approved by the party responsible for compliance could void the user's authority to operate the equipment.

NOTE: This equipment has been tested and found to comply with the limits for a Class B digital device, pursuant to part 15 of the FCC Rules. These limits are designed to provide reasonable protection against harmful interference in a residential installation. This equipment generates uses and can radiate radio frequency energy and, if not installed and used in accordance with the instructions, may cause harmful interference to radio communications. However, there is no guarantee that interference will not occur in a particular installation. If this equipment does cause harmful interference to radio or television reception, which can be determined by turning the equipment off and on, the user is encouraged to try to correct the interference by one or more of the following measures:

-Reorient or relocate the receiving antenna.

- Increase the separation between the equipment and receiver.
- Connect the equipment into an outlet on a circuit different from that to which the receiver is connected.
- Consult the dealer or an experienced radio/TV technician for help.

**Radiation Exposure Statement**

To comply with FCC RF exposure compliance requirements, this grant is applicable to only mobile configurations. The antennas used for this transmitter must be installed to provide a separation distance of at least 20cm from all persons and must not be co-located or operating in conjunction with any other antenna or transmitter.