

DELTA♥CHILDREN

AERO SMARTSLEEP AUTO-GLIDE BASSINET

With Stay-Flat™ Autoglide Technology

INSTRUCTION MANUAL

ADULT ASSEMBLY REQUIRED

STYLES AND COLORS MAY VARY

25367



⚠ WARNING: CHOKING HAZARD

Adult assembly required because of small parts. Keep assembly parts out of reach of children under 3 years.

Read all instructions BEFORE assembly and USE of product
KEEP INSTRUCTIONS FOR FUTURE USE.

Consumer Information



WARNING

Failure to follow these warnings and instructions could result in serious injury or death.

- **Read all instructions before assembling unit.**

KEEP INSTRUCTIONS FOR FUTURE USE.

DO NOT USE THIS UNIT IF THE INSTRUCTIONS CANNOT BE STRICTLY FOLLOWED.

- Before each usage or assembly, inspect unit for damaged hardware, loose joints, missing parts or sharp edges. NEVER use this product if there are any loose or missing fasteners, loose joints, broken parts, or torn mesh/fabric. Check before assembly and periodically during use. Contact Delta Children's Products Customer Service Department at gcs@deltachildren.com for replacement parts, repair or instructions.
- **DO NOT** substitute parts.
- **FALL HAZARD**—To help prevent falls, DO NOT use this product when the infant begins to push up on hands and knees or has reached manufacturer's recommended maximum weight of 30lbs. (6.8kg), whichever comes first.
- Use bassinet with only one child at a time.
- Strings can cause strangulation! DO NOT place items with a string around a child's neck, such as hood strings or pacifier cords. DO NOT suspend strings over a product or attach strings to toys.
- **SUFFOCATION HAZARD:** Infants can suffocate:
 - In gaps between an extra pad and side of the bassinet/cradle.
 - On soft bedding.
- Use ONLY the pad provided by the manufacturer. **NEVER** add a pillow, comforter or another mattress for padding.
- If a sheet is used with the pad, use only the one provided by the manufacturer or one specifically designed to fit the dimensions of the bassinet/cradle.
- To reduce the risk of SIDS, pediatricians recommend healthy infants be placed on their back to sleep, unless otherwise advised by your physician.
- Never use plastic shipping bags or other plastic film as a mattress covers not sold and intended for that purpose. They can cause suffocation.
- **DO NOT** place bassinet near a window where cords from blinds or drapes may strangle a child. Child may fall out of window.
- **DO NOT** place cords, straps or similar items that could become wound around a child's neck in or near the bassinet.

CARE AND MAINTENANCE

- The frame, mattress pad, storage basket, music module may be wiped clean using a mild cleaning solution and a damp cloth. Do not use bleach. Do not use harsh or abrasive cleaners. Rinse clean with water to remove residue. Do not immerse the frame.
- The sheet is machine washable. Wash it separately in cold water on the gentle cycle. Do not use bleach. Tumble dry separately on low heat and remove promptly.
- Always store product in a clean and dry place.
- Before each usage or assembly, inspect unit for damaged hardware, loose joints, missing parts or sharp edges. NEVER use this product if there are any loose or missing fasteners, loose joints, broken parts, or torn mesh/fabric.

WARNING

Failure to follow these warnings and instructions could result in death or serious injury .

SUFFOCATION HAZARD

Infants have suffocated:

- On pillows, comforters and extra padding.
- In gaps between a wrong size mattress (too small or too thick) and product sides.
- **NEVER** add soft bedding or padding.
- Use **ONLY** mattress provided by manufacturer.
- Always place baby on back to sleep to reduce the risk of SIDS and suffocation.
- If a sheet is used with the pad, use only the one provided by the manufacturer or one specifically designed to fit the dimensions of the product mattress.
- Product can roll over on soft surfaces and suffocate child. **NEVER** place product on beds, sofas or other soft surfaces

FALL HAZARD: • To help prevent falls,

- Do not use this product when the infant begins to push up on hands and knees, or has reached 30 lbs. (13.6kg) whichever comes first.
- Always use product on the floor. Never use any elevated surface.
- Do not carry baby in the bassinet

DELTA♥CHILDREN

LIMITED MANUFACTURER WARRANTY

This Delta product is warranted to be free from defects for a period of 90 days from the date of purchase under normal use. This warranty extends only to the original retail purchaser and is valid only when supplied with proof of purchase, or if received as a gift, when the registration is on file with Delta. This limited manufacturer warranty does not cover the following:

- Products purchased as floor models or samples.
- Items purchased on an “as-is” basis, as a second hand product, or as a resale product.
- Items purchased at a Final sale, a “Going out of Business” sale, or a Liquidation sale.

TO REGISTER YOUR PRODUCT for important safety alerts and updates to your product please visit www.deltachildren.com

TO REPORT A PROBLEM, please log on to www.deltachildren.com and click the Consumer Care Tab, or contact us by email at gcs@DeltaChildren.com

Date of Purchase: _____ (you should also keep your receipt)

EXTENDED WARRANTY

DON'T MISS YOUR CHANCE TO BE COVERED FOR ALL OF LIFE'S MISHAPS!

With Delta's Extended Warranty, you're covered for mechanical failure from normal use or if your item stops working due to normal wear and tear, plus all those unexpected surprises.

2 YEARS OF PROTECTION

For Additional Information:

Simply visit our Website, register your product, and add the Extended Warranty

<https://www.deltachildren.com/pages/product-registration>

Extended Warranty only available in the following States: Arkansas, Colorado, Delaware, District of Columbia, Georgia, Idaho, Illinois, Indiana, Iowa, Kansas, Kentucky, Louisiana, Maryland, Michigan, Mississippi, Missouri, Nebraska, Nevada, New Hampshire, New York, North Carolina, North Dakota, Pennsylvania, Rhode Island, South Dakota, Tennessee, Utah, West Virginia

Parts

IMPORTANT! Please remove all parts from the package and identify them before assembly.

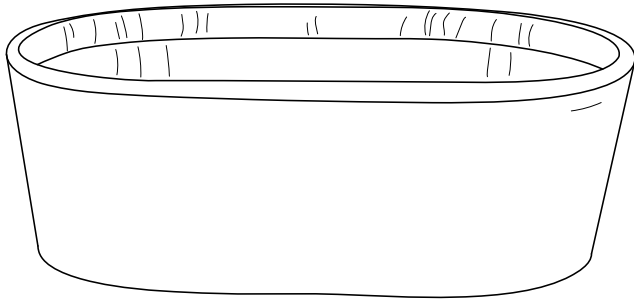

Bassinet

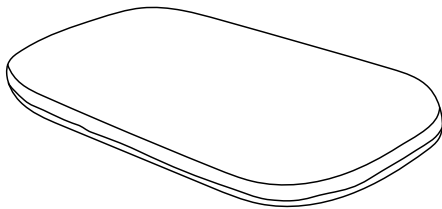

Mattress Pad

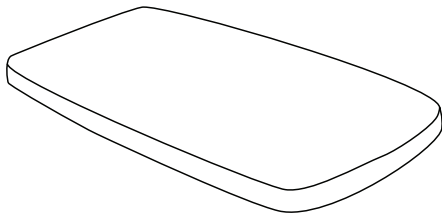

Mattress Support Board

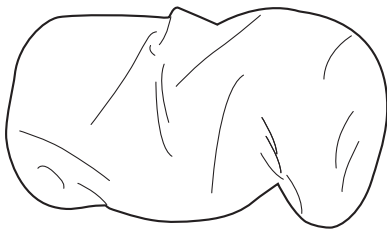

Knit Sheet

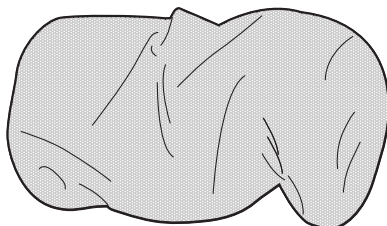

Pure Air 3D Mesh Sheet

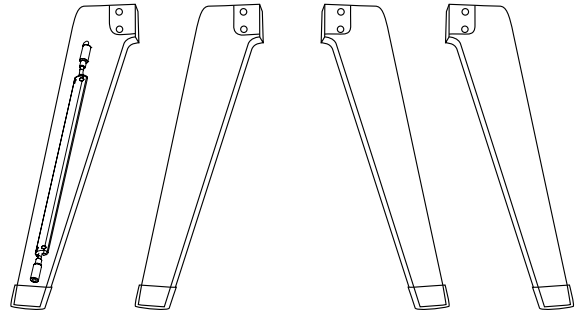

Legs - 4 total:

Left (with power cord connector) x1

Left x1

Right x2

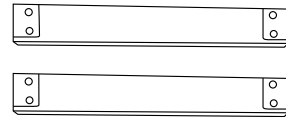

**Center Leg Connector
x2**



Metal Cross Bar - 2

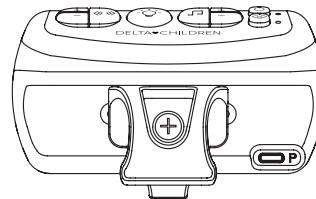

Module

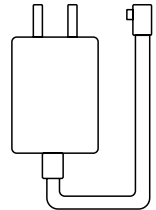

Power Cord Adapter

Hardware Kit

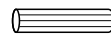

Wood Dowel - 8

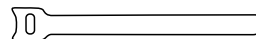

Velcro Strap



M6 x 30mm Bolt - 4



M6 x 16mm Bolt - 16

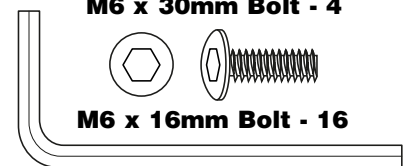

Allen Key

Bassinet Assembly

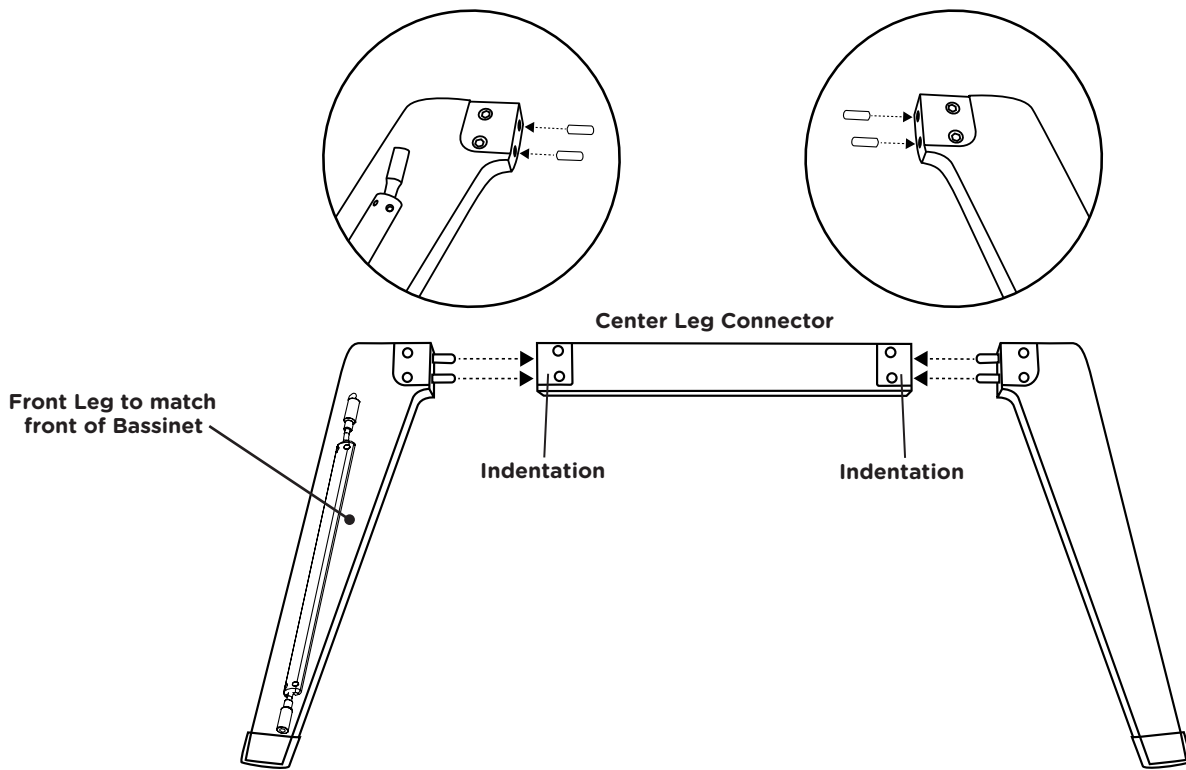

1 **Note:** You may need the help of another adult to help steady all parts for assembly.

- Insert wood dowels into left (with power cord connector) and right legs as shown above.
- Note the orientation of the Center Leg Connector before assembling. The open portion of the indentation should face up.
- Insert Left and Right Legs into Center Leg Connector to create Frame Leg 1.

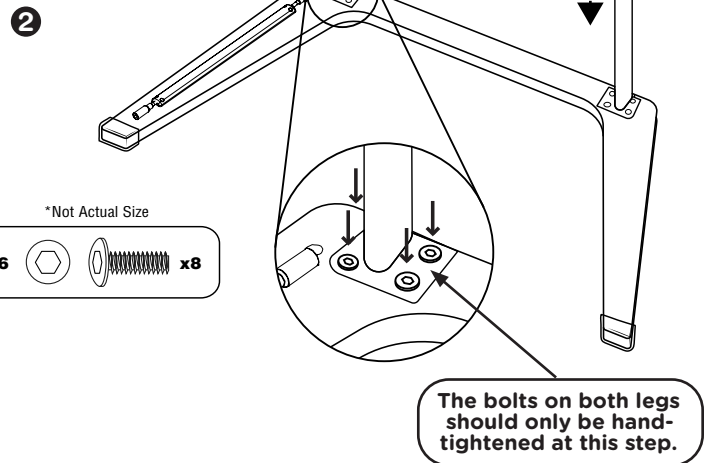
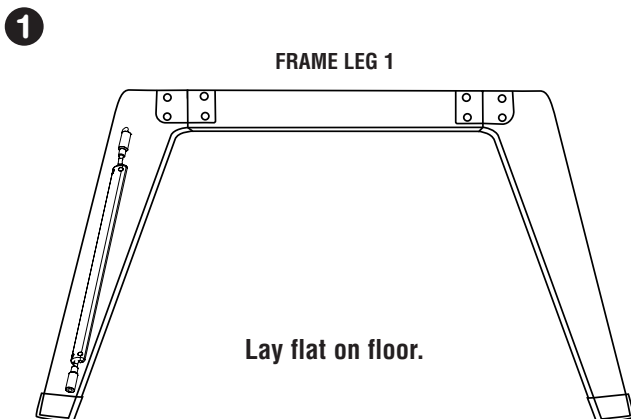

- 2**
- **1** Lay assembled Frame Leg 1 flat onto floor.
 - Line up the first metal cross bar with the shape of the indentation. The “Facing Inward” sticker should face inward.
 - **2** Insert (4) M6 x 16mm bolts and hand-tighten so that the assembled Leg has a little room to wiggle.
 - Repeat for remaining metal cross bar. Ensure all bolts are mostly screwed in, but not tight. They will be fully tightened later.

Bassinet Assembly

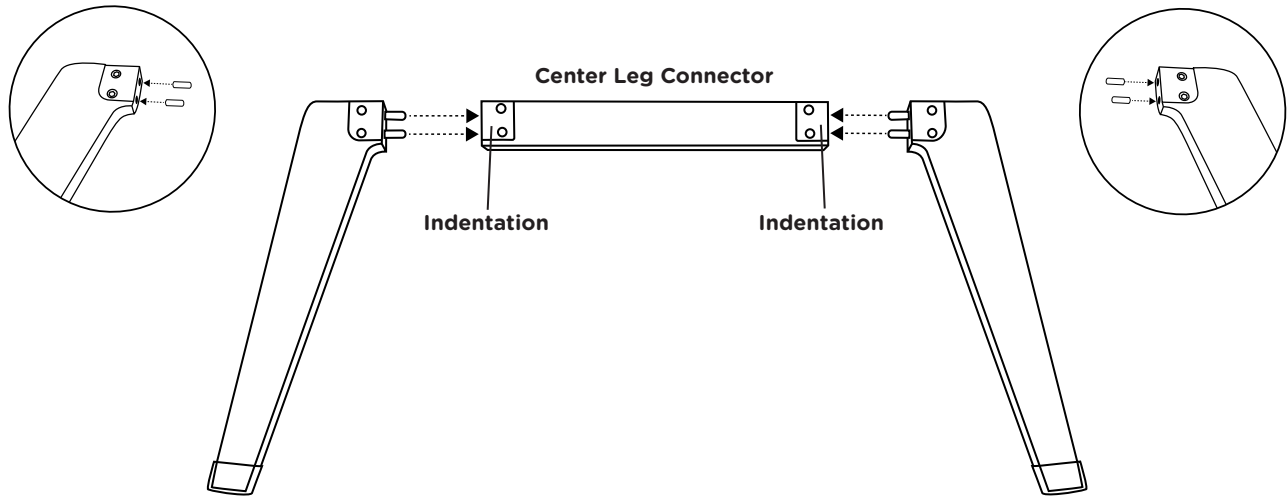

- 3**
- Insert wood dowels into left and right legs as shown above.
 - Note the orientation of the Center Leg Connector before assembling. The open portion of the indentation should face up.
 - Insert Left and Right Legs into Center Leg Connector to create Frame Leg 2.

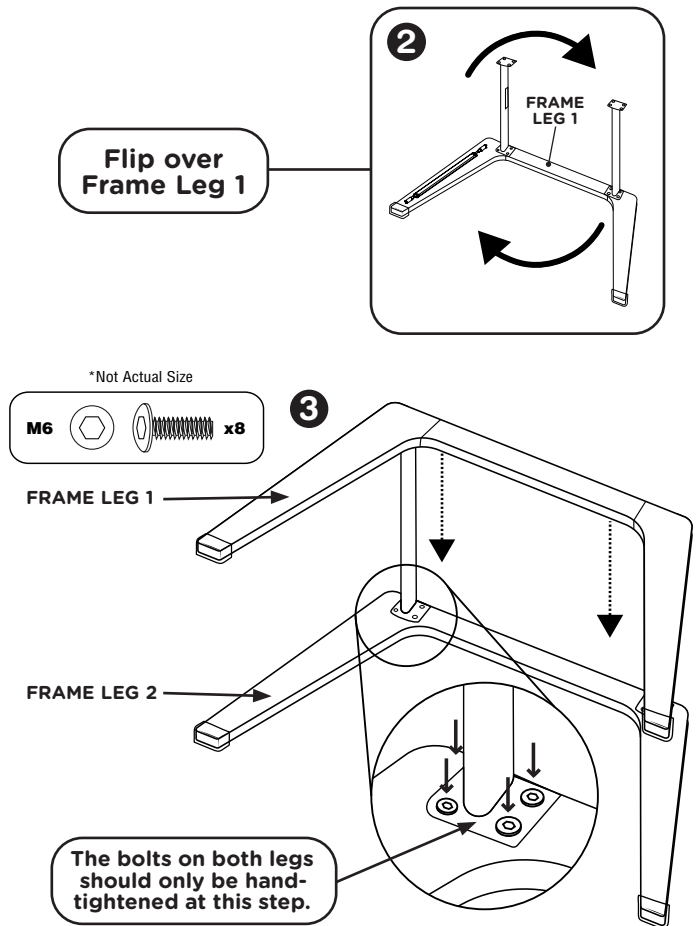
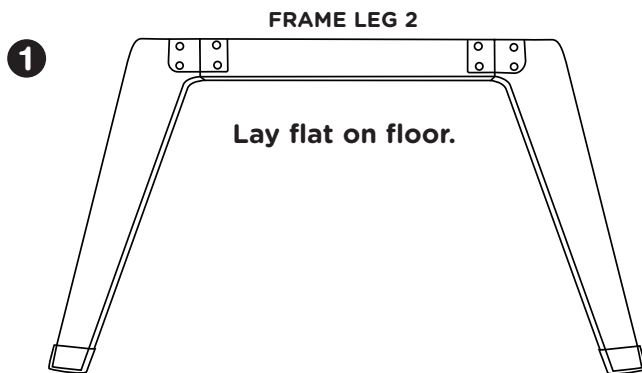

- 4**
- **1** Lay assembled Frame Leg 2 onto floor.
 - **2** Flip over Frame Leg 1 from step 2 so that metal cross bars are facing down.
 - Line up the metal cross bars on Frame Leg 1 with the shapes of the indentations in Frame Leg 2 .
 - **3** Insert (4) M6 x 16mm bolts and hand-tighten so that the assembled Leg has a little room to wiggle.
 - Repeat for remaining metal cross bar. Ensure all bolts are mostly screwed in but not tight, they will be fully tightened in the next step.

Bassinet Assembly

Once Leg Frame is assembled, use the included Allen key to fully tighten all 16 bolts (4 per leg) holding the Legs to the Center Leg Connectors- **DO NOT OVERTIGHTEN**

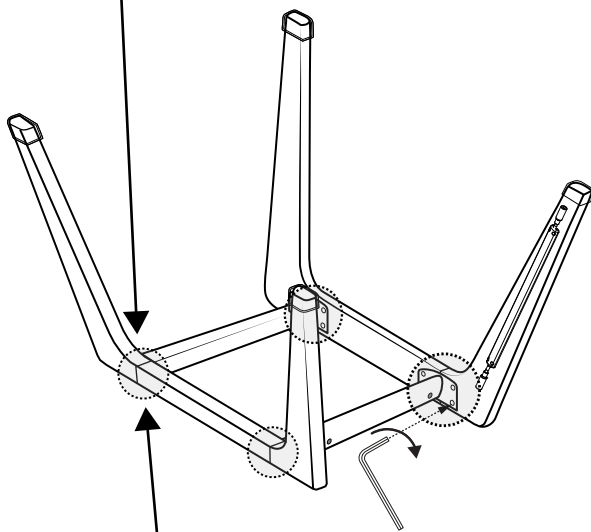

While tightening the Leg Bolts, make sure the Legs align with the Center Leg Connector. Small gaps between parts are OK. See below examples:

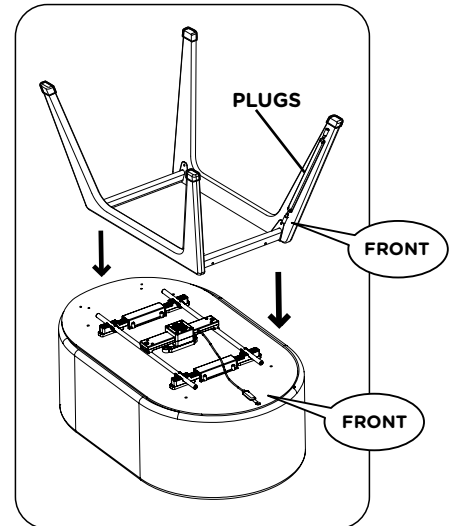

*Not Actual Size

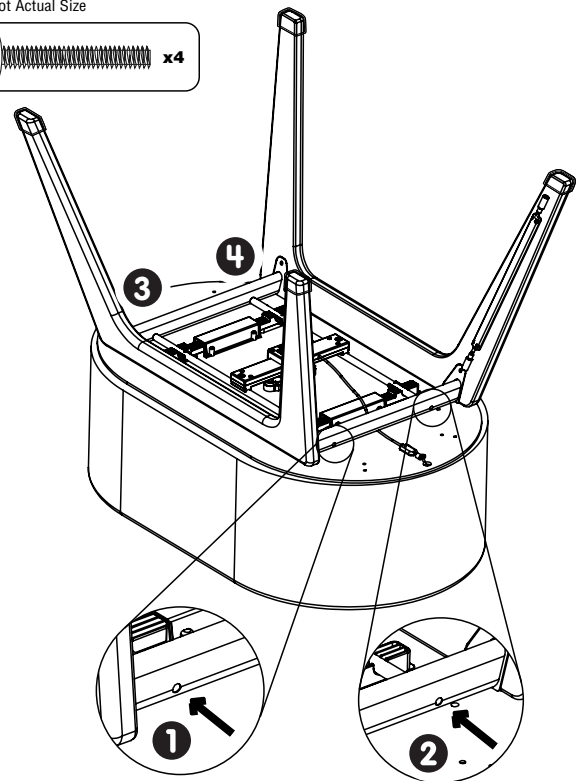
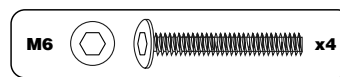

5

- While ensuring that each leg is aligned with the Center Leg Connectors, tighten all bolts holding Leg Frame together. Small gaps between parts are OK. There are 16 bolts in total-4 per leg. **Do not overtighten.**

6

Note: Ensure the Wooden Left Leg (with Power Cord Connector) is located at the front of the bassinet.

- Place the bassinet on a flat surface with the bottom cross tubes facing up.
- Align the fully assembled base to the bassinet cross tubes, noting the location of the bolt holes.
- Insert the M6 bolt to the cross bar and tighten with the allen key included. **1**
- Insert the other M6 bolt and tighten with the allen key included. **2**
- Repeat on the other side. **3 4**
- Check to be sure the support is secure.

Bassinet Assembly

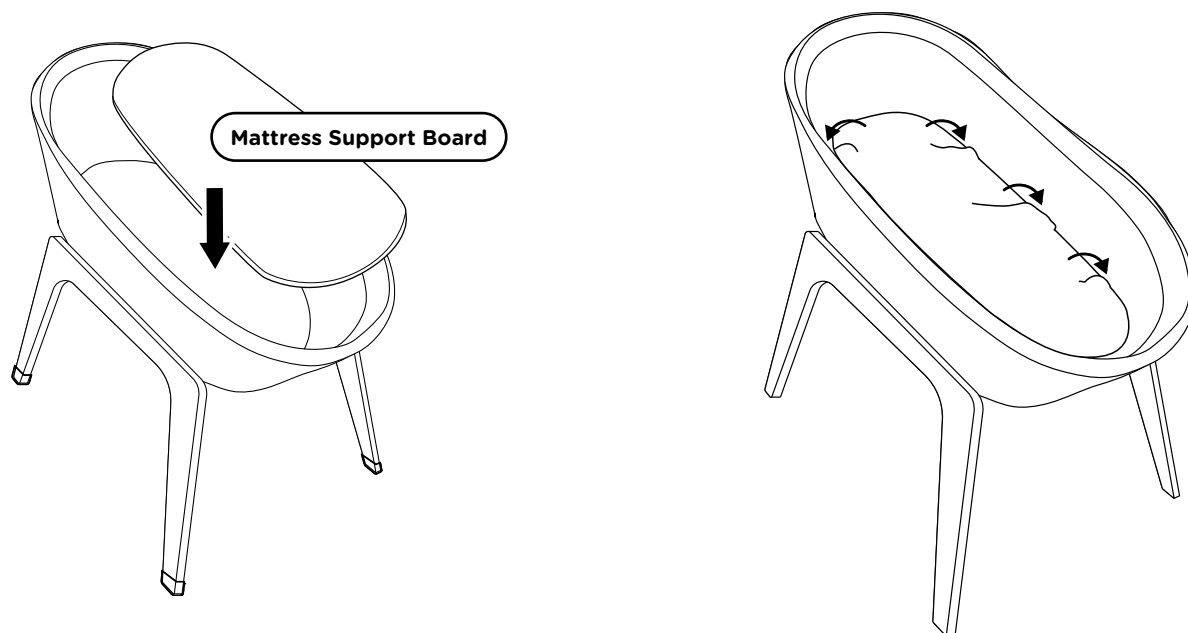

- 7**
- Place the Mattress Support board into the bassinet. (Optional)
 - When using Mattress Support board, tuck any excess fabric material down underneath board.

NOTE: If needed, remove the Mattress Support Board to increase Autoglide speed.

Choose a sheet option

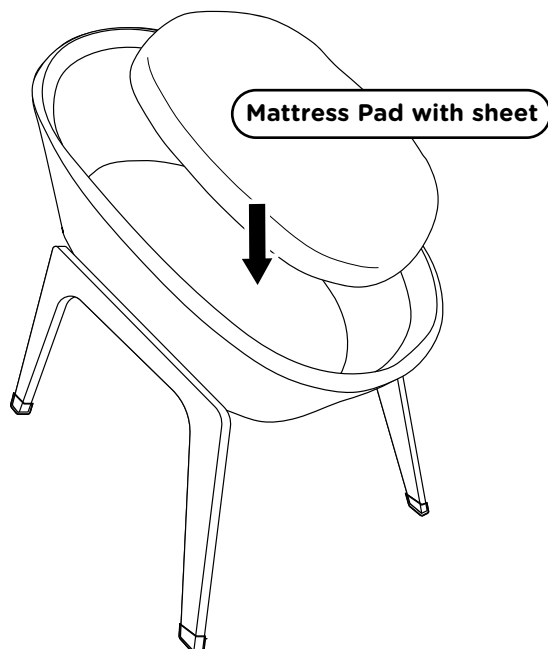
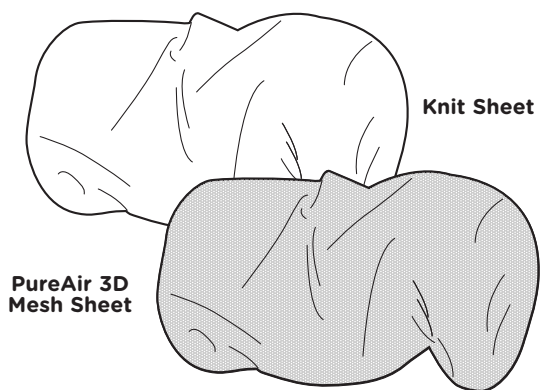

- 8**
- Choose either the Knit Sheet or the PureAir 3D Mesh Sheet
 - Place the sheet over the mattress pad.
 - Place the mattress pad with sheet into the bassinet.



WARNING

Read all instructions BEFORE assembly and USE of product. KEEP INSTRUCTIONS FOR FUTURE USE.

CAUTION - This device complies with Part 15 of the FCC Rules. Operation is subject to the following two conditions: (1) this device may not cause harmful interference. (2) this device must accept any interference received, including interference that may cause undesired operation. Changes or modifications not expressly approved by the party responsible for compliance could void the user's authority to operate the equipment.

NOTE: This equipment has been tested and found to comply with the limits for a Class B digital device, pursuant to part 15 of the FCC Rules. These limits are designed to provide reasonable protection against harmful interference in a residential installation. This equipment generates uses and can radiate radio frequency energy and, if not installed and used in accordance with the instructions, may cause harmful interference to radio communications. However, there is no guarantee that interference will not occur in a particular installation. If this equipment does cause harmful interference to radio or television reception, which can be determined by turning the equipment off and on, the user is encouraged to try to correct the interference by one or more of the following measures:

- Reorient or relocate the receiving antenna.
- Increase the separation between the equipment and receiver.
- Connect the equipment into an outlet on a circuit different from that to which the receiver is connected.
- Consult the dealer or experienced radio/TV technician for help.

MPE Reminder: To satisfy FCC / IC RF exposure requirements, a separation distance of 20 cm or more should be maintained between the antenna of this device and persons during device operation. To ensure compliance, operations at closer than this distance is not recommended.

Installing Module

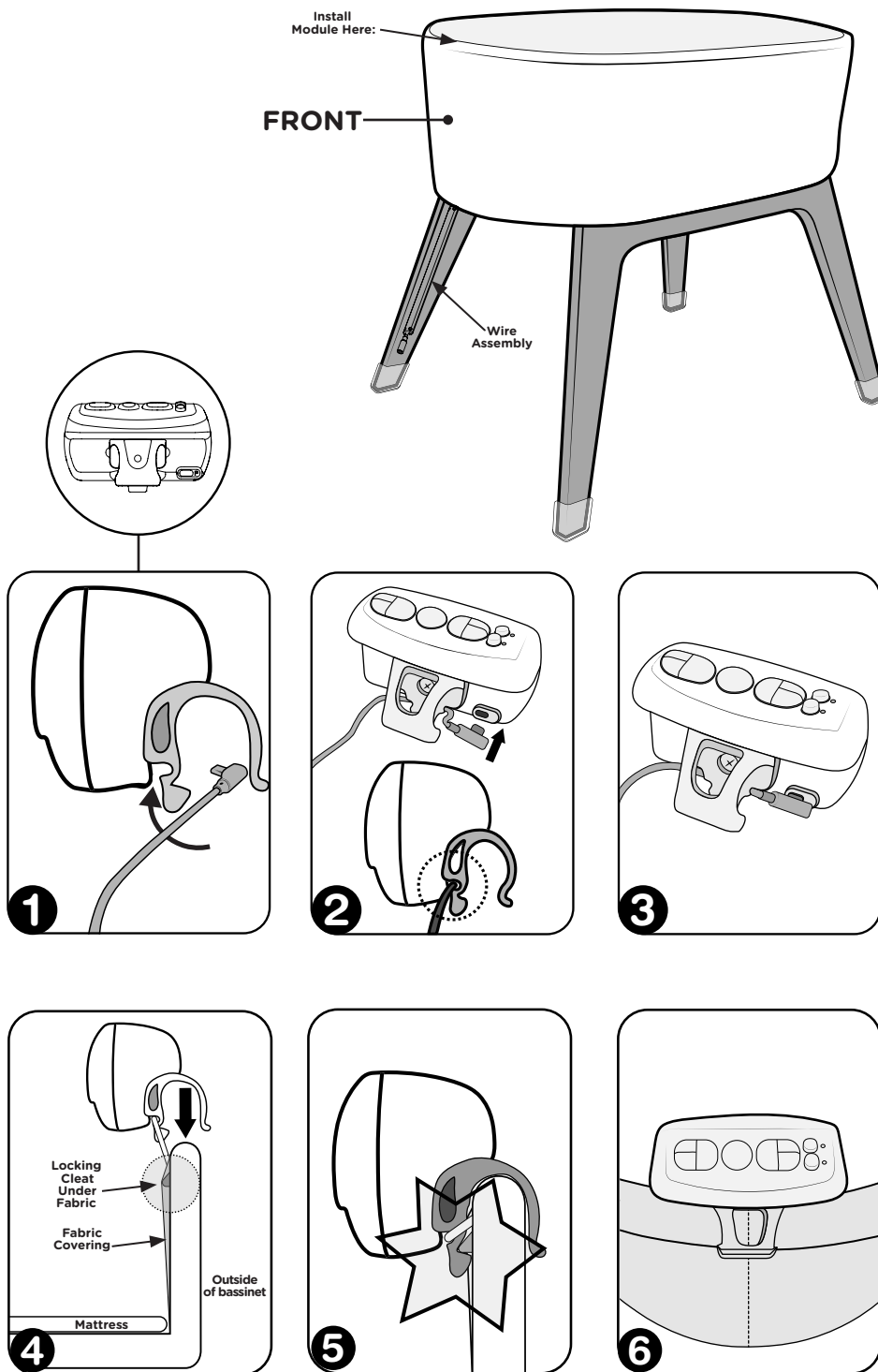

1

- Identify the front of the bassinet, the front has the power cord connector on the inside of the leg.
- Insert the USB Type C wire into the bottom clip as shown. **1**
- Connect the USB Type C wire to the back side of the module and ensure it is fastened in place. **2 3**
- Locate the locking cleat on the FRONT INSIDE of the bassinet. It is hidden under the fabric covering. **4**
- With the buttons facing outward **4**, lower the module down onto the front wall of the bassinet. **5** Ensure the locking clip on the module clicks onto the locking cleat and is securely in place.
- The module should be centered at the front of the bassinet. When centered the seam in the fabric will be visible through the locking clip on the module. **6**

Wire Connection Assembly

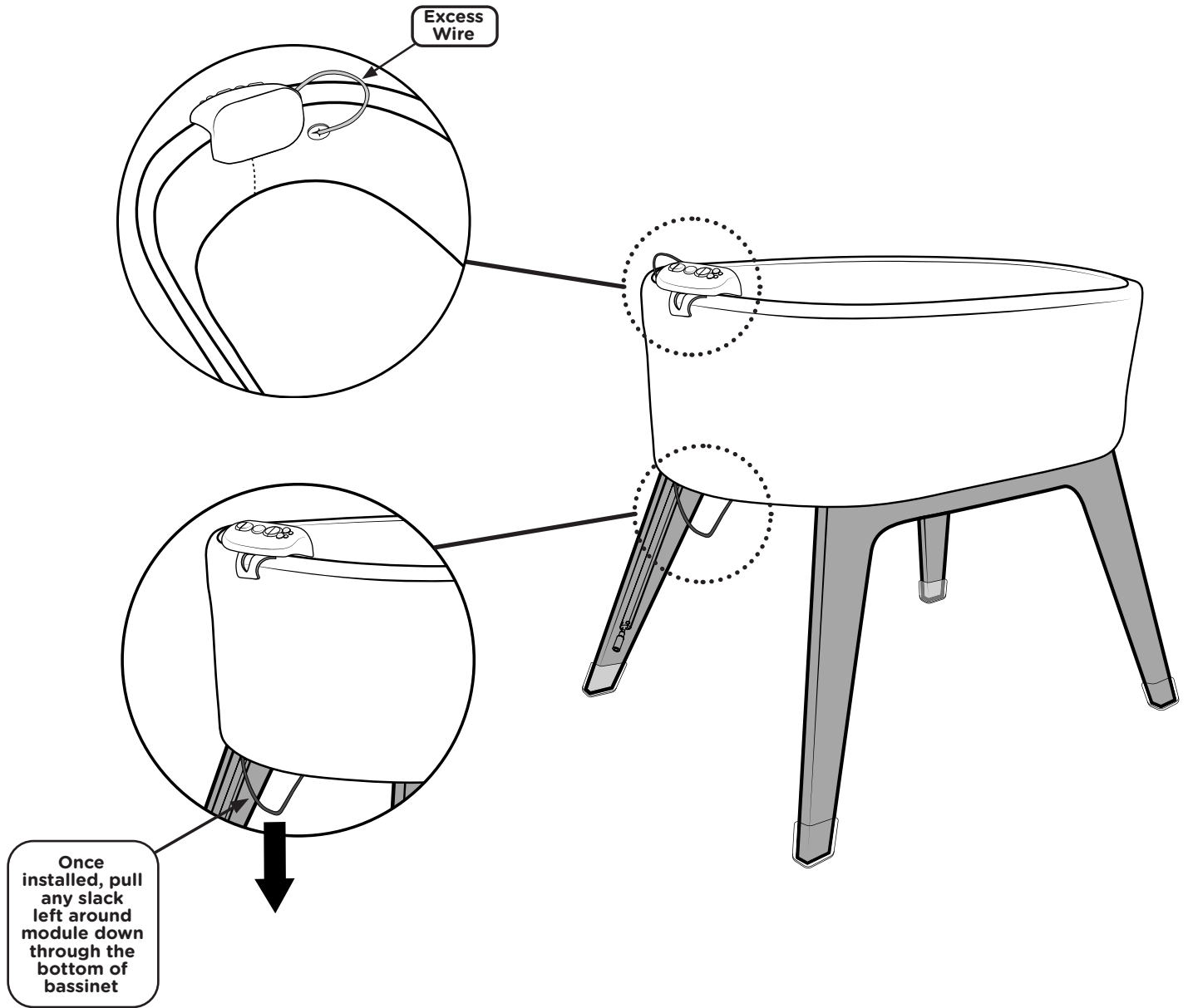

1

- If any excess wire remains between the module and the fabric wall of the bassinet, pull down on wire under bassinet to remove the slack near the module. In the next step you will use the included Velcro Strap to affix extra wire to metal frame under bassinet.

Wire Connection Assembly

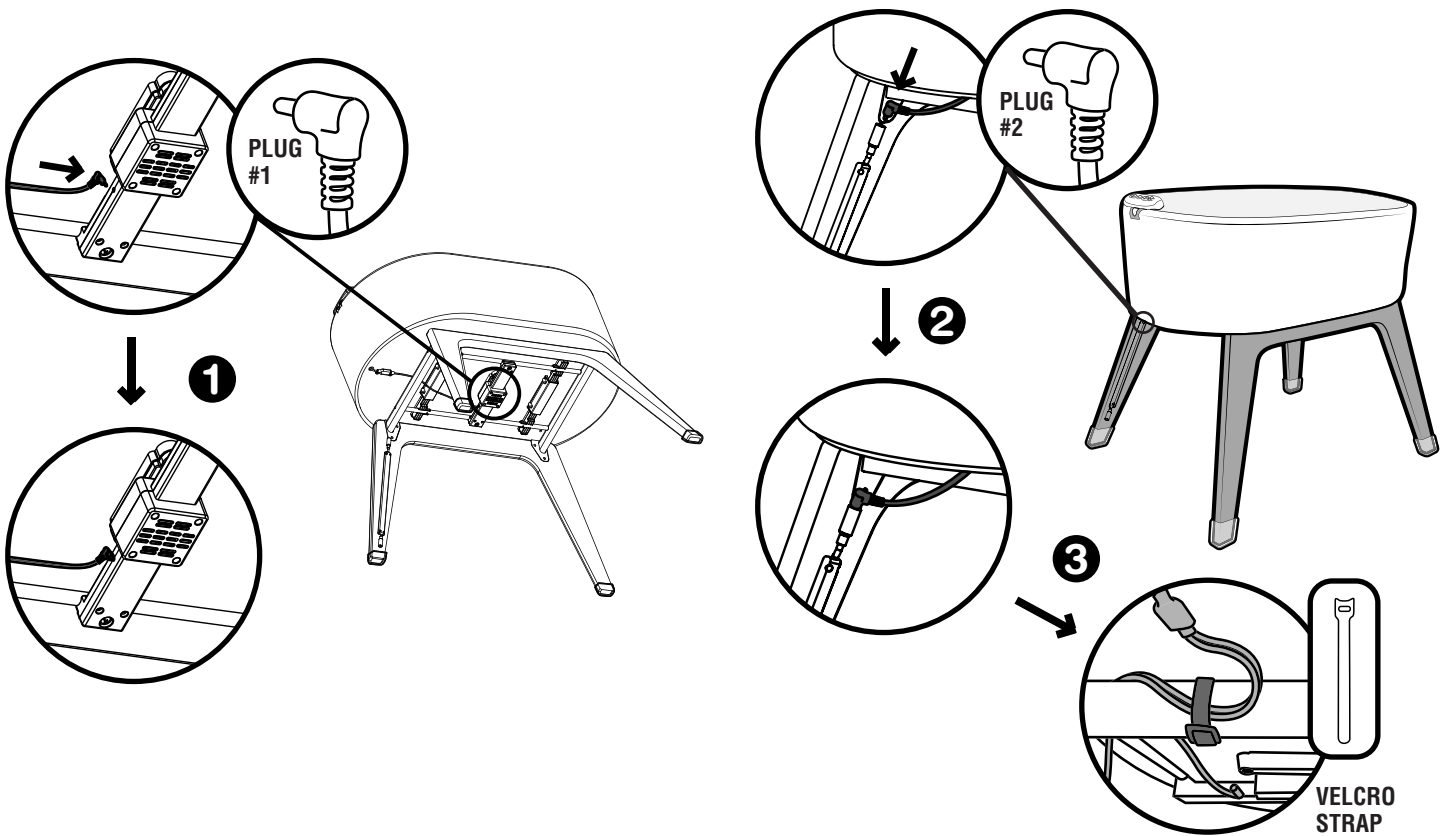

1

- Locate Plug 1 underneath the bassinet and insert it into the auto glide connector. **1**
- Locate Plug 2 and insert it into the top connection point found on the inside of the front left wooden leg. **2**
- Use the Velcro Strap to secure wires to the front bar. (Ensure the wires still have enough space to allow auto glide to move left and right). **3**

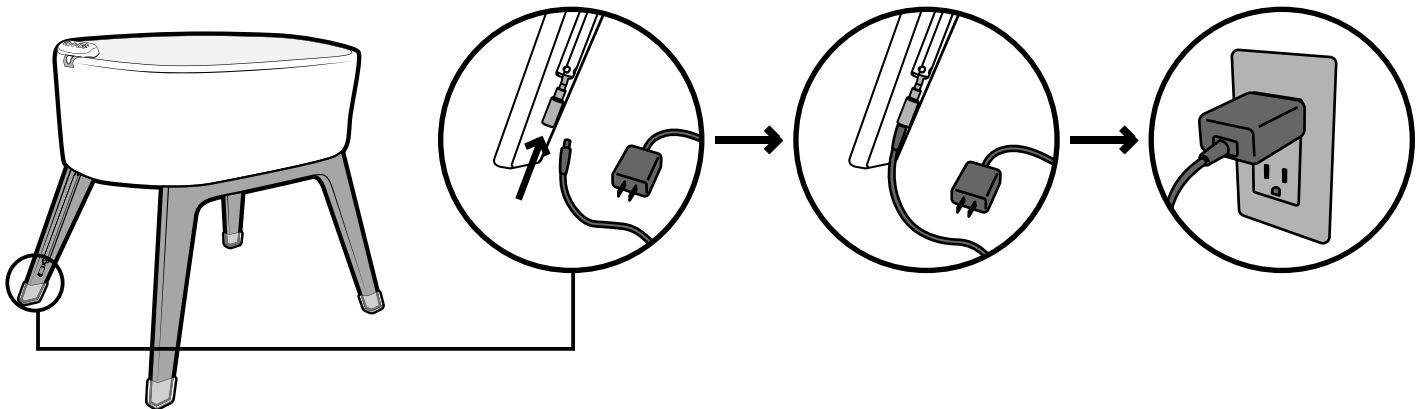

2

- Locate the Power Cord. Insert it to the bottom plug of the Wooden Left Leg.
- Once all plugs are fully connected, locate the nearest wall socket to connect the power.
- When fully charged the green light on the Autoglide assembly will blink.

Music Module Operation

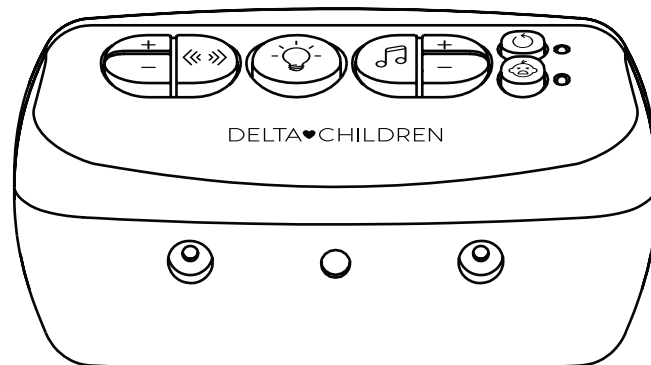
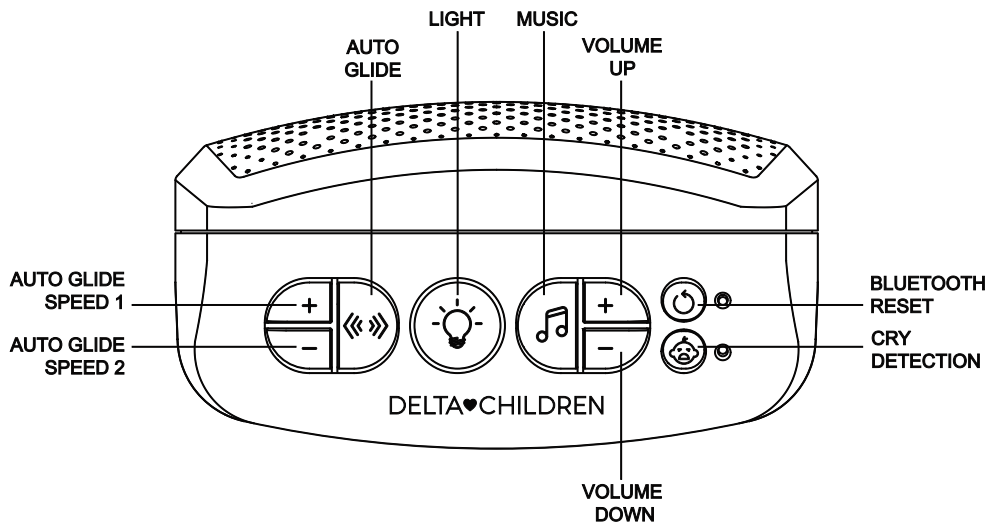

With Stay-Flat™ Autoglide Technology

Press Auto-Glide button  to start 60 minutes cycle of auto glide. Press again to stop Auto-Glide

Note: Auto-Glide speed can be adjusted with PLUS/MINUS buttons on the “top-left” of the music module.

Activate bassinet light by pressing LIGHT button  on the top of the music module.

NOTE: Light will stay on 60 minutes cycles, unless button pressed before 60 minutes are up.

Press MUSIC button  on top of the music module to activate MUSIC.

Press button multiple times to cycle through eight (8) music melodies & white noise.

Volume can be adjusted with PLUS/MINUS buttons on the “top-right” of the music module.

Press Reset button  causes the device to reset; Indicator shows green when on.

Press Cry Detection button turns on  Cry Detection; Indicator shows green when on.

CARE AND MAINTENANCE

- The frame, mattress pad, storage basket, music module may be wiped clean using a mild cleaning solution and a damp cloth. Do not use bleach. Do not use harsh or abrasive cleaners. Rinse clean with water to remove residue. Do not immerse the frame.
- The sheet is machine washable. Wash it separately in cold water on the gentle cycle. Do not use bleach. Tumble dry separately on low heat and remove promptly.
- Always store product in a clean and dry place.
- Before each usage or assembly, inspect unit for damaged hardware, loose joints, missing parts or sharp edges. NEVER use this product if there are any loose or missing fasteners, loose joints, broken parts, or torn mesh/fabric.

DELTA♥CHILDREN

Delta Children's Products Corp.
114 West 26th Street
New York, NY 10001
gcs@DeltaChildren.com
www.DeltaChildren.com

follow us

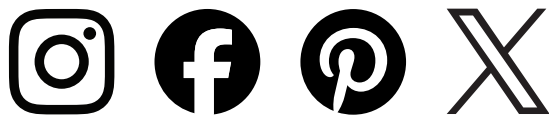

@deltachildren