

# AI Bird Feeder Quick Guide

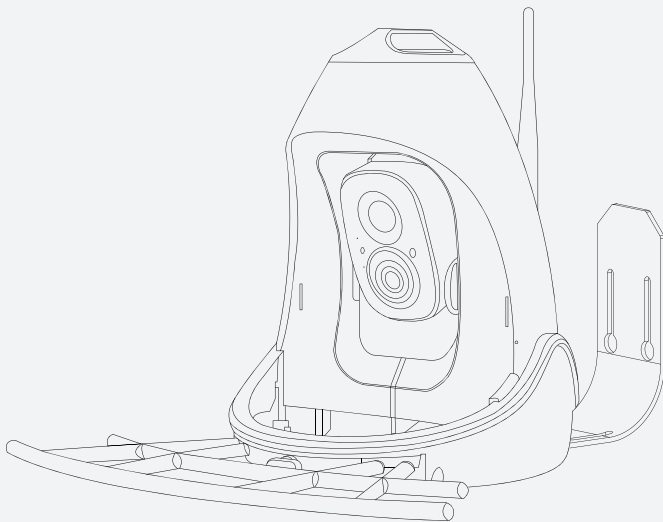

# Warning

**Note:** This equipment has been tested and found to comply with the limits for a Class B digital device, pursuant to part 15 of the FCC Rules. These limits are designed to provide reasonable protection against harmful interference in a residential installation.

This equipment generates uses and can radiate radiofrequency energy and, if not installed and used in accordance with the instructions, may cause harmful interference to radio communications. However, there is no guarantee that interference will not occur in a particular installation.

If this equipment does cause harmful interference to radio or television reception, which can be determined by turning the equipment off and on, the user is encouraged to try to correct the interference by one or more of the following measures:

- Reorient or relocate the receiving antenna.
- Increase the separation between the equipment and receiver.
- Connect the equipment into an outlet on a circuit different from that to which the receiver is connected. Consult the dealer or an experienced radio/TV technician for help.

The antennas used for this transmitter must be installed to provide a separation distance of at least 20 cm from all persons and must not be co-located for operating in conjunction with any other antenna or transmitter.

FCC(USA) 15.9 prohibition against eavesdropping except for the operations of law enforcement officers conducted under lawful authority, no person shall use, either directly or indirectly, a device operated pursuant to the provision of this part for the purpose of overhearing or recording the private conversations of other unless such use is authorized by all of the parties engaging in the conversation. Changes or modifications not expressly approved by the party responsible for compliance could void the user's authority to operate the equipment.

FCCID: 2AY58-V6-WNQ-03

ICCaution:

- English:

This device contains licence-exempt transmitter(s)/receiver(s) that comply with Innovation, Science and Economic Development Canada's licence-exempt RSS(s). Operation is subject to the following two conditions:

This device may not cause interference.

This device must accept any interference, including interference that may cause undesired operation of the device.

CERED This product can be used across EU member states.

# Catalog

1. What's In The Box	P. 1-3
2. Camera Structure	P. 4-5
3. Assemble Bird Feeder	P. 6-8
4. Camera Charging	P. 9
5. How To Turn On & Off The Camera	P. 10
6. Set Up With Vicohome App	P. 11
7. Connection Camera--Bluetooth Mode	P. 12-14
8. Device Sharing	P. 15
9. Get 30 days of free cloud storage	P. 16
10. AI bird Identification	P. 17
11. Bird Feeder Installation	P. 18-32
12. Solar Panel Installation	P. 33-34
13. Cleaning Bird Feeder	P. 35-41
14. How to Add Bird Seed	P. 42-43
15. Status Light & Battery Camera Reset	P. 44
16. Frequently Asked Questions	P. 45

# What's In The Box

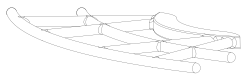

Perch

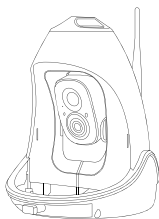

Bird Feeder

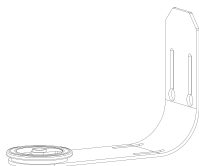

Mounting Bracket

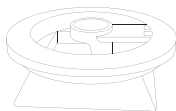

Tripod Adapter

All Bird Feeder Quick Guide



Quick Guide

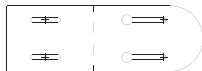

Drilling Template

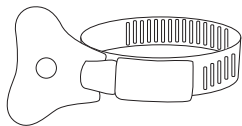

Hose Clip

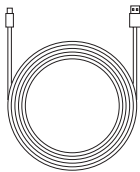

Type C Power Cable

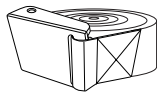

Black Strap



Perch Screw



Mounting Screws



Anchors



Ejector Pin

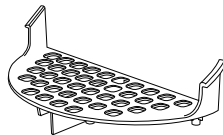

Squirrel Barrier

# Functional Accessory

## What's in the box

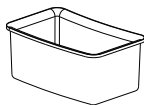

Water box \*1

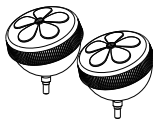

Hummingbird Honey Box \*2

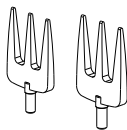

Fruit fork \*2

## How to installation

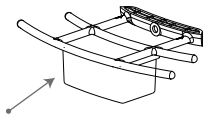

Put the water box in correct place

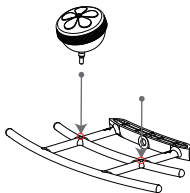

Insert honey box in the hole to fix it

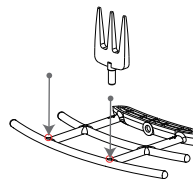

Insert fruit fork and make it secure

# Camera Structure

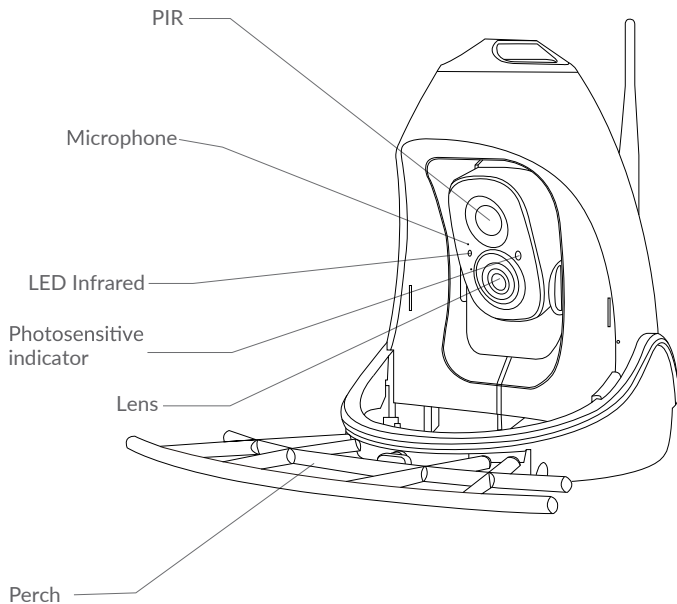



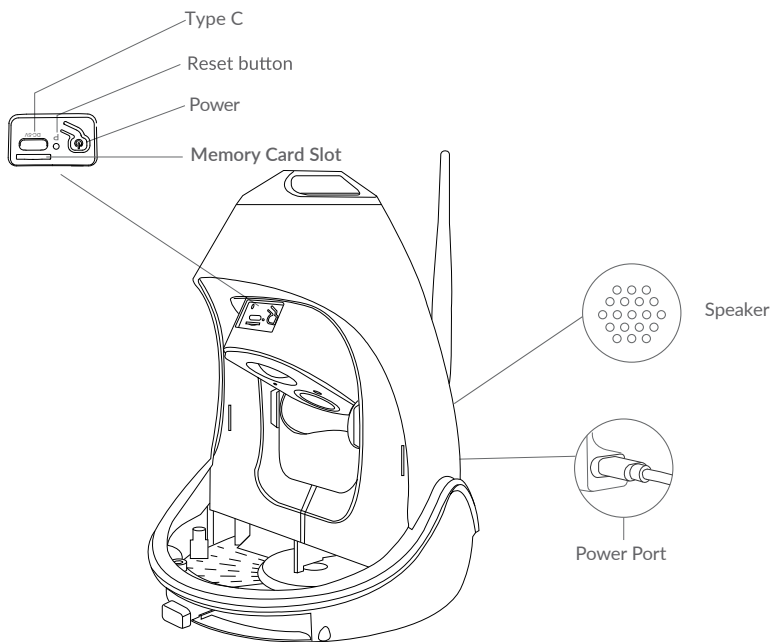

# Assemble Bird Feeder

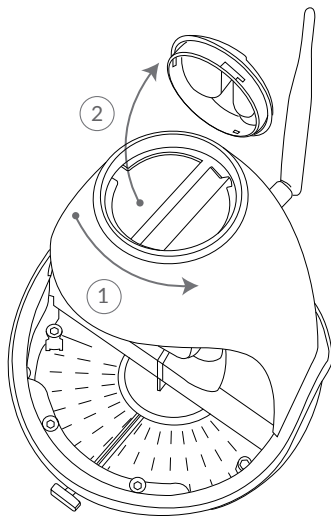

## Open the Bird Feeder

Step 1: Place your finger on the buckle and rotate counterclockwise.

Step 2: Open the top cover upwards, you can add birdseed.

## Assemble Perch

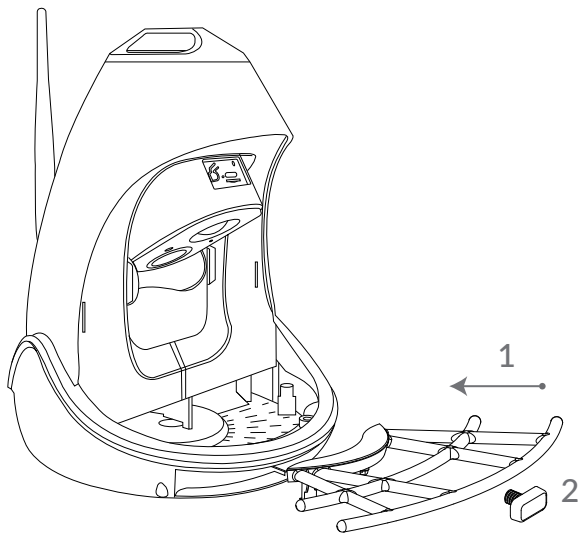

Step1:Use the provided perch and push in parallel from the side.

Step2:Tighten the screw caps.

# Assemble Squirrel Barrier

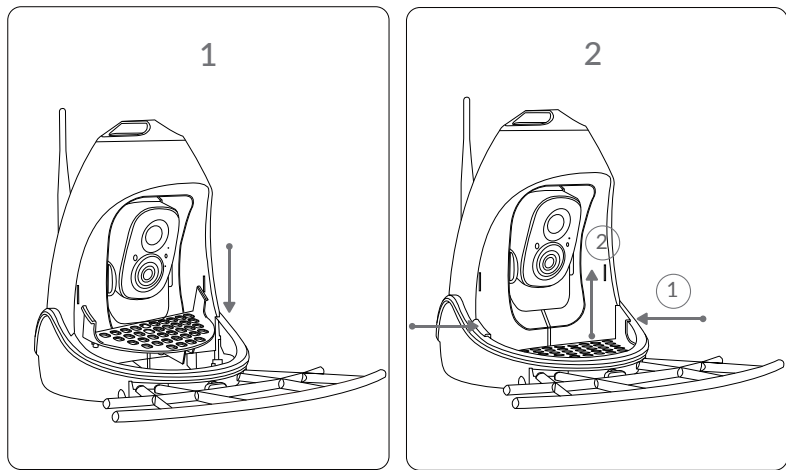

**Mounting:** Place the squirrel barrier in place and press down.

**Dismantle:** Squeeze the sides of the squirrel barrier inward and lift it upward.

**Note:** Adding this accessory may affect the bird's eating experience.

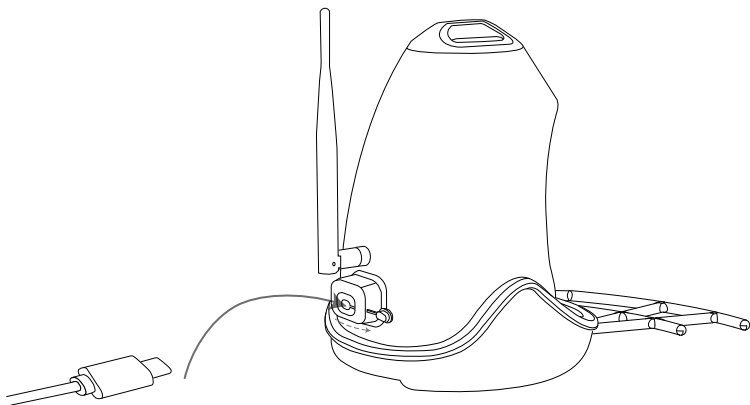

The batteries inside the camera are not fully charged according to the transportation safety regulations. Please fully charge the camera before using it. Please charge the batteries with provided Type C Port Cable (DC5V/ 1.5A)

# How To Turn On & Off The Camera

## To turn on the camera:

Press the Power Button on the top of the camera to turn it on.  
Then the LED Indicator in the left of the camera will be blink blue.

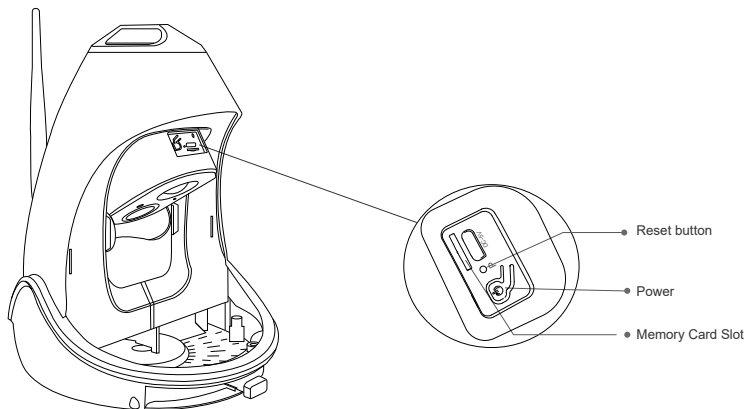

## To turn off the camera:

Press the power button on the top of the camera to turn it off.  
Then the LED Indicator in the left of the camera will be off.

# Set Up With Vicohome App



Download Vicohome App from App Store or Google Play.

You can also download the App by scanning the QR code above with the QR code scanner in your smartphone.

# Connection Camera--Bluetooth Mode

1. Power on the Camera, when you hearing "Ding Ding Ding Ding"Please click "Add Camera Now".
2. Bluetooth will find the device nearby.

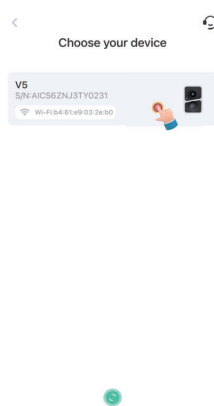
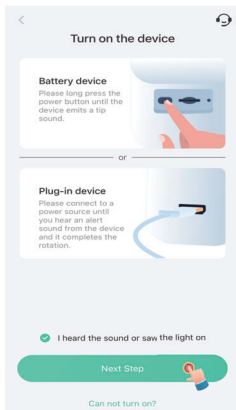
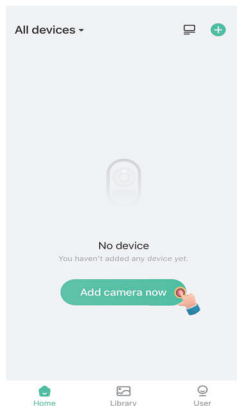





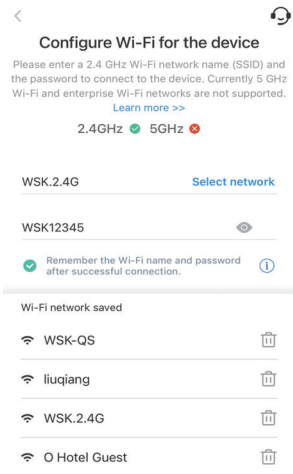

3. Select WiFi, enter the correct password, and click "Next Step"



4. You will hear "Connection Succeeded" and "the WiFi connect succeeded".

Connection succeeded



-  Connect the device to the network
-  New device is found
-  Register it to the cloud service
-  Initialize the device

5. You can customize the device name, and click "Next Step"

**Set a name and location for the device**

Device Name

Smart Camera

Location Edit

Front door Living room Back door

Garden Office Garage

+

Next Step 

6. Congratulations! Your device add successfully.

[< Previous](#)

5/5



### You're all done!

You have completed the installation! You can modify the installation angle as you want later.

Finish 

# Device Sharing

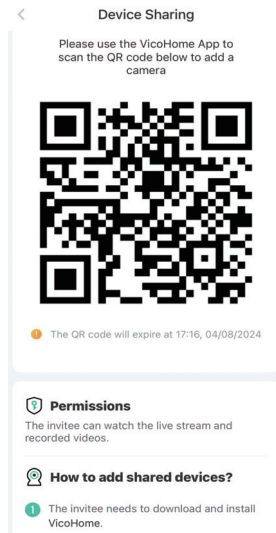
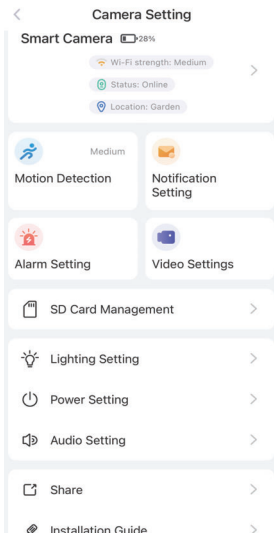

Please click “Settings Icon” to enter camera setting, choose “Share” to share device, there will be a QR code. Please note the QR Code will expire in 30 minutes, invitee can watch the live stream and recorded videos.

# How to get 30 days of free cloud storage

For new register we have 30 days free cloud storage

After one month this service needs to be subscribed.

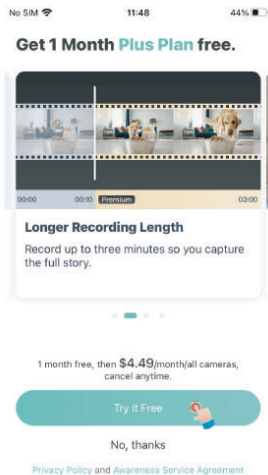
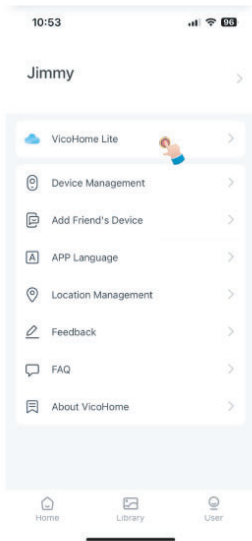

# AI bird Identification

After you get the free cloud storage, your AI Function will work.

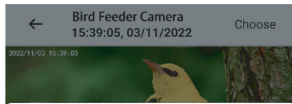
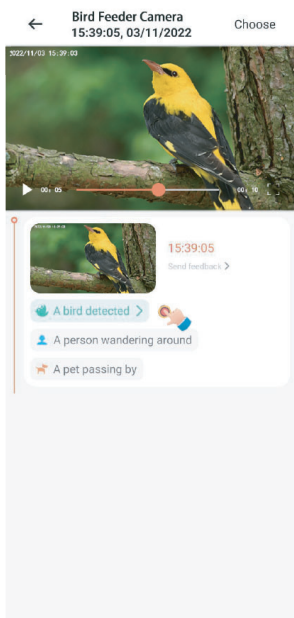

**Baltimore Oriole**

The Baltimore oriole (*Icterus galbula*) is a small icterid blackbird common in eastern North America as a migratory breeding bird. It received its name from the resemblance of the male's colors to those on the coat-of-arms of 17th century Lord Baltimore. Observations of interbreeding between the Baltimore oriole and the western Bullock's oriole, *Icterus bullockii*, led to both being classified as a single species, called the northern oriole, from 1973 to 1995. Research by James Rising, a professor of zoology at the University of Toronto, and others showed that the two birds actually did not interbreed significantly. The Baltimore oriole is the state bird of Maryland. It is also the namesake and mascot for the Baltimore Orioles baseball team.

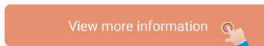

# Read Before Installation

1. Keep Bird Feeder and all accessories out of reach of children and pets.
2. Make sure the camera has been fully charged (DC5V / 1.5A).
3. Working temperature: -10°C to 50°C (14°F to 122°F)  
Working relative humidity: 0-90%
4. Please do not expose the camera lens to direct sunlight.

## Note:

1. Bird Feeder Cam only works with 2.4GHz Wi-Fi and also supports Bluetooth.
2. Strong lights may interfere with the device's ability to scan QR code.
3. Avoid placing the device behind furniture or near microwaves products. Try to keep it within range of your Wi-Fi signal.

# Installation

Check the following things before you drill holes on your wall:

Bird Feeder Cam has been successfully added to your APP and is able to stream video.

## Wall Installation:

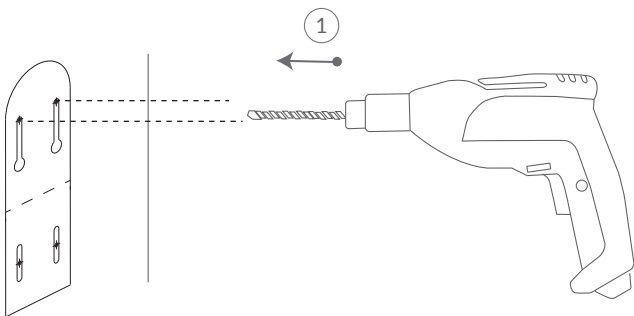

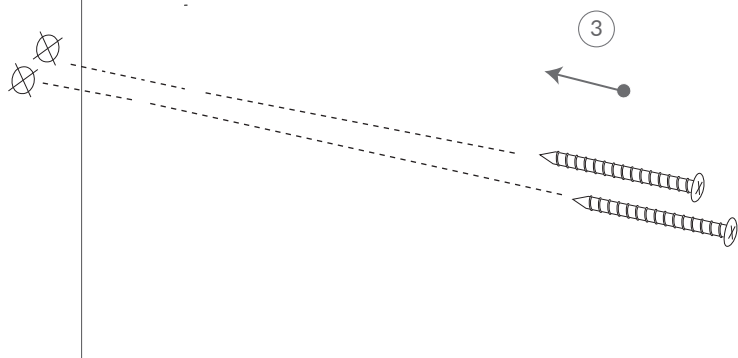
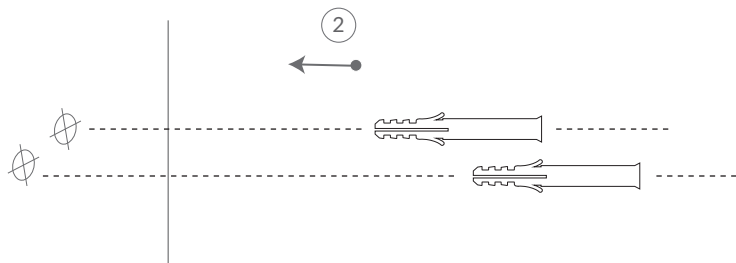



### Step 1:

1. Use the provided drilling template to mark the position of holes on your wall. Use drill bit (15/64", 6mm) to drill two holes.
2. Install the anchors to fix the screws. (Install on wood skip this step.)
3. Install the Mounting Bracket on your wall with the screws provided.

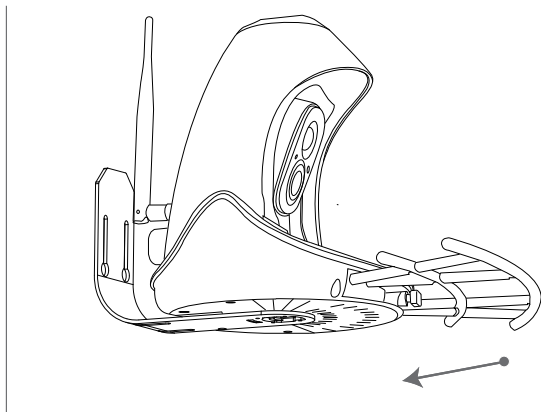

**Step 2:** Slide the Bird Feeder into the bracket through the slide rail.

# Tree Installation:

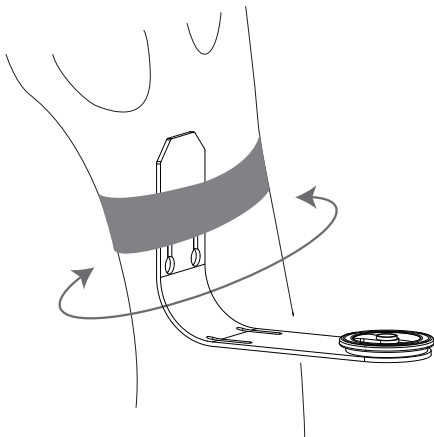

**Step 1:** Wrap the Mounting Bracket around the tree with the Black Strap.

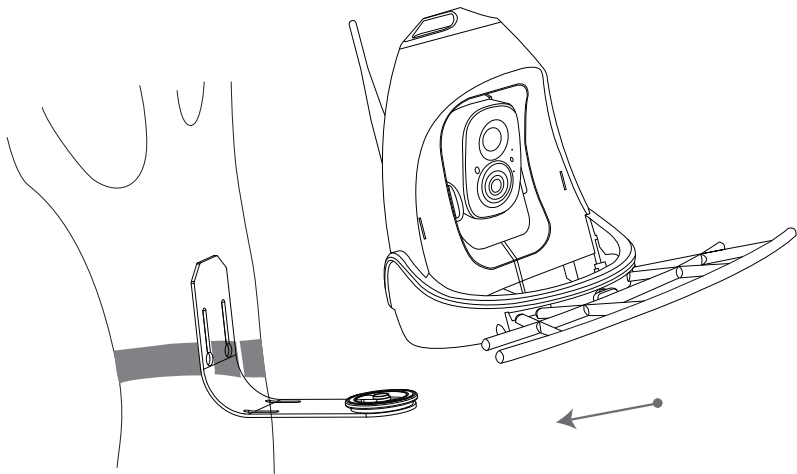

**Step 2:** Slide the Bird Feeder into the mounting bracket.

# Stand Installation:

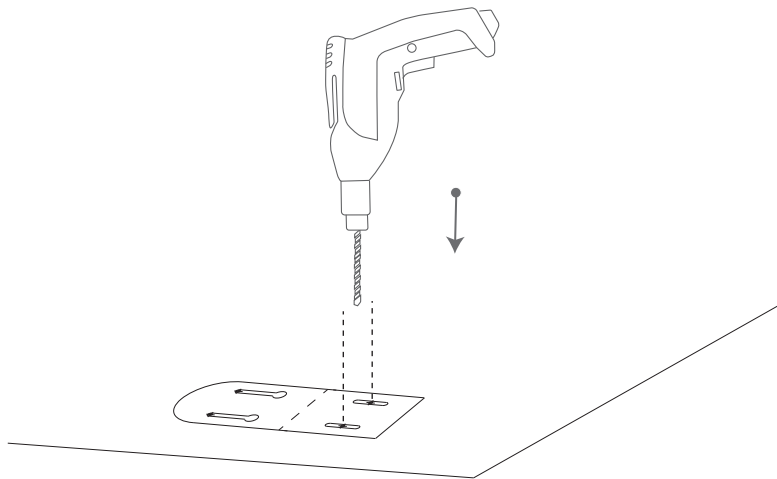

**Step 1:** The Bird Feeder can be placed steadily on a flat surface, but for stability, we recommend that the backplane is installed and fixed on a flat surface.

Use the provided drilling template to mark the position of holes on flat surface. Use drill bit( $5/16"$ ,8mm) to drill two holes.

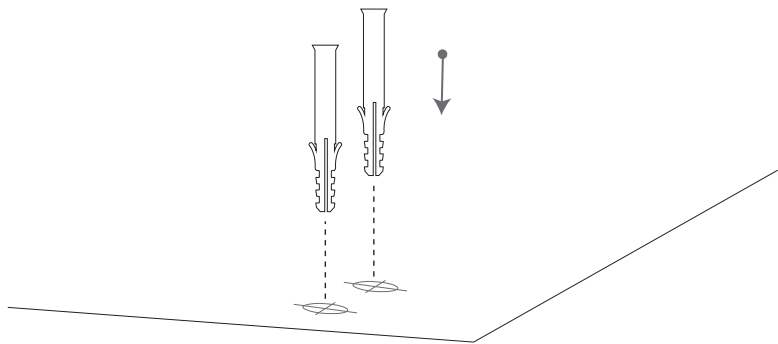

**Step 2:** Install the anchors to fix the screws. (Install on wood skip this step.)

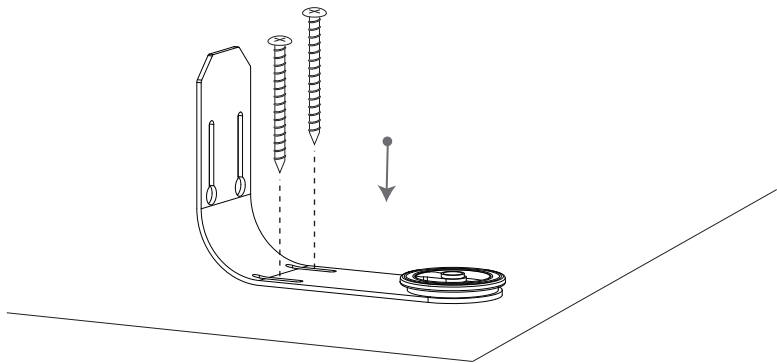

**Step 3:** Install the Mounting Bracket on flat surface with the screws provided.

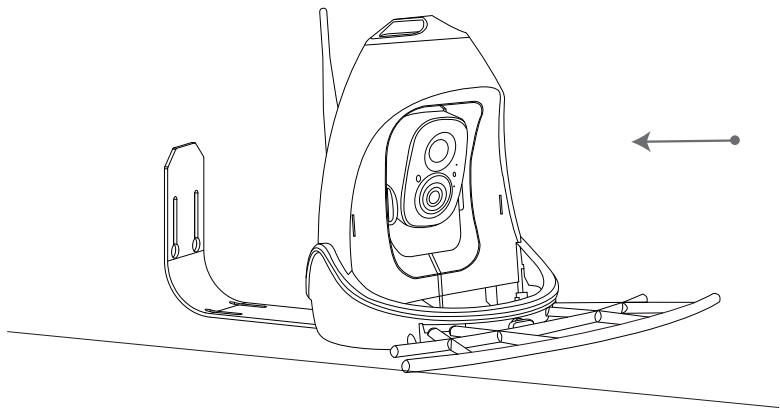

**Step 4:** Slide the Bird Feeder into the mounting bracket.

## Tripod Installation:

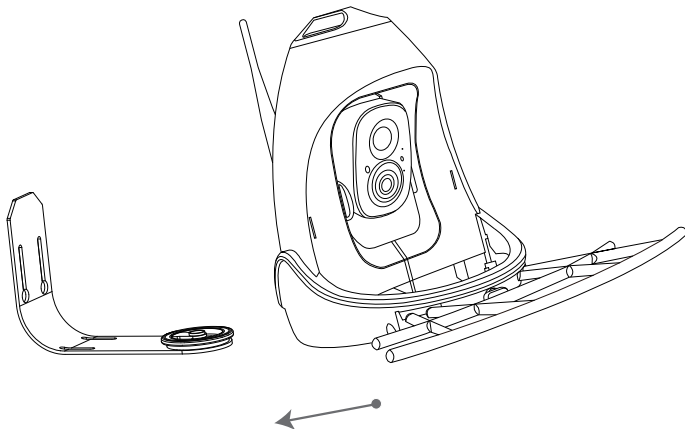

Make sure you don't have the bracket installed on the bottom of the Bird Feeder. If you need to remove it, please take a look at "Step 2 of Cleaning Bird Feeder" for instructions on "**Page 36**" how to remove the bracket.



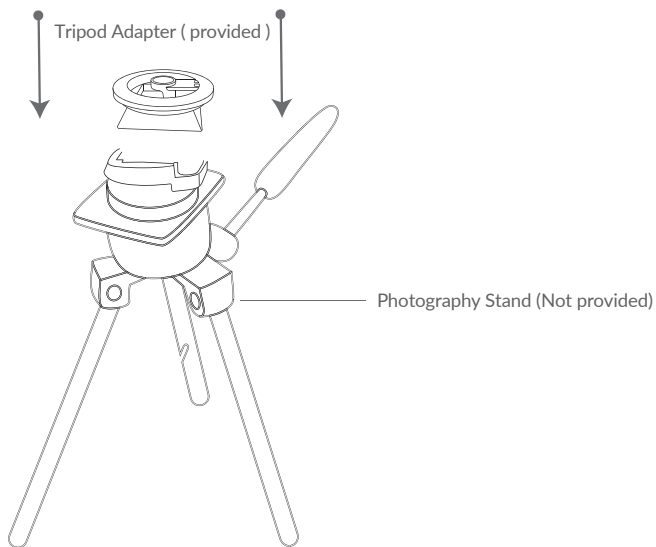

**Step 1:** Slide the Bird Feeder into the Tripod Adapter.

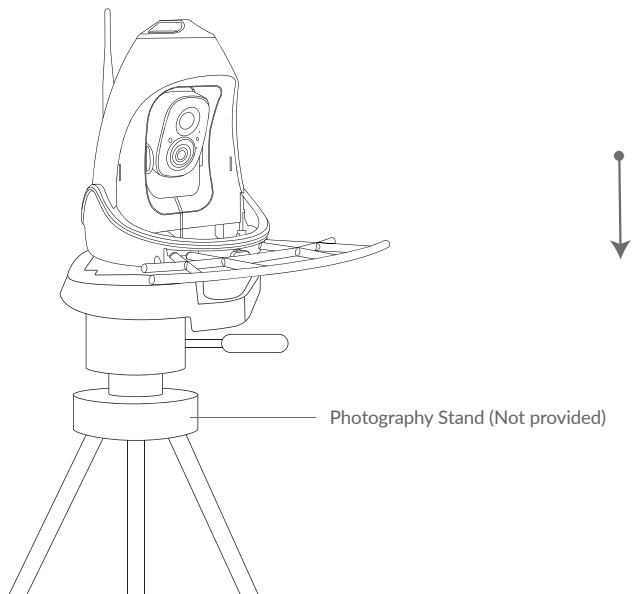

**Step 2:** Install the Bird Feeder on the corresponding accessories, such as a photography stand(not provided).

## Pole Installation - Hose clip

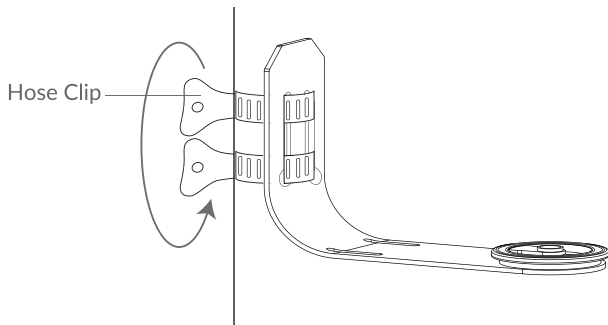

**Step 1:** Attach Bird Feeder to the pole with the Hose Clip turning the handle clockwise.

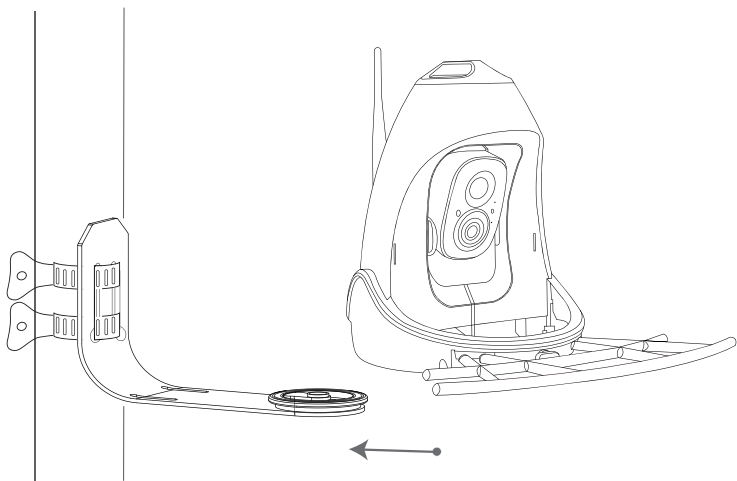

**Step 2:** Slide the Bird Feeder into the bracket through the slide rail.

# Solar Panel Installation

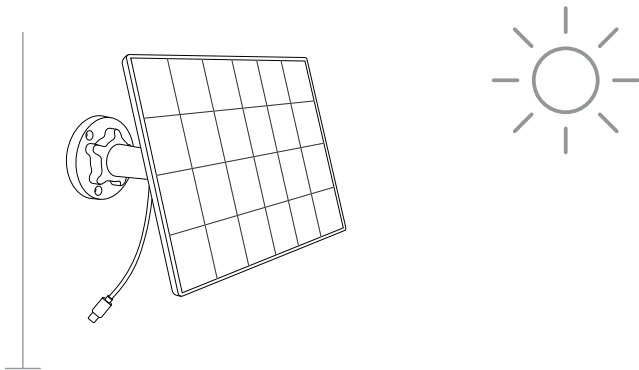

**Step 1:** Find a good installation point and install the Solar Panel in a sunny location.

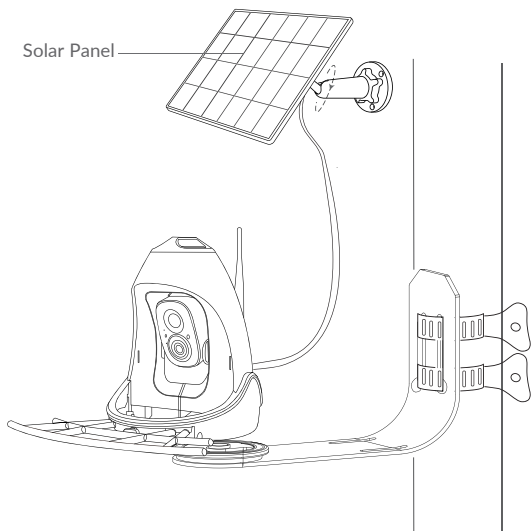

After Bird Feeder is installed and ready for bird watching.

# Cleaning Bird Feeder

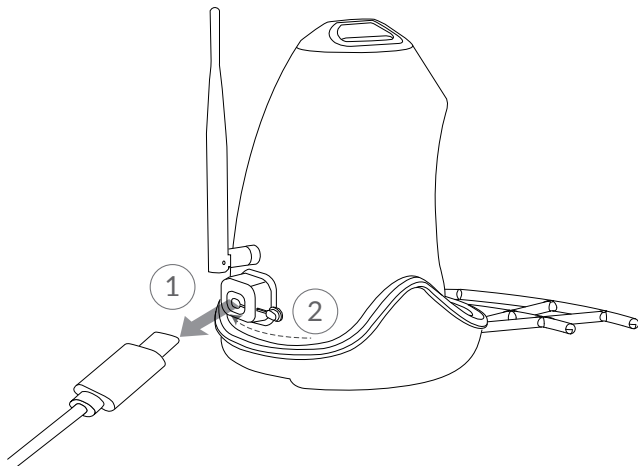

**Step 1:** Unplug the charging cable and put on the silicone cover.

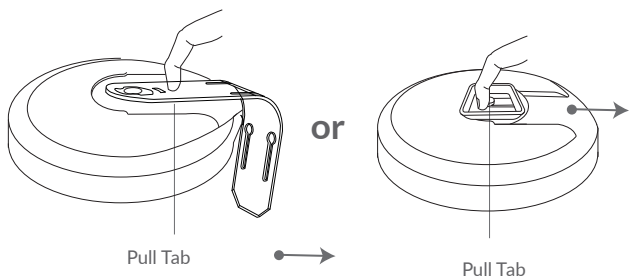

**Step 2:** Using the Pull Tab on the base of the feeder, remove the Bird Feeder from the bracket.



1



2

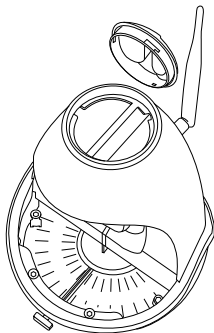

**Step 3:** Rotate the top cover by hand and open the top cover upwards.

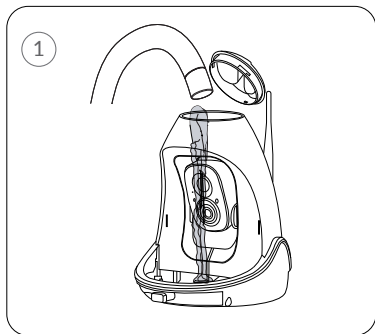

**Step 4:** Pour water on both sides of the seed reservoir, Do not wash in the middle of the camera or any of its components. They are water resistant, not water-proof. Dry the feeder, including the seed reservoir.

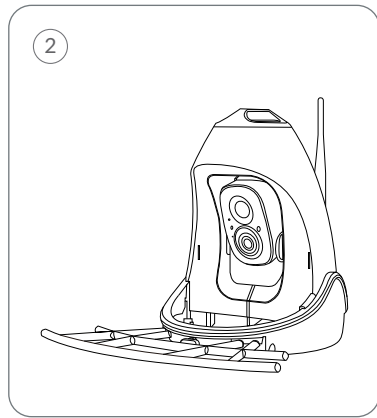
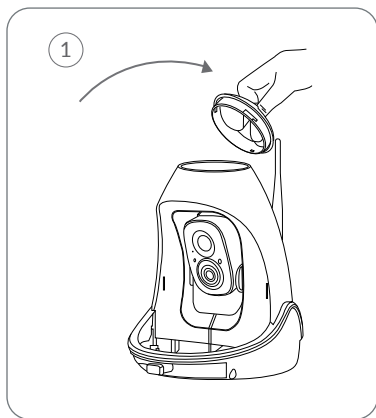

**Step 5:** Covering the roof: Return the cover to the correct position.

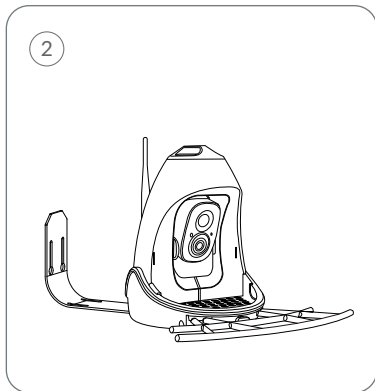
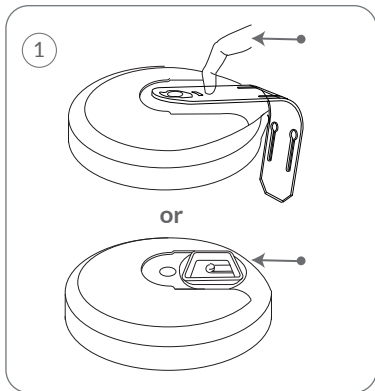

**Step 6:** Re-attach the bracket to the Bird Feeder base.

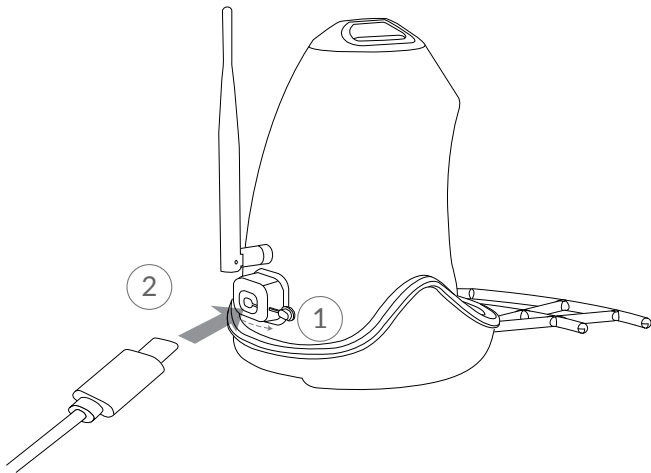

**Step 7:** Open the silicone plug, re-plug in the Solar Panel.

# How to Add Bird Seed

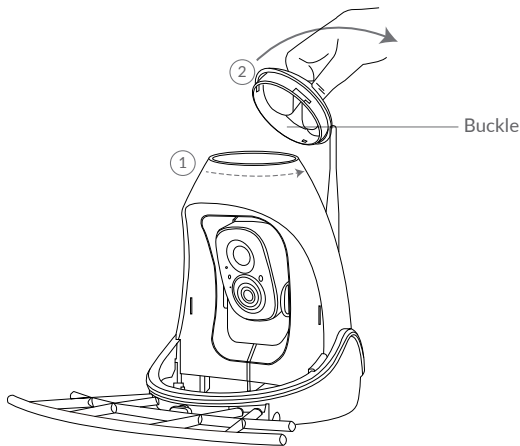

**Step 1:** Place your finger on the buckle and rotate counterclockwise, open the top cover upwards.

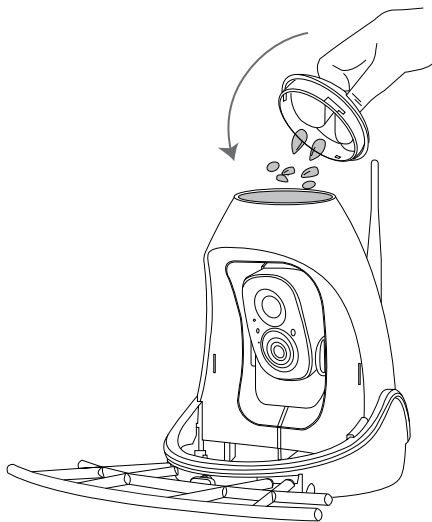

**Step 2:** You can add bird seed. Finally, close the roof back.

# Status Light

This camera uses status light to communicate.

LED Indicator	Description
Solid Blue	Working
None	Sleep/Power Off
Solid Yellow	Charging
Solid Green	Charging Finished

## Battery Camera Reset

When the battery camera is powered on, if you are not hear a prompt sound of "Ding,Ding,Ding,Ding", please quickly press power button twice in a row, until the blue light flashes, and a prompt sound of "Ding,Ding, Ding,Ding", that is, the reset is successful.



# Frequently Asked Questions

**Q1: Why doesn't the Wi-Fi name appear when I connect to Wi-Fi?**

**A1:** You need to turn on the "location permission" for the app in the system settings and change it to "allow when using".

**Q2: Will the camera show red lights when night vision is activated?**

**A2:** The built-in infrared lamp beads make the camera only show some dim red lights when night vision is activated, but the image quality is still clear under no light environment.

**Q3: What are the requirements for Wi-Fi?**

**A3:** Please use a 2.4GHz wireless network. The device does not support the 5GHz wireless network. Meanwhile, please set the Wi-Fi authentication method to wpa2-psk or other lower level of the security method. A password is required.

**Q4: How far should the camera be placed from the router?**

**A4:** After testing, the Wi-Fi connection distance can normally reach up to 100 meters in the open area. However, the actual situation depends on the strength of Wi-Fi and its surrounding environment.

**Q5: What is the maximum length of recording time?**

**A5:** You can choose the recording time in the app. The camera record for a fixed time or "auto" mode, when depending on whether there is a person, the maximum length of a video is 30 seconds.

**Q6: What should I do when the device is malfunctioning?**

**A6:** Long press the power button to restart the camera.