

# CD BOOMBOX



CD/MP3 DISC PLAYER WITH BLUETOOTH  
USB DISC PLAYER WITH FM RADIO

MODEL:W17  
USER MANUAL

PLEASE READ THIS USER MANUAL COMPLETELY BEFORE OPERATING  
THIS UNIT AND RETAIN THIS BOOKLET FOR FUTURE REFERENCE.

## DEAR CUSTOMER

Thanks for your trust and selection for CD Boombox  
We are committed to provide quality products with novel design and exquisite workmanship.

In order to maximize the fun and excitement the player offers, please read this manual before use. You will know the precautions and key points of operations. Please keep this manual well for further reference.

If you need some more information or guideline, please feel free to contact us.

### WARNING

#### CLASS 1 LASER PRODUCT

CLASS 1 LASER PRODUCT  
APPAREIL LASER DE CLASSE 1  
PRODUCTO LASER DE CLASE 1

CAUTION  
INVISIBLE LASER RADIATION  
WHEN OPEN AND INTERLOCKS  
DEFEATED  
AVOID EXPOSURE TO BEAM.



This product contains a low power laser device.



Warning:

To avoid fire or electric shock, do not expose the unit to rain or moisture.



#### WARNING

Risk of electric shock  
Do not open!



Caution: To reduce the risk of electric shock, do not remove the cover (or back). There are no user serviceable parts inside.  
Refer servicing to qualified service personnel.



**This symbol indicates the presence of dangerous voltage inside the enclosure, sufficient enough to cause electric shock.**



**This symbol indicates the presence of important operating and maintenance instructions for the device**

## PRECAUTIONS BEFORE USE

1. Usage of controls or adjustments or performance of procedures other than those specified herein may result in hazardous radiation exposure or fire or electrical shock. Keep below instructions in mind.
2. Do not cover or block any ventilation openings. When placing the device on a shelf, leave 5cm (2") free space around the whole device.
3. As the laser beam used in this player is harmful to the eyes, do not attempt to disassemble the casing.
4. Do not touch the lens or poke at it, may damage the lens and the player may not operate properly.
5. Stop operation immediately if any liquid or solid object fall into the cabinet. Unplug the player and have it checked by qualified personnel.
6. Keep the player away from heat sources such as radiators, heaters, stoves, candles and other heat-generating products or naked flame. Working temperature between 0° and 35°C.
7. Avoid using the player near strong magnetic fields
8. This player must operate on a power source as specified on the specification label.
9. Unplug this player during lightning storms or when unused for a long period.
10. Make sure this player is adjusted to a stable position. Damage caused by using this player in an unstable position vibrations or shocks or by failure to follow any other warning or precaution contained within this user manual will not be covered by warranty.
11. To clean the device, use a soft dry cloth. Do not use solvents or petrol based fluids.
12. Use only with the cart, stand, tripod, bracket, or table specified by the manufacturer, or sold with the apparatus. When a cart is used, use caution when moving the cart/apparatus combination to avoid injury from tip-over.



## COMPLIANCE WITH FCC REGULATIONS

This device complies with part 15 of the FCC Rules. Operation is subject to the following two conditions: (1) This device may not cause harmful interference, and (2) this device must accept any interference received, including interference that may cause undesired operation. Warning: Changes or modifications to this unit not expressly approved by the part responsible for compliance could void the user 's authority to operate the equipment. NOTE: This equipment has been tested and found to comply with the limits for a Class B digital device, pursuant to part 15 of the FCC Rules. These limits are designed to provide reasonable protection against harmful interference in a residential installation. This equipment generates, uses and can radiate radio frequency energy and, if not installed and used in accordance with the instructions, may cause harmful interference to radio communications. However, there is no guarantee that interference will not occur in a particular installation. If this equipment does cause harmful interference to radio or television reception, which can be determined by turning the equipment off and on, the user is encouraged to try to correct the interference by one or more of the following measures: - Reorient or relocate the receiving antenna. - Increase the separation between the equipment and receiver . - Connect the equipment into an outlet on a circuit different from that to which the receiver is connected. - Consult the dealer or an experienced radio/ TV technician for help. RF Exposure The device has been evaluated to meet general RF exposure requirement. The device can be used in portable exposure condition without restriction.

## PREPARATION FOR USE

Unpack the package carefully and remove all the accessories from the packing. Verify that the following accessories are present before setting up the unit.

- Main unit X 1
- AC cable X1
- User manual X1
- Audio cable X1
- USB-micro USB power cable X1

## TABLE OF CONTENTS

Precaution before use-----	2
Location of controls-----	5-6
Basic operation -----	7-10
CD playback operation -----	11-13
USB playback operation -----	13
Bluetooth playback operation -----	14
Radio play operation -----	15
Care and maintenance -----	16
Troubleshooting -----	17

# LOCATION OF CONTROLS

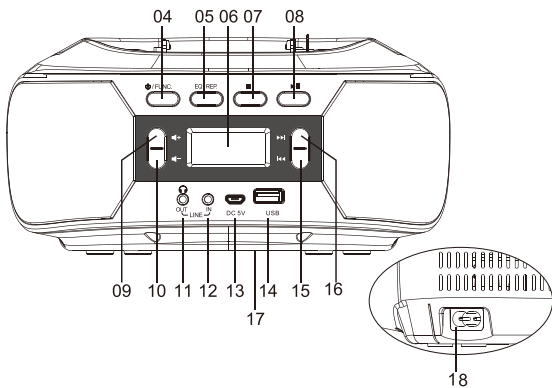
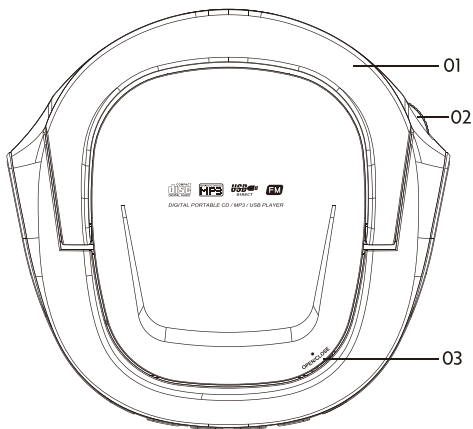

## LOCATION OF CONTROLS

- 1.Handle
- 2.FM tuner
- 3.CD door open      press to open the CD door
- 4.Power/function button    Press and hold to turn on/off;  
press and release to switch function after turned on
- 5.EQ/REP. button      Press and release to switch sound effect,  
press and hold to switch between single track, whole disc repeat,  
random and normal sequential playback when plays;
- 6.LCD screen
- 7.Stop
- 8.Play button    press to pause or resume playing
- 9.Volume increase button
- 10.Volume decrease button
- 11.Earphone/line out jack
- 12.Line in jack
- 13.DC 5V in jack
- 14.USB slot
- 15.Previous button    Press to skip to previous track,press and hold  
to fast rewind on current track
- 16.Next button      Press to skip to next track,press and hold to fast  
forward on current track
- 17.Battery case
- 18.AC in socket

## FEATURES

- CD/MP3/USB disc playback
- Bluetooth for audio streaming
- Integrated FM radio
- Digital LCD display with backlight
- EQ function

## SPECIFICATIONS

Bluetooth pairing name	W17
disc format	CD,CD-RW,MP3
USB format	WMA,MP3
Output connector	3.5mm earphone socket
mains power adapter	100~240V
Speaker output power	1.5*2W RMS
BT working distance	10M (max)

## POWER SOURCE

- AC Power  
Use ONLY the power cord supplied with this device.  
Insert the power cord into the AC in socket and plug the other end of the cable into a wall outlet.



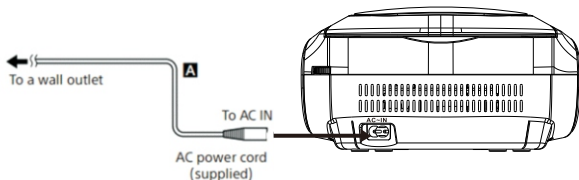

## Caution

- ✦ Please do not connect the player with main power in humid conditions or if it has a damaged plug.
- ✦ Do not connect the player with main power after it has been dropped or damaged.

## Battery Power

To use your CD Boombox as a portable device you need to install 4 “C” size batteries.

1. To open the battery compartment, turn the CD Boombox over.
2. Press both tabs simultaneously and lift the cover off.
3. Insert 4 C Size batteries (not included) according to the polarity indicated in the battery compartment.
4. Replace the battery compartment cover.

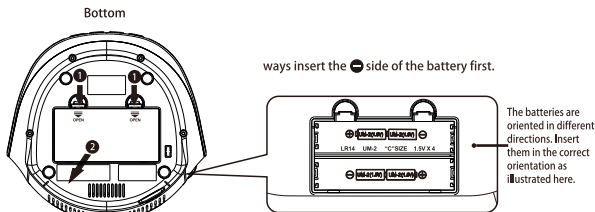

Press down on the battery compartment cover at ① and slide it in the direction of the arrow ②.

## Caution about the use of Batteries:

- ✦ Danger of explosion if battery is incorrectly replaced. Replace only with the same or equivalent type.
- ✦ Replacement of a battery with an incorrect type that can result in an explosion or the leakage of flammable liquid or gas.
- ✦ Disposal of a battery into fire or a hot oven, or mechanically crushing or cutting of a battery, that can result in an explosion.
- ✦ Attention should be drawn to the environmental aspects of battery disposal.

### ● DC 5V power

- 1.Plug the micro USB head of cable into the DC 5V jack on the player
- 2.Plug the USB head to a 5V 2A adapter or power bank (not included)

## TURN ON /OFF THE PLAYER

- 1.To turn on the player, press and hold power button for 2 seconds, LCD screen will light up with blue backlight.
- 2.To turn off the player, Press and hold power button for 2 seconds, the LCD screen will go off.

## VOLUME INCREASE OR DECREASE

- ❖ Press and release volume increase button to increase volume gradually, Press and hold to increase fast.
- ❖ Press and release volume decrease button to decrease volume gradually, Press and hold to decrease volume fast.

### CAUTION

PROLONGED USE AT HIGH LEVELS MAY IMPAIR YOUR HEARING.

## **EARPHONE-LINE OUT CONNECTION**

- ❖ Earphone connection: Connect the plug of the earbuds (not including) into the earphone/line out jacket. Please set the volume low and increase it if necessary.
- ❖ Line out connection: Connect the line out jack on the player to line in jack of external device, you will hear the sound from external device.

## **LINE IN CONNECTION**

Connect this boombox with other device and we hear sound from the boombox.

1. Connect to the Line in jack on the player to audio out jack of other device with the included audio cable.
2. Press and release function button to switch to AUX mode, LCD screen will show AUX
3. Use the other device to control playback (eg., play, stop, next, previous)
4. Operate on the boombox to increase or decrease volume. If available and necessary, you can also increase or decrease volume by operating on the other device.

## CD DISC PLYABACK OPERATIONS

### ● Loading CD disc

1. Press and release the right corner of the CD door, where marked with OPEN/CLOSE to open it.
2. Load in the CD disc into compartment with its label facing up.
3. Close the CD door till it be secured.

Open the CD compartment cover using the opening tab.

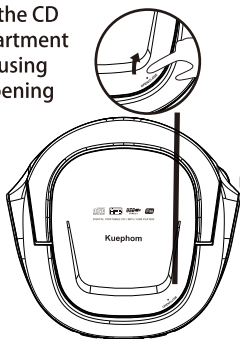

Push down on the center of the disc until it fits into place.

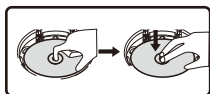

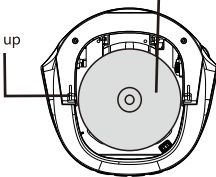

Label side up



### ● Playing CD disc

- ❖ The player will attempt to read the disc once the CD door is closed , and start to play from track 1.
- ❖ To pause play, press the Play button while a disc is playing. The track number will flash on the LCD screen
- ❖ Press the Play button to resume playback when paused.
- ❖ Press and release the Next/Fast forward to skip to the next track. The LED screen will change track number accordingly and then display the playing time .

- ❖ Press and hold Next/Fast forward button to advance quickly through current track, till that release the button to resume normal playback.
  - ❖ Press and release the Previous/Fast rewind to skip back to the previous track. The LED screen will change track number accordingly and then display the playing time.
  - ❖ Press and hold the Previous/Fast rewind to reverse quickly through the current track; till that release the button to resume normal playback.
  - ❖ To stop playback, press the STOP button.
- 
- Track repeat and random playback
  - ❖ To repeat a single track, press and hold the REP button until the repeat sign " " flashes on the LCD screen. The current track will replay repeatedly until play is stopped.
  - ❖ To repeat all the tracks, press and hold the REP button until the repeat sign " " shows steadily on the LCD screen. The player will replay all tracks on the CD until play is stopped.
  - ❖ To play randomly, press and hold the REP button until random playback sign "RAND" shows up on LCD screen. The player will play randomly until the play is stopped.
  - ❖ To resume normal sequential playback, press and hold the REP button until neither " " nor "RAND" shows up on the LCD screen, the player will play sequentially and finally stop till last track on the disc be played.

- Sound effect (Equalizer) switching

When playing,press and release REP/EQ button to switch different sound effect.(FLAT-CLASS-ROCK-POP-JAZZ)

## USB DEVICE PLAY OPERATION

Insert a USB device with compatible media files (MP3 or WMA) into the USB socket. press the FUNC. button to switch to USB mode.The unit will play the first track automatically. Controls for USB playback is identical with CD playback.

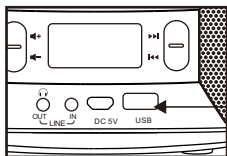

USB disk playback

## BLUETOOTH PAIRING AND PLAY OPERATION

This function enable to stream audio wirelessly from Bluetooth devices(such as laptops, tablets, smartphones and so on) Before using a wireless device with Bluetooth, please make sure that the device has its Bluetooth radio enabled and switched on.

Then you will need to establish a connection between it and the player. This process is called “pairing” and you will only have to do it once. Once two devices are paired, they will automatically connect when they detect each other.

1.press the Function button on the player to bluetooth mode, the “ **bE** ” will show up on LED display. And if it does not detect a paired device,it will automatically switch to pairing mode,the “ **bE** ” on display will flash when the player is in pairing mode.

2.On your bluetooth device,go to its bluetooth setting menu.

3.Have your bluetooth device “search for device” and select the player (W17) when it is found.Enter 0000 as a passkey if device ask for one.

4. When pairing is complete, the player is ready to play and the " **bE** " on the display will show up steadily.
5. Use the bluetooth device to control playback (e.g., stop, play, next, previous).

The player will automatically connect to your bluetooth device next time as long as it has bluetooth enabled, and be within range (10M).

If the pairing process fails, the " **bE** " on display will flash slowly. Please follow the steps as above.

Press and hold STOP button to disconnect from current bluetooth device and go to pairing mode for a new device.

## **RADIO PLAY OPERATION**

1. Press the Function button on the player to switch to FM Radio mode. The screen shows "rAd" then it will display some radio station number (87.5-108).

2. Rotate the tuner to select desired radio station, the frequency number will show on the display.

Use the radio in a place where radio signals can be easily received, such as near a window.

Reorient the unit itself to improve reception if necessary.



## CARE AND MAINTENANCE

1. Unplug the player before maintenance or cleaning.
2. Clean the unit with a soft, damp (never wet) cloth. Solvent or detergent should never be used.

**CAUTION:** Never allow any water or other liquids to get inside the unit while cleaning.

3. Clean the CD disc if skips or will not play. Wipe the disc from the center out with a cleaning cloth, after playing, store the disc in its case.

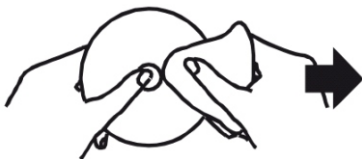

4. If the CD lens is dusty, clean it with a brush-blower, blow several times on the lens and remove the dust with the brush. Finger prints may be removed with a cotton swab moistened with alcohol.

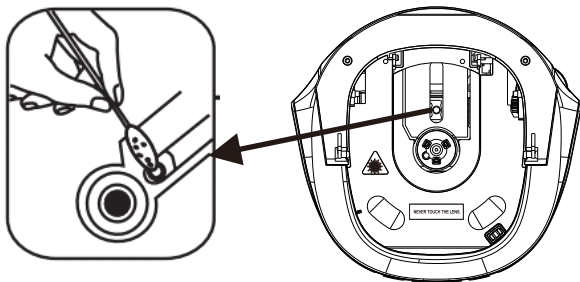

## TROUBLESHOOTING GUIDE:W17

No power	<ul style="list-style-type: none"> <li>– Check that the power cord is connected securely</li> </ul>
CD do not play	<ul style="list-style-type: none"> <li>– Load in and secure the disc properly</li> <li>– Replace with compatible discs</li> <li>– Close the CD door</li> </ul>
USB do not play	<ul style="list-style-type: none"> <li>– Make sure that the files are either WMA or MP3 formats</li> </ul>
No sound or bad sound quality	<ul style="list-style-type: none"> <li>– Press <b>▶  </b> to resume playback.</li> <li>– Adjust the volume.</li> <li>– Check and clean the connections.</li> </ul> <p>Re-connect the connecting cord securely.          The connecting cord is damaged.          The player is in pause mode          The player is in fast forward or fast reverse mode.</p>
The disc is skipping or otherwise distorted.	<ul style="list-style-type: none"> <li>– The disc may be scratched, dirty or otherwise damaged. Damaged discs play unpredictably.</li> <li>– MP3 files encoded at a very high or very low sample rates may not play properly. (A typical CD-quality file is encoded at 192 Kbps and 44,100 Hz. Try playing a different file).</li> <li>– The MP3 file may have become corrupted. Try playing a different file.</li> <li>– The batteries may be running low. Charge it timely</li> </ul>

**Warning:**

Changes or modifications to this unit not expressly approved by the party responsible for compliance could void the user's authority to operate the equipment.

**NOTE:**

This device complies with part 15 of the FCC Rules.

Operation is subject to the following two conditions:

- (1) This device may not cause harmful interference, and
- (2) this device must accept any interference received, including interference that may cause undesired operation.

**FCC Statement:**

This equipment has been tested and found to comply with the limits for a Class B digital device, pursuant to part 15 of the FCC Rules. These limits are designed to provide reasonable protection against harmful interference in a residential installation. This equipment generates, uses and can radiate radio frequency energy and, if not installed and used in accordance with the instructions, may cause harmful interference to radio communications. However, there is no guarantee that interference will not occur in a particular installation. If this equipment does cause harmful interference to radio or television reception, which can be determined by turning the equipment off and on, the user is encouraged to try to correct the interference by one or more of the following measures:

- Reorient or relocate the receiving antenna.
- Increase the separation between the equipment and receiver.
- Connect the equipment into an outlet on a circuit different from that to which the receiver is connected.
- Consult the dealer or an experienced radio/TV technician for help.