

English

SHORT GUIDE

R916 Android

Thank you for choosing
a **Ejeton** product



Box contents

Remove the device from its carton being careful not to damage the packing material so that it may be re-used if the device is to be transported in the future. Make sure that all the components illustrated below are present and that there are no signs of damage. If there are, contact customer service.

1. Documentation (short guide)
2. Device
3. power supply cable
4. power supply

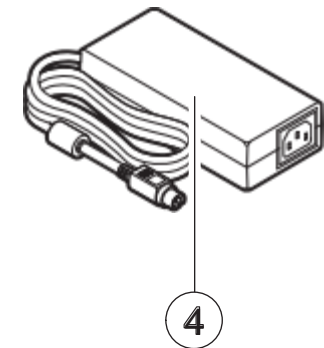
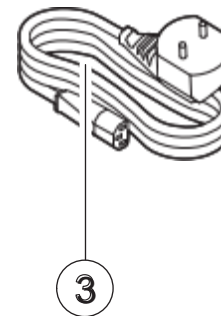
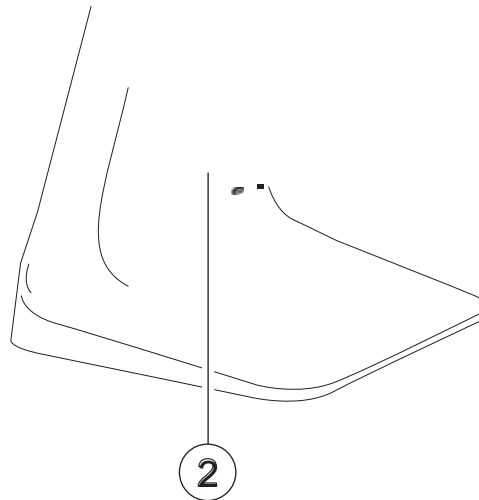
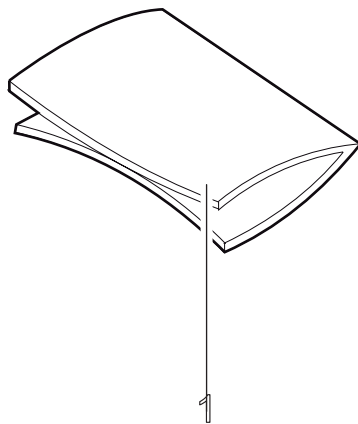
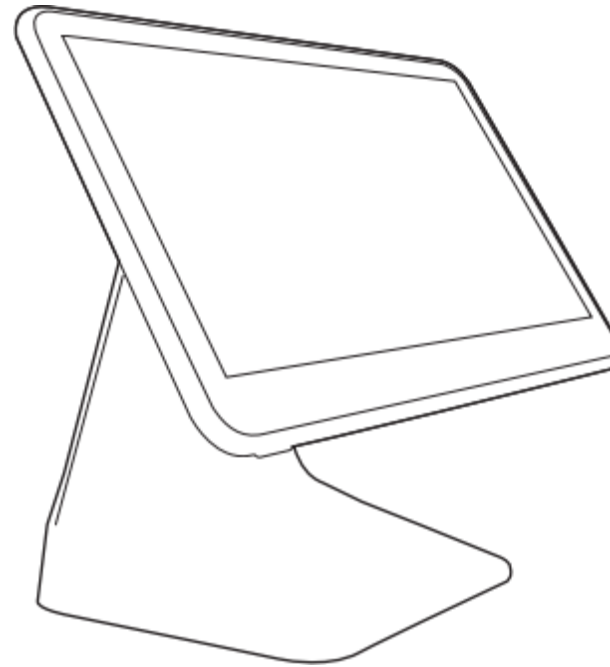

Device description

- | | |
|-----------------------------------|-----------------------------|
| 1. 1.Displa touch 15.6 inch touch | 9. Network Port |
| 2. Base | 10. USB Interface |
| 3. Connectable fan | 11. Interface R Interfaccia |
| 4. Input interface DC12V | 12. Output interface DC12V |
| 5. HDMI signal output interface | 13. Switch button |
| 6. Audio output interface | 14. Empty |
| 7. Interface R Interfaccia | 15. USB Interface |
| 8. USB Interface | |

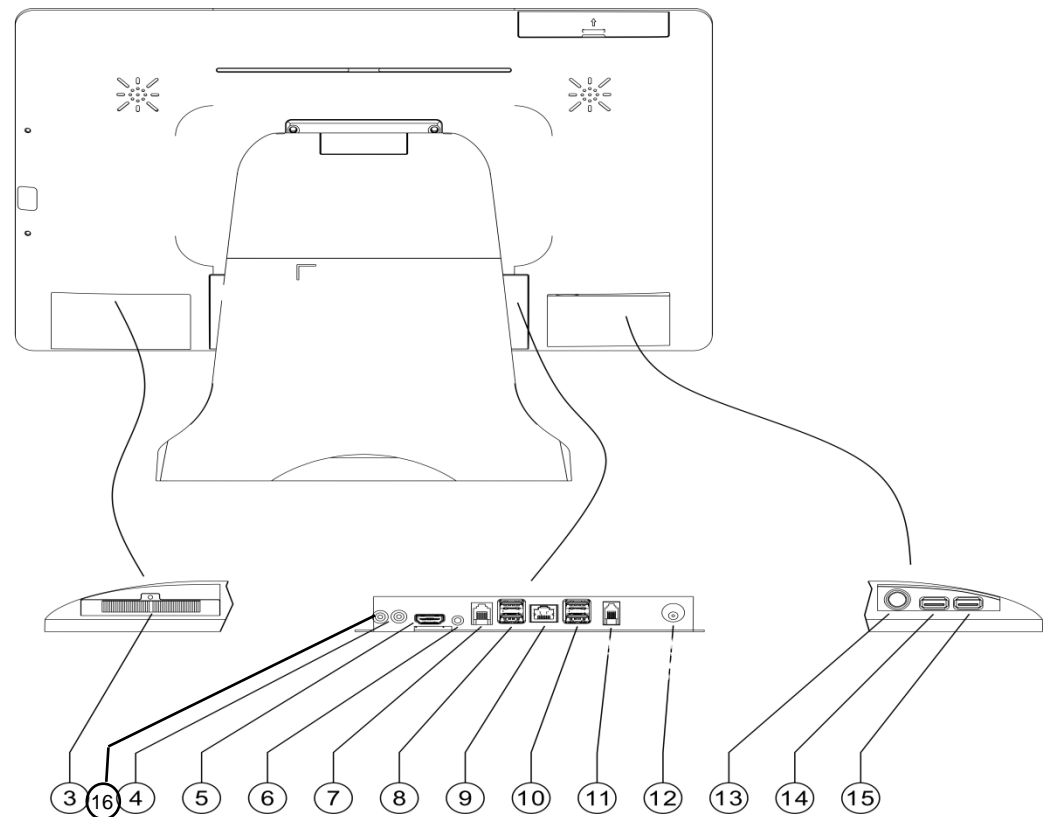
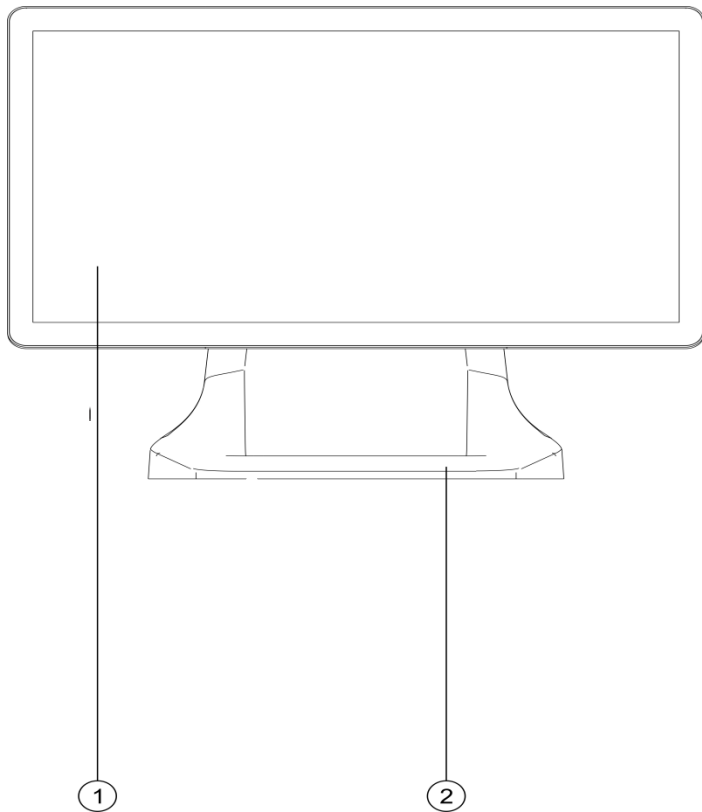

Turn the device On/Off

1. connect the power supply cable (included) to the device and the mains outlet use the type of electrical power supply indicated on the device label.
2. Turn the device on pressing the ON/OFF Key.

1

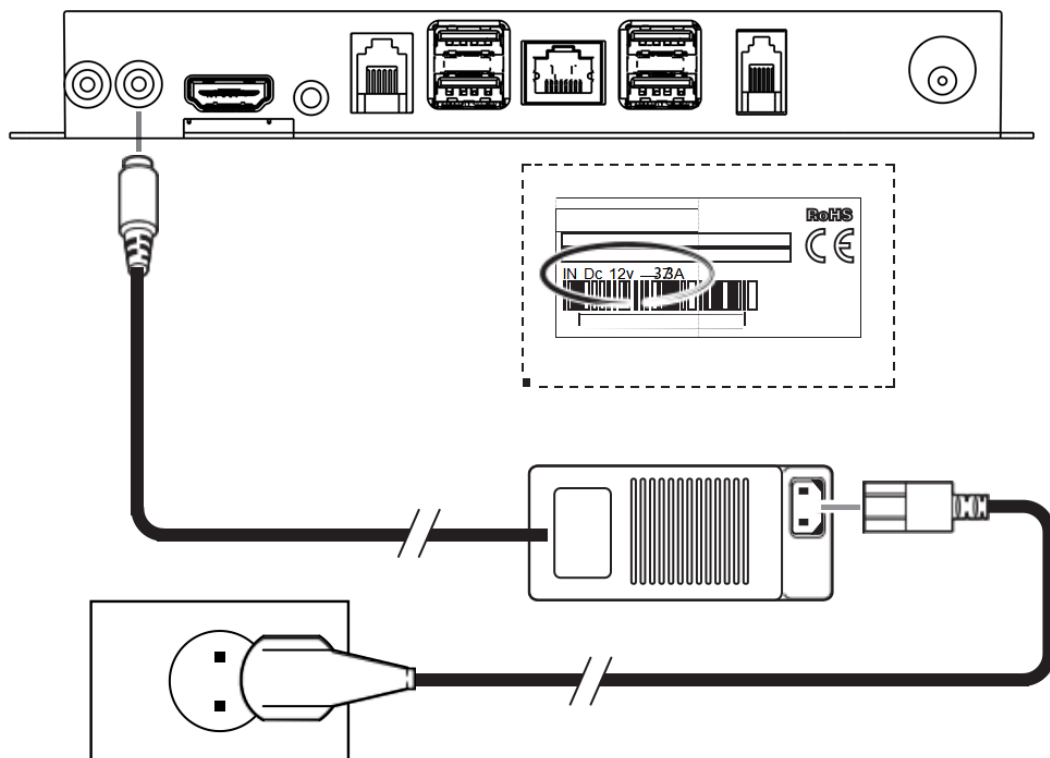

2

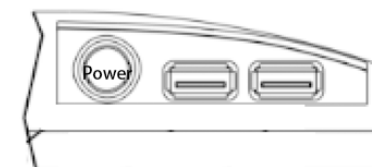
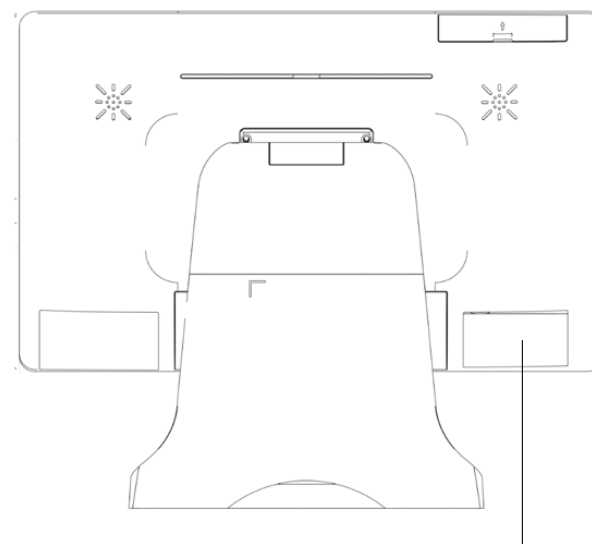

status messages

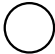
STATUS LED		DESCRiPTION
	ON	DEVICE ON
	OFF	DEVICE OFF

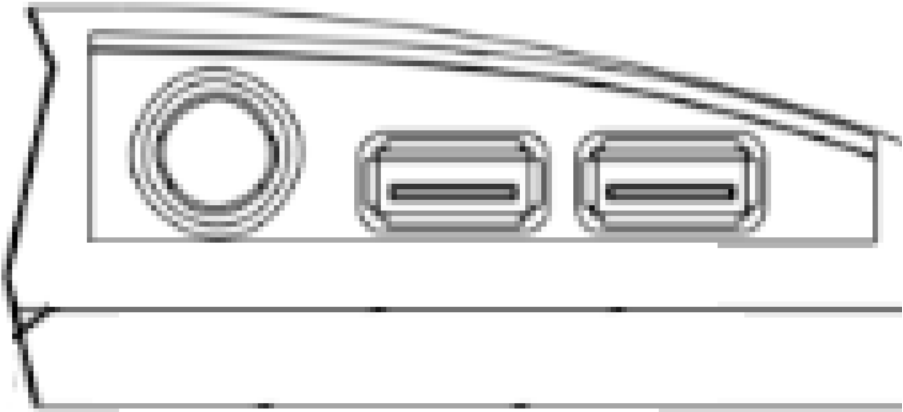

Connection

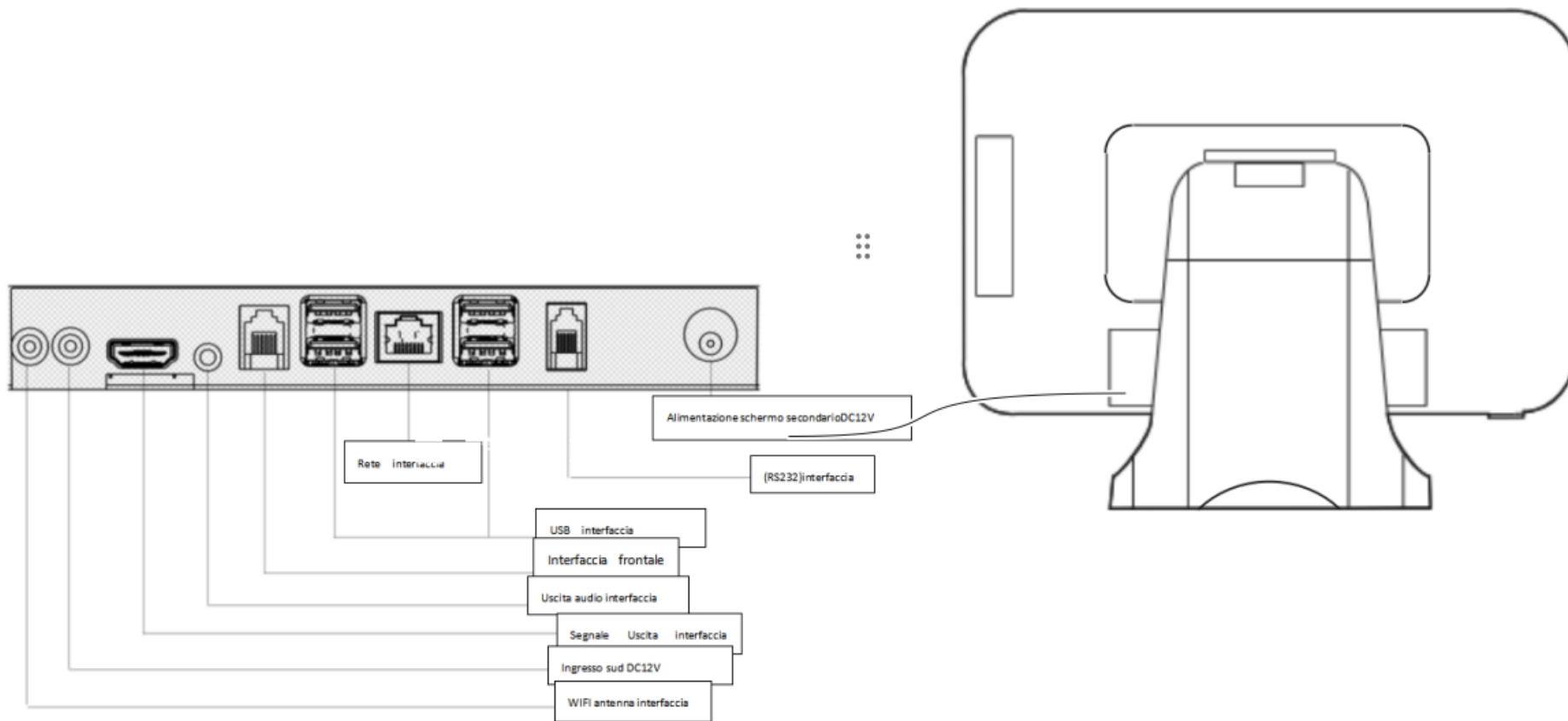

Cleaning

1. Disconnect the power supply cable and wait a few minutes to allow the screen to get to room temperature.
2. To clean the device use compressed air or a soft cloth.
3. Gently wipe the screen with a soft cloth slightly moistened with water.

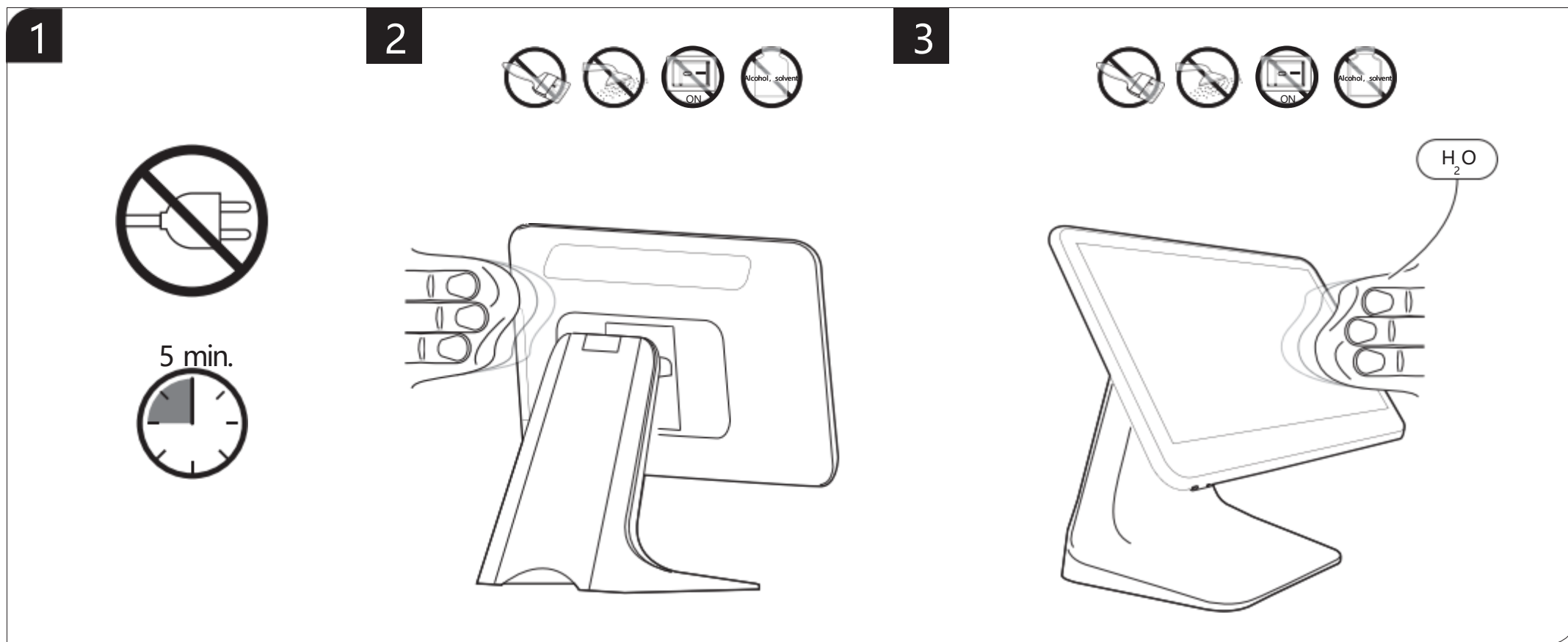

Technical specifications

GENERAL	
processor	RK3568 2.0 GHz
RAM memory	4 GB DDR4
Flash memory	32GB
operating system	Android 11
Interfaces	DC12V Input □*1 DC12V Output□*1 USB 2.0*2 USB 3.0*2 RJ11（RS232）*1 RJ12（Cash Box）*1 AUDIO *1 HDMI Output Connection □*1 RJ45 LAN □*1 WIFI Antenna □*1
LCD PANEL	
Dimension	15 .6
Resolution	1920*1080
Brightness	350 Typ
POWER SUPPLY ELECTRICAL SPECIFICATIONS	
power supply voltage	da 100 vac a 240 vac
Frequence	da 50 Hz a 60 Hz
output	12 V, 3.33 A
power	39.96 w

Device dimensions

All the dimensions shows in following igures are in millimetres.

width	370 mm
Length	204.77 mm
Height	309.1 mm
weight	g

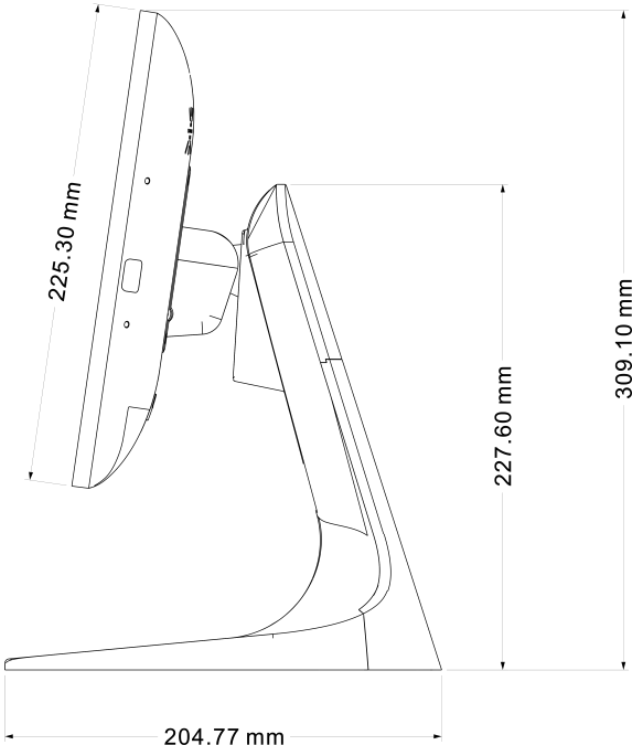
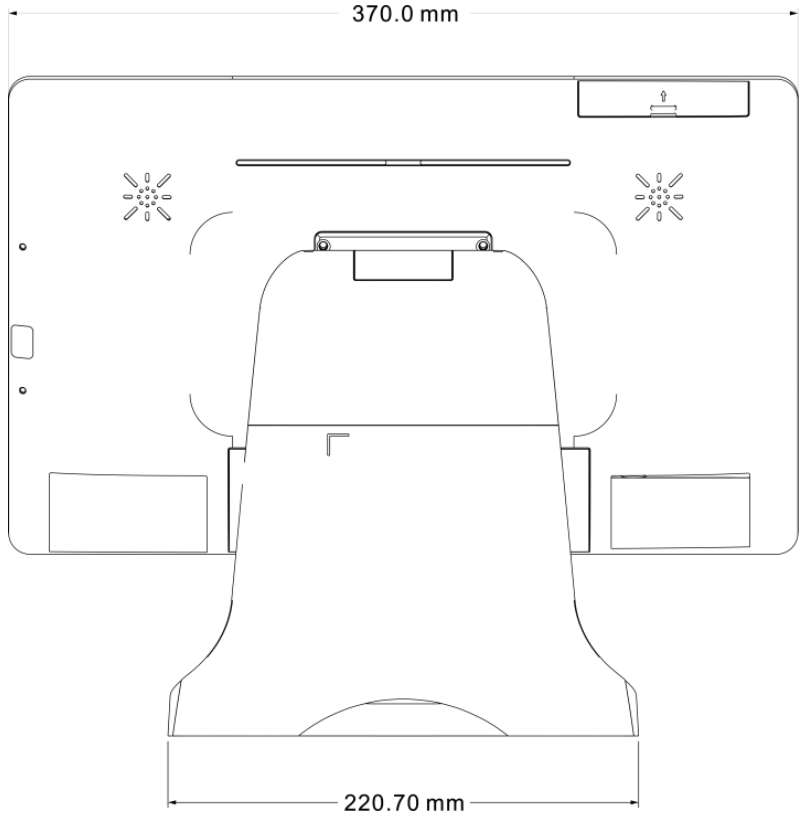

Technical service

1. Find the product label located on the bottom of the device.
2. The label shows the product code Pc, serial number SN and hardware release HW.
3. Login to the site www.custom4u.it and use the support tools.

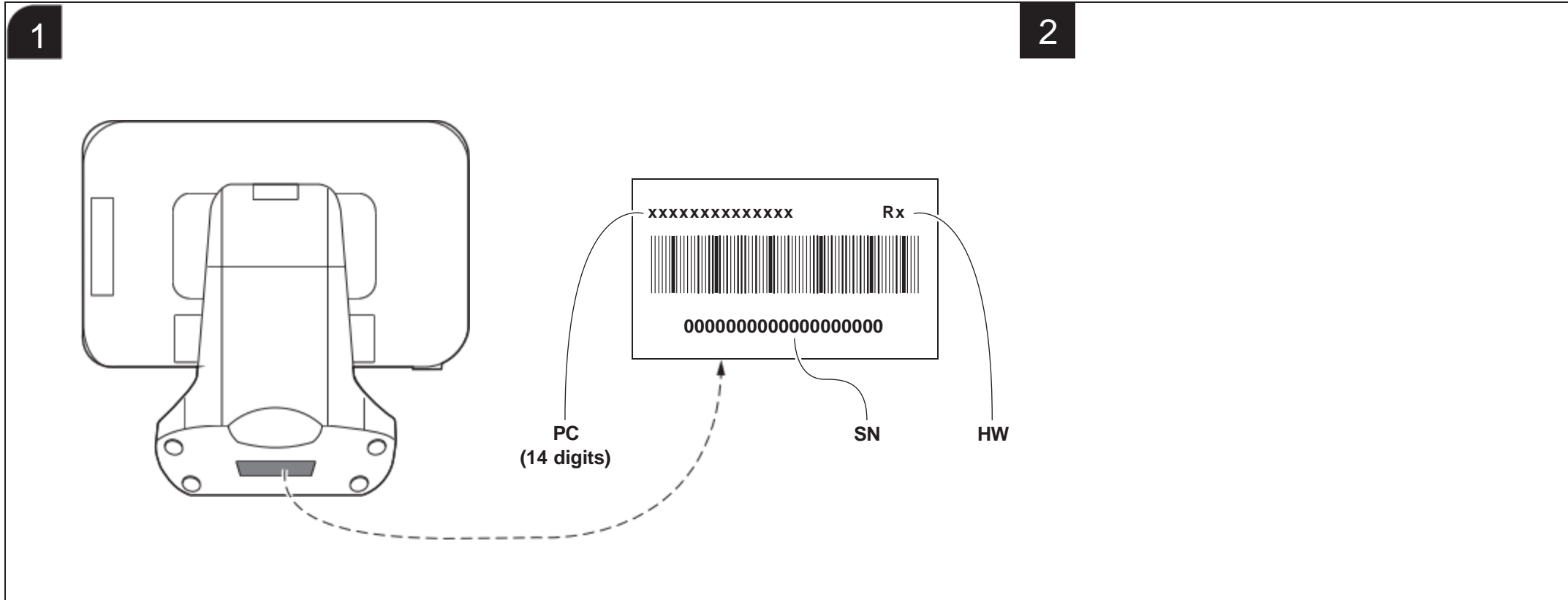

FCC Statement

This equipment has been tested and found to comply with the limits for a Class B digital device, pursuant to part 15 of the FCC Rules.

These limits are designed to provide reasonable protection against harmful interference in a residential installation.

This equipment generates, uses and can radiate radio frequency energy and, if not installed and used in accordance with the instructions, may cause harmful interference to radio communications. However, there is no guarantee that interference will not occur in a particular installation. If this equipment does cause harmful interference to radio or television reception, which can be determined by turning the equipment off and on, the user is encouraged to try to correct the interference by one or more of the following measures:

- Reorient or relocate the receiving antenna.
- Increase the separation between the equipment and receiver.
- Connect the equipment into an outlet on a circuit different from that to which the receiver is connected.
- Consult the dealer or an experienced radio/ TV technician for help.

This device complies with part 15 of the FCC Rules. Operation is subject to the following two conditions:

- (1) This device may not cause harmful interference, and
- (2) this device must accept any interference received, including interference that may cause undesired operation.

Caution:

Any changes or modifications not expressly approved by the party responsible for compliance could void the user's authority to operate the equipment.

FCC Radiation Exposure Statement

This equipment must be installed and operated in accordance with provided instructions and the antenna(s) used for this transmitter must be installed to provide a separation distance of at least 20 cm from all persons and must not be co-located or operating in conjunction with any other antenna or transmitter. End-users and installers must be provided with antenna installation instructions and transmitter operating conditions for satisfying RF exposure.