

Gain Table

Antenna Type	Dipole
Pattern Type	Dipole – omni-directional
Polarization	Linear (X- polarized)
Peak to Peak on omni plane (YZ)[dB]	5.0
Mean gain on omni plane (YZ)[dBi]	-3.5
Max gain on omni plane (YZ)[dBi]	-2.2

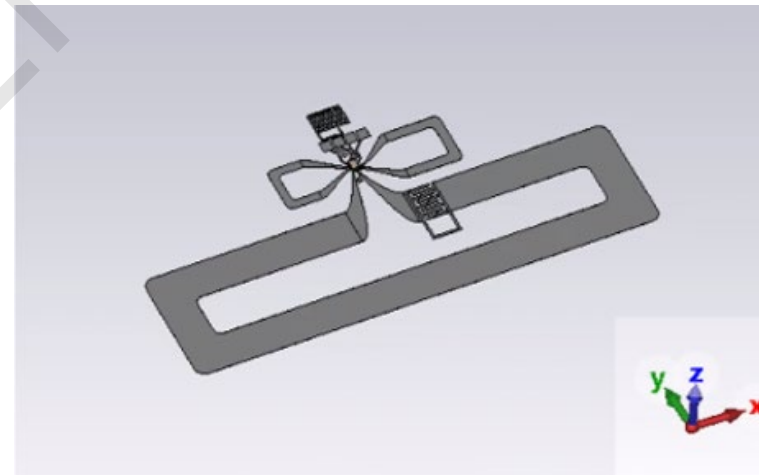

3D radiation pattern at 2.4 Ghz (Tx antenna)

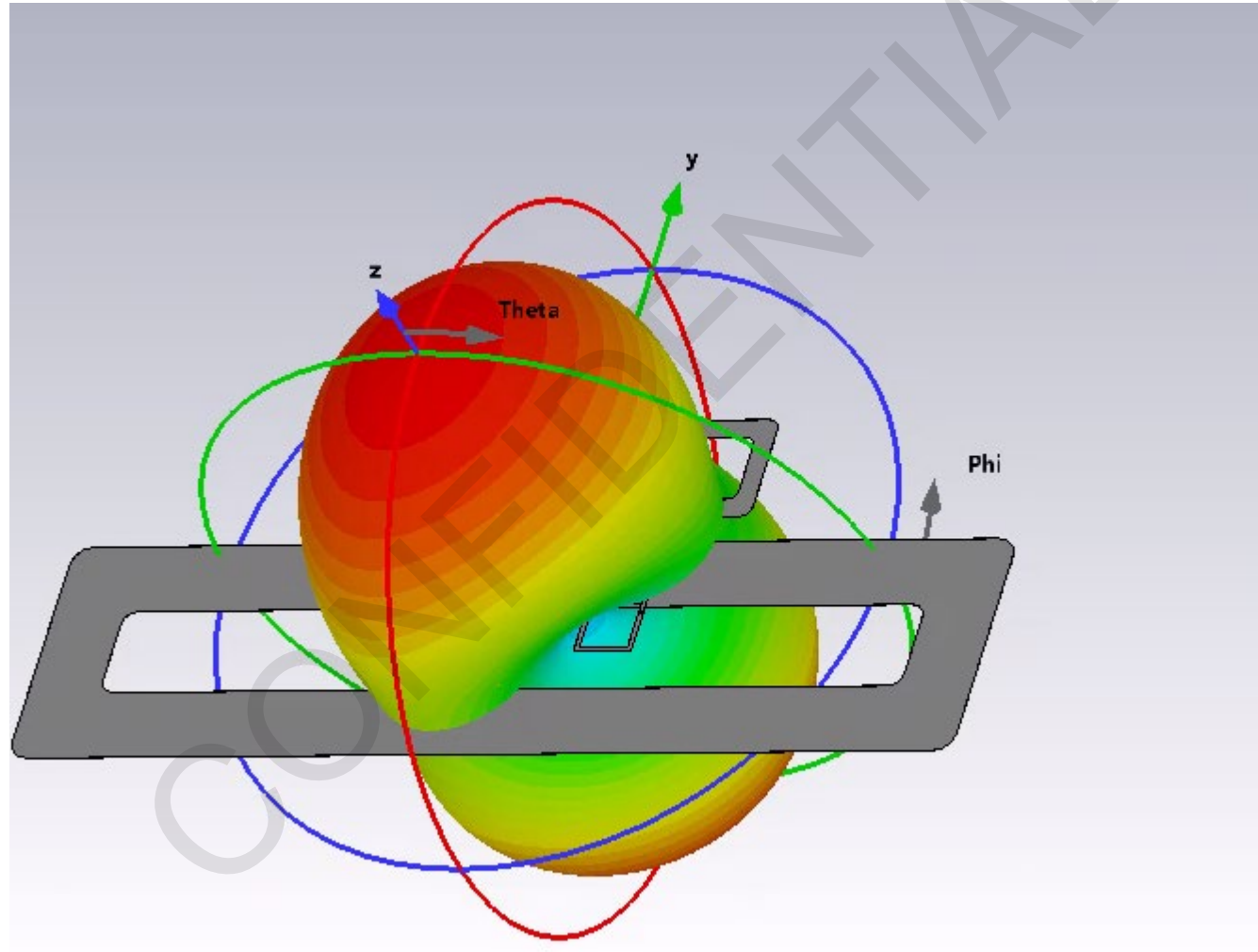

2D cuts at 2.4 GHz

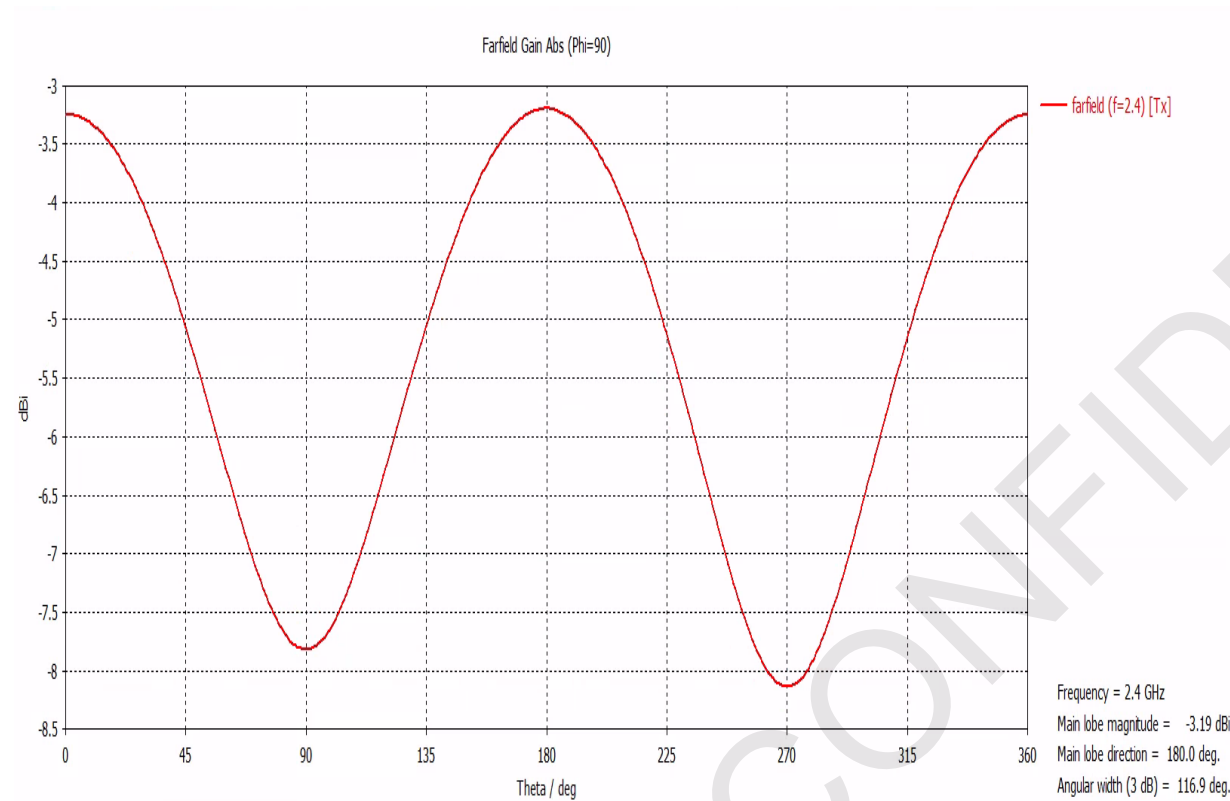

YZ plane

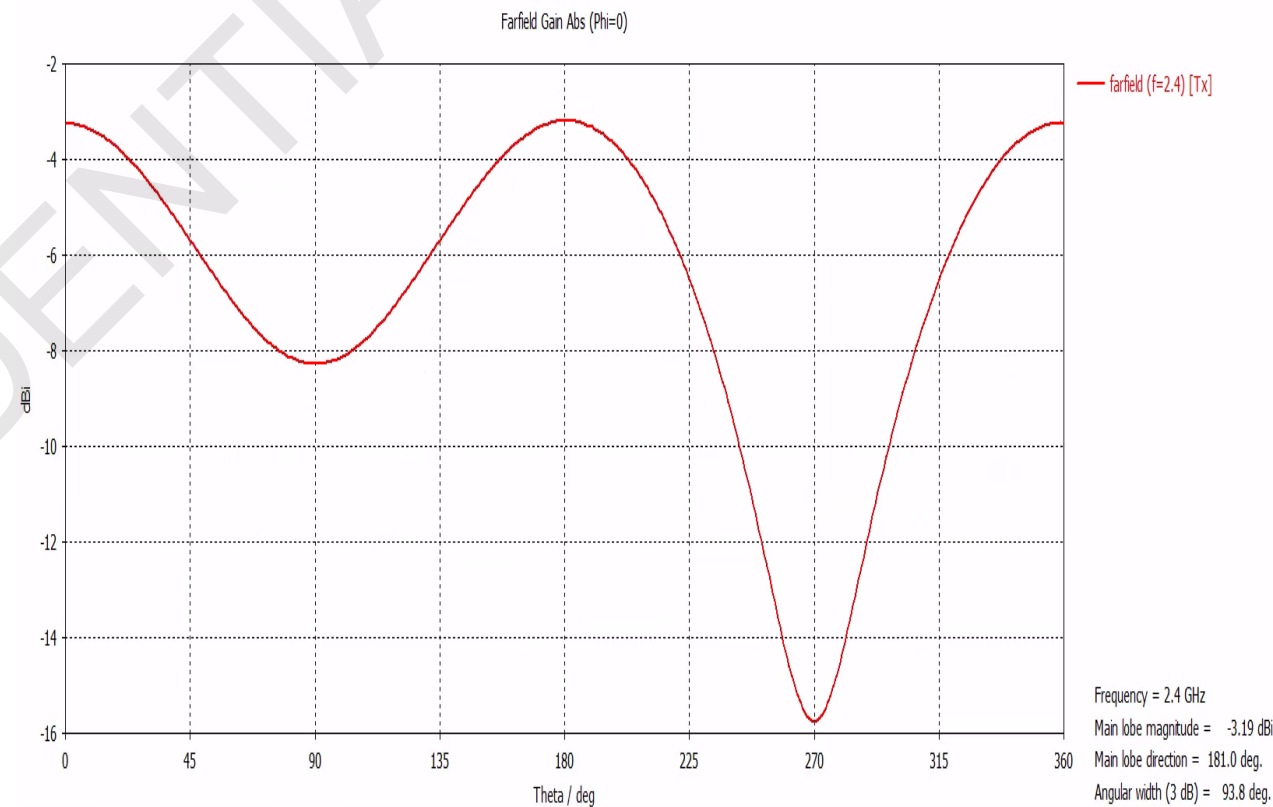

XZ plane