

280x90mm 正面

D4 说明书

感谢您购买此款产品，使用前请仔细阅读操作说明书，以确保正确使用。

本产品是一款带有MP3功能的车载FM播放器，它是LCD显示屏，支持显示来电人姓名以及电话号码，同时采用5.0高性能蓝牙模块，和内置高音质MP3/WAM解码芯片，可以将TF卡或者U盘里面的音乐无线传输到汽车音响上，只要您的手机支持蓝牙功能，连接成功后就可以把手机音乐通过汽车FM发送到您的汽车音响上，无需改装您的爱车，就可以享受动听的音乐了，如果有来电，接听后可以将您的来电切换为免提状态，通话结束后继续播放音乐，（让您的驾驶更安全，同时尽情享受音乐）

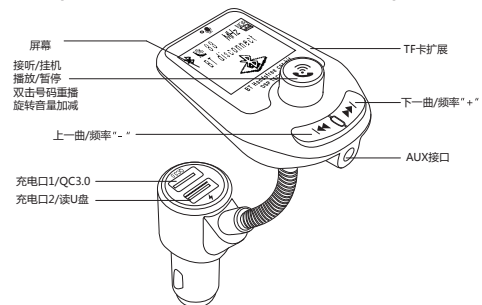

操作说明

1.蓝牙模式：

- (1) 将产品插入汽车点烟器，打开手机蓝牙，搜索蓝牙名称：D4，点击连接配对成功，苹果手机会弹出窗口：是否允许同步通讯录，选择允许，然后会自动同步通讯录，同步成功后，来电就会显示电话号码以及联系人姓名，安卓手机连接蓝牙时会自动导入通讯录。
- (2) 来电时按一下蓝牙电话接听电话。
- (3) 重播电话，双击电话按键，呼出拨打过的第一个号码。
- (4) 当打开手机GPS导航时，可以通过车内的音响播放GPS导航，使你驾驶更加安全。

2.菜单模式：

长按电话键进入菜单，菜单选项包括如下：

- (1) 对比度设置：可以调节显示屏亮度
- (2) 语音设置：英文，中文
- (3) 工作模式：蓝牙模式，TF模式，U盘模式，LIN模式
- (4) 导入电话本功能
- (5) 音效模式：普通、摇滚、流行、经典、爵士、乡村

3.TF/U盘模式：

- (1) 插入TF卡，车内音响自动播放TF内的音乐
- (2) 可以通过旋转编码器来控制音乐声音的大小，音量调到26为最佳，也可以通过汽车音量键来控制音量。
- (3) 把U盘插入带音乐符号的USB口，就可以播放U盘里面的歌曲。

4.调频功能：

- (1) 如果要更换FM频率，长按上下曲键激活频率，然后用旋钮调频率。
- (2) 切换歌曲，可以通过短按上一曲，下一曲按键来切换歌曲。
- (3) 车载MP3的频率范围（88-108.0），产品点亮时，显示屏会出现一个频率，为了使用音质达到最佳，把汽车的频率调到一个空的频率，再把产品匹配好频率。

5.充电功能：

设备支持双USB充电，读U盘的USB口支持1A充电，另一个USB口支持QC3.0快充，兼容支持快充的手机。

6.断电记忆：

每次产品断电重启后，系统会自动连接蓝牙，或者自动记忆FM频率和TF里面的歌曲，当你再次启动设备时，产品会继续播放当前播放的歌曲。

技术参数：

工作电压：12-24V
工作电压限制：9-30V
双USB输出：QC3.0/2.1A
播放格式MP3 WMA
SNR：>60dB
失真度：<0.1%
蓝牙版本：5.0
蓝牙声音处理：A2DP（高级音频分配模式）功能支持
蓝牙内置天线，所以请避免使用信号强烈的广播频率，可以将FM调空频率，以获得更好的声音效果。
蓝牙传输距离：5米
蓝牙话筒有效距离：0.5-2米
FM频率：88-108.0MHz
FM模式：立体声数字PLL频率锁定

注意事项：

1. 插入TF时，蓝牙连接功能处于打开状态，蓝牙功能会自动连接，如果不想接受自动连接可以断开手机蓝牙。
2. 本产品内置天线，所以请避免使用信号强烈的广播频率，可以将FM调空频率，以获得更好的声音效果。
3. 当正在使用调频时，切勿把车载蓝牙音量调到最大，以免失真。
4. 使用手机不同，操作蓝牙的方式也不一样，有些手机在断电后通电时，可能不支持自动播放音乐，需要手动点播放。
5. 适适过程中，如果声音不够大，请手动调节产品的音量。
6. 不要在高温，粉尘或潮湿的环境中使用产品
7. 本产品长期不使用时，应从汽车点烟器口拔下，正常使用时，等汽车启动后再插上使用，避免点火电压过高损坏。

感谢您购买本产品，本产品会给各位使用者提供方便的操作和愉快安全的驾车旅途，让汽车音乐伴您同行。

蓝牙连接

① 插入点烟器插座

将“车载蓝牙播放器”插入点烟器

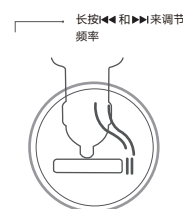

② 手机蓝牙配对

进入手机“设置”-“蓝牙”连接“D4”连接成功，会有语音提示



③ 汽车FM调频至88MHz

将汽车收音机的频率与MP3播放器的频率调为一致都调到87.5MHz（或一致调到其他频率）

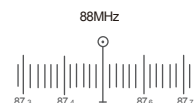

④ 手机播放音乐

手机打开音乐播放器，播放音乐即可用于汽车音响收听所播音乐

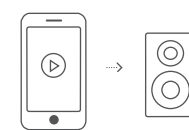

280x90mm 反面

D4 USER MANUAL

Thank you very much for buying this product. You are advised to read this user manual carefully before using this product. We sincerely hope this product will bring you a lot of convenient and fun while you are driving.

This product is a car FM transmitter with MP3 function, with LCD display that supports the caller's name and phone number. It uses a dedicated 5.0 high-performance Bluetooth module, and built-in high-quality MP3/WAM decoder chip. It can transfer the music inside the TF card wireless to the car audio, as long as your phone supports Bluetooth. After the connection is successful, you can send the music to your car audio through the car FM. You can enjoy the music without modifying your car. If there is an incoming call, the caller number will be automatically broadcast. After answering, you can switch your call to hands-free status and continue playing music after the call ends (making your driving safer and enjoying music).

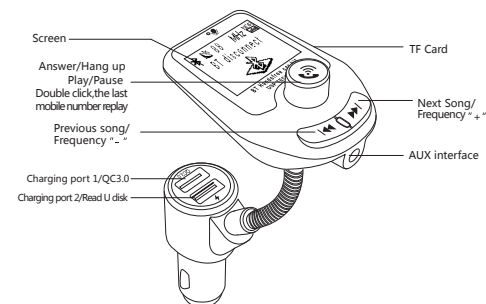

Operating Instructions

1. Bluetooth mode:

- (1) Insert the product into the car cigarette lighter, open the phone Bluetooth, search for the Bluetooth name: D4, click the connection pairing successfully, the Apple phone will pop up a window: whether to allow the Contacts to be synchronized, select the permission, then automatically synchronize the Contacts, synchronization Once successful, the caller will display the phone number and the contact name. Android phones connect to Bluetooth and automatically import contacts.
- (2) When you are calling, press the Bluetooth phone button to answer the call.
- (3) Replay the calling, double-click the phone button to call out the first number dialed.
- (4) When you turn on the mobile phone GPS navigation, you can use the car's audio broadcast GPS navigation to make your driving more secure.

2. Menu mode:

long press the phone key to enter the menu, menu options include the following:
CONTRAST SET, LANGUAGE SET, PLAY MODE SET, GET PH. BOOK, EQ MODE.
(1) CONTRAST SET: can adjust the display brightness
(2) LANGUAGE SET: English, Chinese
(3) PLAY MODE SET: Bluetooth mode, TF mode, U disk mode, LIN mode
(4) GET PH. BOOK: import phone book function
(5) EQ MODE: normal, rock, pop, classic, jazz, country

3. TF / U disk mode:

- (1) Insert the TF card, the car audio automatically plays the music in the TF card.
- (2) You can control the music volume by rotating the encoder, the volume is adjusted to 26 is the best, you can also control the volume through the car volume button.
- (3) Insert the U disk into the USB port with music symbols, you can play the songs in the U disk.

4. FM function:

- (1) If you want to change the FM frequency, long press the up and down button to activate the frequency, then use the rotary knob to adjust the frequency.
- (2) Switch songs, you can switch songs by short pressing the previous song and the next song button.
- (3) The frequency range of the car MP3 (88-108.0), when the product is lit, the display will show a frequency, in order to use the sound quality to achieve the best, the car frequency is adjusted to an empty frequency, then match frequency for product.

5. Charging function:

It supports dual USB charging, the USB port of the reading U disk supports 1A charging, another USB port supports QC3.0 fast charge, compatible with mobile phones that support fast charge.

6. Power-off memory:

When this product is powered off, it remembers the frequency that is used and the music in TF card that is played before it is turned down. When this product is restarted again, it will continue play music that you listen to last time.

Technical Parameters:

Working voltage: 12-24V
Voltage limit: 9-30V
Dual USB output: QC3.0/2.1A
Play format: MP3 WMA
SNR: >60dB
Distortion: <0.1%
Bluetooth version: 5.0
Bluetooth sound processing: A2DP (Advanced Audio Distribution Mode) function support
Bluetooth transmission distance: 5 meters
Bluetooth microphone effective distance: 0.5-2 meters
FM frequency: 88-108.0MHz
FM mode: stereo digital PLL frequency lock

Attention:

1. When the TF card is inserted, this product will connect with mobile phone through Bluetooth automatically unless you turn off Bluetooth on mobile phone.
2. This product contains built-in antenna, so please avoid switching to a FM frequency with very strong signal or an unoccupied FM frequency in order to get a better sound quality.
3. To adjust the volume of car audio by using the button on it instead of adjusting the volume through this product. If you use this product to increase the volume of car audio, do not increase the volume to the highest volume because that can cause distortion.
4. Some mobile phone may not be automatically connected with this product through Bluetooth. If that happened, please manually connect mobile phone with this product through Bluetooth.
5. If the sound is not loud enough during the call, please manually adjust the volume of the product.
6. Do not use this product in high temperature, dusty or humid environment.
7. Pull out this product from the cigarette lighter if it is not in use for a long time. Put this product into cigarette light after the car engine is started to avoid any possible damage of high voltage on this product.

Appreciate again for buying this product. We do hope the extraordinary features of this product and music from your phone can bring your a convenient and pleasant driving.

Bluetooth Connection

① Insert cigarette lighter socket

Insert "car fm transmitter" into the cigarette lighter, long press [Left Arrow] or [Right Arrow] adjust frequency

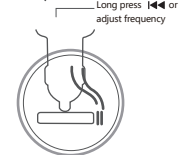

② Bluetooth pairing

Enter the phone "Setting" "bluetooth", connect "D4", there will be a voice prompt after the connect is successful



③ Car FM adjust to 88MHz

Adjust the frequency of the car radio to 87.5MHz (or other consistent frequency) in accordance with the frequency of the MP3 player

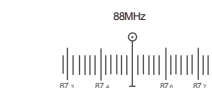

④ Bluetooth Music

Open the phone music player, it can play music through car audio



FCC Caution.

This device complies with part 15 of the FCC Rules. Operation is subject to the following two conditions:

- (1) This device may not cause harmful interference, and
- (2) this device must accept any interference received, including interference that may cause undesired operation.

Any Changes or modifications not expressly approved by the party responsible for compliance could void the user's authority to operate the equipment.

Note: This equipment has been tested and found to comply with the limits for a Class B digital device, pursuant to part 15 of the FCC Rules. These limits are designed to provide reasonable protection against harmful interference in a residential installation. This equipment generates uses and can radiate radio frequency energy and, if not installed and used in accordance with the instructions, may cause harmful interference to radio communications. However, there is no guarantee that interference will not occur in a particular installation. If this equipment does cause harmful interference to radio or television reception, which can be determined by turning the equipment off and on, the user is encouraged to try to correct the interference by one or more of the following measures:

- Reorient or relocate the receiving antenna.
- Increase the separation between the equipment and receiver.
- Connect the equipment into an outlet on a circuit different from that to which the receiver is connected.
- Consult the dealer or an experienced radio/TV technician for help.

This equipment complies with FCC radiation exposure limits set forth for an uncontrolled environment. This equipment should be installed and operated with minimum distance 20cm between the radiator & your body.