

ROMTOK



Scan this code to visit the "ROMTOK" website
to learn about more smart products.

Video Conferencing Bar

Instruction manual

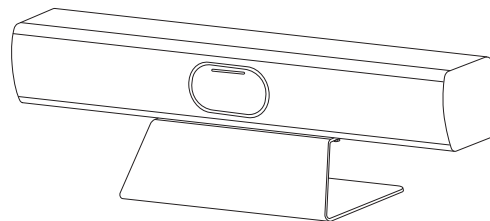

Product name: Video Conferencing Bar

Service hotline: +86-571-88661187

Hangzhou Sairobo Network Technology
Co., Ltd.

The ROMTOK official website always
welcomes you!

Power input: DC12V \approx 5A 

Service email: Support@sairobo.com

Level 8, Building 6, Artificial Intelligence Town,
Hangzhou, China

www.romtok.com

Please read this instruction manual carefully before use.

■ What's in the box

- ROMTOK CN1000 x 1
- Desktop stand (installed) x 1
- Hinge (installed) x 1
- HDMI cable (3m/118inch) x1
- Ethernet cable (3m/118inch) x1
- AC power cable x 1
- Remote control x 1
- Instruction manual / Warranty card x 1

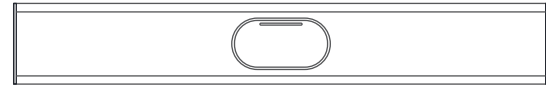

ROMTOK CN1000x 1

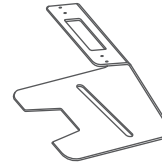

Desktop stand x 1
(installed)

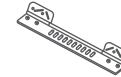

Hinge x 1
(installed)

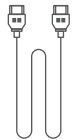

HDMI cable x 1



Ethernet cable x 1

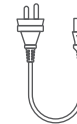

AC power
cable x 1



Remote control x 1



Instruction manual/Warranty
card x 1

*If consumers use a power adapter for power supply, they should purchase a power adapter that has obtained CCC certification and meets the standard requirements.

■ Product overview

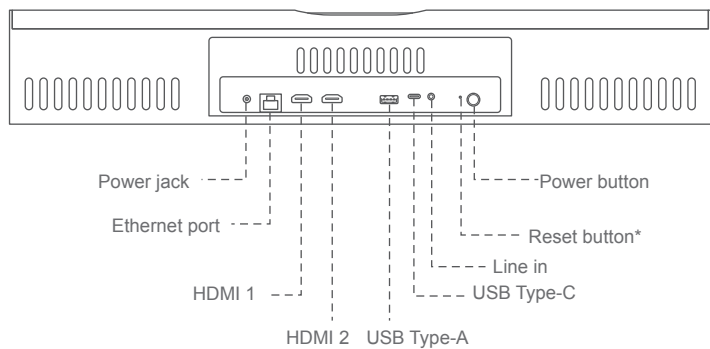
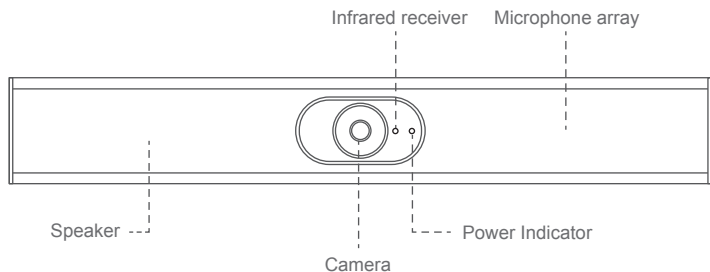

* USB Type-C Port is for data transmission only

* When the device is plugged in but has not been turned on, use a pin or paper clip to press and hold the reset button and long press the power button at the same time to reset the device.

■ Installing the device

- ① Fasten the hinge to the bottom of the device, and then fasten the desktop stand to the hinge.

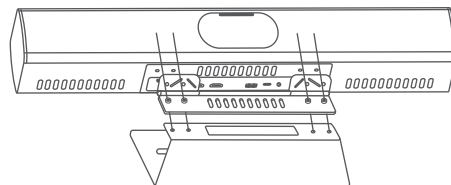
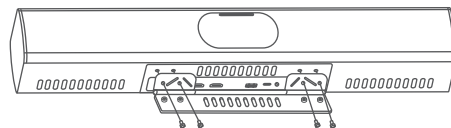

- ② Adjust the angle of the device so that it stays level on a desktop. Make sure the device is stable and not shaking. Before using the device, remove the lens cover and place it on the magnetic area on the right side of the device.

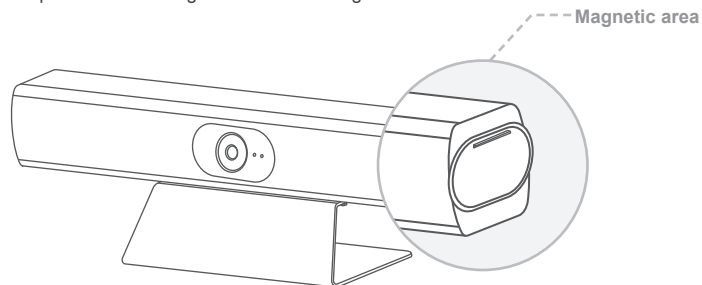

■ Connecting the device to a power supply and a display

① Connect the device to a power supply.

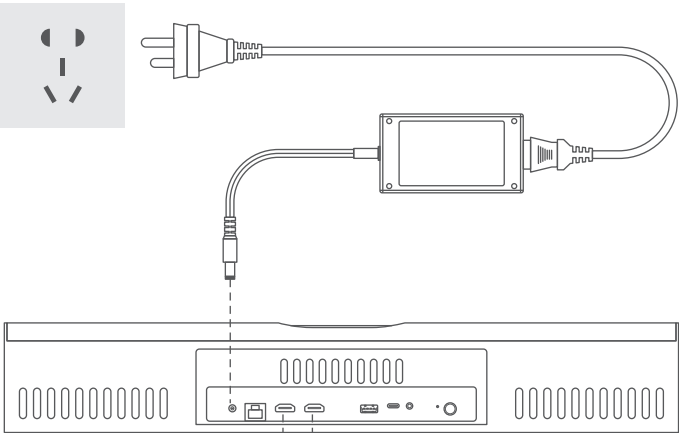

② Connect to a device such as a TV, and a projector using an HDMI cable.

(If you use only one screen, you must connect the cable to HDMI 1.)

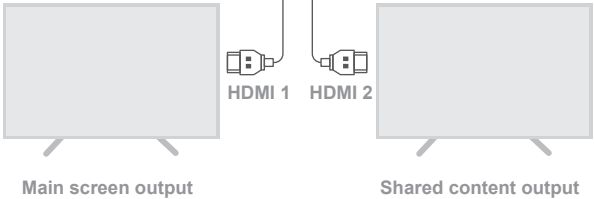

■ Powering on and off

After connecting the power adapter, long press the power button to turn on the device. The power indicator turns green and then red, and finally becomes solid green. To turn off the device, long press the power button until the power indicator goes off.

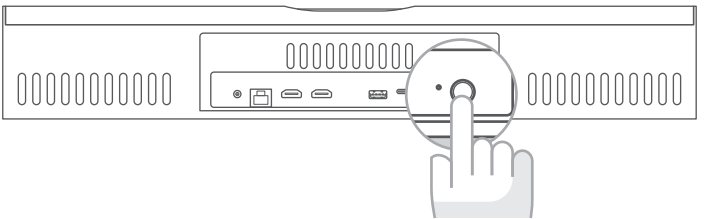

■ Power indicator statuses

Solid green	The device is working.
Solid red	The device is in standby mode.
Off	The device is off.

■ Connecting the device to the internet and connecting peripherals

- ① Connect the device to the internet using an Ethernet cable or Wi-Fi.
(An Ethernet connection is recommended for smoother video conferencing.)

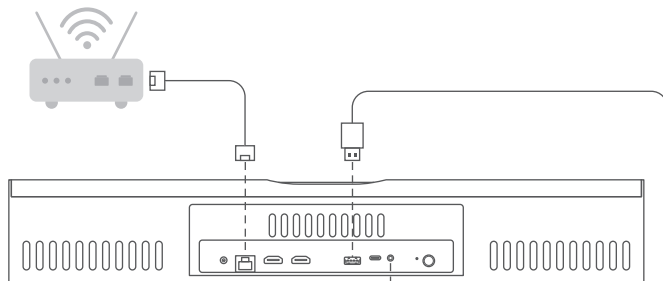

- ② Connect to a device such as a keyboard and a mouse using the USB Type-A port.
(If you need to perform special settings, you can connect a device such as a keyboard and a mouse using the USB port.)

- ③ Connect to an audio device using Line in



■ Using the Video Conferencing Bar (taking the Zoom platform as an example)

- ① Visit the Zoom official website, download Zoom Rooms Controller, and install it on your phone.

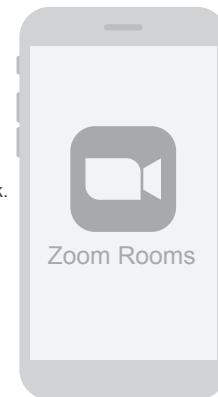

- ② Power on the device and connect it to the internet:
 - Plug in the device and turn it on.
 - Connect the device to the Ethernet or a Wi-Fi network.
 - Connect a phone to the same Wi-Fi network as the device.

- ③ Connect devices:

- Open Zoom Rooms Controller on your phone.
- Enter the pairing code displayed on the screen.
- Pairing is completed. Sign in to your Zoom account and start a meeting.
(Please refer to the official website for the Zoom sign-in instructions.)

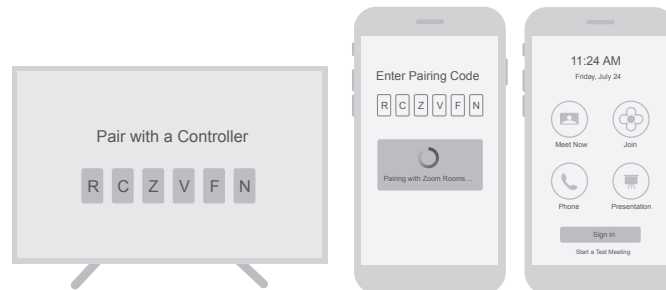

Names and content of hazardous substances in the product

Part name	Hazardous substance					
	Lead (Pb)	Mercury (Hg)	Cadmium (Cd)	Hexavalent chromium (Cr(VI))	Polybrominated biphenyls (PBB)	Polybrominated diphenyl ether (PBDE)
Housing	○	○	○	○	○	○
Circuit board and its components	×	○	○	○	○	○
Packaging components	○	○	○	○	○	○

This table was compiled in accordance with the regulations of SJ/T11364.

- Indicates that the content of the hazardous substance in all homogeneous materials of the part is below the limit requirement specified in GB/T26572.
- ×
- Indicates that the content of the hazardous substance in at least one certain homogeneous material of the part exceeds the limit requirement specified in GB/T26572.
-  This mark means the Environmentally Friendly Use Period (EFUP) of this product is 10 years. During this EFUP, the hazardous substances in this product will not leak or change under normal use conditions, and your use of this product will not cause serious pollution to the environment or serious damage to your health or property.

This product meets the RoHS environmental requirements: at present, there is no mature technology in the world that can replace or reduce the lead content in electronics, ceramics, optical glass, steel, and copper alloys.

Warranty terms

During the warranty period, your Sairobo hardware product is warranted against defects in materials and workmanship when used in accordance with Sairobo's instruction manuals. Under this warranty, you will be able to direct your claims to Sairobo if a defect arises during the warranty period.

≤ 7 days

Within 7 days of purchase, if the Video Conferencing Bar has a defect, you can choose to have the original purchase price refunded, or exchange the product for a product of the same model with equivalent functionality.

≤ 15 days

Within 15 days of purchase, if the Video Conferencing Bar has a defect, you can exchange the product for a product of the same model with equivalent functionality.

After Sairobo confirms the defect, you can choose to repair, refurbish, or replace the product. All changed parts are non-returnable. If we determine a product is not faulty, we will ship it back to you as it is.

The warranty period for the Video Conferencing Bar is 1 year. Any alteration to this warranty card renders it invalid. This warranty card is invalid without the seal of the merchant.

■ Warranty exclusions

This warranty does not apply to some circumstances, including but not limited to:

- No valid warranty card; No valid receipt; Expired warranty.
- Any damage caused by force majeure such as fires, floods, and lightning strikes.
- Any damage caused by not using, maintaining, or storing the product in accordance with the instruction manual.
- Any damage caused by dismantling or repairing by non-Sairobo authorized service providers.
- The product model or serial number on the warranty card does not match that of the actual product.
- Normal decolorization and wear and tear during the use of the product.
- The product is not usable due to the customer's own network.

In any of the above circumstances, you should seek a solution from the responsible party or choose a paid service from Sairobo.

■ FCC Warning:

Any Changes or modifications not expressly approved by the party responsible for compliance could void the user's authority to operate the equipment.

This device complies with part 15 of the FCC Rules. Operation is subject to the following two conditions:

- ① This device may not cause harmful interference, and
- ② this device must accept any interference received, including interference that may cause undesired operation.

Note: This equipment has been tested and found to comply with the limits for a Class B digital device, pursuant to part 15 of the FCC Rules. These limits are designed to provide reasonable protection against harmful interference in a residential installation. This equipment generates uses and can radiate radio frequency energy and, if not installed and used in accordance with the instructions, may cause harmful interference to radio communications. However, there is no guarantee that interference will not occur in a particular installation. If this equipment does cause harmful interference to radio or television reception, which can be determined by turning the equipment off and on, the user is encouraged to try to correct the interference by one or more of the following measures:

- Reorient or relocate the receiving antenna.
- Increase the separation between the equipment and receiver.
- Connect the equipment into an outlet on a circuit different from that to which the receiver is connected.

Consult the dealer or an experienced radio/TV technician for help.

This equipment complies with FCC radiation exposure limits set forth for an uncontrolled environment. This equipment should be installed and operated with minimum distance 20cm between the radiator & your body.

Warranty Card

To be kept by merchant

Customer name _____ (Mr./Ms.) Telephone number _____

Customer address _____

Main unit model _____ Serial number _____

Merchant name _____

Purchasing address _____

Date of purchase _____ Merchant's phone number _____

Receipt number _____

Seal of
merchant



Warranty Card

To be kept by merchant

Customer name _____ (Mr./Ms.) Telephone number _____

Customer address _____

Main unit model _____ Serial number _____

Merchant name _____

Purchasing address _____

Date of purchase _____ Merchant's phone number _____

Receipt number _____

Seal of
merchant